

WABASH - LAT. EAST - S.S. No. 2 - 1900
S.S. No. 20 - Dist. Y - 1920

RECON PORTION DIST. Y SS20
BUILT BY: MID STATES CONST. CO.
PROJ. No 542-80-245-80026-000-000-001
BOOKED 6-14-80 FROM AG 9

Plat 9-51

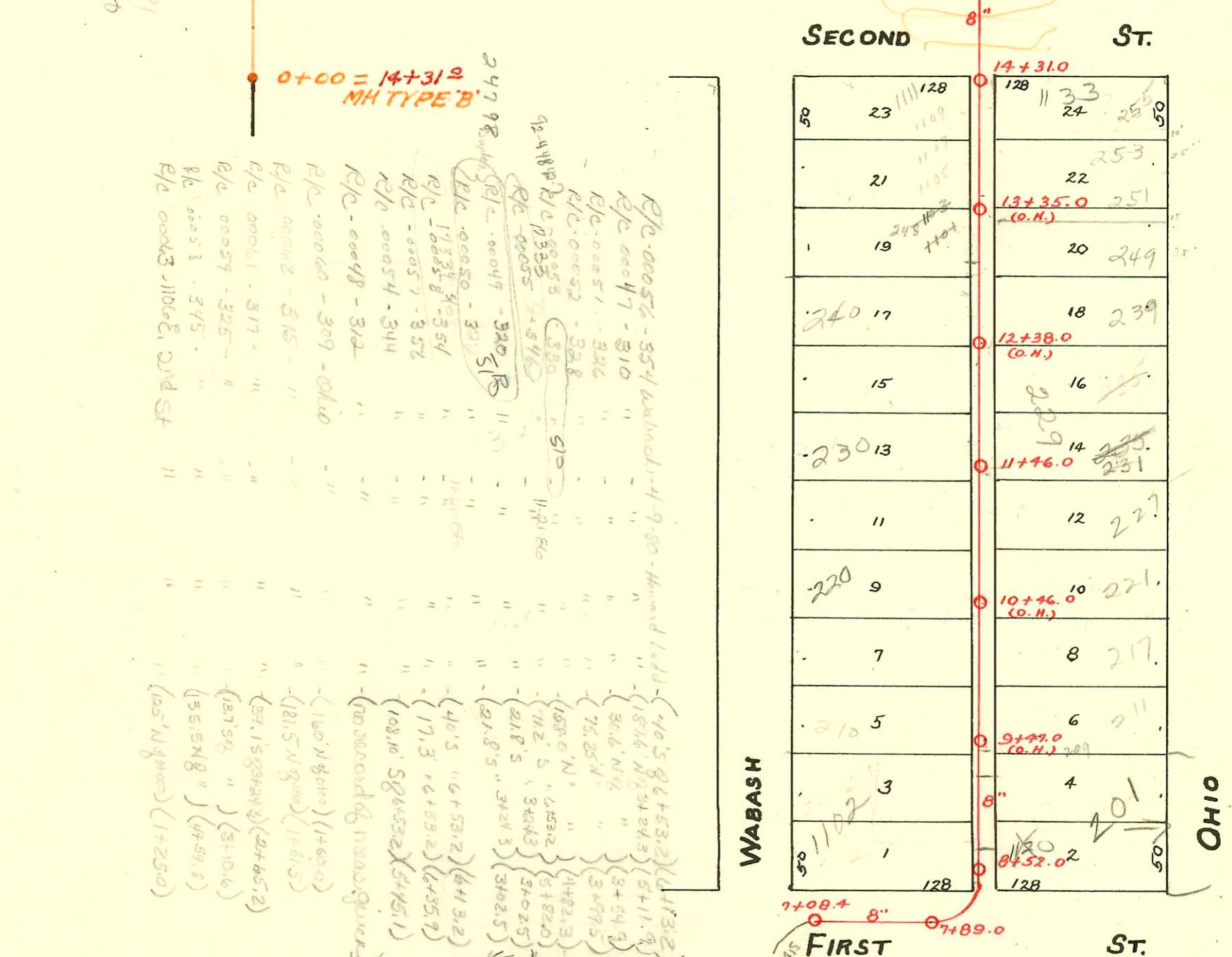
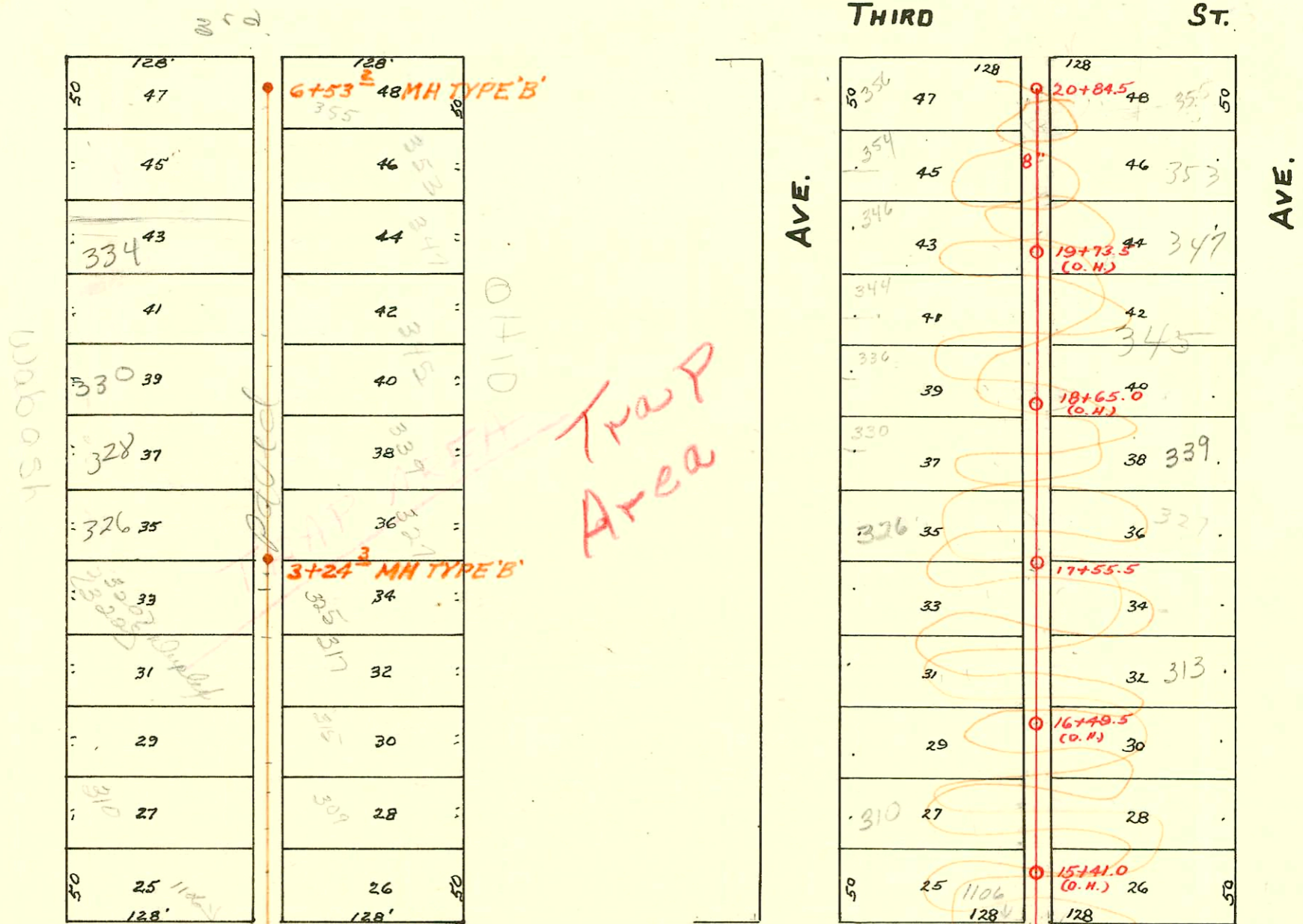

247.98
92.418
R/C 00056 - 354
R/C 00047 - 310
R/C 00051 - 302
R/C 00052 - 328
R/C 00053 - 328
R/C 00054 - 344
R/C 00048 - 312
R/C 00060 - 309
R/C 00062 - 315
R/C 00061 - 317
R/C 00059 - 325
R/C 00058 - 315
R/C 00063 - 1106
R/C 00064 - 1106
R/C 00065 - 1106
R/C 00066 - 1106
R/C 00067 - 1106
R/C 00068 - 1106
R/C 00069 - 1106
R/C 00070 - 1106
R/C 00071 - 1106
R/C 00072 - 1106
R/C 00073 - 1106
R/C 00074 - 1106
R/C 00075 - 1106
R/C 00076 - 1106
R/C 00077 - 1106
R/C 00078 - 1106
R/C 00079 - 1106
R/C 00080 - 1106
R/C 00081 - 1106
R/C 00082 - 1106
R/C 00083 - 1106
R/C 00084 - 1106
R/C 00085 - 1106
R/C 00086 - 1106
R/C 00087 - 1106
R/C 00088 - 1106
R/C 00089 - 1106
R/C 00090 - 1106
R/C 00091 - 1106
R/C 00092 - 1106
R/C 00093 - 1106
R/C 00094 - 1106
R/C 00095 - 1106
R/C 00096 - 1106
R/C 00097 - 1106
R/C 00098 - 1106
R/C 00099 - 1106
R/C 00100 - 1106

- # 26712 - 12-11-90 - 209 N Ohio - Henning (9+32)
- # 26713 - 12-11-90 - 211 N Ohio - Henning (9+58)
- # 26757 - 12-13-90 - 217 N Ohio - Henning (10+12)

#92-44842-7 - 330 N Wabash - 3/4 - Clay tile - as line leaves north property line
97-9244-7 6-9-97 - 249 N Ohio - Henning -
SWR 2001-61799 7/19/09 1120 E 1st St - H.V. Mills -
sealed w/concrete 42' N of 1st St curb

CONSTRUCTION RECORD

SERVICE RECORD

STATION	ELEVATION		Depth	MANHOLE	4-INCH "Y" BRANCHES		No. of Permit		House Number		DATE OF PERMITS	
	Ground	Grade			EAST	WEST	EAST	WEST	EAST	WEST	EAST	WEST
	108.92	106.42 106.29	2.50 3.7	6+53.2 20+84.5 =20+84.2								
					20+78.0	20+75.5						
					20+60.5	20+58.0	#667	#43			12-3-10	3-27-06
					20+35.5	20+43.5	#36719	#544			1-15-73	10-4-10
20	108.49	106.26	2.23		20+11.0	20+08.5	#1705		355 Ohio		11-19-23	
					19+86.5	19+84.0	#591	#120	347 Ohio	347 Ohio	6-6-08	10-28-13
					19+61.5	19+59.0		#85	343 Ohio	343 Ohio	5-5-06	
					19+36.5	19+34.0					8-4-64	
19	108.29	106.06	2.23		19+02.0	19+10.0		#81			1-28-72	5-3-06
					18+88.0	18+85.5	#30208		345 Ohio		6-11-71	
					18+63.0	18+61.0	#606		341 Ohio		7-13-21	
					18+38.5	18+36.0	#272					2-26-23
					18+13.5	18+11.0	#172		338 Ohio	338 Ohio	4-30-73	7-31-08
					17+89.0	17+86.5	#5348	#204	327 Ohio	327 Ohio	1-16-69	9-15-06
		105.63	4.1	3+24.3 77+55.5 =17+55.3	17+64.5	17+62.0	#1022	#270	327 Ohio	327 Ohio	6-26-19	9-29-72
					17+36.5	17+34.0	#169	#270	317 Ohio	317 Ohio	4-7-09	1-24-08
17	107.93	105.66	2.27		17+12.0	17+09.5	#2708	#270	312 Ohio	312 Ohio	7-17-72	9-29-52
					16+82.5	16+85.0	#1109	#271	313 Ohio	313 Ohio	7-29-19	1-24-08
					16+62.5	16+60.0	#106		317 Ohio	317 Ohio	4-25-78	10-8-00
					16+38.0	16+35.5	#106		317 Ohio	317 Ohio	2-15-78	5-19-06
					16+13.0	16+21.0	#218		315 Ohio	315 Ohio	4-25-78	
16	108.26	105.46	2.80		15+89.5	15+87.0	#359	#1355	309 N. Ohio	310 Wabash	5-7-15	11-6-72
					15+64.5	15+62.0			310 Wabash	310 Wabash	7-25-75	
					15+39.5	15+37.0			302 N. Ohio	302 N. Ohio	1-16-78	11-7-19
					15+15.5	15+13.0			2nd Ohio	2nd Ohio	4-20-11	
15	108.75	105.26 104.98	3.49 3.8	0+00 14+31.0 =14+31.0		15+57.6			1106 E Ohio	1106 E Ohio		5-9-77
					14+19.5		#202		1117 Ohio	1117 Ohio	9-13-06	
14	108.58	105.06	3.52		14+05.0	14+17.0	#376	#108	1117 Ohio	1117 Ohio	6-9-77	4-6
					13+92.5	13+90.0	#108	#3924	2nd Ohio	2nd Ohio	72-11-42	3-3-61
					13+68.5	13+66.0	#117	#516	253 Ohio	253 Ohio	5-8-70	
					13+43.5	13+41.0	#233		253 Ohio	253 Ohio	6-11-71	9-17-13
13	107.89	104.86	3.03		13+18.5	13+16.0	#209	#233	243 Ohio	243 Ohio	5-28-06	5-7-04
					12+93.5	12+91.0	#365		240 Ohio	240 Ohio	11-2-07	4-23-74
					12+81.0	12+66.0	#365		229 Ohio	229 Ohio	6-20-18	
					12+43.5	12+41.0	#60		1101 E Ohio	1101 E Ohio	5-1-81	2-13-63
					12+19.0	12+16.5			226 Ohio	226 Ohio		4-18-06
12	108.15	104.66	3.49		11+94.5	11+92.0	#302	#131	209 Ohio	209 Ohio	5-1-81	10-26-21
					11+67.5	11+65.0	#92		231 Ohio	231 Ohio	9-27-01	
					11+46.0				231 Ohio	231 Ohio	7-27-71	10-16-87
					11+42.0	11+39.5			227 Ohio	227 Ohio	5-8-06	4-1-15
					11+17.5	11+15.0	#1027				6-11-71	
11	108.04	104.46	3.58		10+92.5	10+90.0	#227		224 Ohio	224 Ohio	5-1-81	
					10+66.5	10+64.0	#136		224 Ohio	224 Ohio	8-17-23	
					10+52.0						5-19-67	7-22-07
					10+39.0							11-5-01
10	107.84	104.26	3.58		10+22.0	10+15.0	#409				8-7-02	
					9+92.5		#1044				7-16-23	
					9+67.5	9+90.0	#373				4-24-11	
					9+65.0							
					9+42.5	9+40.0	#381	#779	210 Ohio	227 Ohio	4-24-22	8-27-48
					9+17.5	9+15.0	#66		206 Ohio	206 Ohio	12-20-71	2-11-10
9	107.85	104.06	3.79		8+93.5	8+91.0	#31190		1102 E Ohio	1102 E Ohio	3-24-72	
					8+68.5	8+66.0	#1833	#576			12-13-23	9-11-09
8	107.77	103.86	3.91		8+43.5	8+41.0	#211		209 Ohio	209 Ohio	4-26-18	
					7+89.0							
7	108.27	103.68	4.59		7+08.4							
	108.11	103.66	4.45									

SO 8203 - 1122 1st 5-19-83 - Al Henning (8+57.0N) (8+62.5)
 SO C63005 - 212 N. Wabash - Al Henning - 7-12-77 (9+87.0)
 SO C61675 - 1117 E. 5th - Al Henning - 6-20-77
 SO C6207 - 328 Wabash - Wm. Long - 5-31-77 (8+129.5)
 SO C59564 (306 Wabash) 1-24-77 15th. 4th. Top line
 SO C59014 (224 Wabash) 12-9-76 20th Top SRK
 SO C58360 (328 Wabash) M. Surly 10-26-76 25th Top of 20. Top line
 C55567 - 355 Ohio - 5-24-76 - Seal off
 C44585 - 240 N. Wabash - Dennis Moon 4-23-74 (top)
 C20811 - 344 Wabash - J.C. Moore - 9-2-70 (top 19+76.5)
 #1616 - Top - 302 Wabash - 6-22-44 - Wichita Pkg Co.
 #1257 - Top - 230 Wabash - 5-13-52 - G.A. Smith
 B1010 - Seal off (106-104 W. 25th) 23-9-64 Smith pkg.
 #C5499 - Seal off (344 Wabash) 10/27/67 Geo Griffin
 #C6227 - Seal off (336 Wabash) 12/21/67 - Geo Griffin
 C-20139 - Seal off (302 Wabash) 7-16-70 - Al Henning
 C29554 - Seal off (202 Wabash) 12-20-71 - Al Henning
 C56296 - new open - 302 Wabash - 7-20-76 - Wabash held

C71439 - (335 N. Ohio) - 4-26-79
 C71671 - (239 N. Ohio) - 5-9-79 (1460.5)
 3224 - 229 Ohio 5-1-81
 22421 - 220 N. Wabash - 1-17-89 SO. at Henry
 (Sealed 17" N of SR out in life)