

PART OF LAT. 15 FROM 1ST ST. TO 3RD ST. BET. MATHEWSON & NEW YORK
S.S.No.4-1904-DIST.Y-S.S.No.20-1920.

Plat 9-51

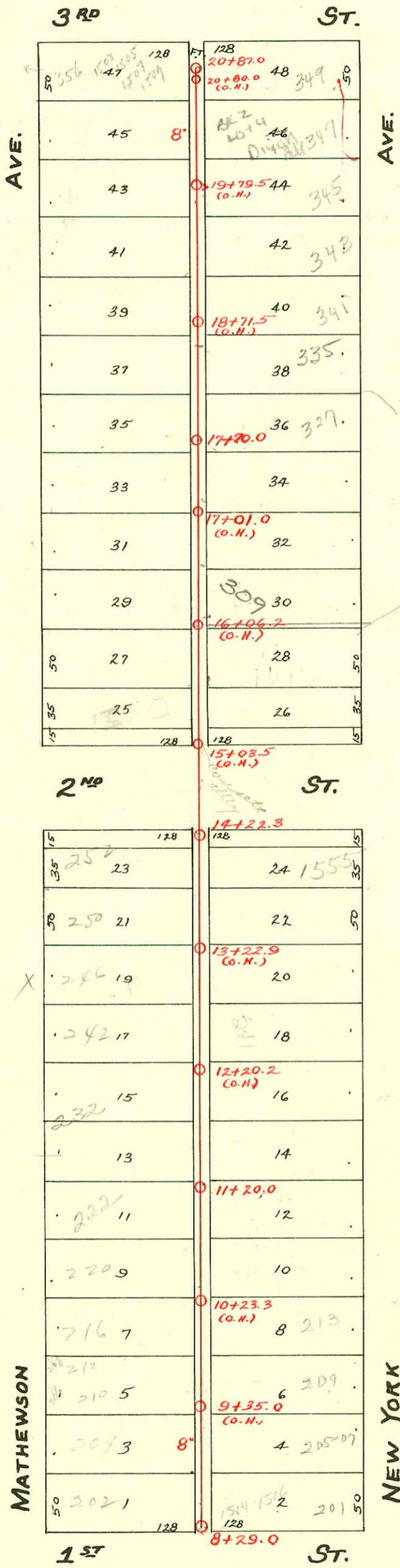

TRAP AREA

1=100

1770
1601
1169

CONSTRUCTION RECORD

SERVICE RECORD

STATION	ELEVATION		Depth	MANHOLE	4-INCH "Y" BRANCHES		No. of Permit		House Number		DATE OF PERMITS			
	Ground	Grade			North West	South East	North West	South East	North West	South East	North West	South East	North West	South East
8			4.80	8+29.0		8+32.0		#305		203 New York		12-16-08		
					8+34.0	8+56.0	#116	#1	1512 E. 1ST	NO RECORD	4-1-37	1-2-22		
					8+58.0	8+78.5	#280	#1593	RECORD	New York	1-14-14	3-14-47		
					8+80.5	8+88.5		C43784		205		3-4-74		
9					9+04.5	9+04.5		C202-00720		207 R. S. S. ROW		3-15-22		
					9+06.5	9+30.5	#580	#207	207 R. S. S. ROW	New York	12-9-88	8-6-41		
					9+35.0	9+35.0	#189	#405	213	New York	8-13-17	8-29-79		
					9+82.5	9+82.5	#720		210	New York	12-9-88	7-11-10		
					9+57.5	9+55.5		#439		209	New York	9-29-17		
					9+83.0	9+81.0						8-20-31		
10					10+09.0	10+07.0	#246	#214	216 5/10		4-10-03	6-11-18		
					10+35.0	10+33.0	#645		215	New York	1-22-96	8-30-17		
					10+60.0	10+58.0	#820	#7907	222 1/2	New York	9-23-65	10-7-71		
					10+81.0	10+79.0	#4373	#133	223 1/2	New York	4-7-19	4-25-83		
11					11+06.5	11+04.5					10-19-65	6-18-08		
				11+20.0										
					11+33.0	11+31.0	#277		224	New York	6-20-69	11-21-08		
					11+58.0	11+56.0	#575		224	Mathewson	12-4-12			
					11+84.0	11+82.0	#115		239	New York	12-4-81	3-7-10		
12					12+09.5	12+07.5	#178		236	Mathewson	6-20-69	8-13-06		
					12+32.6	12+30.6	#418	#387	242	New York	8-26-69	11-26-73		
					12+58.0	12+56.0	#767		241	New York	7-9-14	3-5-24		
					12+83.5	12+81.5	#180		243	New York	10-20-69	5-21-23		
13					13+09.5	13+07.5	#232		246 5/10	Mathewson	8-15-06			
					13+33.5	13+33.5	#253	#811	250	Mathewson	4-19-10			
					13+59.5	13+57.5	#253	#811	252	New York	5-13-85	7-18-83		
					13+86.0	13+84.0					4-30-10	3-3-19		
14					14+12.0	14+10.0								
				14+22.3										
					14+99.0	14+99.0	#662		1516 E. 2ND		8-2-72	6-18-25		
15					15+01.0	15+33.0	#134	#195	304	New York	1-17-69	9-7-72		
					15+26.5	15+24.5	#30	#195	304	New York	2-26-20	3-13-08		
					15+52.0	15+50.0						12-3-79		
					15+77.5	15+75.5	#2283		316	Mathewson	3-20-07	8-30-06		
16					16+03.5	16+01.5	#185		317	New York	11-15-73			
					16+29.0	16+27.0	#185		317	New York	9-15-83			
					16+54.5	16+52.5	#72		317	New York	10-2-05	4-19-41		
					16+80.5	16+78.5						2-14-10		
17					17+05.5	17+03.5	#253	#961	324	Mathewson	12-26-07	2-1-73		
					17+32.0	17+30.0	#232	#271	326	Mathewson	8-1-29	8-1-29		
					17+56.5	17+54.5					5-1-18	7-14-07		
				17+70.0										
					17+84.0	17+82.0								
18					18+10.5	18+08.5	#159	#272	336	Mathewson	8-23-05	1-15-07		
					18+35.5	18+33.5	#160	#292	334	Mathewson	8-24-05	4-1-78		
					18+61.5	18+59.5	#340		341	New York	4-11-11	4-27-21		
					18+86.5	18+84.5								
19					19+12.0	19+10.0	#164		340	Mathewson	8-30-05			
					19+40.0	19+38.0	#257	#146	343-5	New York	7-26-84	7-26-84		
					19+66.5	19+64.5	#257	#146	344 R	New York	10-5-84	2-19-80		
					19+97.0	19+95.0					12-26-07	7-29-07		
20					20+22.0	20+20.0	#124	#786	346	Mathewson	3-26-18	12-10-93		
					20+47.5	20+45.5	#232	#248	350	New York	11-27-05	9-26-11		
					20+72.5	20+70.5	#16574				11-3-69	5-28-12		
				20+87.0 FT.										

2002-00720 - 3/15/02 - 207 N New York - RD Campbell - Replaced upper 8'-4" 45, 4" 54 40, TWIN CO

C69764-1510 C. 2nd - 12-11-78 (15+10A) 2-21-76 (13+47.5)

C41797-1555 E. 2nd - al Henning 8-2-72 (15+15)

#C19642-246 Mathewson - al Henning - 6-10-70 (13+09.5)

C34030-323 New York - al Henning 3-18-69 - Seal off

C13169-326 Mathewson - al Henning 3-18-69 - Seal off

#3702 - Trailer - Private line - 213 New York - 1-7-53 - Joe Mc Donald #14177 tap 211 New York Chipp's P/bq. 5-12-61 (10+20.0)

Rec. #44587 - 239 New York - Henning - 8-16-56

#167-78P - 1509 E. 2ND - 2-27-28 - Oldfather

#2085 - 209 New York - 2-14-40 - Frederick P/bq. Co Used old connection. 4-4-75 - al Henning

#3227 - Private line - 341 1/2 New York - 3-25-41 - Dean Skinnell C48845 7-18-73 (13+89.3)

#1057 - Tap - 1519 E. 2ND - 12-9-46 - J.N. Hanno C40103 - Henning

#650 - Tap - 324 Mathewson - 4-16-54 - Seal off C 32855 - al Henning 6-12-72

#2194 - 6 on 8 wye - 207 New York - 10-5-54 - Phipps P/bq.

B-587 - Seal off - 1507 E 2nd Henning 12-16-63 #20944 - 6-30-88 - 327 N. New York - sealed 2' w of MH 17+70

#5782 - Seal off - 320 N Mathewson Henning - 10-4-76