

PART OF LAT. 16 FROM FIRST ST. TO THIRD ST. BET. NEW YORK & PENNSYLVANIA  
S.S. NO. 4-1904 - DIST. Y-S.S. No. 20-1920.

Plat 9-51

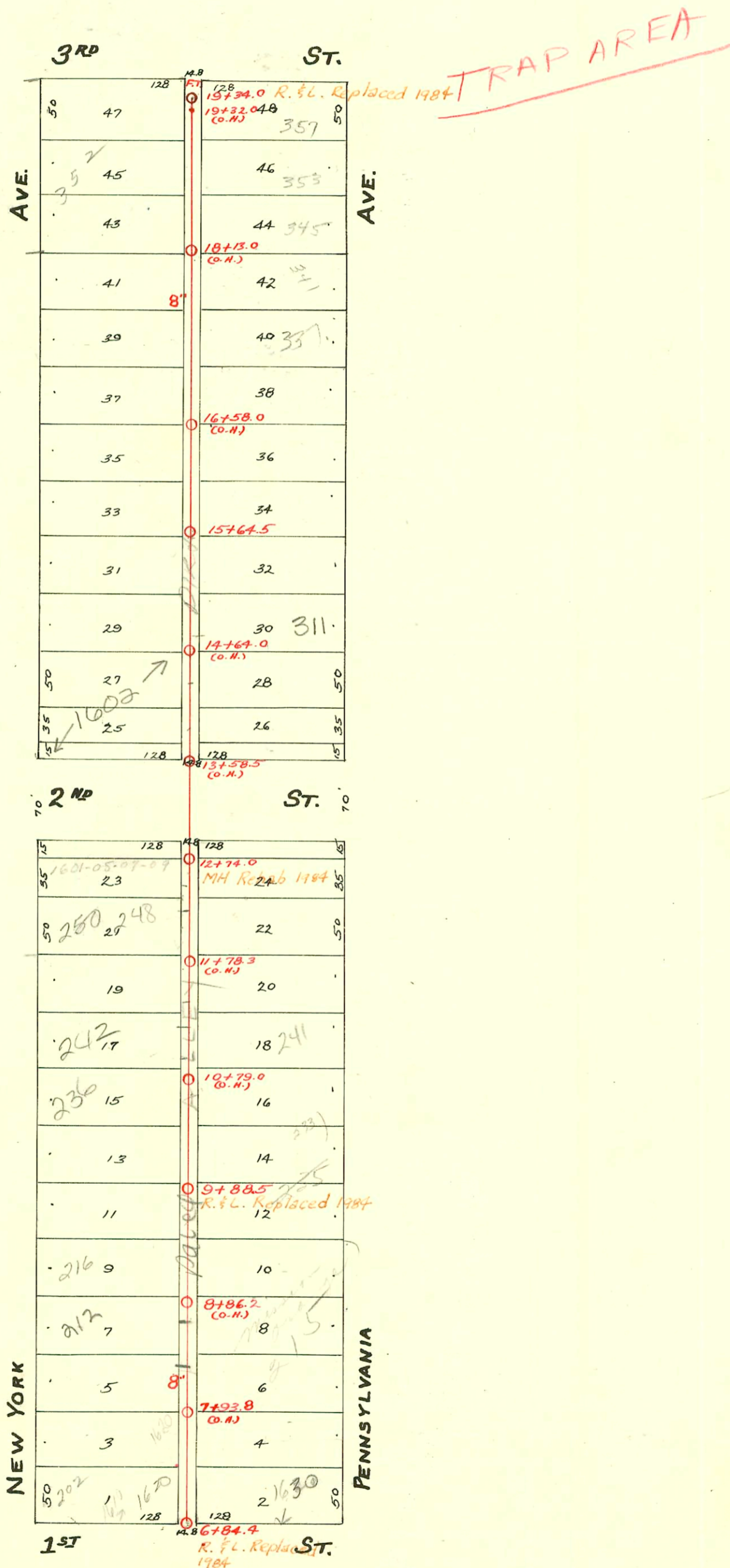

CONSTRUCTION RECORD						SERVICE RECORD						
STATION	ELEVATION		Depth	MANHOLE	4-INCH "Y" BRANCHES		No. of Permit		House Number		DATE OF PERMITS	
	Ground	Grade			North West	South East	North West	South East	North West	South East	North West	South East
6				6+84.4		6+88.0						
7					6+90.0							
					7+10.0	7+08.0	#172	259	202	1618	9-11-05	2-9-60
					7+33.0	7+31.0	#405	227	203 N	1630	9-29-76	11-22-07
					7+58.0	7+56.0	#143	1006	1230 East	207	7-5-06	8-15-22
					7+83.5	7+81.5						
8					8+08.0	8+06.0	#1387	1007	1670 E 1st	210	5-29-85	8-15-22
					8+33.5	8+31.5	#2936		214 New York		4-11-46	
					8+58.0	8+56.0						
					8+73.5	8+71.5	#2615	1026	214 New York	221 S/O	10-9-50	5-6-24
9					9+08.8	9+06.8	#156	884	210 S/O New York	221 Pennsylvania	8-15-06	8-10-25
					9+33.8	9+31.8						
					9+58.6	9+56.6						
					9+83.5	9+81.5						
				9+88.5								
10					10+05.0	10+07.0	#259	864	232 New York	233 S/O Pennsylvania	1-6-08	5-16-80
					10+32.0	10+30.0	#624	324	240 New York	235 Pennsylvania	10-29-18	5-16-80
					10+57.5	10+49.5	#219	868	244 New York	235 Pennsylvania	5-14-12	7-20-22
					10+76.0	10+74.0	#208		242 New York	243 Pennsylvania	3-23-20	
						10+99.0		#840	242 N New York	241 Pennsylvania		7-15-22
11					11+01.0	11+24.5	#5236		241 Pennsylvania	241 Pennsylvania	7-24-17	6-17-55
					11+26.5	11+49.0	#136		241 Pennsylvania	241 Pennsylvania		6-28-08
					11+51.0	11+74.0	#650		249 Pennsylvania	249 Pennsylvania		6-20-28
					11+76.0							
						11+99.0						
12					12+01.0	12+24.5	#173		250 New York	255 Pennsylvania	9-11-05	
					12+26.5	12+49.0	#798		250 New York	255 Pennsylvania	6-8-73	1-17-10
					12+51.0		#434		250 New York	255 Pennsylvania	7-14-09	
				12+74.0								
13					13+56.0	13+54.0						
					13+81.0	13+79.0	#139	28	2000-00142 New York	311 N R Pennsylvania	7-23-07	3-7-06
14					14+06.5	14+04.5	#140		308 New York	314 Pennsylvania		2-29-00
					14+31.8	14+29.8					7-23-07	
					14+56.5	14+54.5						
			5.9		14+81.5	14+79.5	#141	2000-00142	310 S.O. New York	311 N R Pennsylvania	7-23-07	1-18-00
15					15+06.5	15+04.5	#410		312 Pennsylvania	315-17 Pennsylvania	5-4-17	7-12-10
					15+31.8	15+29.8	#264	554	316 New York	316 Pennsylvania		4-19-56
					15+56.6	15+54.6	#420		316 Pennsylvania	316 Pennsylvania		7-10-14
				15+64.5	15+80.0	15+78.0	#682	190	316 New York	316 Pennsylvania	9-13-17	4-14-09
16					16+03.0	16+01.0						
					16+28.5	16+26.5	#594		320 New York	320 N Pennsylvania	10-29-23	
					16+53.0	16+51.0	#816		334 New York	334 Pennsylvania	1-25-10	
					16+78.0	16+76.0	#189		330 N Pennsylvania	330 N Pennsylvania		4-17-18
17					17+03.0	17+01.0						
					17+28.0	17+26.0	#1018	1396	333 New York	337 S/O Pennsylvania	5-5-24	11-5-02
					17+53.0	17+51.0	#6375		342 New York	342 Pennsylvania	9-9-53	2-5-47
					17+78.0	17+76.0	#291		335 Pennsylvania	335 Pennsylvania		12-8-08
18					18+03.0	18+01.0						
					18+28.0	18+26.0	#444		346 New York	346 Pennsylvania	10-26-12	
					18+53.0	18+51.0						
					18+79.0	18+77.0	#955	2000-00092	356 Pennsylvania	353 Pennsylvania	5-28-19	1-13-00
19					19+04.0	19+02.0	#770	243	356 New York	356 Pennsylvania	3-11-19	4-23-10
				19+34.0 FT.								

2003-03376 - R-311 N Pennsylvania - Reddi - No clo - 1445, 1422, 4" PVC - Replace 10' upper pipe  
 2000-00142 - R-311 N Pennsylvania - Reddi Rootr - 6" PVC - Replaced Lower 12' (90's of MH 15+64.5) (1447.5)

97-80147 - 5-20-97 236 N New York

764 8737 1605-09 E. 2nd (Khan) MH 12+74 7-18-13  
 26333/2-227 Pennsylvania - All Henning - 10-3-77 (9+42.5)  
 2059263-247 N Pennsylvania - Reddi Rootr - 12-22-76 (11+51.6)  
 059977-352 New York - 10-1-76 (18+79)  
 257400-347 New York - 8-25-76 - All Henning (18479)  
 052399-346 New York - 8-25-76 - All Henning (18429)  
 #017033-244 New York - 11-21-69  
 (Sealed on prop line 75' W of main sewer)

#10046 341 N Pennsylvania - All Henning - 1-24-85 191310 S.  
 C14764-345 Pennsylvania - Seal off - All Henning 6-30-69  
 16119 - Seal off - 206 New York - 9-10-62

#2489 - Tap 1618 E. 2ND 11-16-49 - Cherry Pkg. Co.  
 #4117 - Setting wye - 6" on 8" - 2-16-53 - 1610 E. 2ND Pray Bros.  
 #6270 - 6" on 8" wye - 227 Pennsylvania - 8-24-53 - P.C. Fish.  
 #1200 - Tap 1610 E. 1ST - 11-25-49 - Frederick Pkg. Co. 4/15/82  
 #7208 - Wye 1608 E. 1ST - 1-9-56 - Pray Bros.  
 #7154 - Wye 1608 E. 1ST - 1-9-56 - Pray Bros.  
 #15323 Tap 215 Pennsylvania 3-21-82 Riparo - Inman (8+79.5)  
 #2440 - depth 242 New York 4-28-11 All Henning (10+93+70 ft.)