

S.S. No. 8-1908



SCALE: 1" = 100'

Ordinance No. 18-597 vacates Alley bet. Osage & Oak from Douglas So. to the E. & W. alley So. of Douglas. Jan. 20, 1953.

The 108' Lateral running in this vacated alley has been abandoned as a City sewer and the maintenance of this Lateral will be the responsibility of the property owner. See letter of Jan. 23, 1953 - City Service Dept.

TRAP AREA

1993 SANITARY SEWER REHABILITATION PROGRAM - PHASE I
 PROJ. NO. 468-82348 (632000)
 BUILT BY INSITUFORM PLAINS, INC.
 BOOKED 5-11-94 FROM AS BUILTS

RECONNECTIONS

STA.	ADDRESS	DIRECTION
0+4	711 W. Douglas	North
7+99.5	201 S. Oak	East
7+84.5	715 W. Texas	West
7+74.9	204 S. Osage	West
7+52.2	206 S. Osage	West
7+49.8	209 S. Oak	East
0+96.5	219 S. Oak	South
6+20	No Address	East
6+07	No Address	West
6+04	No Address	West
5+72	No Address	East
4+48	No Address	East
4+41	No Address	West
4+37	No Address	West
4+22	No Address	West
4+04	No Address	East
3+95	No Address	East
3+46	No Address	West
2+74	No Address	East
2+49	No Address	West
1+97	No Address	East
1+69	No Address	East
1+27	No Address	East
1+21	No Address	West
0+96	No Address	East
0+93	No Address	East
0+74	No Address	East

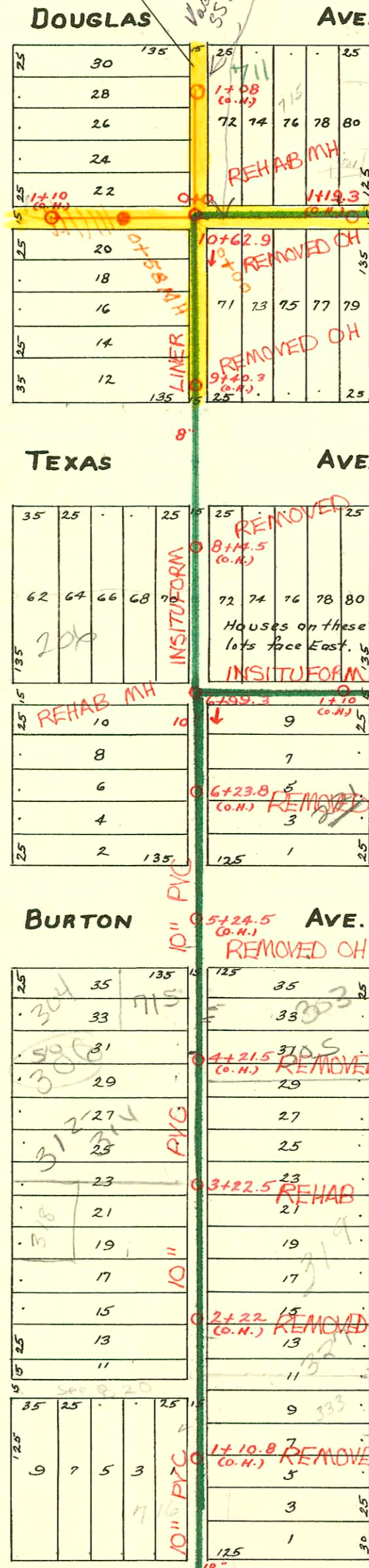

WICHITA STATE BANK S S
 PROJ. NO. 468-76-245-80475-000-000-008
 BOOKED 4-16-79 FROM 1H.92

1994 SANITARY SEWER REHABILITATION PROGRAM - PHASE I
 PROJ. NO. 468-82399 (623124)
 BUILT BY INSITUFORM PLAINS, INC.
 BOOKED 2-6-95 FROM AS BUILTS

1993 SANITARY SEWER REHABILITATION PROGRAM - PHASE II
 PROJ. NO. 468-82348 (63200)
 BUILT BY W. B. CARTER CONST. CO.
 BOOKED 5-31-95 FROM AS BUILTS

95-8714-7 6-16-95 716 W. Maple
 2nd conn at 0+90.8 - top
 6" sh 40 PVC

95-1714672 10/27/95
 708 W. Maple (home) -
 Ahead -

95-2019472 12-7-95 -
 708 W. Maple -

2002-02731- 319 S. Oak 10/4/02
 Roto-4" PVC 40 Exist trap - DL
 replaced saddle w/ Predno Saddle
 47.5' sof MH 3+22.5 (3+70) Installed
 trap, 1v22, 1v45, Twin co @ house -
 Replaced entire line - paved alley cut - old
 msmt not correct

7174.9
 6+99.3

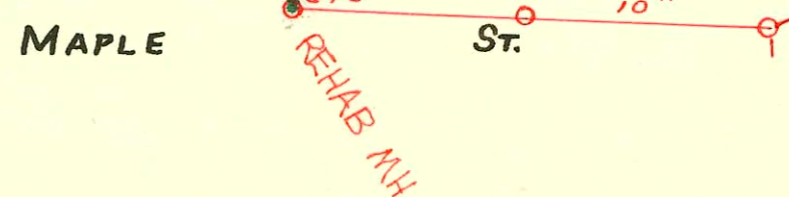

CONSTRUCTION RECORD

SERVICE RECORD

STATION	ELEVATION		Depth	MANHOLE	4-INCH "Y" BRANCHES		No. of Permit		House Number		DATE OF PERMITS	
	Ground	Grade			North West	South East	North West	South East	North West	South East	North West	South East
				(+10 (o.H.))								
1					1+06.8							
					0+77.0							
					0+49.5							
					0+21.5							
0			4.70	0+0								
1	112.41	107.55	4.86	1+08 (o.H.)	1+08	1+06						
						0+91						
						0+65.5	#199		715 W. Douglas		9-8-60	6-8-36
						0+39.5						
0	112.15	107.45	4.70	0+0		0+14.5	#198		715 W. Douglas			6-8-36
1	112.35	107.55	4.80	1+19.3 (o.H.)	1+12	1+09.5			701 W. Douglas		3-17-77	7-22-26
					0+89	0+86.5						
					0+66	0+63.5	#5535	#455	711 W. Douglas	125	3-27-78	7-29-10
					0+40	0+37.5	#1183		705 W. Douglas		10-31-38	
0	112.15	107.45	4.70	0+0	0+14.5	0+12		#295				2-26-23
10	112.00	107.28	4.72		10+62.9	10+43						
						10+25						
						9+99.5						
						9+74						
						9+61						
9	111.95	107.18	4.77		9+28	9+25.5	#246				5-4-09	
8	112.60	107.08	5.52			8+22.5						
						7+77	#1022	#663			8-16-22	11-9-14
					7+66.5	7+69	#16966				1-17-63	
					7+44	7+41.5	#376	#946			1-30-09	5-26-19
7	112.50	106.95	4.60		7+18.5	7+16						
					6+99.3	6+73.5						
						6+71						
						6+48						
						6+21.5						
6	112.10	106.88	5.22		6+06	5+95.5	#82				3-5-09	3-26-26
						5+72						
						5+69.5						
5	112.10	106.78	5.32			4+63.5	#87				2-1-95	3-11-06
						4+40	#3229				2-28-10	8-14-15
4	112.50	106.63	5.52		4+19	4+16.5	#658	#887			10-25-09	4-19-24
						3+96						
						3+70						
						3+44.5	#657	#690			7-31-26	6-20-22
3	112.00	106.58	5.42		3+15.5	3+13						
						2+95	#123				3-25-09	10-26-14
						2+72						
						2+46	#236				4-30-09	7-18-74
2	111.70	106.48	5.22		2+20	2+17.5						
						1+96.5	#1491				10-9-23	6-10-25
						1+66						
						1+50						
						1+26	#666	#812			7-29-65	1-24-10
1	111.20	106.38	4.82			1+00.5						
						0+74.5						
0	110.60	106.28	4.32	0+0		0+44.5						

91622136701 4/29/91 303 S. Oak Boardman = Inspr 4/26/91 4" SDR35 wye 455' N
 up MH in Maple 1-4" C.O 1-4' TRAP
 6x4 Reducer at wye

- 27320 (705 Burton) Jerry Boardman 3-26-94 (5/0 6" trap 70's curb)
- 63598-114 S. Osage - Al Klemm - 10-19-77 (1700.0)
- 62320-318 S. Osage - Al Klemm - 7-29-77 (2744.5) N.C.
- 61595-324 S. Osage - Al Klemm 6-13-77 (17416)
- 61596-325 S. Osage - Al Klemm 6-13-77 (17875)
- 61178-318 S. Osage 5-17-77 (3+21.5)

Tap in Lat. E. from M.H. 6+99.3 - #465 - 10-11-20
 #1954-708 W. Maple - 11-6-39 - F. LaFay - Used old connection.
 #2756-704 W. Maple - 10-10-40 - C.A. Preston - Used old connection.
 #2727-714 Burton - 10-4-40 - Simmons, Pkg.
 #768-Setting wye - 705 Burton - 4-26-54 - Art Fresser
 #3152-702 W. Maple - 2-27-41 - Harley Riggs
 #4388-Set wye - 725 W. Douglas - 3-9-53 - Rex Robertson Seal off C59013 - 20 W. Douglas 12-9-76 (0+19.0)
 #5781-Set wye - 715 W. Douglas - 5-11-53 - Rex Robertson
 #669-Use old conn. - 716 W. Maple - Joe McDonald - 5-2-56 (0+93) - This conn. was not reconnected
 #13751-733 W. Douglas Kendall King 1-10-61 (Cap M.H. 1' east of base)
 #4600-5' off 715 W. Douglas, Al Klemm 11-22-65, 0750.5