

S.S. No. 8-1908

LAT. No. 13
AND PART OF
LAT. No. 24 & MAIN J.

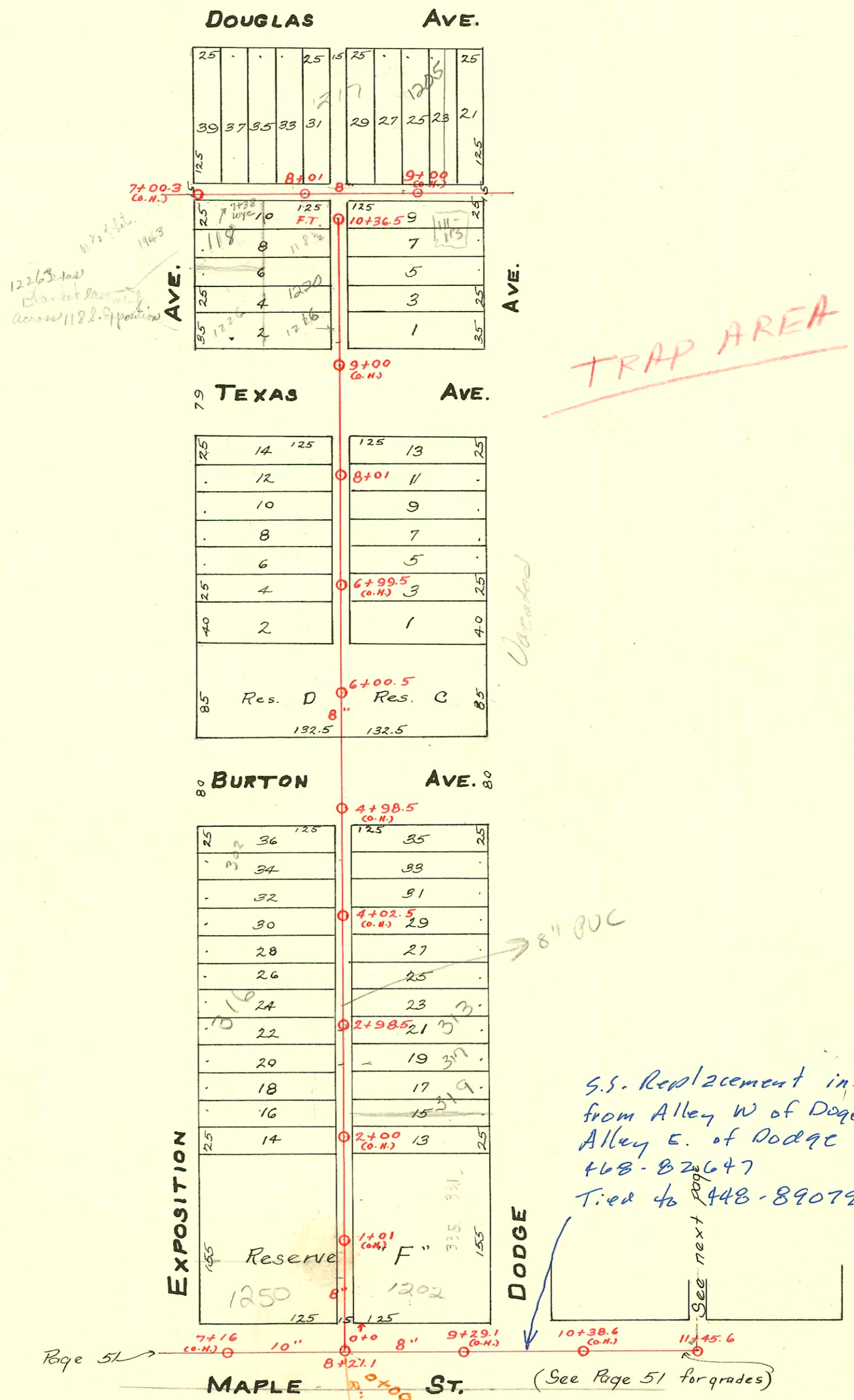

TRAP AREA

Vacated

8" POC

S.S. Replacement in Maple from Alley W of Dodge to Alley E. of Dodge
+68-82647
Tied to 448-89079

SAN SEWER-KANS MASONIC HOME
BUILT BY: UTILITY CONTR. INC.
PROJ. N^o 468-76-245-80000-000-000-008
BOOKED 10-13-81 FROM BR 17

12263 102
Blanket easement
across 1182.9 ft position

Page 51

(See Page 51 for grades)

See next page

CONSTRUCTION RECORD						SERVICE RECORD						
STATION	ELEVATION		Depth	MANHOLE	4-INCH "Y" BRANCHES		No. of Permit		House Number		DATE OF PERMITS	
	Ground	Grade			North West	South East	North West	South East	North West	South East	North West	South East
Continued Page 54												
9	112.01	106.96	5.05	9+00 (O.H.)	9+36 9+71 8+90.5 8+98.5 8+74.5 8+41 8+23	10+29 10+06 9+80 9+54 9+21.5	93-19573-7 #194 2003-00544 #253 #802	1205 S W Douglas 111-1135 Fern 1215 W Douglas	7-26-93 4-17-12 2-28-03 11-30-67 5-8-13 1-19-10			
8	111.14	106.66	4.48	8+01	7+83 7+62.5 7+49.5	7+38.5 7+16 7+11	Seal #2883 #1551	1201 W Douglas 1225 W Douglas	11-8-71 11-15-22			
7	111.89	106.36	5.53		7+27		#93		3-9-50			
10	111.05	106.83	4.22	10+36.5 FT.	10+31.5 10+08.5 9+82.5 9+56.5 9+24	10+29 10+06 9+80 9+54 9+21.5	#695 #1061 #1443	121 W Dodge	9-3-65 11-6-09 7-10-19			
9	110.78	106.63	4.15						6-24-98 10-30-22			
8	110.80	106.43	4.37	8+01	8+17.5 7+90.5 7+67 7+41	8+15 7+88 7+64.5 7+38.5	#275 #188 #1346 #272	Allison School 118 S Exposition	4-12-20 4-4-10 11-12-22	10-7-02 5-11-10		
7	110.26	106.23	4.03		6+97.5 6+55.5 6+20 5+87.5 4+62.5 4+34	6+95 6+51 6+17.5 5+85 4+60 4+36.5	#1234 #674 #1883 #92 #246 #389	3052-02740 #272 #437 #251 #601 #389	9-22-22 5-4-23 8-18-24 3-16-09 3-25-30 9-19-16	8-28-15 4-13-14		
6	110.04	106.03	4.01	6+00.5	6+20	6+17.5	#1883		8-18-24			
5	109.79	105.83	3.96		5+87.5 4+62.5 4+34	5+85 4+60 4+36.5	#92 #246 #389	301 S. Dodge 302 S. Exposition 345 S. Dodge 307 S. Dodge	10-8-14 3-25-30 9-19-16			
4	111.32	105.63	5.69		4+10.5 3+79.5 3+72 3+44	4+13 3+90 3+69.5 3+46.5	#273 #963 #14 #1060	10 S. Exposition 311 S. Dodge 313 S. Exposition 315 S. Exposition 317 S. Exposition	4-5-22 10-29-21 2-3-09 11-1-24	8-14-70 10-21-21		
3	111.53	105.43	6.10	2+98.5	3+18.5 2+98 2+65 2+42 2+13.5	3+16 2+96 2+62.5 2+39.5 2+11	#1136 #1061 #1082 #444	316 R. Exposition 317 S. Exposition	11-18-21 11-1-21 11-4-21	11-18-21 7-19-09		
2	111.33	105.23	6.10		1+88 1+62.5 1+37 1+14	1+85.5 1+60 1+34.5 1+17.5	#445 #548 #517	321 S. Exposition 315 S. Exposition	7-19-09 8-17-09			
1	110.81	105.03	5.78		0+88.5 0+63.5 0+37.5	0+86 0+61 0+35	#1320 #665	23573 #1114 #35	1202 W. Maple 120 S. Exposition 120 S. Exposition	7-20-31 10-10-22 10-27-09	7-28-13	
0				0+0 = M.H. 8+21.1 in Maple.	0+37.5 0+35	0+35	#12902		2-25-69			

SAN SEWER FOR KANSAS MASONIC HOME

0+00	110.2	104.73	5.5	EXISTING								
1+00	110.7	105.13	5.6									
	110.7	105.13	5.6	1+00.6	6" STUB SW 6" STUB SE		376 395	1211 W Maple 1211 W Maple	5-23-80 5-23-80			

2001-01750-716101-316 S. Exposition - Glover - 4" SCH 40, 4" trap, 1 twin iso, Replaced all but lower 7'

slo 1318 - (335 S Dodge) 9-22-80 Q. Henning

#C14134 Sealoff - 1226 2nd - J.C. Severn - 5-16-69 (seal approx. 7+21) - sealed into S. Exp. line at 118 S. Exp.

#C14135 Tap - 1226 2nd - J.C. Severn - 5-16-69 (relucting line) Tap (7+41.4)

2002-02738 #1369 - 1226 Texas Tap - 10-18-22 (No. 1111) - 10/4102 McClung slo 81' w of MH 8+01 (#720) + 6' from main

#171 - Masonic Home - 4-11-18 (Tap at 173' W of MH 11+456) - serves Admin of Home

#2617 - Tap - 118 S. Exposition - 1-24-46 - Davidson Pibq. No. 1111 (old pipe 7+38)

2003-00208 #986 - Tap - 1205 1/2 W. Douglas - 7-22-49 - Eugene Reynolds. 6" clay line slo 90° E of MH + 15' from main

slo 2002-02738 #7175 - Tap - (1216-18 Texas) - 1-22-52 - Simmons Pibq. No. 1111 (10/7102 McClung slo 31' W of MH 8+01 (#720) + 6' from main

#93-19573-7 - 1/2 - 1205 W. Douglas - 1/2 of 3 - Henning - 6" clay
135' E edge of alley wye 90° E of x MH