

# S.S. No. 13-1909

May 9, 1922 #864

Easement or Indenture: Between The Sisters of Charity of the Blessed Virgin Mary of St. Joseph, Dubuque County, Iowa, a corporation in the County of Dubuque and State of Iowa, party of the first part, and the City of Wichita, Sedgwick County, Kansas, of the second part - over the following described land in Sedgwick County, Kansas, to wit: A strip of ground twenty (20) feet wide, five feet east and fifteen (15) feet west of the west line of the S.E. 1/4 of Sec. 24, Twp. 27 South, R. 1 W., of 6<sup>th</sup> P.M., from the north line of Douglas Ave. to the south line of West First St., as shown by the recorded plat, in the City of Wichita, State of Kansas; and granted to the said party of the second part, the City of Wichita, its agents, servants and licensees, such right of way for the purpose of laying, constructing, and maintaining water, sewer, electric and gas lines over and upon the above described property, together with the uses incident there to.

Signed: The Sisters of Charity of the B.V.M. of St. Joseph, Dubuque Co., Iowa  
 By Mother Mary Isabella Kane - Pres.  
 Sister Mary Crescentia Markey, Secy.

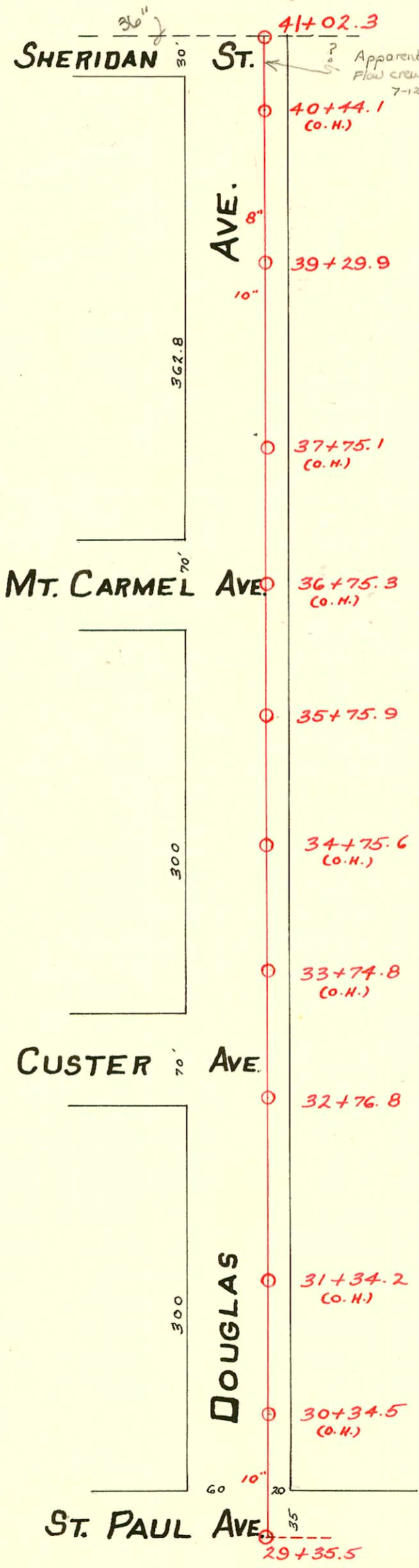

SCALE 1" = 100'

CONSTRUCTION RECORD					SERVICE RECORD							
STATION	ELEVATION		Depth	MANHOLE	4-INCH "Y" BRANCHES		No. of Permit		House Number		DATE OF PERMITS	
	Ground	Grade			North West	South East	North West	South East	North West	South East	North West	South East
<i>Note: Plat on Page 75</i>					<i>Lot. 22 - Dist. C - S.S. #20.</i>							
0+0	102.4	92.30		0+0								
					0+68.4 N.		#30		1955 Silver		4-19-49	
1+0	102.0	92.40										
				1+57.2								
					1+96.0 W.							
2+0	99.9	92.60			2+24.0							
					2+48.5							
					2+74.0							
					2+97.0		#5116		1951 Silver		5-6-53	
3+0	99.3	92.70			3+21.4							
					3+46.8							
					3+73.0							
					3+99.0							
4+0	99.6	92.80										
					Riser #1937 4+14.4 N		#1363 #2346		1937 Silver		7-3-84 10-22-45	
					4+50.0		12430		1937-39 Silver		10-21-54	
				4+60.0								
					Riser 4+82.4		#2376		1929 Silver		10-31-45	
5+0	99.7	92.90			5+05.0							
					5+31.0 Riser #1917		#1165		1917 Silver		12-23-46	
					5+55.0							
					5+82.6							
6+0	99.8	93.00			6+06.0							
					6+30.5							
					6+55.2							
					6+79.8							
7+0	99.9	93.10										
					Riser #1907 7+13.8		#3527		1907 Silver		12-28-50	
					7+29.5							
					7+46.0		2005-0345		1901R Silver		12-16-05	
					7+71.0		#6381				11-5-51	
7+77.0	99.7	93.18		7+77.0								
<hr/>												
				41+02.3								
41	114.80	112.05	2.75									
				40+44.1 (O.H.)								
40	114.30	111.95	2.35									
				39+29.9								
39	114.22	111.85	2.47									
				38								
38	114.22	111.75	2.47									
				37+75.1 (O.H.)								
37	113.72	111.65	2.07									
				36+75.3 (O.H.)								
36	113.86	111.55	2.31									
				35+75.9								
35	113.96	111.45	2.51									
				34+75.6 (O.H.)								
34	113.76	111.35	2.41									
				33+74.8 (O.H.)								
33	113.96	111.25	2.71									
				32+76.8								
32	113.96	111.15	2.81									
				31+34.2 (O.H.)								
31	114.06	111.05	3.01									
				30+34.5 (O.H.)								
30	113.86	110.95	2.91									

#261-3107 W. Douglas - Special Permit - 4-6-26 - 4" Clay s/c 122' 2" (H)  
 #666-2911 W. Douglas - Special Permit - 7-29-21  
 #632 - Kansas Sanitarium - 7-22-21  
 #1193 - Kansas Sanitarium - 8-29-19