

S.S. No. 14-1909
DIST. Y- S.S. No. 20-1920

TRAP AREA

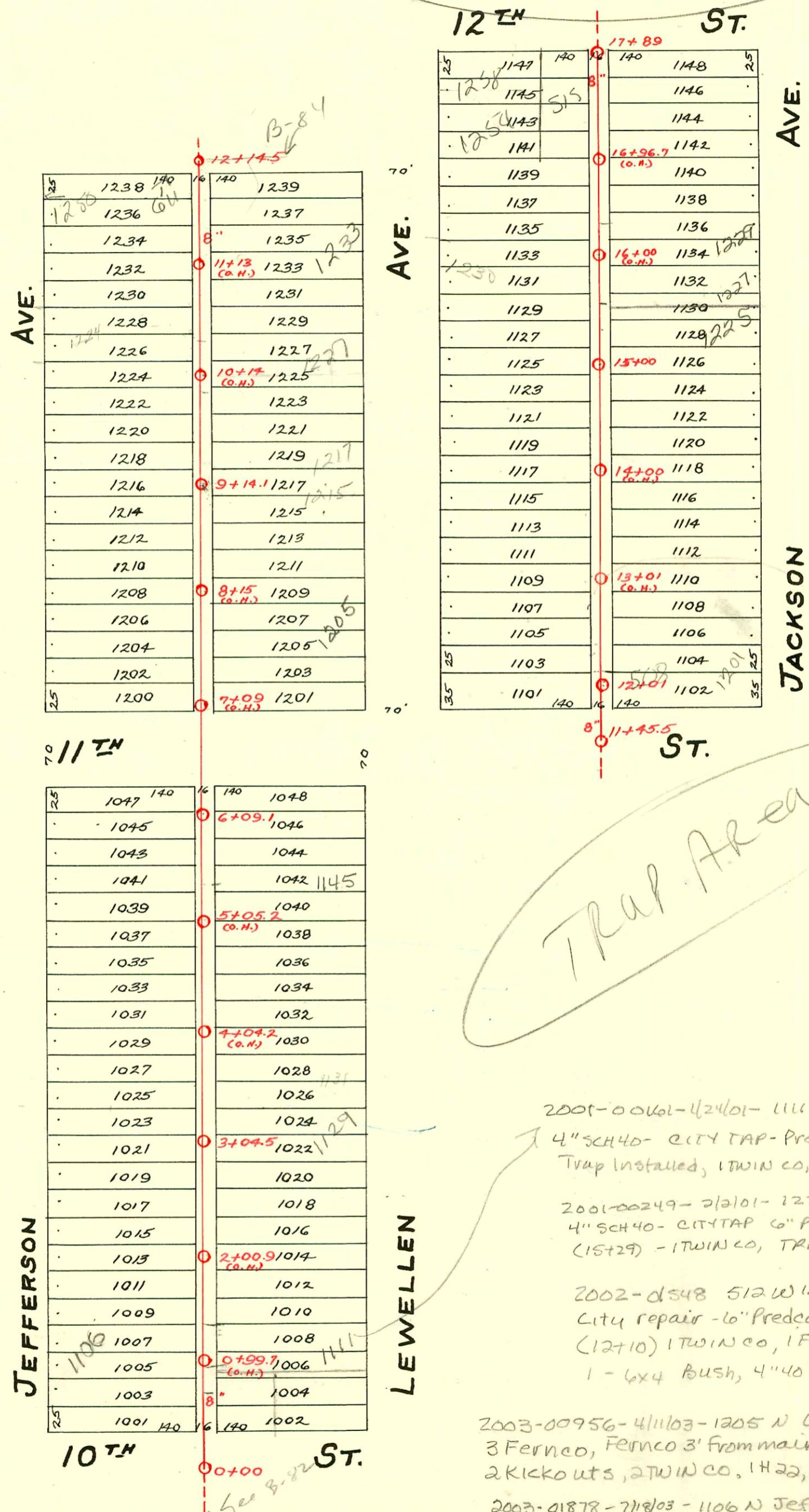

Trap Area

- 2001-00061-42401- 111 N Lewellen- Padgett Ex
4" SCH40- CITY TAP- Predco- 133.6' N of MH 0700
Trap installed, 1 TWIN CO, 1V22, 1H22
- 2001-00249- 21201- 1225 Jackson- BILEXC-
4" SCH40- CITY TAP 6" Predco 29' N of MH 15700
(15+29) - 1 TWIN CO, TRAP INSTALLED,
- 2002-d548 512 W 12th- Wichita Exc-
City repair - 6" Predco- 64.5' N of MH 11455
(12+10) 1 TWIN CO, 1 Fernco, New trap, 4H45,
1- 6x4 Bush, 4" 40 PVC
- 2003-00956- 41103- 1205 N Lewellen- Aash NoLeaks-
3 Fernco, Fernco 3' from main, New trap, 1W4e,
2 Kickouts, 2 TWIN CO, 1H22, Shallow, 4" 40 PVC
- 2003-01878- 711803- 1106 N Jefferson- City wye repair-
6" Predco, 1- 6x4 Bush, 1V45, New house trap, 2 TWIN CO,
2H22, 1 Fernco, Shallow, 4" 40 PVC 95.2' N of MH
0700 (95.2)
- 2006-00582- 1102 Jefferson- (1) twin co (2) fernco (1) wsd Shallow- Reddi 2-22-06

CONSTRUCTION RECORD

SERVICE RECORD

STATION	ELEVATION		Depth	MANHOLE	4-INCH "Y" BRANCHES		No. of Permit		House Number		DATE OF PERMITS	
	Ground	Grade			North West	South East	North West	South East	North West	South East	North West	South East
				17+89	17+78.5	17+76						
					17+55.7	17+58						
					17+35.5	17+33	#386	#711			7-15-13	11-10-09
17	119.30	113.85	5.45		17+09.5	17+07	#543	#401	1254 Lewellen	1245 Jackson	5-13-29	6-29-09
					16+84.5	16+82	#978		1254 Lewellen		9-8-25	
					16+59	16+56.5		#799				3-28-19
					16+39.5	16+31		#901				12-18-17
16	117.90	113.75	4.15		16+07.5	16+05	#20		1230 Lewellen		1-17-13	
					15+83	15+80.5	#407				7-8-18	
					15+56.5	15+54	#653	#414			8-24-20	4-22-25
15	117.40	113.65	3.75	15+00	15+31.5	15+29	#895	?	1222 Jackson	1225 Jackson	12-17-20	Homeowner advised 3-11-28 re 11-27-28
					15+08.5	15+06	#886				12-10-20	
					14+82	14+79.5						
					14+56.5	14+54	#293	#468			5-29-13	10-4-23
					14+31	14+28.5	#280		1215 Lewellen		5-12-09	
14	116.70	113.55	3.15		14+05.5	14+03						
					13+80		#1125				8-31-22	
					13+55	13+77.5		#1013		1217 Jackson		9-18-28
					13+29	13+52.5		#649				11-14-18
13	117.10	113.45	3.65		13+04.5	13+26.5		#891				11-22-11
						12+99						
					12+78.5	12+76	#1726		1214 Lewellen		11-22-23	
					12+52.5	12+50	#264	#712	1210 Lewellen		5-7-09	12-4-14
12	117.10	113.35	3.75	12+01	12+27.5	12+25	#372	#404	1202 Lewellen		6-17-09	7-11-10
					11+93	11+90.5						
11	117.30	113.25	4.05	11+45.5								
				12+14.5								
					11+79		#912				7-27-22	
					11+74	11+71.5	#965	#986	1239 Lewellen		8-8-22	8-11-22
					11+48.5	11+46	#428				7-14-14	
11+47	120.44	114.00	6.44		11+22.5	11+20		#136				1-25-23
					10+97.5	10+95						
					10+72.5	10+70	#40209		1224 Jefferson		7-24-23	
					10+50	10+47.5		#227				4-15-10
					10+26.5	10+24	#263		1228 Jefferson		3-29-29	
10+47	119.74	113.90	5.84		10+01.5	9+99	#1092	#989	1224 Jefferson	1225 Lewellen	11-5-24	2-16-59
					9+76.5	9+74	#349	#1231	1220 Jefferson		7-23-12	9-22-19
					9+31	9+28.5						
					9+25.5	9+23						
9+47	119.14	113.80	5.34	9+14.1	9+01	8+98.5	#879	#486	1216 Jefferson		See #98 12-1-17	6-10-20
					8+76	8+73.5	#68		1214 Jefferson		3-20-12	
					8+50.5	8+48						
					8+25.5	8+23	#444				7-19-18	
8+47	117.44	113.70	3.74		8+00	7+92.5	#840	#534	2003 Jefferson	1205 Lewellen	See next pg 10-17-11	4-11-03 11-18-12
					7+74.5	7+72	#869		1206 Jefferson		10-11-26	
					7+49.5	7+47	#2016	#249	622 W. Jefferson		8-18-50	4-28-10
7+97	116.31	113.60	3.31		7+24.5	7+22		#610				11-16-10
6+47	116.81	113.50	3.31	6+09.1	6+23.5	6+21						
					5+99	5+96.5	#912	#47			5-15-19	2-1-10
					5+73.5	5+71	#677	#745			11-16-14	9-20-21
					5+48.5	5+46	#913		2401-01395 Lewellen		6-6-01 9-29-21	
5+47	117.61	113.40	4.21		5+23	5+20.5						
					4+98	4+95.5	#720	#279			12-22-14	7-10-6
					4+72.5	4+70	#895	#409		1137 Lewellen	9-27-21	7-23-13
					4+47.5	4+45						
4+47	117.38	113.30	4.08		4+22.5	4+20						
					3+97	3+94.5	#1141	#144		1135 Lewellen	8-11-19	4-7-15
					3+71.5	3+69		#857		1131 Lewellen		9-19-21
					3+46.5	3+44	#587		1142 Jefferson		9-15-09	
3+47	116.88	113.20	3.68	3+04.5	3+21	3+18.5	#317				5-22-14	
					2+94.5	2+92		#116		1129 Lewellen		3-31-16
					2+69.5	2+67	#140				4-19-16	
					2+44	2+41.5		#1				1-2-14
2+47	117.08	113.10	3.98		2+21	2+18.5	#724				8-13-21	
					1+98.5	1+96						
					1+73.5	1+71		#324				6-2-09
					1+48	1+45.5						
1+47	116.88	113.00	3.88		1+22.5	1+20	#1743	#493	1106 Jefferson	610 W. 10th Jefferson	7-18-03	7-28-39
					0+97.5	0+95	#964				9-21-41	8-7-09
					0+72.5	0+70		#347				7-14-15
0+0					0+47	0+44.5	#1662				12-5-22	

Top #124-1211 Jackson - 2-26-29 - Preston Pibq.
 Tap #660-612 W. 11th - 8-12-48 - Riggs Pibq.
 8862 Tap 1217 Lewellen 1-13-59 See 7th Ward in MH 914. 1
 8861 Tap 1215 Lewellen 1-13-59 See 7th Ward 8+98.6 (See 6 on 8 way to dy.)
 Repair 27332-1227 Lewellen - 3-29-91 - R.D. Campbell (10+46.1 tap 6x4 Gasket)