

LAT. D - DIST. C - S.S. No. 20
1913

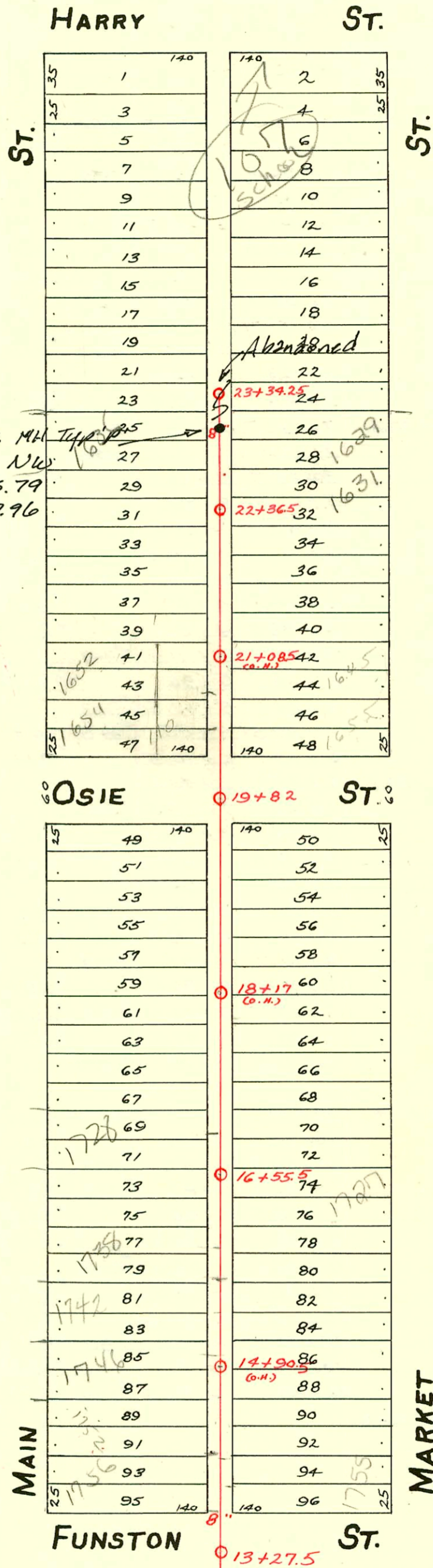

23+06.3 MH Top 105.79
6" stub NW
Flow 97.96

S.S. plans for Harry Street Elementary School
Proj. No. 1219 PPS
Built By Boardman Enterprise
Booked 8/20/02 As Built

16+88.5
16+55.5

CONSTRUCTION RECORD							SERVICE RECORD					
STATION	ELEVATION		Depth	MANHOLE	4-INCH "Y" BRANCHES		No. of Permit		House Number		DATE OF PERMITS	
	Ground	Grade			North West	South East	North West	South East	North West	South East	North West	South East
13	102.65	96.60	6.05	13+22.5	13+62	13+59.5	#179				3-11-20	
14	102.75	96.72	6.03		13+87.5	13+85	#1384		1751 S. Market		6-12-24	
					14+12.5	14+10	#193	#327	1751 Market		3-18-20	4-17-22
					14+38	14+35.5						
					14+63	14+60.5	#1090	#1025	1746 S. Main	1751 S. Market	5/26/22	10-25-21
15	102.88	96.84	6.04		14+97.5	14+86						
					15+13.5	15+11						
					15+39	15+36.5	#12					
					15+64.5	15+62						
					15+89.5	15+87	#450	#553			5-25-21	9-16-18
16	102.55	96.96	5.59		16+15	16+12.5	#195					4-27-15
					16+37.5	16+35						
					16+55.5							
					16+63	16+60.5	#902	#479			12-22-20	4-5-23
17	102.43	97.08	5.35		16+88.5	16+86	#167	#449			9-9-22	3-30-23
					17+13.5	17+11	#190				3-19-21	
					17+39	17+36.5						
					17+64	17+61.5	#410	#435				4-24-23
					17+89.5	17+87			1711 S. Market		5-16-21	7-15-14
18	102.75	97.20	5.55		18+14.5	18+12	#592	#88			3-27-24	3-21-16
					18+40	18+37.5	#690	#390	1706 S. Main		7-22-24	9-8-78
					18+65	18+62.5	#936	#7832		1703 S. Market		9-20-16
					18+90	18+87.5	#2679	#309	106 E. Osie	1701 S. Market	4-24-24	12-18-74
19	103.07	97.32	5.75		19+12.5	19+10					12-9-24	5-24-18
					19+33	19+30.5						
					19+82							
20	103.13	97.44	5.69		20+18.5	20+16	#354	#1178			3-9-23	8-7-23
					20+43.5	20+41	#384				3-19-23	
					20+69	20+66.5				1655 S. Market		11-18-25
					20+94	20+91.5						
21	103.81	97.56	6.25		21+19	21+16	#386				3-19-23	
					21+44	21+41.5						
					21+69.5	21+67						
					21+95	21+92.5	#2317		1642 S. Main		10-15-24	
22	104.36	97.68	6.68		22+20.5	22+18	#275				4-5-22	
					22+36.5							
					22+46	22+43.5	#2316		1638 S. Main		10-15-24	
					22+71	22+68.5						
					22+96	22+93.5	#1058					1-24-02
23	104.59	97.80	6.79		23+26.5	23+24	#418				5-8-24	8-20-15
					23+29	Y Straight up						
					23+34 1/4	23+15.85	#0197					8-27-80

SWR 2003-0069 3-11-03 1636 S Main USD 259. Slo with concrete 12' s of MH 23106.3 (22+94.3)

slo 2002-00221-1631 S Market 1/4" dia AE Henning - sealed w/concrete 6' s of MH 23+34.3 (22+68.3)

2002-00954-44102-1738 S Main - Caster Plog - 1 Terra co, 1 Fernco, Replaced 15' of pipe @ house, Soil pipe ext. 4" 40 PVC shallow

2002-00222-124102-1629 S Market - AE Henning - Slo w/concrete 30' s of MH 23+34.25 (23+04.25)

07-210-7 2-18-97 1752 S. Main - Padgett - 4" PVC up
96-17954-7 1024-96 1746 S. Main - New Conn - wye 14+97.5

#174- Tap - 5-10-22 - ? Scholt