

S.S. No. 16 - 1910
Dist. Y - S.S. No. 20 - 1920

TRAP AREA

2003-01205-5/6/03- 723 N Wabash
Jones Swr - 1 trap (requested by SWR
Maint) avaa, 1422, 6" Predco by city
108.2' E of MH 1475 (3403.2) city
Wye repair

Sewer Rehab & Mosley Relief Sewer
Dist 1 & 20, North of Douglas
468-80-990-80271-000-000-001
Built By Stannard Const.
Booked 8-8-85 From As Built

92-43062-7 11-23-92 109 E Murdock (Henny)
87 ft E. of M.H. (47 ft. off main) 7465.2

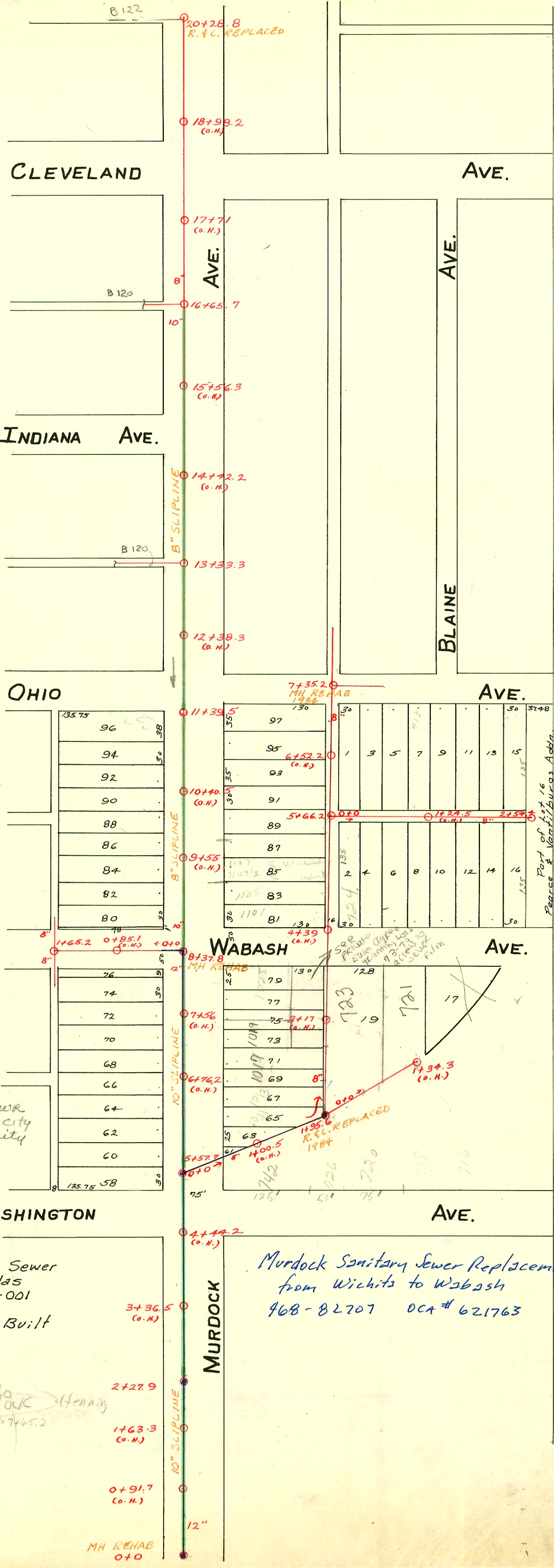

Easement #804 - Apr. 14, 1920 - Geo. H. Siedhoff & L. Siedhoff, his wife
to City of Wichita - R/W 10 ft. wide - Lots 2 to 14, Wabash Ave.,
Tillinghast's Addn.

Murdock Sanitary Sewer Replacement
from Wichita to Wabash
468-82707 OCA # 621763

MH REHAB
0+0

CONSTRUCTION RECORD

SERVICE RECORD

"A"
MAIN

STATION	ELEVATION		Depth	MANHOLE	4-INCH "Y" BRANCHES		No. of Permit		House Number		DATE OF PERMITS	
	Ground	Grade			North West	South East	North West	South East	North West	South East	North West	South East
0	112.68	106.67	6.01	0+00								
1	112.05	106.75	5.30									
2	112.27	106.83	5.44	2+27.9								
3	112.27	106.91	5.36									
4	112.54	106.99	5.55									
5	113.06	107.07	5.99	5+57.7	5+52		#25017 #495		1004 1002 E Murdock		3-24-90 2-21-47	
6	111.73	107.20	4.53		5+72 5+97.5 6+23.0 6+48.5 6+74.0		C38443 #1166		1008 E Murdock		4-20-73 8-20-19	
7	111.83	107.40	4.43									
8	111.91	107.60	4.31	8+37.8								
9	112.45	107.99	4.46		9+91.5							
10	112.49	108.09	4.30		10+15.5 10+44.0 10+49.5 10+75.0		5652 #1376 9721 C74568 #2424		1122 E Murdock 1120 E Murdock 1122 E Murdock		7-7-83 10-19-22 11-29-83 10-7-79 5-11-48	
11	112.59	108.19	4.40	11+39.5	11+05.5		#206 C36047		1126 Murdock 801-811 Ohio		3-23-20 11-21-72	
12	112.69	108.29	4.40									
13	112.74	108.39	4.35	13+33.3								
14	112.83	108.49	4.34									
15	112.76	108.59	4.17									
16	112.86	108.69	4.17	16+65.7								
17	112.81	108.79	4.02									
18	112.76	108.89	3.87									
20	113.16	108.99	4.17	20+28.8								
0	112.03	107.93	4.10	0+00								
1	112.43	108.03	4.40	1+65.2								
0	112.06	107.60	5.00	0+00								
1	111.40	107.70	3.70		1+15.6 1+49.5 E		#1377		1009 E Murdock		6-27-71 10-19-22	
2	111.90	107.80	4.10	1+95.6	2+02 2+20 2+32.5 2+53.5 2+79.0		C3349 #490 #1029		1015 E Murdock 1015 E Murdock		4-1-67 8-19-10 6-27-19	
3	112.50	107.90	4.60		3+04 3+29.5 3+55.5	3+06.5	C6648 93489 #401 #401		1015 E Murdock 1021 E Murdock 1025 E Murdock		1-29-68 (see below) 3-12-93 5-12-21	
4	111.80	108.00	3.80		4+32 4+62 4+95		9178 #1314 #1370		1101 E Murdock 1105 E Murdock 1107 E Murdock		9-18-83 10-9-22 5-12-75 9-17-23	
5	111.90	108.10	3.80		5+23.5 5+66.2 5+53.5 5+92	5+07.6	#478	C3493	1124 Murdock		4-9-67 8-10-14	
6	111.96	108.20	3.76		6+01 6+19.5		8650 #851 853		1122 E Murdock 1125 E Murdock		7-7-83 7-7-83 11-19-20	
7	112.26	108.30	3.96	7+35.2	7+66		#841				11-12-20	
0	111.97	107.79	4.18	0+0		0+51 0+76.5						
1	112.37	107.89	4.48			1+04.5						
	112.07	108.065	4.005	1+34.3 (O.H.)		1+30.0	#46		721 Wabash		1-10-23	
0	111.86	108.16	3.70	0+00	0+12.5 0+37.5 0+63.5 0+86.0	0+15.0 0+40.0 0+66.0 0+88.5	#1328 #4878 #1395		723 710 Ohio		12-22-64 6-5-51 9-21-23	
1	111.16	108.36	2.80		1+09.0 1+35.0 1+60.5 1+86.0	1+11.5 1+37.5 1+63.0 1+88.5	#1651 #14409 #1427		713 Ohio 711 Ohio 709 Ohio		11-21-66 11-9-23 6-18-68 7-17-24 6-18-24	
2	111.86	108.56	3.30		2+10.5 2+36.0 2+49.5	2+13.0 2+38.5						
	112.16	108.67	3.49	2+54.4 (O.H.)								
	C74569	1115-17 E. Murdock		Seal off - 10-1-79 (5+92.9)								
	C20679	731 Wabash		Seal off - at Henning 8-25-70 (3+23.6)								

#2657 - Private line - 714 N. Washington - 2-5-46 - C. Frank McCoy. (Seal off C3489-714 N Washington only) 6-12-67
 #2840 - Tap - 1019 E. Murdock - 12-14-49 - J. N. Hanna. (See Book A 411) Luningger Pllgy.
 #4714 - Tap - 720 N. Washington - 4-3-53 - C. G. Coleman.
 #453 - 6" in 8" pipe - 726 Wabash - 10-9-27 - 11-20-27 - 1+24 in alley back of wabash
 #1735 Seal off - 726 Wabash Lower - Pllgy. 5-4-69
 L.O. # C31838 - 916 N. Washington - 4/25/72 - for spreading (1+28.3) #25924-819/90 - 1017 E Murdock - NIC - (2+41.0 JWB)
 #91-36255-7 - 1025141 - 1015 E Murdock (50' E. of MT)
 #93-4809-7 (2/12/93) 1021 E. Murdock - 4" ABS 40 - tied back into original sewer line at Seal off 5