

DIST. A-S.S. No. 4
1922

M.H. is 5' East of
W. Prop. line of Hydraulic

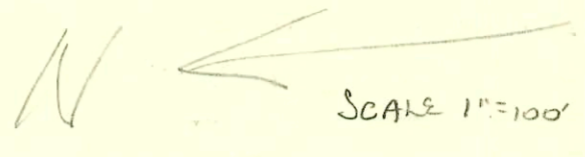

D3 27' 0+0
HYDRAULIC AVE.

231
231
229
227
225
223
221
219

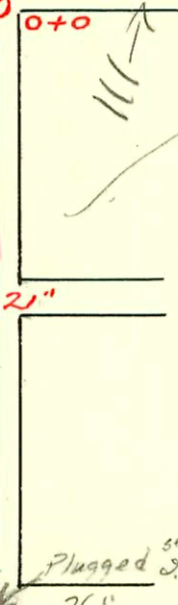

36" 36"
GREENWOOD (was Fannie) AVE.
3+39.4

217
215
213
211
209
207
205
203
201
199
197
195

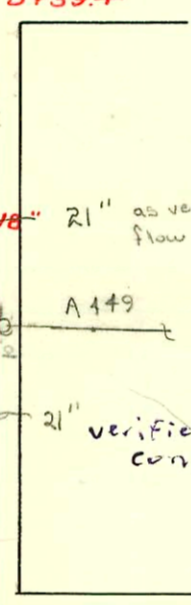

21" as verified by flow crew 8-22-78
re-verified as 21" by CIPP contractor - LML 3-31-11
A 449
21" verified as 21" by CIPP contractor - LML

82.7 7+02
ELLIS AVE.

185
183
181
179
177
175
173
171
169
167
165
163

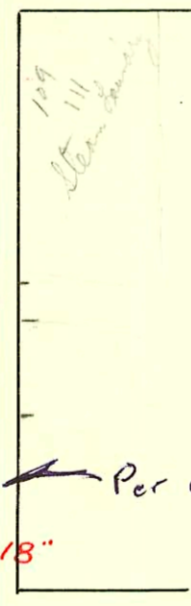

Per CIPP contractor, this is 21" also - LML 3-31-11

10+81.4
LULU AVE.

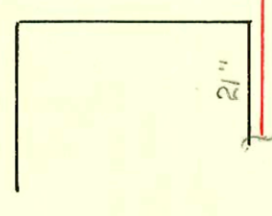

Note: Sewer Maint. crew did Dye Test & PU of Main on 8/12/2001. Following connections confirmed.

1601 E. Douglas
Tap at 297' w of
MH 0100 (5547-409)
111 S. Hydraulic
Tap at 70' w of
MH 0100 (5547-409)

Normal
Sanitary
K.P.

B 208

CONSTRUCTION RECORD

SERVICE RECORD

Note:
X's Marked
"Connected"
were connected
at time sewer
was laid.

STATION	ELEVATION		Depth	MANHOLE	4-INCH "Y" BRANCHES		No. of Permit		House Number		DATE OF PERMITS	
	Ground	Grade			North West	South East	North West	South East	North West	South East	North West	South East
0+0	108.50	98.13	10.37	0+0	0+29							
					0+51.4							
					0+76.7							
1+0	108.67	98.23	10.44		1+02							
					1+25			#276				2-25-24
					1+50.3							
					1+74.4							
					1+98.6							
2+0	108.49	98.33	10.16		2+21.4							
					2+44.5							
					2+66.7							
					2+89.4			#1380				6-12-24
3+0	108.42	98.43	9.99		3+77.5							
4+0	108.46	98.53	9.93		4+01			#844	1529 E. Douglas			9-11-30
					4+27							
					4+51.7							
					4+77			#845	1529 E. Douglas			9-11-30
5+0	108.24	98.63	9.61		5+02.6							
					5+28							
					5+53							
					5+78.4							
6+0	108.11	98.73	9.38		6+03.5							
					6+29			#735	1501 E. Douglas			5-15-23
7+0	108.86	98.83	10.03	7+02	7+50							
					7+80							
8+0		98.93			8+02.7							
					8+40.3							
					8+78.5							
9+0	108.66				8+98.4							
9+21		99.03	9.63		9+21.4							
					9+46							
					9+74.3							
					9+94.5							
10+0	108.66	99.13	9.53		10+38.4			#24943				
					10+76			#1065	1401 E. B. Douglas			2-16-20 9-28-25
10+81.4	Flo out 99.22			10+81.4	10+76							
	Flo in 99.47				See preceding page.							

This line does not require trap

2001-01044-4/30/01-1425 E Douglas - Betzen Trenching - 4" sch 40 - City Tap, Predco 53.6' w of MH, Trap installed, 17WINCO, Run to within 4' of Bldg & capped off with sch 40 PVC cap

- #1907-111 S. Hydraulic - 9-8-54 - Cowan P lbg. Co - 9-8-54 -
- Tap - #131 - 1409 E. Douglas - 2-27-30 - C. Frank McCoy.
- Tap - #485 - 1421 E. Douglas - 5-10-30 - F. X. Hoff & Son.
- Tap - #546 - 1421 E. Douglas - 5-28-30 - F. X. Hoff & Son.
- Tap - #600 - 1617 E. Douglas - 6-13-30 - I. C. Hendrick.