

Underground Utilities:
 Water Co. Control Cables

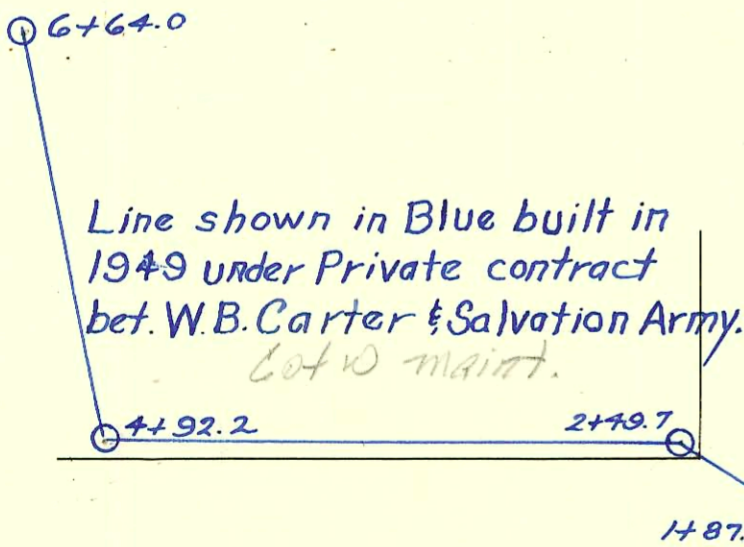

3-29-96
 MH 31+20.5 could be
 in wrong location
 entire lot location
 maybe wrong
 Per KDCan sheet 31+20.5 MH
 is located several ft W of
 D.P.E. of 1239. Legals show
 addresses in correct
 locations.

CONSTRUCTION RECORD

SERVICE RECORD

Salvation Army Private Line.

STATION	ELEVATION		Depth	MANHOLE	4-INCH "Y" BRANCHES		No. of Permit		House Number		DATE OF PERMITS	
	Ground	Grade			North West	South East	North West	South East	North West	South East	North West	South East
0+0		115.62	3.70	0+0								
1+0		115.72	3.25									
1+87.5		115.81	3.46	1+87.5								
2+0		115.82	3.47									
2+49.7		115.87	2.82	2+49.7								
3+0		115.92	3.04									
4+0		116.02	2.64									
4+92.2		116.11	2.44	4+92.2								
5+0		116.12	2.35									
6+0		116.22	3.44									
6+64.0		116.29	3.70	6+64.0								

37	124.02	117.30	6.72	37+32.9	36+91	36+88.5						
					36+66	36+63.5	#979		1355	Ferry		11-9-27
					36+41	36+38.5						
36	123.50	117.10	6.40		36+15.5	36+13			1329	Ferry		4-3-50
					35+88.5	35+86	#283		1330	Amidon		8-25-49
					35+63.5	35+61	#1363		1317	Ferry		2-19-25
					35+38.5	35+36	#92		1315	Ferry		9-26-25
35	122.41	116.91	5.57		35+10.5	35+08	#1063					
					34+85.5	34+83						
					34+60.5	34+58	#2056	#1579	1922 W.	12th		10-15-49
					34+35.5	34+33						11-21-22
34	121.95	116.70	5.25	34+28.7	34+10.5	34+08	#769		1307	Ferry		7-13-25
					33+85	33+82.5						
					33+59.5	33+57	#153	#1010	1910	Woodrow		7-18-35
33	122.67	116.50	6.17		33+39.5	33+37						10-24-21
					32+61.5	32+59						
					32+36.5	32+34	#539	#822	1921 W.	12th		10-16-37
32	122.11	116.30	5.81		32+10.5	32+08	#481		1921 W.	12th		9-22-37
					31+85.5	31+83	#799	#941	1921 W.	12th		10-9-30
					31+60.5	31+58						
					31+35	31+32.5						
31	121.64	116.10	5.54	31+20.5	31+09.5	31+07	#1151	96-4334-7	1925 W.	12th		10-17-38
					30+84.5	30+82	#1612	#940	1242	Amidon		9-14-49
					30+59	30+56.5						10-9-30
					30+34.2	30+31.7						
30	120.73	115.90	4.83		30+09	30+06.5	#1786		1341	Ferry		4-22-26
					29+83.5	29+81	#2045		1235	Ferry		8-5-24
					29+61.1	29+58.6						9-9-24
					29+32.5	29+30	#1041	#327	1228	Amidon		9-3-43
29	120.40	115.70	4.70		29+08.5	29+06	#1648		1228	Amidon		8-14-16
					28+83.9	28+81.4	#273	#2779	1223	Ferry		7-17-24
					28+59	28+56.5						10-4-41
					28+33.8	28+31.3	#1366					11-11-19
28	120.32	115.50	4.82	28+04	28+11.3	28+08.8	#2086	#710	1216	Amidon		10-18-49
					27+83.5	27+81						6-22-22
					27+58.5	27+56						
					27+32.5	27+30						
27	121.26	115.30	5.96		27+07	27+04.5	#724	#92	1924 W.	11th		9-27-46
26	120.95	115.10	5.85	26+88.7 (o.h.)	26+82.5	26+80			1205	Ferry		5-17-16

2000-01150-51800-1237 N Perry Ave - Jerry Forshee - 4" SCH 40 - Repair 10' pipe toward rear of prop - 11/22

#7886 1221 Perry (Greenwood) 4-21-83
 #755 - Tap - 8-20-21
 Tap #184 - 2026 Woodman - 11-8-28 - J.E. Lansdowne
 #513 - Tap - 1357 Perry - 5-17-30 - Simmons P1b9.
 #2771 - Tap - 1210 Amidon - 12-12-49 - Simmons P1b9.
 #644 - Tap - 2050 W. 11th - Buckley Service - 8-21-63 (prim line) (4+19.2)
 #3153 - Tap - 2050 W. 11th - Buckley Service - 3-26-65 (top in man. 6+64)
 #13539 - 2050 W. 11th - 4-20-83 - Buckley Service - (6+15.5) top