

DIST. 3 - S.S. No. 12
1924

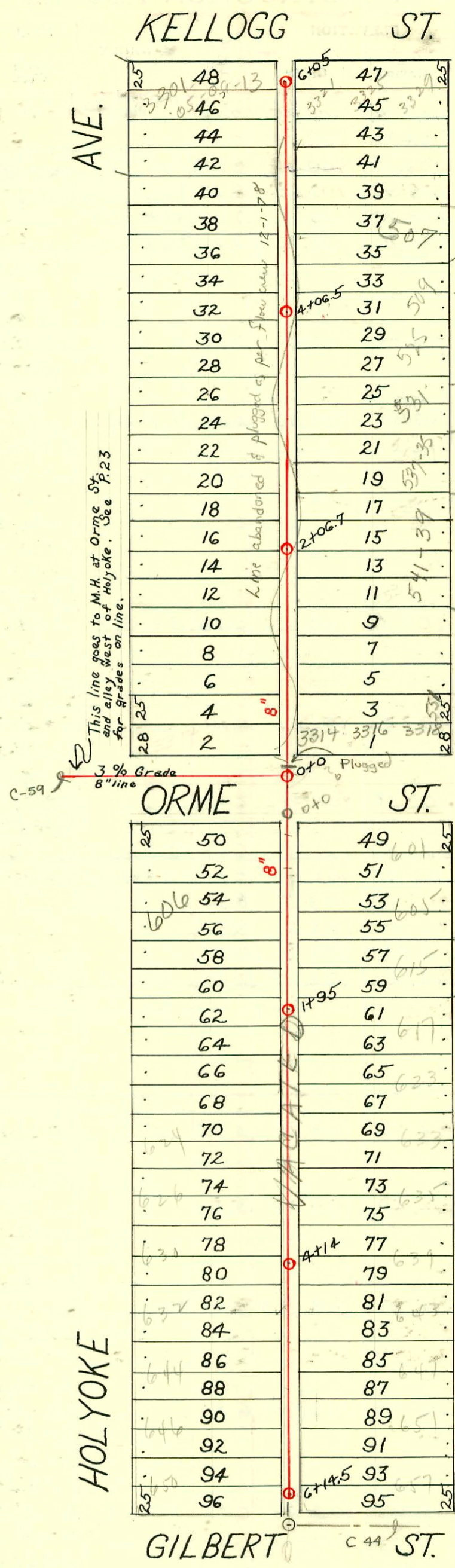

LAT. C - DIST. 1 - S.S. No. 12
1924

SO. C48305
C14252-507 Rutan - Joe Spaulding - 2-5-75
5-28-69 (top 4+94.2)

CONSTRUCTION RECORD

SERVICE RECORD

STATION	ELEVATION		Depth	MANHOLE	4-INCH "Y" BRANCHES		No. of Permit		House Number		DATE OF PERMITS	
	Ground	Grade			North West	South East	North West	South East	North West	South East	North West	South East
Between Chautauque & Lorraine Gilbert to Morris	0+0	108.04	100.60	7.44	0+0	0+35.5	0+33			3017 E. Gilbert		10-28-26
						+60.5	+58	#921	706 S. Chautauque			
						+85.5	+83	#931		707 S. Lorraine		11-1-26
	1+0	107.24	100.70	6.54	1+13	1+10.5		#1623				3-18-47
						+38	+35.5			712 S. R. Chautauque	709 S. Lorraine	2-15-01
						+63	+60.5	#816	#754			9-23-26
						+83.5	+81	#133		716 S. Chautauque		2-16-28
	2+0	106.94	100.80	6.14	2+05	2+13.5	2+11			722 S. Chautauque	721 S. Lorraine	7-17-29
						+38.5	+36	#880	#1596			9-14-49
						+63.4	+61.4		#332	726 S. Chautauque	725 S. Lorraine	8-20-36
						+88.9	+86.4		#286			7-20-36
	3+0	106.68	100.90	5.78	3+14.5	3+12				730 S. Chautauque	733 S. Lorraine	3-26-30
						+39.8	+37.3	#252	#303			7-31-36
						+65	+62.5					
						+90.3	+87.8	#1187		738 S. Chautauque		11-4-38
	4+0	106.45	101.0	5.45	4+06	4+15.3	4+12.8		#519		737 S. Lorraine	11-30-36
						+40.5	+38		#313		735 S. Lorraine	8-7-36
						+70.9	+68.4	#547		742 S. Chautauque		4-27-45
						+90.8	+88.3	#286	#206	748 S. Chautauque	747 S. Lorraine	6-28-27
	5+0	106.50	101.10	5.40	5+16.2	5+13.7						4-2-30
						+40.9	+38.4		#656		751 S. Lorraine	3-8-28
	6+0	106.33	101.20	5.13		+66.5	+64					12-28-37
	6+15	106.33			6+15	+92.1	+89.6	#1839		757 S. R. Lorraine		9-16-39
						+67.9	+65.4					
Between Holyoke & Rutan - Gilbert & Orme	0+00	116.07	104.2	11.87	0+00	0+29.5	0+27			3309 E. Orme	603 S. Rutan	10-26-55
						+53.5	+51	#6807	#26		605 S. Rutan	2-4-30
						+79.7	+77.4		#811			8-19-30
	1+00	116.82	104.35	12.47	1+05	1+02.5		#2194		606 S. Holyoke		11-24-33
						+29.5	+27		#126		615 S. Rutan	9-26-24
						+54.5	+52	#2244	#1788	612 S. Holyoke	615 S. Rutan	2-26-30
					1+95	+80	+77.5	#374		614 S. Holyoke		2-5-70
	2+00	118.64	104.50	14.14	2+04	2+01.5		#2016		617 S. Rutan		4-14-25
						+29.5	2+27	#2174		620 S. Holyoke		2-25-49
						+54.7	+52.2		#1717		623 S. Rutan	9-23-24
						+79.2	+76.7					4-2-47
	3+00	118.59	104.65	13.94	3+05.5	3+03		#43	#677	624 S. Holyoke	633 S. Rutan	1-31-29
						+29.2	+26.7	#408				8-11-27
						+54.9	+52.4					5-14-26
						+80.5	+78		#1125	632 S. Holyoke	635 S. Rutan	8-22-29
	4+00	116.36	104.80	11.56	4+05.1	4+02.6		#1273		639 S. Rutan		9-12-29
						+29.5	+27	#2373		630 S. Holyoke		10-20-24
						+55.1	+52.6		#343		643 S. Rutan	7-7-47
						+80.2	+77.7					
	5+00	115.47	104.95	10.52	5+05	5+02.5		#458	#652	644 S. Holyoke	647 S. Rutan	5-2-25
						+30.5	+28	#1002	#607	646 S. Holyoke	651 S. Rutan	11-19-26
						+55.5	+53		#650	650 S. Holyoke	657 S. Rutan	9-5-46
						+80.5	+78		#1049			6-4-29
	6+00	115.05	105.10	9.95	6+05	6+02.5						8-13-29
	6+14.5	114.85	105.12	9.73	6+14.5							
Between Holyoke & Rutan - Kellogg to Orme.	0+00	116.07	109.0	7.07	0+00	0+44.2	0+46.7			3304 E. Orme		7-17-74
						+68.5	+71	#1098		556 S. Holyoke		10-5-25
						+94.3	+96.8	#430		552 S. Holyoke		4-9-25
	1+00	115.61	109.3	6.31	1+19.1	1+21.6		#248		552 S. Holyoke		4-8-27
						+44.2	+46.7	#249		548 S. Holyoke		7-17-74
						+68.8	+71.3					4-8-27
						+93.8	+96.3					
	2+00	116.58	109.6	6.98	2+06.7	2+19.5	2+22	#889		544 S. Holyoke		10-17-74
						+43.5	+46	#913		636 S. Holyoke		8-11-25
						+69.2	+71.7					8-19-25
						+94.5	+97	#384	#3325	532 S. Holyoke	535-37 S. Rutan	5-16-27
	3+00	117.04	109.9	7.14	3+19.6	3+22.1						3-6-75
						+44.5	+47	#596		526 S. Holyoke		7-17-74
						+69.6	+72.1					7-15-27
						+94.5	+97					
	4+00	117.90	110.2	7.70	4+06.5	4+19.5	4+22	#907	#933	525 S. Rutan	522 S. Rutan	7-17-74
						+44.5	+47			509 S. Rutan		1-16-75
						+69.7	+72.2	#2182		518 S. Holyoke		7-5-46
						+95	+97.5	#293	#823	514 S. Holyoke	514 S. Rutan	10-24-27
						+44.5	+47			3365 E. Kellogg		11-1-26
	5+00	118.75	110.5	8.25	5+20	5+22.5		#68		3304 E. Kellogg	3329 E. Kellogg	6-20-46
						+45	+47.5	#17	#2722			2-13-25
						+70.5	+73	#2222		3321 E. Kellogg		7-9-75
						+95.5	+98	#2721		3324 E. Kellogg		12-31-24

C48758
 #504 - Tap - 742 S. Chautauque - 5-7-29 - O. O. Oldfather
 #1519 - Private line - 3316 E. Orme - 10-23-29 - W.A. Bittrich
 #472 - Tap - 3314 E. Orme - 10-15-29 - W.A. Bittrich
 #386 - Private line - 3318 E. Orme - 7-7-31 - Wilson Pibg.
 #211 - Tap - 719 S. Lorraine - 6-12-36 - T.P. Hayes Pibg.
 #325 - Tap - 3315 E. Orme - 10-12-37 - Shellenbarger
 #873 - Tap - 602 S. Holyoke - 5-18-38 - Frederick Pibg.
 #1095 - Private line - 551 S. Rutan - 9-20-38 - C.A. Preston
 #1832 - Tap - 3017 E. Gilbert - 9-14-39 - Kansas Pibg. Co.
 #1121 - Tap - 531 S. Rutan - 10-4-48 - Nelson Pibg. Co.
 #190 - Tap - 539 S. Rutan - 3-12-56 - Al Henning