

KELLOGG ST.		ST.	
704	4401	709	1111
705		710	
706	4407	711	
707		712	
708		713	
709		714	
VACATED			
570	132	329	132
509		330	
508		331	
507		332	
506		333	
505		334	
504		335	
503		336	
502		337	
501	2+38	338	59
500		339	
499		340	
498		341	
497		342	
496		343	
495		344	
494		345	
493	132	346	132
ORME			
492	132	347	132
491		348	
490		349	
489		350	
488		351	
487		352	
486		353	
485		354	
484		355	
483		356	
482		357	
481		358	
480		359	
479		360	
478		361	
477		362	
476		363	
475		364	
474		365	
473		366	
472		367	
471		368	
470		369	
469	132	370	132
FOUNTAIN		BROADVIEW	
GILBERT ST.		ST.	

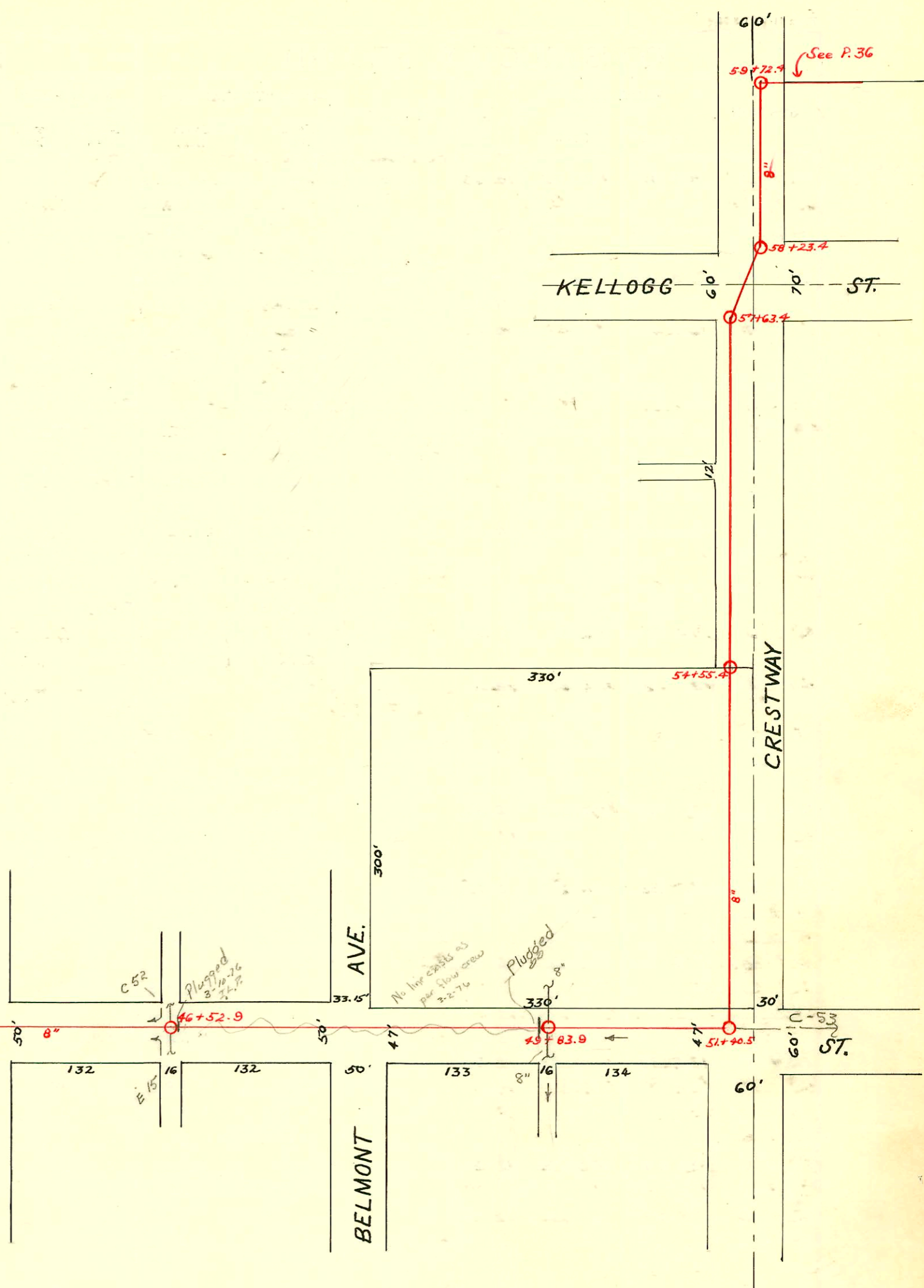

DIST. 6 - S.S. #12
A. A. Dobson - 1927

2003-01038 4/17/03 605 S Broadview - A Good Pibr - City wye repair
 4" Predco 80' N of MH 11405 (11785) 4" PVC 2V45
 2003-00974 4/15/03 608 S Fountain - A Good Pibr - City wye repair
 4" Predco 82' N of MH 11405 (11785) 4" PVC 2 dir. cl. 1V22, 2H45.
 2003-01334-5/19/03 - 615 S Broadview - McClung - City wye
 repair 38' N of MH 11405 (11743) 4" Predco, 4" PVC - (twin) co,
 1V45, 1V22

CONSTRUCTION RECORD

SERVICE RECORD

STATION	ELEVATION		Depth	MANHOLE	4-INCH "Y" BRANCHES		No. of Permit		House Number		DATE OF PERMITS			
	Ground	Grade			North West	South East	North West	South East	North West	South East	North West	South East	North West	South East
36+0	160.72	150.12	10.60	36+93.9 = 4" PVC 40 ✓ 6+66.5 use for 1/2	6+74.5	6+72	#6385		638 S. Fountain		5-30-91			
36+93.9		150.26			7+00.2	+97.7	#490			657 S. Broadview		9-27-37		
					+26.9	7+24.4			#1247 #2613 #4106	651 S. Broadview		12-6-38 8-20-41		
37+0	160.50	150.27	10.23		+51.5	+49	#1104		636 S. Fountain			9-26-38		
					+78.8	+76.3								
					8+04.5	8+02			#66	647 S. Broadview			3-6-37	
38+0	160.41	150.42	9.99		+30.2	8+27.7	#658		630 S. Fountain	637 S. Broadview		12-29-37	2-18-37	
					+55	+52.5								
					+80.5	8+78			#931	637 S. Broadview			6-21-38	
39+0	159.09	150.57	8.52	39+63.4	9+07.3	9+04.8	#2211		628 S. Fountain			10-28-64		
39+63.4					9+30	+27.5	#2285		624 S. Fountain			10-28-64		
				9+36 for 1/2	9+56.1	9+53.6	#1987	#20	633 S. Broadview			5-2-40		
40+0	160.33	150.72	9.61		9+81.5	+79	#2413	#748	624 S. Fountain	621 S. Broadview		10-14-87	1-23-37	
					10+07.2	10+04.7						11-14-49	7-24-30	
					+32.5	10+30			#52A	619 S. Broadview			12-4-36	
41+0	162.78	150.87	11.91		+58	+55.5	#971		624 S. Fountain				11-21-46	
41+32.4	163.42			41+32.4	+83	+80.5								
					11+44.5	11+09	#970		618 S. Fountain				11-21-46	
42+0	164.33	151.02	13.31	42+05 for 1/2	11+36.3	+33.8	#1033		617 S. Broadview				9-21-28	
					11+62	11+59.5	#259		615 S. R. Broadview				5-17-25	
					11+87.5	11+85	#1962	#263	608 S. R. Fountain	605 S. R. Broadview		5-4-78	3-27-30	
43+0	165.56	151.17	14.39	M.H. in Orme-Turn E.	12+13.1	12+10.6	#2655	#684	602 S. Fountain	601 S. Broadview		9-16-70	7-7-30	
43+23.4	166.05	151.21	14.83	43+23.4	+39	+36.5							7-7-30	
				12+96 for 1/2	+64.5	+62								
44+0	166.18	151.32	14.86											
45+0	165.58	151.47	14.11											
46+0	165.54	151.62	13.92	46+52.9										
46+52.9														
47+0	164.80	151.77	13.03											
48+0	163.53	151.92	11.61											
49+0	159.85	152.07	7.78											
49+83.9				49+83.9										
50+0	162.13	152.22	9.91											
51+0	163.26	152.37	10.89											
51+40.5				51+40.5										
52+0	162.11	152.52	9.59											
53+0	162.71	152.67	10.04											
54+0	164.08	152.82	11.26											
54+55.4				54+55.4										
55+0	165.20	152.97	12.23											
56+0	165.91	153.12	12.79											
57+0	166.54	153.27	13.27											
57+63.4				57+63.4										
58+0	166.47	153.42	13.05											
58+23.4				58+23.4										
59+0	166.80	153.57	13.23											
59+72.4	167.35			59+72.4										
				M.H. in Crestway - Alley N. of Kellogg. Turn East.										
LINE BET. Fountain & Broadview Orme St. North	0+0	166.56	155.0	11.56	0+0	0+26	0+23.5	#187	#426	538 S. Fountain	537 S. Broadview	6-10-47	4-24-29	
						+52	+49.5	#144		552 S. Fountain		6-7-48		
						+78.1	+75.6				551 S. Broadview		7-12-37	
						1+03.9	1+01.4		#345		545 S. Broadview		5-19-37	
						+28.5	+26		#42					
						+54.2	+51.7	#2333		548 S. Fountain	541 S. Broadview		11-4-49	
						+80.5	+78		#1313				12-13-28	
						2+05.5	2+03	#436		542 S. Fountain		8-17-31		
						+31	+28.5							
						+56.5	2+54	#806	#3	538 S. Fountain	545 S. Broadview	7-30-28	1-2-29	
						+83.8	+81.3	#969		532 S. Fountain		11-21-46		
						3+03.5	3+01		#809		531 S. Broadview		7-3-29	
						+30.5	+28	#1264		530 S. Fountain		12-3-28		
						+55.5	+53		#578		529 S. Broadview		5-20-29	
						+80.5	+78							
						4+06.5	4+04	#527	#195	522 S. Fountain	525 S. Broadview	5-9-29	6-12-48	
						+31.5	+29	#515	#941	516 S. Fountain	511 S. Broadview	5-15-28	7-29-29	
						4+79.2	+57							
LINE EAST from M.H. 4+79.2	0+0	169.57	158.36	11.21	0+0	0+24.7	North only							
						+51.2								
						1+0	1+77							
						1+25	1+?							
LINE WEST from M.H. 4+79.2	0+0	169.57	158.36	11.21	0+0	0+16.0								
						1+24.4	1+24.4							

Tap #795-4105 E. Kellogg - Simmons - 7-26-28
 Tap #512-4513 E. Kellogg - Simmons - 5-17-30 - Tap is 126.5 ft. So. of M.H. 57+63.4
 Tap #350-451 S. Crestway - Carl E. Carr - 9-2-36-3397
 Tap #449-441 S. Crestway - Cherry M. Cartney - 12-22-36 - 1896 - S/D 110' N. of M.H. #35' of main
 Tap #478-634 S. Fountain - Simmons - 9-22-37
 Tap #2295 - Private line - 703 1/2 S. Broadview - 9-19-45 - Davidson P169.
 Tap #2183 - Leford, Geo. 4145 E. Kellogg - 10-22-64 (1+19.6)
 Tap #2124 - Leford, Geo. 4145 E. Kellogg - 10-22-64 (0+47)
 Tap #44570 - Leford, Geo. 4145 E. Kellogg - 4-22-74 (0+86)
 10/14/87 - 19307 - 626 S. Fountain - Rep - (4" wye rep. 2" S. of sep. in high box Lot 10/10 S.)
 97-2947
 96-1822
 97-3197 7 315/97 4101 S. Kellogg - Hemming