

See plat 10 S3

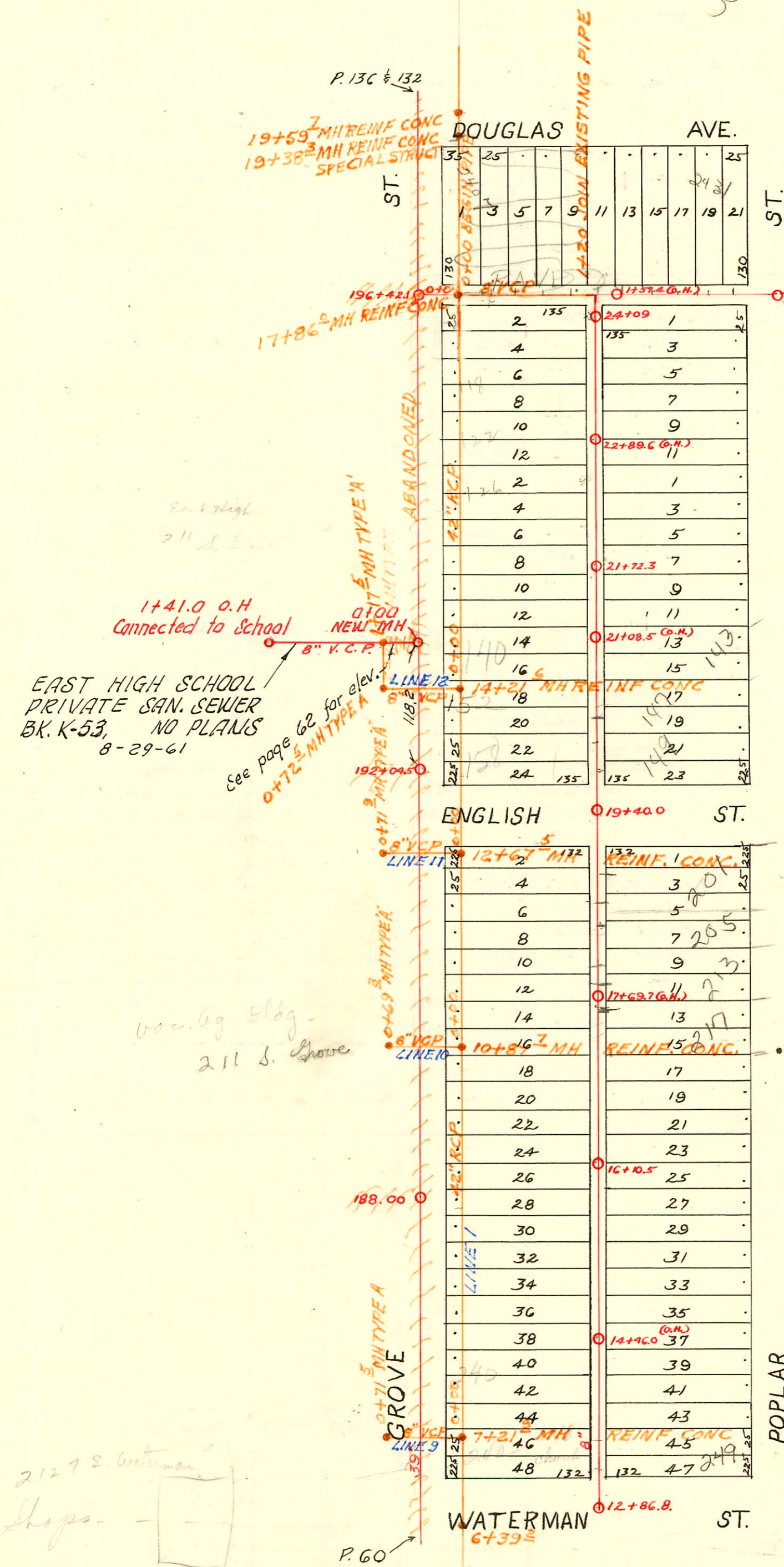

DIST. A - S.S. #12  
1912

RECON LATERALS DISTA SS N#12  
BUILT BY: UTILITY CONTR. INC.  
PROJ. N#468-76-245-80610-000-000-001  
BOOKED 3-1-80 FROM JLA #12

RECON PORTION SAN SEWER N#12  
LINCOLN TO 2ND PART A  
BUILT BY: UTILITY CONTR. INC.  
BOOKED 4-17-80 FROM DCD 36A

EAST HIGH SCHOOL  
PRIVATE SAN. SEWER  
BK. K-53, NO PLANS  
8-29-61

11+41.0 O.H  
Connected to School

See page 62 for elev.  
0+72 5 MH TYPE A

Voc. Bldg -  
211 S. Grove

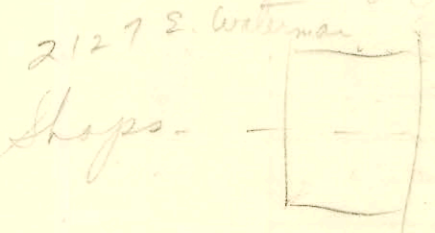

95-7112-7 4-12-95 213 S Poplar

- c66182 - 2245 Grove 5-2-78 C. L. Rutledge (16744.5)
- c 59869 - 211 from Annex Bldg to new Gymnasium 2-11-77 - Charles Bleser
- c 62734 - 2301 E. Douglas - 8-25-77 - Bldg # 605 (61.6 ft. 26 of them M.H.C.)
- c 64330 - 2201 E. Douglas - 12-6-77 old gym - Wilfred Baker (50 ft. 10 of them M.H.)
- c 64534 - 238 S. Grove 5.0 12-19-77 - Manning (14108.5)
- c 64535 - 236 S. Grove 5.0 12-19-77 - " (15101.5)
- c 64536 - 228 S. Grove 5.0 12-19-77 - " (15144.5)
- c 64537 - 208 S. Grove 5.0 12-19-77 - " (18137.0)
- c 64538 - 134 S. Grove 5.0 12-19-77 - " (22109.3)
- c 65319 - 138 S. Grove 5.0 3-13-78 - Rutledge (21156.3)

c 68122 - 126 S. Grove 5.0 8-30-78 Manning (22107.0)

CONSTRUCTION RECORD

SERVICE RECORD

STATION	ELEVATION		Depth	MANHOLE	4-INCH "Y" BRANCHES		No. of Permit		House Number		DATE OF PERMITS	
	Ground	Grade			North West	South East	North West	South East	North West	South East	North West	South East
LINE BET. Grove & Poplar - Douglas to Waterman	12+0	109.74	101.91	7.83	12+86.8	13+19.4						
	13+0	110.04	102.16	7.88	13+25.0 +50.5 +76.0	13+22.5 +48.0 +73.5 +99.0	#1390 #291	#58	248 S. Grove		3-3-79 3-3-67	11-21-19 2-13-11
	14+0	109.94	102.41	7.53	14+01.5 +26.5 +51.5 +77.0	14+01.5 +24.0 +49.0 +74.5	#1086	#228	240 S. Grove		1-19-17 7-21-19	2-11-11 3-29-11
	15+0	110.04	102.66	7.38	15+02.5 +28.0 +53.5 +79.0	15+00.0 +25.5 +51.0 +76.5	#205 #681 #824 #552	#551 #780 #296	236 S. Grove 228 S. Grove 224 S. Grove		3-25-11 9-17-17 6-19-11	11-8-15 10-24-17 5-14-14
	16+0	110.44	102.91	7.53	16+10.5 +31.0 +53.5 +81.5	16+04.0 +28.5 +51.0 +79.5	#859	#654 #572	220 S. Grove 225 S. Poplar		4-21-19	7-24-11 9-25-14
	17+0	110.57	103.16	7.41	17+06.5 +32.0 +57.0 +83.0	17+04.0 +29.5 +54.5 +80.5	#68 #222	#1904 #314	235 S. Poplar 213 S. Poplar 213 S. Poplar		2-15-11 3-27-20	8-20-24 4-13-11 4-12-95
	18+0	110.47	103.41	7.06	18+08.0 +33.5 +58.5 +83.5	18+05.5 +31.0 +56.0 +81.0	#72 #544 #541	#46 #1397	1501 W. Douglas 149 S. Poplar 158 S. Grove		3-6-18 6-13-11 8-18-59	4-12-95 5-23-16 2-8-11 4-7-42
	19+0	110.47	103.66	6.81	19+40.0 +30.5 +56.5 +81.0	19+77.0 +20.0 +54.0 +78.5	#541	#383 #1230 #149	149 S. Poplar 147 S. Poplar 140 S. Grove		11-2-15 6-27-72 9-20-19	5-20-92 4-20-11 4-25-11
	20+0	110.57	103.91	6.66	20+05.5 +30.5 +56.5 +81.0	20+03.0 +28.0 +54.0 +78.5	#503	#514 #150	143 S. Poplar 127 S. Poplar		3-26-17 6-2-11	2-22-95 5-16-11 6-23-82
	21+0	110.37	104.16	6.21	21+54.5 +81.5 +95.0	21+29.0 +29.0 +79.0	#150				3-14-11	
	22+0	110.87	104.41		22+06.5 +32.0 +57.5	22+04.0 +29.5 +55.0	#2 #436 #552	#780	122 S. Grove		1-4-16 3-31-78 6-30-27	10-16-16 9-22-11
	23+0	111.07	104.66	6.41	23+08.0 +33.5 +59.0 +84.5 +95.0	23+05.5 +31.0 +56.5 +82.0 +92.0	#1076 #378 #162 #833		118 S. Grove 115 S. Poplar 114 S. Grove		11-3-21 4-24-11 4-24-11	4-14-66 3-8-22 12-13-16
	24+0	111.57	104.91	6.66	24+09.0							
LINE IN E. & W. Alley So. of Douglas Bet Grove & Poplar.	0+0	Inside of edge of sidewalk			0+0 = 196+42.1	0+14.5 N. +40.0 +65.5 +91.0	#224 #1163	2403 E. Douglas 2403 E. Douglas			3-24-11 11-23-21	
	1+0	111.40	102.35	9.15		1+16.5 +42.5 +67.0 +94.5	#583 #189	2411 E. Douglas 2431 E. Douglas			8-14-17 4-9-17	
	2+0	111.70	102.70	9.00		2+19.5 +45.0 +71.0	#331				9-12-87	
	3+0	112.10	103.05	9.05	3+11.5							
LINE IN GROVE.	186+0	110.8	97.605	13.195								
	187+0	110.6	97.705	12.895								
	188+0	110.6	97.835	12.765	188+00							Tapped #371, 372, 373 Roosevelt School 3-14-23
	189+0	110.8	97.935	12.865								
	190+0	110.6	98.035	12.565								
	191+0	110.8	98.135	12.665								
	192+0	111.0	98.235	12.765	192+04.5							
	193+0	110.6	98.335	12.265								
	194+0	110.4	98.435	11.965								
	195+0	110.9	98.535	12.365								
	196+0	111.2	98.635	12.565	196.42.1							
	197+0	111.0	98.735	12.265								
	198+0	111.4	98.835	12.565								

#2524 - Tap - 106 S. Grove - 12-11-45 - Burgen Pibg. Co. (0+67.0) 203-31-70 Culley - 220-20 S. Grove - (3+61.5)  
 #1068 - Private line - 2407 E. Douglas - 12-10-46 - Brodie Pibg Co. (0+70.0) 50 C 70404 - 232 S. Grove 3-1-79 Hanning (15+54.5)  
 #935 - Private line - 2409 E. Douglas - 10-17-47 - Jensen Pibg Co. 50 C 70407 - 2409 E. Douglas 3-1-79 Hanning (0+70.0)  
 #645 - Used old connection - 2431 E. Douglas - 8-10-48 - Gray Bros Pibg Co. 50 C 70402 - 2401 E. Douglas 3-1-79 Hanning (0+67.0)  
 #3213 - Used old connection - 258 S. Grove - 11-28-50 - Thompson Pibg Co.  
 #7400 - Tap - 211 S. Grove - (East High School) 2-5-52 - Davidson Pibg.  
 #14575 - 2127 E. Waterman (School) Private line connection - Gray Bros. 5-13-60  
 #14544 - 211 S. Grove (East High School) 2-9-61 (New MH)  
 #44867 - 117 S. Poplar Seal off 5-14-74 - Joe Spaulding (23+56)  
 #52657 - 2801 E. Douglas - 12/3/75 - Deald Thompson  
 #56774 - 117 S. Poplar - 7-19-70 - Creek Hudson 4" tap into ground 114

SERVICE RECORD

CONSTRUCTION RECORD

DATE OF SERVICE      DATE OF CONSTRUCTION      NO. OF FEET      NO. OF FEET      NO. OF FEET      NO. OF FEET      NO. OF FEET      NO. OF FEET      NO. OF FEET      NO. OF FEET

2001-00 212-13201-249 S Poplar St - Bellows Plog - 4" SCH 40 - 1 TWIN CO, 2 Fernco to clay  
no msmt

CG1#B

Form 42-020

RECON  
PORTION  
SS N<sup>o</sup> 12  
LINE TO 2ND

CONSTRUCTION RECORD

SERVICE RECORD

STATION	ELEVATION		Depth	MANHOLE	4-INCH "Y" BRANCHES		No. of Permit		House Number		DATE OF PERMITS	
	Ground	Grade			North West	South East	North West	South East	North West	South East	North West	South East
LINE 1 5 0+62.4	108.0	96.22	11.8	Begin MH EXISTING								
1+00	108.1	96.26	11.8									
2+00	108.2	96.36	11.8									
3+00	109.0	96.46	12.5									
4+00	109.3	96.56	12.7									
5+00	109.6	96.66	12.9									
6+00	109.8	96.70	13.1	5+36.9								
	110.1	96.78	13.3									
	109.8	96.81	13.0	6+19.5								
	109.2	96.83	12.4	6+39.2								
7+00	110.6	96.91	13.7									
	110.6	96.94	13.7	7+21.9								
8+00	110.5	97.04	13.5									
9+00	110.6	97.17	13.4									
10+00	110.8	97.31	13.5									
	111.2	97.42	13.8	10+87.7								
11+00	111.2	97.44	13.8									
12+00	111.3	97.57	13.7									
	111.2	97.65	13.6	12+67.5								
13+00	110.7	97.70	13.0									
14+00	111.1	97.83	13.3									
	111.3	97.86	13.4	14+21.6								
15+00	111.6	97.96	13.6									
16+00	111.3	98.09	13.2									
17+00	111.5	98.22	13.3									
	111.7	98.33	13.4	17+86.0								
18+00	111.7	98.35	13.4									
19+00	112.3	98.48	13.8									
	111.7	98.53	13.2	19+38.3								
	111.5	98.56	12.9	19+59.7								
LINE 9 0+00	110.6	96.94	13.7	0+00=7+21.9 LINE 1 0+71.5								
LINE 10 0+00	111.2	97.42	13.8	0+00=10+87.7 LINE 1 0+69.3								
LINE 11 0+00	111.2	97.65	13.6	0+00=12+67.5 LINE 1 0+71.9								
LINE 12 0+00	111.3	97.86	13.4	0+00=14+21.6 LINE 1 0+72.5								
1+00				1+17.5 8" West								
					and inspected at street level			#00562		3301 E Douglas post Eps. High		6-13-80