

DIST. A - S. S. # 12
1912

RECONNECTIONS

STATION	ADDRESS	DIRECTION
18+90.9	202 S. Poplar	West
18+73.1	201 S. Green, Apts. 1, 2, 3	East
18+50.6	206 S. Poplar	West
18+47.9	205 S. Green	East
17+75.2	210 S. Poplar ^{4" Sch 40} _{PK}	West ²⁻²¹⁻⁹⁵
17+73.2	211 S. Green	East
17+48.3	215 S. Green	West
17+50.3	214 S. Poplar	East
16+92.6	219 S. Green	East
16+53.4	224 S. Poplar	West
16+25.8	221 S. Green	East
15+94.2	230 S. Poplar	West
15+92.1	225 S. Green	East
15+67.3	237 S. Green ^{5/0 2002-23}	East ^{124/02}
15+19.5	234 S. Poplar	West
14+93.9	238 S. Poplar	West
14+91.5	241 S. Green	East
14+43.8	242 S. Poplar	West
14+41.7	243 S. Green	East
14+18.8	254 S. Poplar	West
13+66.1	245 S. Green	East
13+41.3	258 S. Poplar	West
13+38.5	247 S. Green	East

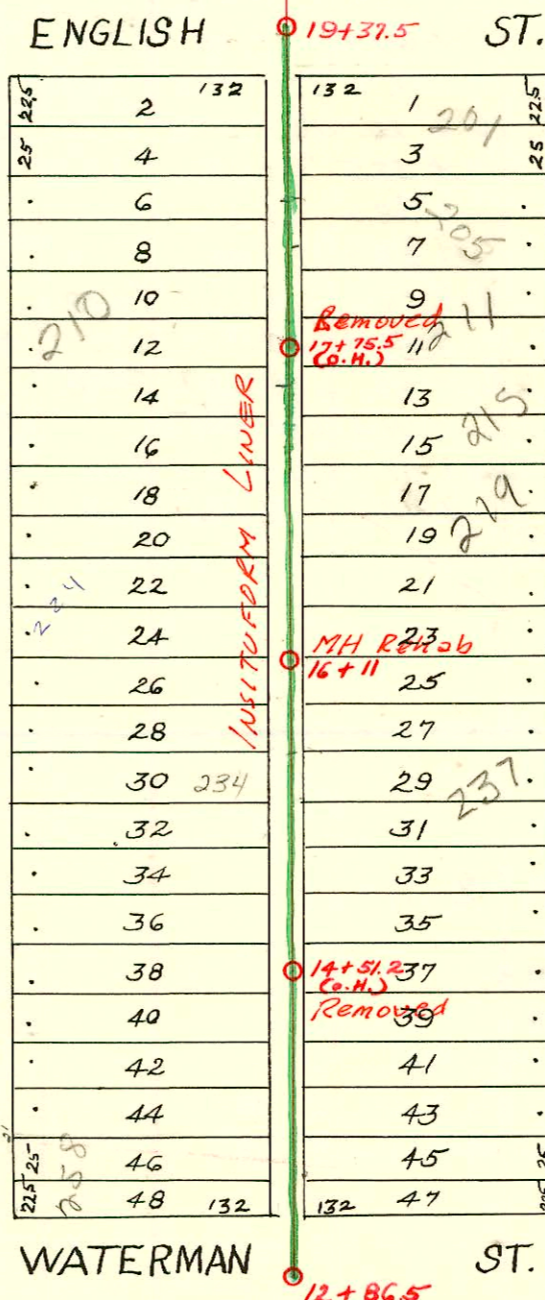

1991 SAN. SEWER RECONSTRUCTION
PROGRAM PHASE II
BUILT BY INSITUFORM PLAINS

94-5589-7 245 S. Green 7/19/94 - 4" PVC 40 Replaced 36 ft section of line
13 ft from main to point 25 ft from house - 4 ft shallower, neatly cut

2002-01950 7/17/02 124 S Poplar - Shallow Pibg - Predco Saddle 35.4' N of MH 21791.6 (22+27) TWIN CO - 1122

CONSTRUCTION RECORD						SERVICE RECORD						
STATION	ELEVATION		Depth	MANHOLE	4-INCH "Y" BRANCHES		No. of Permit		House Number		DATE OF PERMITS	
	Ground	Grade			North West	South East	North West	South East	North West	South East	North West	South East
12+0	109.72	102.71	7.01	12+86.5								
13+0	109.52	102.96	6.56		13+36.5	52' No. of MH 13+34	#366	#2000-2781 617	248 S. (250) Poplar	247 SR Green	6-12-92	12-26-00
					+61.5	+59	#640		250 S. Poplar		8-29-17	11-12-13
					+87.5	+85		#136				3-11-11
14+0	109.82	103.21	6.61		14+13	14+10.5	#9				1-12-16	
					+38.5	+36	#175	#135			4-20-15	3-11-11
					+66	+63.5						
					+90	14+87.5	#234	#567			3-30-11	8-6-17
15+0	110.32	103.46	6.86		15+13.5	15+11	#673		234 S. Poplar		9-11-17	
					+41	+38.5						
					+65	+62.5						
					+91.5	+89						
16+0	110.72	103.71	7.01	16+11	16+19.5	16+17	#269	#26			4-8-20	2-14-12
					+45	+42.5	#473				6-1-21	
					+65.5	+63						
					+96.5	+94	#603				11-4-12	
17+0	110.62	103.96	6.66		17+24	17+21.5						
					+49	17+46.5	#330	#83	210 S. R. Poplar		7-5-12	2-24-11
					17+72	17+69.5	90-3053-7				3-4-92	
18+0	110.66	104.21	6.45		18+22	18+19.5						
					+47.5	18+45	#336	#598			4-17-11	10-9-18
					+73	+70.5	#192	#194	201 S. Green		3-23-11	4-11-17
					+98	+95.5						
19+0	110.66	104.46	6.20	19+37.5	19+84.5	19+82	#75		150 S. Poplar		2-19-13	
20+0	110.86	104.71	6.15		20+10	20+97.5	#167	#82			3-25-14	2-24-11
					+35.5	+33						
					+60.5	4" SCH 40 PIP 20+58.1	00232 #454		145 S. Green		1-26-17	5-8-11
					+85	+82.5	#49					
21+0	111.46	104.96	6.50		21+11.5	21+9						
					+36.5	+34	#295	#719			4-11-11	1-29-19
					+62	+59.5		#291				3-28-25
					+87	+84.5	#261	#2162	137 S. Green 135 S. Green		5-4-17	8-13-52
22+0	112.26	105.21	7.05	21+91.6	22+11	22+08.5	#509	#65	124 S. S. Poplar	200 S. S. Poplar	7-23-02	9-15-13
					22+36	+33.5	#818				10-7-11	2-15-11
					+61.5	+59						
					+84.5	+82						
					+99	+99		#337				4-17-11
23+0	112.76	105.46	7.30		23+01.5		#327				4-15-11	
					+27	+24.5						
					+52	+49.5	#328	#199			4-15-11	4-23-18
					+79	+66.5	#332				4-15-11	
	112.76	105.71	7.05	23+99.6		+81.5						
3+0	112.10	103.05	9.05	3+11.5	North 3+46.5							
					+72		#1932		2503 E. Douglas		8-26-24	
					+98							
4+0	112.40	103.40	9.00		4+23		#1933		2507 E. Douglas		8-26-24	
					+46.5							
					+67.5		#1934		2511 E. Douglas		8-26-24	
					+94							
5+0	112.80	103.75	9.05		5+14		#145				3-13-11	
					+39.5		#146				3-13-11	
					+68							
					+94							
6+0	113.20	104.10	9.10	6+40	6+83							

#532 - Tap - 2501 E. Douglas - 11-16-31 - J. E. Lansdowne
 #533 - Tap - 2503 E. Douglas - 11-16-31 - J. E. Lansdowne
 #534 - Tap - 2505 E. Douglas - 11-16-31 - J. E. Lansdowne
 2825 - Tap - 2512 E. Waterman - 2-15-57 - Cherry Alley
 2066180 - 2513 E. Douglas, at Hamway - 5-2-78 (5+74.5)
 2066179 - 2519 E. Douglas, at Hamway - 5-2-78 (4+27.5) - N.C. 06016-2525 E. Douglas - 11-17-77 - J. Lansdowne
 #92-3053-7 3/4/92 - 210 S. Poplar - Jim Morris