

1991 SAN SEWER RECONSTRUCTION PROGRAM, PHASE II
 Built by InsituFORM PLAINS

DIST. A. - S.S. # 12
 1912

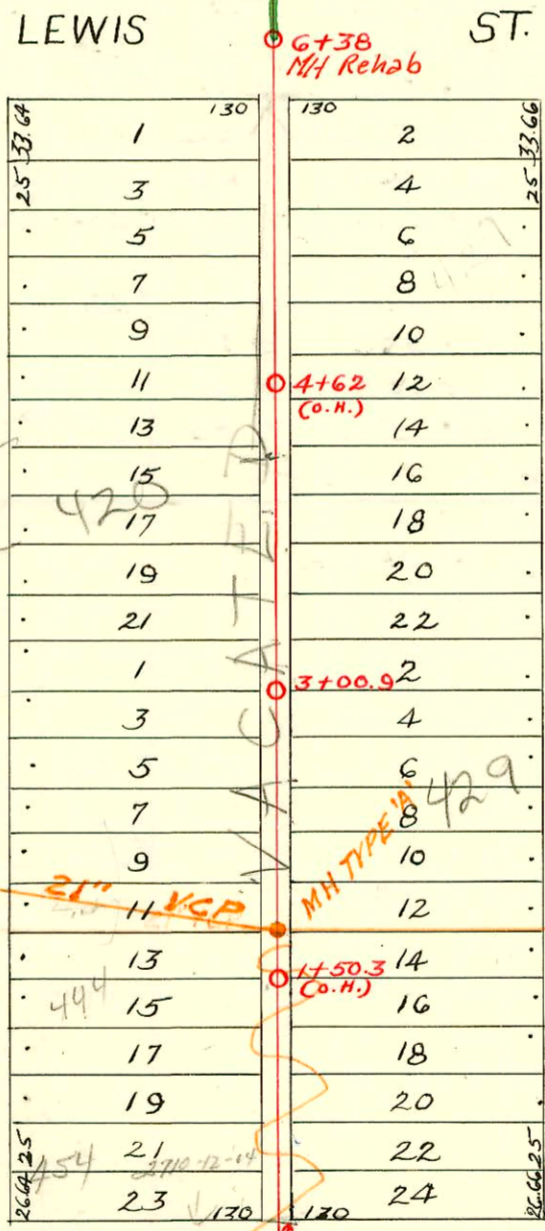

CHANGES BY STATE HWY DEPT
 BOOKED 9-10-77 FROM AS BUILT PLAN
 (SEE PAGE C15A)

RECONNECTIONS

STATION	ADDRESS	DIRECTION
12+37.7	2715 E. Waterman	West
12+36.4	302 S. Estelle	West
12+20.9	2719 E. Waterman	East
11+87	306 S. Estelle	West
11+84.3	305 S. Volutsia	East
11+59.9	311 S. Volutsia	East
11+38	310 S. Estelle	West
11+11.9	315 S. Volutsia	East
10+65.5	312 S. Estelle	West
10+63.5	319 S. Volutsia	East
10+41	314 S. Estelle	West
9+89.9	339 S. Volutsia	East
9+68.3	320 S. Estelle	West
9+65.7	341 S. Volutsia	East

RECONNECTIONS

STATION	ADDRESS	DIRECTION
9+33.3	322 S. Estelle	West
9+05.8	343 S. Volutsia	East
8+83.5	330 S. Estelle	West
8+81.1	345 S. Volutsia	East
8+34.5	332 S. Estelle	West
8+31.8	337 S. Volutsia	East
8+07.1	347 S. Volutsia	East
7+84.7	334 S. Estelle	West
7+60	336 S. Estelle	West
7+33.1	349 S. Volutsia	East
7+08.5	351 S. Volutsia	East

RECONNECTIONS

STATION	ADDRESS	DIRECTION
6+86.2	340 S. Estelle	West

AGood Pitar CITY repair - 4" Preced 34' sof MH 9+37 (9+03) 2V45, ITWIN CO 4"40PK

CONSTRUCTION RECORD

SERVICE RECORD

STATION	ELEVATION		Depth	MANHOLE	4-INCH "Y" BRANCHES		No. of Permit		House Number		DATE OF PERMITS	
	Ground	Grade			North West	South East	North West	South East	North West	South East	North West	South East
0+0	107.40	101.34	6.06	0+0	0+32 +57 +82.5	0+29.5 +54.5 +80	#28 #29705 #983	#622	454 S. Estelle 2740 E. Kellogg	11-12-71 1-12-22 1-11-22		6-20-30
1+0	107.60	101.59	6.05	1+0	1+07.5 +33 +58.5 +84	1+05 +30.5 +56 +81.5	#982 #31110 #1096 #38	#355 #1096	446 S. Estelle 2746 E. Kellogg 444 S. Estelle	10-17-21 11-12-71 6-23-71 1-17-22		3-22-72 7-16-37 8-26-22
2+0	107.50	101.84	5.66	2+0	2+09 +34.5 +60 +87.5	2+06.5 +32 +57.5 +85	#33 #705 #64	#1459 #396 #1674	440 S. Estelle 443 S. Estelle 439 S. Estelle	6-23-71 1-13-22 6-22-22 6-30-11		10-31-22 11-12-71
3+0	107.80	102.09	5.71	3+00.9	3+20 +45 +71.5	3+17.5 +42.5 +69	#1284	#922	426 S. Estelle		10-14-19	12-15-11
4+0	108.20	102.34	5.86	4+0	4+22 +47 +73 +98.5	4+19.5 +44.5 +70.5 +96	#157 #443	#168	420 S. Estelle		3-8-22 5-24-21	4-10-18
5+0	108.91	102.59	6.32	5+0	5+24 +49 +74	5+21.5 +35.0 +71.5 +97.5	#1386 #150	#232 #366	429 S. Estelle 2717 E. Lewis	10-19-22 4-3-18		8-30-91 4-20-14 9-14-36
6+0	109.01	102.84	6.17	6+38	6+00 +80	6+77.5		#226				5-16-12
7+0	109.41	103.09	6.32	7+0	7+04.5 +29.5 +55 +80	7+02 +27 +52.5 +77.5	#350 #899 #1319	#91			4-28-21 3-13-18 12-15-17 10-10-22	
8+0	109.91	103.34	6.57	8+0	8+05 +31 +55.5 +81	8+02.5 +28.5 +53 +78.5	#362	#832 #86	347 S. Estelle 332 S. Estelle	10-12-11 4-20-22		3-26-24
9+0	109.71	103.59	6.12	9+0	9+06.5 +31.5 +56 +81.5	9+04 +29 +53.5 +79	#119 #717 #242	#219 #220 #221	343 Volutsia	4-9-12 8-11-21 3-27-22		6-1-16 6-1-16 6-1-16
10+0	109.95	103.84	6.11	10+0	10+06.5 +32 +57 +81.5	10+04 +29.5 +54.5 +79	#356 #270	#529	320 S. Estelle	5-6-20		12-5-16
11+0	110.15	104.09	6.06	11+0	11+07.5 +32 +58 +83	11+05 +29.5 +55.5 +80.5	#593 #3408 #9385	#800	310 S. Estelle 310 S. Estelle 306 S. Estelle	4-28-81 7-26-20 6-8-81 10-9-83		3-28-19
12+0	111.05	104.34	6.71	12+0	12+08.5 +34	12+06 +31.5	#514		302 S. Estelle	5-17-22		

11+0	107.54	100.57	6.97	11+69.7								
12+0	107.84	100.80	7.04									
13+0	107.74	101.04	6.70									
14+0	108.74	101.27	7.47									

2001-03035 11/23/01 311 S Volutsia - Overnight - 4" sch 40 Predco Saddle 123'S of MH 12+83.7 (11+60.7) ITWIN CO, 1V45

2002-00856 3/26/02 339 S Volutsia - EvenTemp - Replace clo highend - PVC repair to last 2' to main PVC Saddle 49' W of MH 9+37 (9+86)

C 31077-2710-14 E. Kellogg Sealoff at 0+57 - all Penning 3-22-72

#103 - Tap - 2725 E. Kellogg - 2-15-22
 #1531 - Tap - 2715 E. Waterman - 10-25-29 - L.W. Murphy
 #1943 - Private Line - 2718 E. Kellogg - 5-2-47 - Davidsen Pkg.
 #2854 - Tap - 2811 E. Waterman - 10-14-52 - Simmons Pkg.
 #36673 - Tap - 2715 E. Kellogg - 2-2-57 Ref.