



SCALE: 1" = 100'

1992 SANITARY SEWER REHABILITATION PROGRAM - PHASE II
 PROD. NO. 468-82220 (631879)
 BUILT BY INSITUFORM PLAINS, INC.
 BOOKED 8-16-93 FROM AS BUILTS

DIST. A - S.S. No. 12
 1912

*138 S. Volutsia
 5' R/W
 2903519
 and 4' ESMIT Room
 2812 FLWY LIMP R 144
 Doc IF LMP
 2903519
 CH 2/3/99*

*41 S. Erie
 S. 5' R/W
 201333 granted to 197 S. Erie
 Film 1028
 Page 1087*

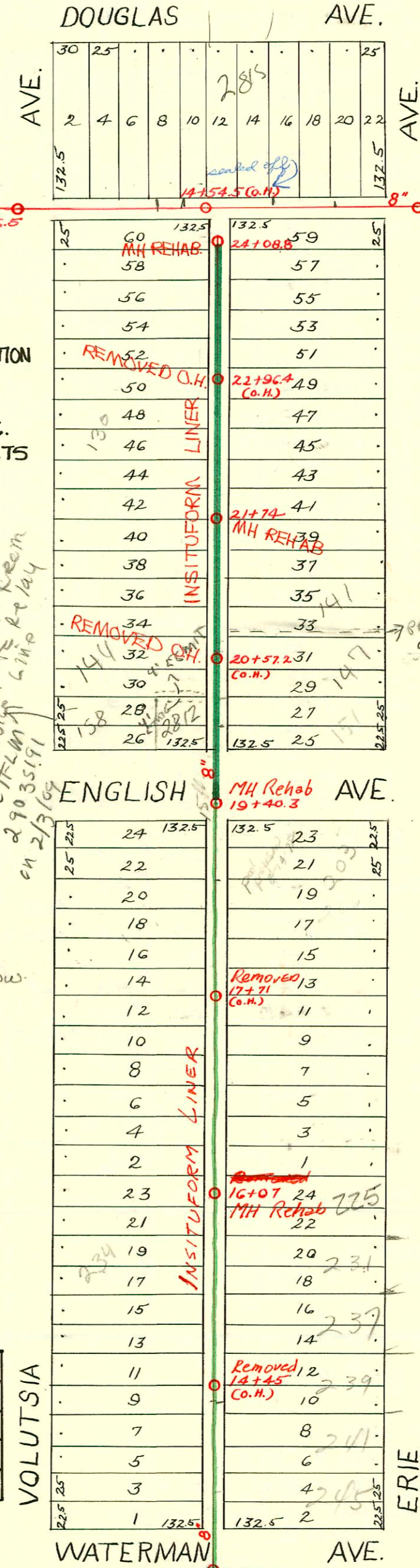

RECONNECTIONS

STATION	ADDRESS	DIRECTION
15+78.7	225 S. Erie	East
15+75.3	226 S. Volutsia	West
15+54.1	231 S. Erie	East
15+32.3	234 S. Volutsia	West
14+94.5	237 S. Erie	East
14+83	236 S. Volutsia	West
14+41	240 S. Volutsia	West
14+31.4	239 S. Erie	East
14+09.5	242 S. Volutsia	West
13+82	241 S. Erie	East
13+60.2	244 S. Volutsia	West
13+57.5	245 S. Erie	East

RECONNECTIONS

STATION	ADDRESS	DIRECTION
17+30.9	210 S. Volutsia	West
17+11.5	222 S. Volutsia	West
16+62.7	224 S. Volutsia	West
16+60.3	223 S. Erie	East

RECONNECTIONS

STATION	ADDRESS	DIRECTION
23+79.5	116 S. Volutsia	West
23+52.6	123 S. Erie	East
23+31.7	118 S. Volutsia	West
23+10.4	124 S. Volutsia	West
22+66	130 S. Volutsia	West
22+57	129 S. Erie	East
21+87.8	132 S. Volutsia	West
21+84.7	135 S. Erie & 135 S. Erie	East
21+56.3	136 S. Volutsia	West
21+54.1	139 S. Erie	East
21+03.7	140 S. Volutsia	West
20+78.6	141 S. Erie	East
20+67.6	147 S. Erie	East

RECONNECTIONS

STATION	ADDRESS	DIRECTION
20+55.9	144 S. Volutsia	West
20+16.3	158 S. Volutsia & 1228 E. English	West
20+11.1	158 S. Volutsia & 1228 E. English	West
20+05.2	151 S. Erie	East
18+88.5	203 S. Erie	East
18+81.5	203 S. Erie	East
18+63.7	2805 E. English & 2045 S. Volutsia	West
18+31.8	205 S. Erie	East
17+87.9	208 S. Volutsia	West
17+82.9	207 S. Erie	East
17+58	215 S. Erie	East
17+33.8	219 S. Erie	East

1991 SAN. SEWER RECONSTRUCTION PROGRAM, PHASE II
 Built By INSITUFORM PLAINS

1999-01045 10/29/99 - 231 S. Erie Ave - Arrowhead Exc - Wye 53'S MH 16+07 (15+54) 4" SCH 40, LTWINCO, 1422, 1445

CONSTRUCTION RECORD							SERVICE RECORD					
STATION	ELEVATION		Depth	MANHOLE	4-INCH "Y" BRANCHES		No. of Permit		House Number		DATE OF PERMITS	
	Ground	Grade			North West	South East	North West	South East	North West	South East	North West	South East
12+0	111.35	105.38	5.97	12+84.5								
13+0	111.45	105.63	5.82		13+27.5	13+25	#51	#26687 #671	245 P. Erie 201 Erie	2-15-15	12-6-90 12-6-18	
					+52	13+50		#545				9-4-18
					+77.5	+75						
14+0	111.72	105.88	5.84		14+02.5	14+00	#944	#190207	239 R Erie	5-24-19	7-21-93	
					+35	14+25.5	#119	#12		3-12-13	1-9-18	
					+53	+50.5		#1634 #544	237 L Erie		1-25-67	7-30-17
					+75	+75						
15+0	112.02	106.13	5.89		15+03	15+00.5	#120				4-9-12	
					+28	+25.5	#952	#99-01045	231 S R Erie	5-27-19	10-29-99	
					+53.5	+51	#1722	#496		12-15-22	11-3-18	
					+78.5	+76.4		#467			1-11-96	8-2-18
						15+99						
16+0	112.02	106.38	5.64	16+07	16+01.5							
					+28.5	16+26						
					+54	+51.5	#108	#134			4-8-12	3-19-13
					+79.5	+77						
17+0	112.22	106.63	5.59		17+04	17+01.5	#747				6-28-22	
					+29	+26.5		#103				4-6-12
					+54.5	+52		#870				11-10-11
					+79.5	+77	#1589	#143	208 S. Volutsia		10-29-23	4-1-18
18+0	112.62	106.88	5.74		18+05	18+02.5	#37	#55077			2-9-25	4-28-76
					+30	+27.5		#142	205 L Erie			4-1-18
					+61	+53	#184				3-22-11	
					+80.5	+78		#272	203 L Erie			6-10-12
					+96	+93.5						
19+0	113.02	107.13	5.89	19+40.3	19+82	+79.5	#652				8-23-20	
20+0	113.45	107.38	6.07		20+07	20+12	#108	#838	198 L Volutsia		3-6-11	9-14-21
					+28	+25.5		#50				2-9-11
					20+53	+50.5	#691				11-21-14	
					+78	+75.5		#873				11-30-17
21+0	113.95	107.63	6.32		21+02.5	21+00	#202				4-8-14	
					+28	+25.5						
					+53	+50.5	#238				5-2-18	
				21+74	+80	+77.5		#162				4-2-13
22+0	114.35	107.88	6.47		22+05.5	22+03	#180	#54			6-9-20	1-30-14
					+31	+28.5						
					+54	+51.5	#110	#121			3-6-11	3-9-11
					+79	+76.5						
23+0	115.02	108.13	6.89		23+24.5	23+22	#148	#11875			3-13-11	
					+49.5	+47		#66	115 Erie		2-15-11	8-28-21
					+74.5	+72	#107				3-6-11	
						+97.5						
24+0	115.65	108.38	7.27	24+08.8	24+00							

R 15379 - 123 L Erie Boulevard - 1-6-86 - 24+08.8 L

22589 - 147 S Erie - Kent - 2-21-89 - 147 S Erie - R-2-80 #20544 - 14-90-147 S Erie - NK - 125

#568 - Top - 442 S. Volutsia - Cherry Plbg. Co.

#161 - Top - 2815 E. Douglas - Mc Donald - 4-26-57

#1686 - Top - 237 L Erie - von White - 1-25-69 - (14+90.4)

2d # C60000 - 2815 E. Douglas - 2-18-77

of MH 19740-3