

DIST. A-S.S. No. 12
1912

1988 Sanitary Sewer Reconstruction
Program (Phase 2)
468-81886 (600817)
Built By Insituform Plains

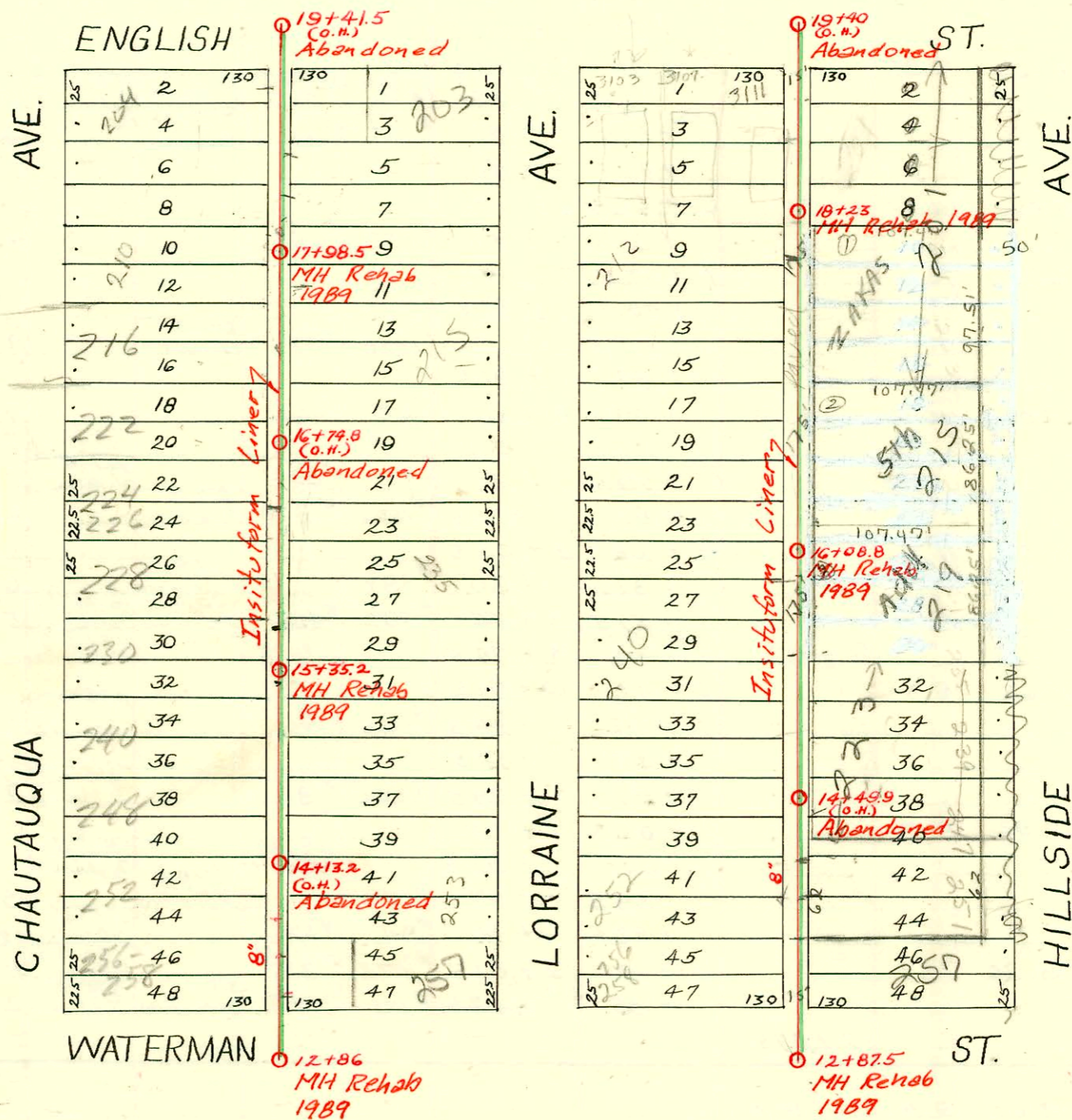

SWR 2004-00281 216104 257 S. Hillside McCallough Exc.
4" 40 PUC run 40' PUC Citytap 4" Predco 44.1" D of MK 12+86 (13+30.1)

CONSTRUCTION RECORD						SERVICE RECORD						
STATION	ELEVATION		Depth	MANHOLE	4-INCH "Y" BRANCHES		No. of Permit		House Number		DATE OF PERMITS	
	Ground	Grade			North West	South East	North West	South East	North West	South East	North West	South East
12+0	115.57	107.44	8.13	12+86								
13+0	114.07	107.74	6.33		13+28	13+25.5	#300	#1118	252-58 S R Chautauque	?	9-4-85	7-27-23
					+53	13+50.5		#1053		?		10-31-21
					+78	+75.5		#825		?		11-10-21
						+98.5						
14+0	114.08	108.04	6.04		14+01		#137		248 S Chautauque		4-2-15	
					+26.5	+24	#862				8-14-28	
					+51.5	+49		#352		?		6-24-13
					14+79.5	+77	#236				4-1-21	
15+0	113.78	108.34	5.44		15+04.5	15+02		#585		?		10-25-13
					15+35.2	15+27.5	#182	#382		?	3-13-20	8-19-12
					15+59.5	+57	#213			?	5-27-16	
					15+85.5	15+83						
16+0	113.62	108.64	4.98		16+11	16+08.5		#228		235 ?		3-29-20
					16+36.5	+34	#25981	#561	284 Chautauque	?	8-21-90	6-27-21
					+62	+59.5	#767				5-3-16	
					+88	16+85.5		#700		?		8-8-21
17+0	114.02	108.94	5.08		17+13.5	17+11	#227		222 ?		4-30-18	
					+40	+37.5	#110		216 S Chautauque		3-30-16	
						+52.5						
					+65	+62.5						
					+88.5	+86	#221		210 S Chautauque		11-18-82	
18+0	114.12	109.24	4.88	17+98.5	18+10	18+07.5	#8	#201	208 S Chautauque	?	1-4-18	3-20-20
					+35.5	+33		#753		?		10-16-17
					+61	18+58.5		#227		?		3-29-20
					+86.5	+84						
19+0	114.62	109.54	5.08		19+04		#109		203 S Chautauque		3-6-11	
					19+41.5	+78						

96-13343-7 814-96 257 S LORRAINE

#6793-Tap- 237 S. Lorraine - 10-29-53 - Joe Mc Donnell

#91-38588-7 12/9/91 251 S. Hillside - N/C

#21555 - New Conn - 9-26-88 - 215 S. Hillside - Burgess - (16+77.0 TAP)

#22155 - 12/05/88 - 223 S Hillside N/C - Coloman (15+15.5 tap 4" SDR 35)

#22355 - 1-9-89 - 219 S. Hillside - Burgess - (11+74.5 TAP)

#27116 - 2-20-91 - 201 S. Hillside - N/C Jim Arnold - (18+71.0 tap 4" SDR 35 C.O)

(14+15.5 tap 4" SDR 35)