

DIST. A - S.S. No. 12
1912

1988 SANITARY SEWER RECONSTRUCTION
PROGRAM (PHASE 2)
468-81886 (600817)
Built By Insituform Plains Inc.

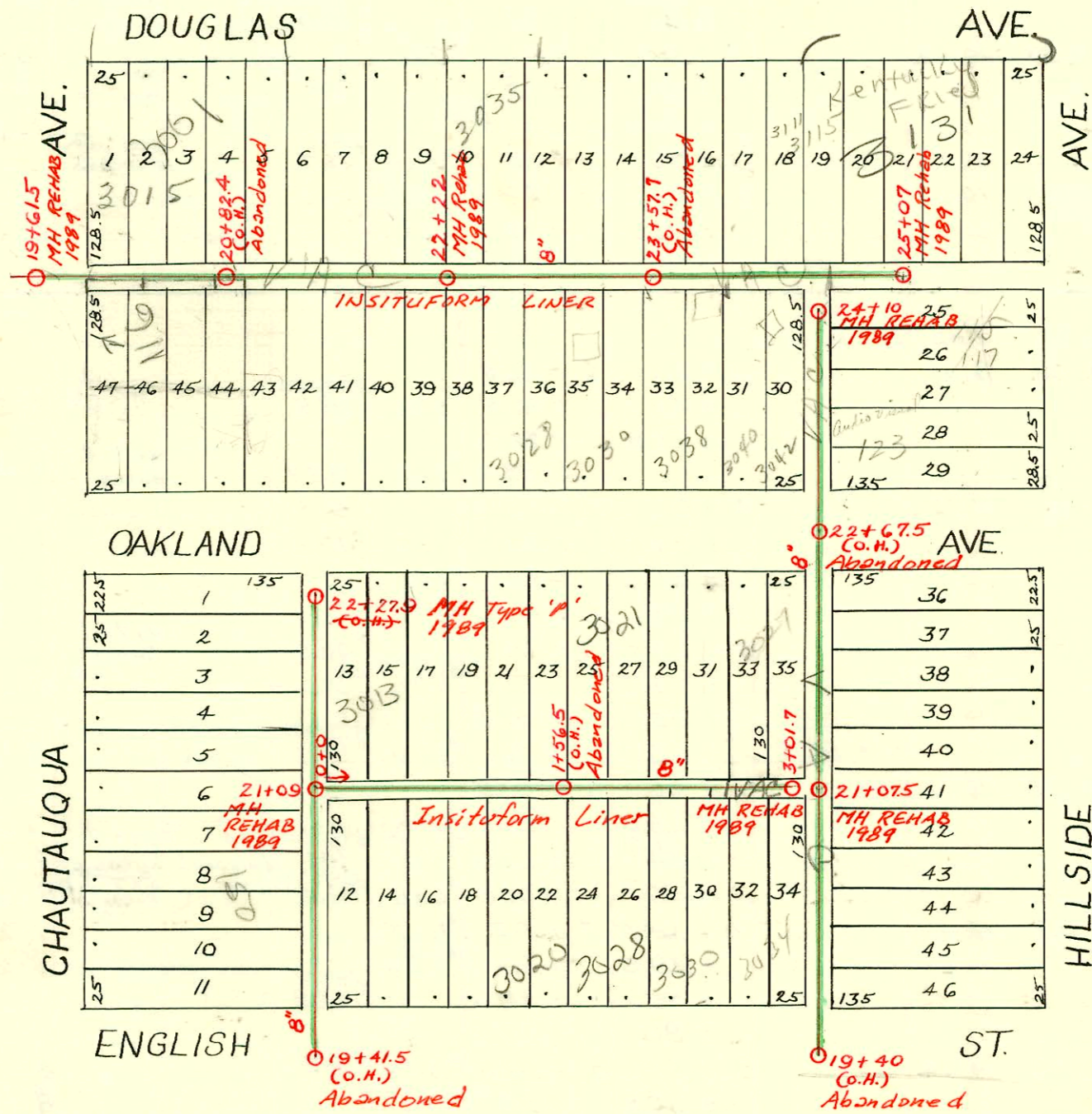

2000-00073 - 110-05 - 3028 E English - repair 4' from main, (1) 45# - 4" sch 40 PVC - Wilks + Assoc
 SWR 1999-00073 6/28/99 3030 E English - B+L Exc - 4" sch 40 repair aprx 10' of line at
 house, 1 Twin co, at 22
 SWR 2004-03317 12-21-04 3020 E English - Fredi Ind. - 4" Precast w/ Strap, 121.5 E of MH, (2) 22" (1) 12" Twinco
 (3) Ferro, poly pipe pipe burst shanno

CONSTRUCTION RECORD

SERVICE RECORD

STATION	ELEVATION		Depth	MANHOLE	4-INCH "Y" BRANCHES		No. of Permit		House Number		DATE OF PERMITS	
	Ground	Grade			North West	South East	North West	South East	North West	South East	North West	South East
19+0	114.62	109.54	5.08		19+78.5		#449				3-11-24	
20+0	115.02	109.84	5.18		20+04		#1315		1305 Chautauque		4-9-93	10-25-19
					20+29		#192		150 S. Chautauque		5-2-12	8-5-89
					20+49.06		6306		150 S. Chautauque			
					+54							
					+79							
					20+99.5		6126		150 S. Chautauque		7-8-82	
21+0	115.52	110.14	5.38	21+09	21+28.5		#297				4-11-11	
					21+54		#198				5-4-12	
					+79		#107				3-7-13	
					22+07		#1457				10-2-23	
22+0	116.02	110.44	5.58				#1282				10-3-22	
0+0	115.48	110.17	5.31	0+0	North	South	9739542		3013 R. Oakland		3-17-97	
					0+21.5	0+19	#521				9-19-13	
					+48	+45.5						
					+73.5	+71	#107	#512			3-7-13	11-28-16
						+97.5						
1+0	115.68	110.47	5.21		1+00							
					1+24	1+21.5	#355	#401			6-24-13	4-29-11
					+49.5	+47						
					1+74.5	+72	#1421	#37	?		12-19-19	1-8-17
						+98						
2+0	115.98	110.77	5.21		2+00.5							
					2+26	2+23.5	#228	#174	3039 R. Seemore English		6-2-16	5-8-16
					+51.5	+49	#175					5-8-16
					2+77.0	2+74.5	#66	#107	3021 E. Oakland	3034 E. English	10-27-88	3-4-18
3+0	116.78	111.07	5.71	3+01.7								3-4-64
19+0	115.81	110.36	5.45			East						
20+0	116.31	110.66	5.65			19+78.5						
						20+03.5						
						+28.5						
						+53.5						
						+79						
21+0	116.88	110.96	5.92			21+01.5		#645	145 S. Hillside		7-18-11	
					21+07.5	+32		#407			12-22-15	
						+55						
						+80.5		#133	125 S. Hillside		2-26-20	
22+0	118.08	111.26	6.82			22+03						
						+27						
23+0	112.68	111.56	9.12			23+01		#114			11-14-21	
						+27.5						
						+52.5						
						+74						
						+98.5		#4211	115-117 S. Hillside		8-3-67	
24+0	112.18	111.86	10.32	24+10.0		23+79		#894			7-26-22	
								C5944			11-30-67	
19+0	117.49	108.65	8.84	19+61.5	North	South						
20+0	117.35	109.00	8.35			20+02		#3037	3015 E. Douglas		3-14-83	1-2-41
						20+14		#131	3007 E. Douglas		3-10-11	
						+24.5	20+27				12-1-21	
						+54.5	+52					
						+80	+77.5					
21+0	117.95	109.35	8.65		21+04	21+01.5		#1186			11-29-21	
						+28.5	+26	#602			11-14-21	
						+53.5	+51	#207	3015 E. Douglas	3016 S. Oakland	12-23-12	10-28-82
						+77	+74.5	#218			3-14-83	3-22-22
22+0	118.05	109.70	8.35		22+02.5	22+00		#507			4-28-13	6-13-21
					22+22	+28.5	+26	#77	3023 E. Douglas		4-16-68	
						+52.5	+50	#678	3035 E. Douglas		3-20-11	8-3-21
						+77	+74.5				6-12-68	
23+0	119.45	111.70	7.75		23+02.5	23+00		#164			3-17-11	
						+27.5	+25					
						+53.5	+51	#202	3030 E. Oakland		3-20-20	5-6-68
						+76.5	+74	#211	3033 E. Douglas		3-28-11	11-13-30
						+99		#512	3040 E. Oakland		10-26-31	5-6-68
24+0	120.85	113.70	7.15		24+01.5			#481	3112 Oakland		4-12-22	
					24+26.5	+24		#1026			8-29-11	
					+79	+74		#434	3123 E. Douglas		4-29-92	
25+0	123.25	115.70	7.55	25+07				#8267	3131 E. Douglas		10-28-47	
											7-15-14	
											6-39-2	

6539 (205 E. Douglas) 9-10-82 Henning (21+22) (52' w of E. R.)
 #328 - Tap - 3-6-23 N.W. Cor. Hillside & Oakland
 #37 - Tap - 1-14-22 3012 E. English (0+19)
 #1233 - Tap - 113 S. Hillside - 5-29-24
 #328 - Tap - N.W. Corner Oakland & Douglas - 3-5-23
 #170 - Tap - 3159 E. Douglas - 2-28-28
 #1451 - Tap - 3009 E. Douglas - 4-12-39 - Kansas Pibg. Co. Seal off 62417 - at Henning 8-4-97
 #2935 - 3019 E. Douglas - 12-6-40 - Used old connection - Plummer Pibg.
 #1086 - Tap - 3117 E. Douglas - 12-12-46 - Play Bros. Pibg. - Tap at 24+74
 #71 - Private line conn. - 3009 E. Douglas - 5-23-47 - Brydon Pibg.
 #1198 - Tap - 3007 E. Douglas - 8-15-49 - Joe's Pibg.
 #1904 - Tap - 3111 E. Douglas - 11-30-49 - Shepherd Pibg. Co.
 #6351 - Used old conn. - 123 S. Hillside - 10-31-51 Davidson Pibg.
 #6536 - Tap - 147 S. Hillside - 9-21-55 - Kendall Pibg. Co.
 #C8181 Seal off, 3030 Oakland - at Henning - 5-6-68
 (conn. with 3030 Oakland - 28+51)
 #C18547 - 3115 E. Douglas - 3-26-70 - at Henning (24+30)
 130 S. Chautauque - 4" Sch 40 PVC - 1/4" Fall - 44 Ft N of MH -
 City crew main tap - dirt alley cut - end conn to 76.9 and 73.9' S of MH -
 No addresses