

DIST. A - S.S. No. 12  
1912

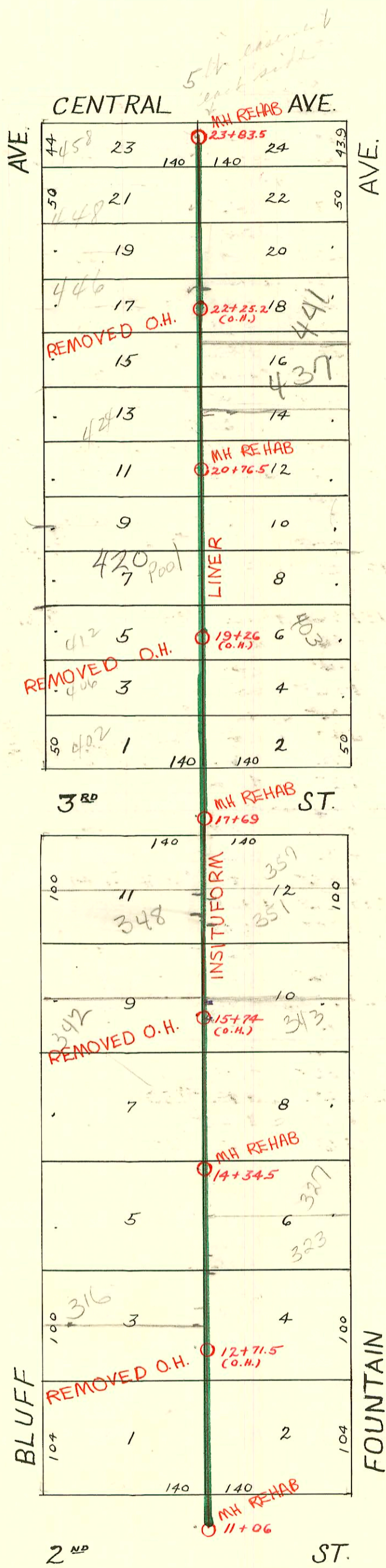

1992 SANITARY SEWER REHABILITATION  
PROGRAM - PHASE I  
PROJ. NO. 468-82220 (631879)  
BUILT BY INSITUFORM PLAINS, INC.  
BOOKED 3-17-93 FROM AS BUILTS

RECONNECTIONS

STATION	ADDRESS	DIRECTION
23+56.4	400 E. Central	WEST
23+50	457 Fountain	East
23+15.6	448 Bluff	West
22+76.6	447 Fountain	East
22+38.8	446 Bluff	West
22+11	441 Fountain	East
21+52.9	437 Fountain	East
21+06.3	424 Bluff	West
20+68.7	431 Fountain	East
20+22.1	423 Fountain	East
19+72.8	417 Fountain	East
19+70.3	420 Bluff	West
19+25.5	412 Bluff	West
19+22.8	403 Bluff	West
18+99.7	406 Bluff	West
18+26.4	402 Bluff	West
17+33.2	354 Bluff	West
17+25.9	357 Fountain	East
16+91.9	351 Fountain	East
16+76.5	348 Bluff	West
16+24.3	347 Fountain	East
16+02	346 Bluff	West
16+00	343 Fountain	East
15+64.8	342 Bluff	West
15+26	341 Fountain	East
15+04.1	332 Bluff	West
14+93.8	331 Fountain	East
14+59.9	328 Bluff	West
14+32	327 Fountain	East
14+09	324 Bluff	West
13+80	320 Bluff	West
13+52.4	323 Fountain	East
13+07.9	316 Bluff	West
13+07.1	315 Fountain	East
12+28	307 Fountain	East
12+06.1	304 & 304 1/2 Bluff	West
11+78.1	301 Fountain	East

2001-03053 1212101 437 N Fountain - Bowers - 4" SCH 40 Fernco 1' from Main, 66' N of MH 20+76.5 (21+42.5) old m snc off  
IRWIN CO, Fernco @ house

93-25443-7 9/27/93 343 N Fountain - 4" PVC 40  
4" City - 18.5 ft south - rerouted line - replaced lower 18 ft  
of line - 4" p f 15m

93-25441-7 - 9/27/93 - 5/0 - 4" clay tile line scales off 19 ft from  
RPL and at NPL No alloy - 343 N Fountain

CONSTRUCTION RECORD						SERVICE RECORD						
STATION	ELEVATION		Depth	MANHOLE	4-INCH "Y" BRANCHES		No. of Permit		House Number		DATE OF PERMITS	
	Ground	Grade			North West	South East	North West	South East	North West	South East	North West	South East
11	182.23	171.12	11.11	11+06	11+67.5	11+65		#342				6-5-14
					+91.5	+89	#477		304 N. Bluff		5-10-22	
12	184.55	172.58	11.97		12+17.5	12+15		#244				4-1-20
					+42.5	+40	#421				5-8-11	
					+68	+65.5						
					12+94	+91.5	#1203	#777	3127 Bluff		9-4-19	5-23-23
13	184.35	174.12	10.23		13+18	13+15.5						
					+43	13+40.5		#52				1-28-22
					13+67.5	+65	#149				3-1-20	
					+93.5	13+91	#38	#866	327 N. Fountain		1-21-20	9-21-21
14	184.15	175.67	8.48		14+18.5	14+16						
	184.75	176.22	8.53	14+34.5	+44.5	+42	#395				5-19-20	
					+69.5	14+67		#134				2-25-22
					14+94.5	+92	#396				5-19-20	
15	185.65	176.54	9.11		15+19.5	15+17		#306				4-19-21
					15+44.5	+42	#906				7-27-22	
					+70	+67.5						
					+95	15+92.5	#2953	#1583	346 N. Bluff	343 N. Fountain	12-20-40	11-22-22
16	186.95	177.04	9.91		16+20	16+17.5		#433		345 N. Fountain		6-22-17
					+45.5	16+43						
					16+71	16+68.5	#2053	#1363	348 N. Bluff	353 N. Fountain	12-26-20	9-17-23
					16+98.5	16+96	#786	#554	350 N. Bluff	See below	9-10-24	
17	189.45	177.54	11.91		17+24	17+21.5						5-24-22
				17+69								
18	189.74	178.04	11.70		18+20.5	18+18	#45		402 N. Bluff			1-20-27
					+46	+43.5						
					+71.5	+69	#857		406 N. Bluff			10-6-26
					+96.5	+94				403 N. Fountain		2-17-83
19	189.94	178.54	11.40		19+21.5	19+19	#966					8-8-22
					+47	+44.5	#231		412 N. Bluff			3-24-22
					+72	+69.5	#1176	#1500	418 N. Bluff			10-10-23
					+97	+94.5	#314					5-27-18
20	190.64	179.04	11.60		20+22	20+19.5						
					+47.5	+45		#150				3-6-22
					+70	+67.5						
				20+76.5	+95.5	20+93	#439	#1441	420 N. Bluff		3-29-23	6-20-24
21	189.64	179.54	10.10		21+20.5	21+18						
					+45.5	+43						
					+71	21+68.5		#33		433 N. Fountain		2-7-25
					+96.5	+94						
22	189.34	180.04	9.30		22+21	22+18.5	#631	#714	446 N. Bluff		4-30-23	8-11-21
					+46	22+43.5						
					+71.5	+69						
					+96.5	+94						
23	189.04	180.54	8.50		23+22	23+19.5	#792		448 N. Bluff		5-26-23	
					+47	+44.5	#256		457 N. Fountain		3-10-20	3-30-25
					+69.5	+67	#1258		458 N. Bluff		8-24-23	
	188.04	180.96	8.08	23+83.5								

2000-02783-123600-348 N Bluff - Roof Plog - 4" SCH40 - 99' 50" of MH 17+65 (16+70) 2V45 - Repair not Replacement  
 1 Fernco to clay 1' from main / Fernco to clay in yard