

DIST. C- S.S. No. 12  
1911

1992 SANITARY SEWER REHABILITATION  
PROGRAM - PHASE III  
PROJ. NO. 468-82220 (631879)  
BUILT BY INSITUFORM PLAINS, INC.  
BOOKED 8-25-93 FROM AS BUILTS

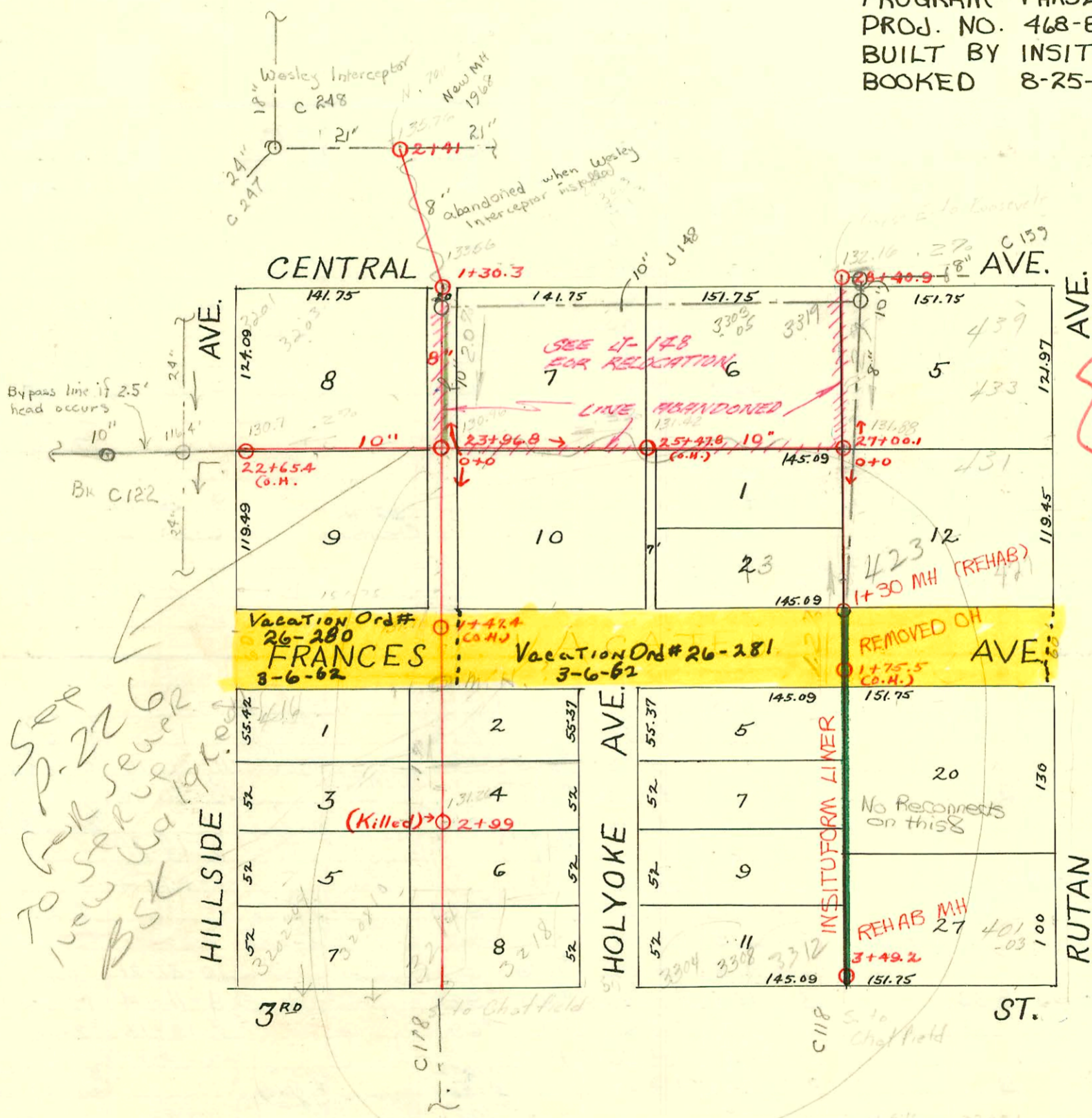

new line  
see J-148

See p. 226  
Get sewer  
to sewer  
new water  
Bk

These two lines in  
process of a bond  
process of a bond  
a re routing permit  
sewer by La Donna  
rel by La Donna  
6/20/02  
Bk

CONSTRUCTION RECORD

SERVICE RECORD

STATION	ELEVATION		Depth	MANHOLE	4-INCH "Y" BRANCHES		No. of Permit		House Number		DATE OF PERMITS	
	Ground	Grade			North West	South East	North West	South East	North West	South East	North West	South East
22	140.63	130.50	10.13		22+51							
				22+65.4 (O.H.)	+74.5			#1489 Seal off	3201 E. Rutan		10-30-61	
23	139.27	130.90	8.47		23+01			#1489 Seal off	3303 E. Central		10-30-61	
					+26.5						10-12-37	
24	134.77	130.96	3.81	23+96.8	24+09			#1058	3217 E. Central		11-3-47	
					+34			#99	3221 E. Central		6-18-32	
					+58.5							
					+84			#384			9-18-16	
25	137.07	131.27	5.80		25+08							
					+34							
					+58							
					+83							
26	136.47	131.57	4.90		26+08.5			#1151	3303 E. Central		9-6-22	
					+32.5			12580 Seal off			5-11-60	
					+58.5			41.6 #1058	3319 E. Central		5-19-60	
					+78			#860				
27	138.27	131.88	6.39	27+00.1	27+14.5			#1174				8-21-19
					+39.5							
					+75			#12674	4337 Rutan		12-7-60	
					+89			#96			4-4-12	
28	141.12	132.07	9.05		28+14			#1345				11-3-19
	138.42	132.16	6.26	28+40.9								
0	135.29	130.96	4.33	0+00	0+16.5	0+14		#1026	440 N. Hillside		11-29-26	
					+42	+39.5		#791	440 N. Hillside		7-1-29	
					+67.5	+65						
					+92.5	+90						
1	133.99	131.06	2.93		1+18	1+15.5						
					+43	+40.5						
					+68.5	+66						
					+93.5	+91						
2	133.99	131.16	2.83		2+18.5	2+16		#1148	3200-04 S.O. 3rd		6-14-72	
					+44	+41.5		#605	3208-101 S.O. 3rd		9-6-22	
					+69.5	+67		#629	3214 E. S.O. 3rd		4-24-23	
				2+99	+94.5	+92					12-4-37	
3	132.49	131.26	1.23		3+17.5	3+15		#1197	3217 S.O. 3rd		6-14-72	
					+42.5	+40					9-15-22	
					+68	+65.5						
0	139.53	131.88	7.65	0+0	0+12	0+14.5		#1174	431 N. Rutan		8-28-61	
					+37	+39.5		#1696 Seal off	429 N. Rutan		8-21-19	
					+62.5	+65					12-11-22	
					+88	+90.5						
1	137.53	133.08	4.45		1+13	1+15.5						
					+38.5	+41						
	142.63	133.98	8.65		+63.5	+66		#5001	414-16 N. Holyoke		6-14-69	
					+89.5	+92					6-15-51	
2	143.13	134.28	8.85		2+14.5	2+17		#1063	408-10 N. Rutan		7-18-23	
					+39.5	+42		#5293	408-10 N. Holyoke		7-20-51	
					+65	+67.5					8-11-69	
					+90	+92.5						
3	145.53	135.48	10.05		3+15.5	3+18		#1044	401-03 N. Rutan		6-14-72	
				3+49.2	+40.5	+43		#225	3312 E. Rutan		11-25-27	
					+66	+68.5					3-17-25	
0	135.96	130.96	5.00	0+00	0+15.5			#1268	450 N. Hillside		11-23-25	
					+44			#289	456 N. Hillside		4-3-29	
					+69			#511			8-27-14	
					+94							
1	141.26	132.96	8.30		1+18.5							
	141.56	133.56	8.00	1+30.3								
2	142.56	134.96	7.60									
	144.36	135.76	8.60	2+41								

26691 - (415-17) 71. Rutan - 12-7-90 (510 87' S. of a MH and 6' from main)

Seal off #1321 - Tap 409 N. Rutan - 12-17-28 - C.C. M. & Laughlin - C15474 - Al Henning - 407-09 N. Rutan - 8-19-64 (3+09.8)

#533 - 438 N. Hillside - 11-7-41 - Kansas Pibg. - Private line #14892 Seal off 438 N. Hillside - Mid-States Inter. - 10-30-61

#1742 - Tap - 416 N. Hillside - 4-7-47 - Scotty Clark Pibg. #14893 " " + 44 N. Hillside. " " "

#917 - Tap - 6-26-23

#14004 Seal off 439 N. Rutan Curtis Pibg. 3-23-61 (8+31.9)

#14662 - 3315 E. Central - 9-15-61 - Mid-States Conns. Co. - 0+26 - tap

#14663 - 3315 E. Central - 9-15-61 - Mid-States Conns. Co. - 0+71 - tap

C15146 - 3308 E. Third - 7-28-69 - Al Henning - 2 or 3 houses tied together

C15577 - 3304 E. Third - 8-25-69 - Al Henning (21 99.2 + 90 West)