

DIST. C - S.S. No. 12  
1911

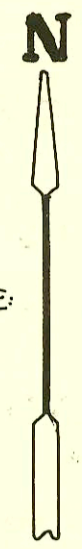

SCALE: 1" = 100'

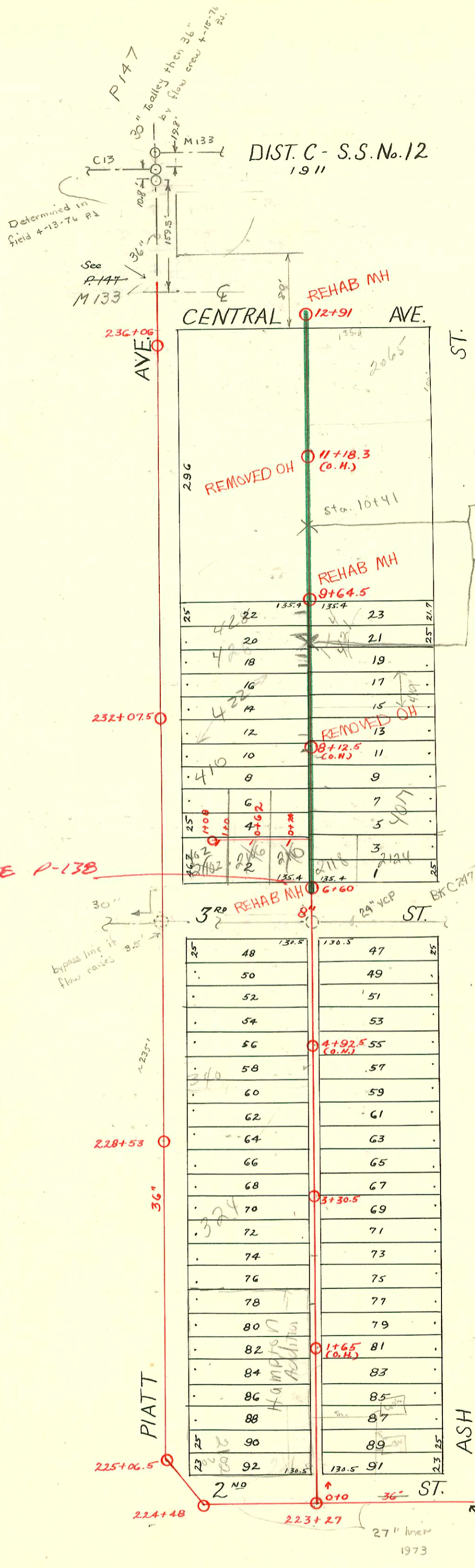

1992 SANITARY SEWER REHABILITATION PROGRAM - PHASE III  
 PROJ. NO. 468-82220 (631879)  
 BUILT BY INSITUFORM PLAINS, INC.  
 BOOKED 8-25-93 FROM AS BUILTS

RECONNECTIONS

STATION	ADDRESS	DIRECTION
12+32	2001, 2007, 2009, 2011 E. Central	West
12+18.6	2065 E. Central	East
12+16.5	2015, 2015 1/2, 2017, 2017 1/2 E. Central	West
11+42.7	446 N. Piatt Apts. A, B, C, D	West
11+08	440 N. Piatt Apts. 1, 2, 3, 4	West
11+03.1	435 N. Ash	East
10+63.1	436 N. Piatt	West
10+55.9	427 N. Ash	East
10+33.7	432 N. Piatt Apts. 1, 2, 3, 4	West
10+31.1	425 N. Ash	East
9+52.9	428 N. Piatt 11' S of MH	West
9+50.2	421 N. Ash Apts. 1, 2, 3, 4	East
9+28.1	426 N. Piatt 5/10 36' S of MH	West
9+03.5	422 N. Piatt	West
9+00.4	419 & 419 1/2 N. Ash	East
8+97.9	424 N. Piatt	West
8+51	417 N. Ash	East
8+26.4	415 N. Ash	East
8+21.3	414 N. Piatt	West
8+03.4	412 & 416 N. Piatt	West
7+51.3	407 N. Ash	East
7+43.2	2118 E. 3rd 96' N of	East
7+41.4	2102, 2106, 2110 E. 3rd	West
7+76.8	2124 E. 3rd	East

97-7187 1-17-97 2102 E 3rd - Henning - Repl 6' in middle of line with 6" sch 40 PUC  
 96-64387 5-2-96 2110 E 3rd - 89' N of MH in 3rd S  
 2001-00536-3/13/01 - McClung's - 4" sch 40 Predco 80' N of MH 6+60 (7+40) TWIN CO, 11/22, 11/45

CONSTRUCTION RECORD						SERVICE RECORD						
STATION	ELEVATION		Depth	MANHOLE	4-INCH "Y" BRANCHES		No. of Permit		House Number		DATE OF PERMITS	
	Ground	Grade			North West	South East	North West	South East	North West	South East	North West	South East
0	112.90	103.80	9.10	0 + 00	0 + 36 + 61.5 + 87	0 + 33.5 + 59 + 84.5	#1518 #117 #128	#117 #128	2102 E 2110 E 302 1/2 N		11-10-22 12-22-21 12-19-72 6-9-22	3-2-21 5-18-84 3-4-21
1	112.10	103.96	8.14		1 + 12.5 + 37.5 + 62.5 + 88	1 + 10 + 35 + 60 + 85.5	#11605 #900	#628	302 1/2 N 313 N 315 N		10-23-78 10-23-78 12-17-17	7-30-14 8-27-17
2	112.00	104.12	7.88		2 + 14 + 39.5 + 64.5 + 90	2 + 11.5 + 37 + 62 + 87.5	#1761 #109 #385 #1663	#875 #1038	314 1/2 N 313 N 321 N 323 N		3-10-22 4-25-22	5-1-19 2-24-25 9-19-25 11-23-29
3	112.30	104.28	8.02	3 + 30.5	3 + 15 3 + 38 3 + 63 + 88	3 + 12.5 + 35.5 + 60.5 + 85.5	#973 #1001 #179	#907	324 Platt 326 Platt		11-19-26 7-30-35	6-4-19 3-12-19
4	112.50	104.44	8.06		4 + 14 + 39 + 66.5 + 90	4 + 11.5 + 36.5 + 63 + 87.5	#898 #1078	#872	343 Platt		3-24-83 11-4-21	5-9-19 4-30-19
5	112.50	104.60	7.90		5 + 16.5 + 41 + 67 + 91.5	5 + 13 + 38.5 + 63.5 + 89	#3712 #81 #164	#194 #89	337 N. Ash		1-16-23 3-9-22	6-21-41 5-2-12 2-23-17
6	112.30	104.76	7.54	6 + 60	6 + 16.5 + 99	6 + 14 + 96.5	#1064	#885			8-23-22	5-6-19
7	112.03	104.92	7.11		7 + 24.5 + 50 + 75	7 + 22 + 47.5 + 72.5 + 97.5	#1532 #1394	#1643	2124 E. Ash 407 N. Ash		10-25-29 10-21-22	10-25-29 11-19-29
8	111.53	105.08	6.45		8 + 00 + 25 + 50.5 + 76.5	8 + 22.5 + 48 + 73 + 98.5	#2 #1629 #1095 #3202 #1096	#780	414 Platt 415 N. Ash 417 N. Ash 419 1/2 N. Ash 419 N. Ash		1-3-28 12-12-27 3-20-41 12-12-27	11-14-29 12-12-27 3-20-41 12-12-27
9	111.03	105.24	5.79	9 + 64.5	9 + 01 + 26 + 51 + 77 + 99	9 + 23.5 + 48.5 + 74.5 + 96.5	#1496 #92 #1859	#812	426 Platt 428 Platt 431 1/2 Platt		11-7-22 1-31-24 12-18-23	2-21-73 4-14-24 9-9-82
10	110.63	105.40	5.23		10 + 25 + 49.5 + 75.5	10 + 22.5 + 47 + 73 + 98	#364 #365	#240 #368	432 Platt		4-15-30 4-15-30	4-1-21 5-5-21
11	111.53	105.56	5.87		11 + 00.5 + 25.5 + 51.5 + 77.5	11 + 23 + 49 + 75 + 99.5	#315 #65	#175	440 Platt 446 Platt		5-28-31 2-14-30	8-27-21 8-21-19
12	112.03	105.72	6.31		12 + 02 + 27 + 53 + 67.5	12 + 15 + 50.5 + 65	#180 #3 #56	#11604 #56	2017 E. Central 2001 E. Central 2019 E. Central		6-1-36 1-4-35	11-19-68 6-19-34
	111.93	105.84	6.09	12 + 76								
222	113.0	101.23	11.77									
223	113.0	101.33	11.67	223 + 27								
224	112.4	101.43	10.97	224 + 48								
225	112.2	101.53	10.67	225 + 06.5								
226	111.8	101.63	10.17									
227	111.6	101.73	9.87									
228	111.9	101.83	10.07	228 + 53								
229	112.0	101.93	10.07									
230	111.4	102.03	9.37									
231	110.8	102.13	8.67									
232	110.6	102.23	8.37	232 + 07.5								
233	111.0	102.33	8.67									
234	111.0	102.43	8.57									
235	111.0	102.53	8.47									
236	111.2	102.63	8.57	236 + 06								

96-12259-7

#1065 - Tap - 326 Platt - 5-23-22  
 #1064 - Tap - 2118 E. 3rd - 4-6-31 - V.H. Patton  
 #41 - 2111 E. Central - 6-1-34 - B.C.M. Cartney & L.C. Cherry (Used old conn.)  
 #2118 - 2111 E. Central - 3-6-40 - Rex E. Boyer - (Used old conn.)  
 #1859 - Tap - 2015 E. Central - 12-20-44 - Wichita Pbg. (New Wgo 12+22) 11-29-68 - Sewer Mtr Rebuilt Line  
 #1248 - 2001 E. Central - 6-51-54 - (Used old conn.)  
 #5244 - Tap - Rear - 422 Platt - 7-13-51 - C. Lee Tade  
 #5678 - Trailer - 2023 E. Central - 8-24-51 - Joe McDonald - Tap  
 #5870 - Tap - Trailer - 414 Platt - 9-21-51 - Self Pbg.  
 #6579 - Private line - 2023 E. Central - 11-24-51 - Joe McDonald - Trailer