

SANITARY SEWER RESPONSE PLAN
 PHASE - IA
 PROJ. NO. 468-82420 (623124)
 BUILT BY INSITUFORM PLAINS, INC.

S.S. No. 12, Dist. E - 1911
 Dist. G - 1912

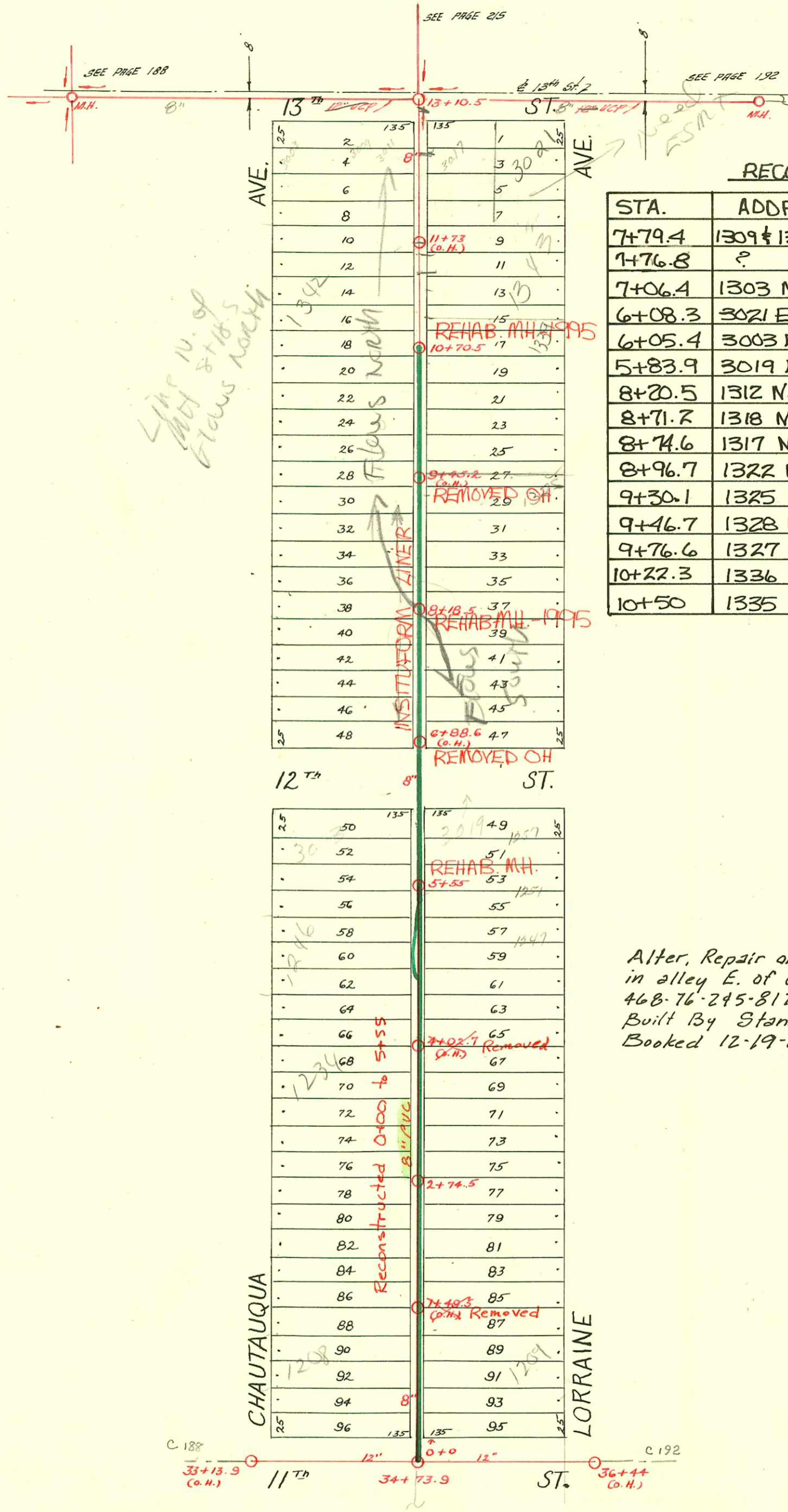

RECONNECTIONS

STA.	ADDRESS	DIRECTION
7+79.4	1309 & 1311 N. Lorraine	East
7+76.8	? N. Chautauqua	West
7+06.4	1303 N. Lorraine	East
6+08.3	3021 E. 12TH St.	East
6+05.4	3003 E. 12TH St.	West
5+83.9	3019 E. 12TH St.	East
8+20.5	1312 N. Chautauqua	West
8+71.7	1318 N. Chautauqua	West
8+74.6	1317 N. Lorraine	East
8+96.7	1322 N. Chautauqua	West
9+30.1	1325 N. Lorraine	East
9+46.7	1328 N. Chautauqua	West
9+76.6	1327 N. Lorraine	East
10+22.3	1336 N. Chautauqua	West
10+50	1335 N. Lorraine	East

*Line N. of
 12th St to
 8th St
 flows north*

Alter, Repair or Reconstruct San. Sewer
 in alley E. of Chautauqua from 11th to 12th
 468-76-245-81772-000-000-001
 Built By Stannard Const.
 Booked 12-19-88 from Insp. Cards

CHAUTAQUA

LORRAINE

CONSTRUCTION RECORD

SERVICE RECORD

STATION	ELEVATION		Depth	MANHOLE	4-INCH "Y" BRANCHES		No. of Permit		House Number		DATE OF PERMITS	
	Ground	Grade			North West	South East	North West	South East	North West	South East	North West	South East
33	139.30	132.41	6.89	33 + 13.9 (O.H.)								
34	139.40	133.21	6.23									
	140.37	133.60	6.77	34 + 73.9								
35	141.35	134.80	6.55									
36	145.71	136.80	8.91	36 + 44 (O.H.)								
0	141.45	133.90	7.55	0 + 00	0 + 36.5	0 + 39	#2342		1202 N. Chautauque		11-4-49	
					+62	+64.5						
					4" SCH 40 +87.5	+90	#433	#443	1208 N. Chautauque	1209 N. Lorraine	see below 7-23-48	7-9-01 4-30-25
1	142.88	135.90	6.98	1 + 14	1 + 16.5							
					+39.5	+42		#229	1211 N. Lorraine			3-29-50
					+65.5	+68						
					4" PVC 40 +91	+93.5	#15884-7 #2407	#2479	1218 N. Chautauque	1217 N. Lorraine	10-3-44 4-6-49	4-13-49
2	144.64	137.90	6.74	2 + 17	2 + 19.5							
					+42.5	+45	#2408	#2480	1222 N. Chautauque	1221 N. Lorraine	4-6-49	4-13-49
	146.42	139.38	7.04	2 + 74.5	+68.5	+71						
					+94.5	+97		#2481	1225 N. Lorraine			4-13-49
3	147.00	139.90	7.10	3 + 18	3 + 20.5							
					+44	3 + 46.5	#1397	#17133	1226 N. Chautauque	1233 N. Lorraine	10-1-29	10-14-26 3-20-26
					+70	+72.5	#3939		1234 N. Chautauque		1-11-06 2-26-57	
					+95	+97.5						
4	150.05	141.90	8.15	4 + 20.5	4 + 23							
					+45.5	+48	#1744		1240 N. Chautauque	1241 N. Lorraine	7-28-39	
					+70	+72.5	#2652	#867	1246 N. Chautauque	1247 N. Lorraine	1-3-44 12-2-49	10-29-46 9-6-50
					+95.5	+98		#2246				
5	153.41	143.90	9.51	5 + 21	5 + 23.5							
	154.79	144.74	10.05	5 + 55	+47	+49.5	#10979 #1205	#3023	1252 N. Chautauque	1245 N. Lorraine	10-2-48 5-26-24	1-11-50 1-6-72 10-18-47
					+73	+75.5	#945		3019 E. 12th			
					+99		#37		3003 E. 12th		3-4-50	
6	156.49	145.90	10.59	6 + 25	6 + 01.5							
					+99.5	+27.5						
7	159.42	147.90	11.52	7 + 02	7 + 02							
					+26	+26	#21049 #1206	#598	3002 E. 12th	1303 N. Lorraine	1-23-73 6-6-50	9-3-46
					+49	+51.5						
					+75	+77.5	#237	#944	1308 N. Chautauque	1309 N. Lorraine	6-19-48	10-18-47
					+99.5							
8	161.53	149.90	11.63	8 + 18.5	8 + 02							
	161.74	150.30	11.44		8 + 24	+26.5	#1934		1312 N. Chautauque		4-2-48	
					+48	+50.5						
					+74.5	+77	#1455	#2893	1324 N. Chautauque	1317 N. Lorraine	1-14-48	4-3-46
					+99		#1456		1328 N. Chautauque		1-14-48	
9	160.20	149.20	11.00	9 + 01.5	9 + 01.5							
					9 + 25	+27.5	#4566 #1485	#753	1348 N. Chautauque	1325 N. Lorraine	7-11-74 1-17-48	6-24-29
					+50.5	+53		#533	1327 N. Lorraine			5-10-29
					+76	+78.5						
10	157.14	147.83	9.31	10 + 02	10 + 04.5							
					+28	+30.5	#46033 #1587		1332 N. Chautauque	1335 N. Lorraine	8-1-74 6-6-44	3-10-50
					+53.5	10 + 56		#99				
	155.00	146.87	8.13	10 + 70.5	+78	+80.5	#820		1336 N. Chautauque		7-5-29	
					+98							
11	154.57	146.46	8.11	11 + 06	11 + 00.5							
					+21.5	11 + 24	#1049	#1312	1342 N. Chautauque	1333 N. Lorraine	10-13-95 7-7-19	12-13-28
					+44	11 + 46.5		#1182	1335 N. Lorraine			11-8-28
					+70	+72.5	#1753		1358 N. Chautauque		3-15-48	
					+95.5	+98						
12	153.02	145.09	7.93	12 + 22	12 + 24.5							
					+46.5	+49	#1621		3007 E. 13th	see below 4-4-01 7-28-65		
					+73	+75.5			3017 E. 13th			6-26-44
13	154.48	143.23	11.25	13 + 10.5								

2001-01678- 7/9/01-1209 N Lorraine Ave. Jones Sewer. 4" SCH 40 90' N of mho 100(0190) Tied to clay with Fernco

Aprx 5' from main 2001-00752- 4/4/01- 3009 E 13th - A Henning- 4" SCH 40 Predco 101.6' S of MH 13+10.5 (12+8.9) - 17" W/CO, 1V45, 2H45

2002-02002- 12/27/01- 1209 N. Chautauque - 11-17-74 Seal Blank

#538 - Top - 1233 N. Lorraine - 4-7-54 - Reynolds Pibg. Co
#1031 - Top - 3025 E. 13th - 11-22-27 - 7/2362 - Express Pibg. - 17" W/CO 4" SCH 40 PVC
#2426 - Top - 1212 N. Chautauque - 5-11-48 - Frederick Pibg. Co. 6-25-71 (1+36)
#1807 - Top - 1227 N. Lorraine - 7-7-52 - Simmons Pibg. Co.

71-C # 5138 1212 N. Chautauque 1-29-82 (Jensen)