

S.S. No. 12 - DIST. O
1918

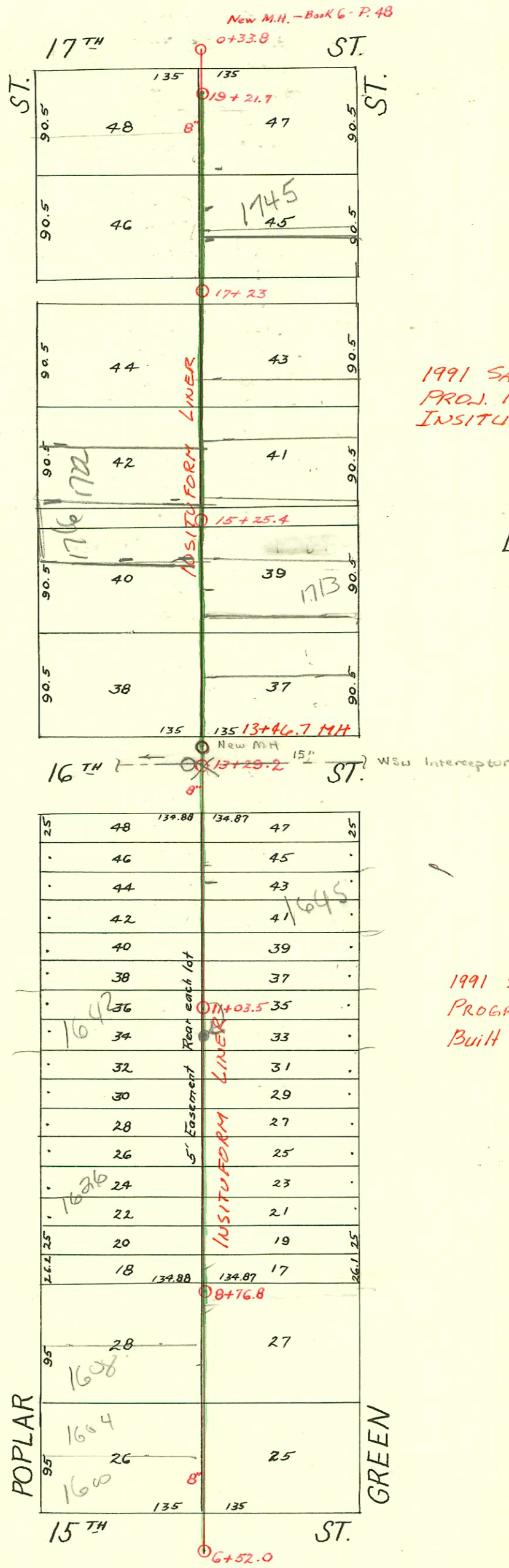

1991 SAN. SEWER RECONST., PART 1
PROJ. No. 468-82140 (630491)
INSITUFORM PLAINS INC.

Lat. K - Dist. O - S.S. #12
Chapin - 1928

1991 SAN. SEW. RECONSTRUCTION
PROGRAM PHASE III
Built by INSITUFORM PLAINS

15+25

POPLAR

GREEN

CONSTRUCTION RECORD

SERVICE RECORD

STATION	ELEVATION		Depth	MANHOLE	4-INCH "Y" BRANCHES		No. of Permit		House Number		DATE OF PERMITS	
	Ground	Grade			North West	South East	North West	South East	North West	South East	North West	South East
6+52				6+52	6+84.1	6+81.6			1600 N. Poplar	1601 N. Green	9-11-29	9-5-29
7+0	126.83	118.01	8.82		7+10.1	7+07.6	#1261	#1222	1600 N. Poplar	1603 N. Green	12-12-41	
					+35.5	+33	#766		1604 N. Poplar	1605 N. Green	5-9-47	12-26-28
					+61	+58.5	#1	#1342	1604 N. Poplar	1605 N. Green		
					+87.3	+84.8						
8+0	126.52	118.17	8.35		8+13.2	8+10.7	#183	#1349	1608 N. Poplar	1611 N. Green	2-24-04	8-2-35
					+37.8	+35.3	#1349	#994	1612 N. Poplar	1615 N. Green	12-28-28	11-18-74
				8+76.8	+68	+65.5	#1349	#1349	1612 N. Poplar	1615 N. Green		8-5-29
					+93.5	+91.0	#108		1622 N. Poplar		2-16-54	3-5-31
9+0	126.70	118.33	8.37		9+18.7	9+16.2	#199	#2580	1626 N. Poplar	see below	8-26-49	
					+45	+42.5	#2580	#2262	1632 N. Poplar	1627 N. Green	11-28-49	3-17-49
					+71	+68.5	#2579		1632 N. Poplar	1633 N. Green	11-28-49	
					+96.5	+94.0	#2579		1636 N. Poplar	1637 N. Green	11-28-49	3-17-49
10+0	126.52	118.49	8.03		10+19.7	10+17.2	#2261	#2578	1642 N. Poplar	1642 N. Green	11-28-49	3-17-49
					+45.8	+43.3	#2578	#2260	1642 N. Poplar	1639 N. Green	11-28-49	
					+71.1	+68.6	#2577	#2196	1646 N. Poplar	1641 N. Green	11-28-49	9-2-50
				11+03.5	10+97.2	+94.7	#2577	#1923	1646 N. Poplar	1641 N. Green	11-28-49	8-12-50
11+0	126.18	118.65	7.53		11+23	11+20.5	#2576	#964	1656 N. Poplar	1645 N. Green	5-13-52	11-21-41
					+48.8	+46.3	#2576	#655	1656 N. Poplar	1657 N. Green	5-13-52	10-17-50
					+74.5	+72.0	#1923	#1503	1700 N. Poplar	1703 N. Green	4-5-50	9-28-72
12+0	126.46	118.81	7.65		12+00.1	11+97.6	#964	#5089	1707 N. Green	1707 N. Green	4-23-79	3-24-30
					+26.3	12+23.8	#655	#1270	1712 N. Poplar	1713 N. Green	6-26-51	8-13-56
					+52.5	+50	#1248	#1058	1716 N. Poplar		5-17-50	12-12-47
					+76.4	+74.5	#1503	#1676	1722 N. Poplar	1721 N. Green	5-4-49	9-12-85
13+0	126.52	118.97	7.55	13+29.2	13+61	13+58.5	#362	#1964	1732 N. Poplar	1735 N. Green	2-25-49	8-6-29
					+87	+84.5	#362	#1964	1732 N. Poplar	1735 N. Green	2-25-49	
14+0	126.75	119.13	7.62		14+12.5	14+10	#236	#5089	1738 N. Poplar	1739 N. Green	2-25-49	12-26-50
					+38.5	+36	#1964	#1450	1742 N. Poplar	1741 N. Green	12-8-48	10-10-29
					+67	+64.5	#5089	#1522	1746 N. Poplar	1745 N. Green	11-15-48	6-23-49
					+92.9	+90.4	#1676	#591	1751 N. Green	1751 N. Green	3-15-49	6-23-49
15+0	127.42	119.29	8.13		15+19.3	15+16.8	#1058	#590	1753 N. Green		10-8-49	1-24-45
				15+25.4	+44.5	+42	#1676	#1884				
					+70.4	+67.9	#167					
16+0	128.15	119.45	8.70		16+22.2	16+19.7	#348					
					+96	+93.5	#348					
					+47.9	+45.4	#1000					
					+73.7	+71.2	#2013					
					+99	+96.5	#2012					
17+0	128.72	119.61	9.11	17+23	17+30.1	17+27.6	#1666	#3460	1742 N. Poplar	1741 N. Green	12-8-48	12-26-50
					+48.1	+45.6	#1102	#1450	1746 N. Poplar	1745 N. Green	11-15-48	10-10-29
					+74.5	+72	#1102	#591	1746 N. Poplar	1745 N. Green	11-15-48	6-23-49
18+0	128.74	119.77	8.97		18+25.5	18+23	#7682	#590	2505 E. 17th	1751 N. Green	3-15-49	6-23-49
					+51.5	+49	#1947	#590	2505 E. 17th	1751 N. Green	3-15-49	6-23-49
19+0	128.22	119.94	8.28		+77.1	+74.6						
19+21.7	127.90	120.00	7.90	19+21.7	19+03.1	19+00.7						

2003-01019 416103 1745 Green - Overnight Sves - City Wye repair 4" Predco 157.6' soft MH at 33.8 2H 22, 1#45 1N22, 1TWIN CO (MSMT OK)

1999-00523-8/26/99-1626 N Poplar - AJ Neal - 4" SCH 40 - Tied back to wye - 1TWIN CO, 1H45

Tap #60448-3-21-77-1745 N Poplar - (18+15.9)

Tap #248-1717 N. Green - 5-23-49 - Wichita Pkg Co.

Tap #5787-1755 N. Green - 9-14-51 - E.H. Headgepatt

Tap #2427-2505 E. 17th - 9-8-52 - Kendall Pkg Co.

Tap #5130 2505 E 17th 8-22-51 Kendall Pkg Co.

Tap #71386-1703 N. Green - 4-24-79 (18+98.9)

C-71386-1703 N. Green - 4-24-79 (18+98.9)