

S.S. No. 12 - Dist. E
1911

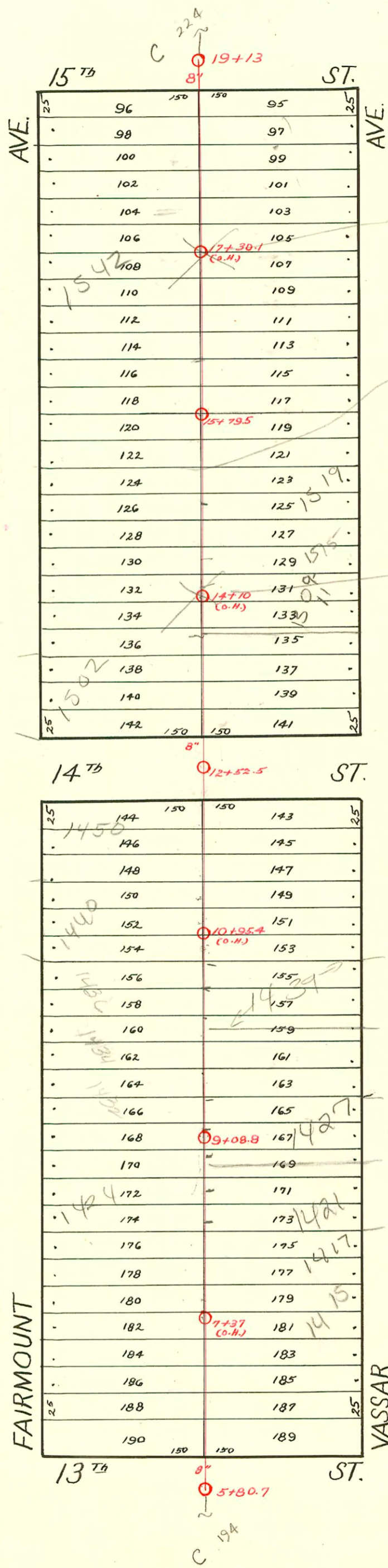

CONSTRUCTION RECORD						SERVICE RECORD						
STATION	ELEVATION		Depth	MANHOLE	4-INCH "Y" BRANCHES		No. of Permit		House Number		DATE OF PERMITS	
	Ground	Grade			North West	South East	North West	South East	North West	South East	North West	South East
5	192.75	184.80	7.95	5 + 80.7								
6	192.84	184.88	7.96		6 + 39 + 59.1 + 84.5	6 + 31.8 + 56.6 + 82	#43	#552			2-8-21	10-7-13
7	194.03	185.28	8.75		7 + 09.5 + 32.9 + 60.6 + 86.5	7 + 07 + 30.4 + 58.1 + 84	#710	#2513	1410 Fairmount	1407 N Vassar	9-18-20	9-27-50
							#711	#128		1415 N Vassar	9-18-20	2-26-30
8	194.41	185.68	8.73		8 + 11.8 + 37.3 + 66.9 + 90	8 + 09.3 + 34.8 + 64.4 + 87.5	#642		1420 Fairmount		6-25-30	
							#392		1428 Fairmount		4-18-29	
9	194.79	186.08	8.71	9 + 08.8	9 + 17.8 + 45 + 70.5 + 96.9	9 + 15.3 Tap 4" Sch 40 + 42.5 + 68 + 93.3	2004-0065	1532 Fairmount	1427 N Vassar	9-21-82	2-14-00	
10	194.90	186.48	8.42		10 + 01 + 22 + 47 + 72 + 91	10 + 19.5 + 44.5 + 69.5 + 88.5	#637		1432 S.O. Fairmount		1-4-73	
							#636	#2549		1447 N. Vassar		8-5-40
11	196.44	186.88	9.56		11 + 20 + 47 + 74.8 + 97.7	11 + 17.5 + 44.5 + 72.3 + 95.2	#814		1437 N. Vassar		7-5-29	
							10735		1457 N. Vassar		4-12-84	
12	197.95	187.28	10.67	12 + 52.5	12 + 23.5 + 94.5	12 + 21 + 92	#960	#823	1450 N. Fairmount	1457 N. Vassar	10-11-21	11-3-20
13	198.88	187.68	11.20		13 + 19.5 + 47.3 + 72.7 + 97.7	13 + 17 + 44.8 + 70.2 + 95.2	#1004		1500-254 Fairmount		8-15-22	
							#106		1510 Fairmount		12-80	
14	199.39	188.08	11.31		14 + 23 + 48.5 + 73.5 + 99	14 + 20.5 + 46 + 71 + 96.5	#262		1512 Fairmount	1509 N. Vassar	3-26-37	4-6-88 3-3-54
							#612		1519 S.O. Vassar		10-9-92	8-23-17
15	199.36	188.48	10.88		15 + 25 + 49.5 + 75.8	15 + 22.5 + 47 + 73.3	#1428	#1294	1518 Fairmount	1525 N. Vassar	4-3-39	12-2-25
16	199.42	188.88	10.54	15 + 79.5	16 + 04 + 29.5 + 54.8 + 72.5	16 + 01.5 + 27 + 52.3 + 70	#141	#124	1520 Fairmount	1527 N. Vassar	4-6-15	9-3-74 3-6-29
							#721				5-11-23	
17	199.83	189.28	10.55		16 + 98 + 48 + 73.8 + 99	+ 95.5 + 84 + 71.3 + 96.5	#964		1522 Fairmount		10-22-47	
							#84		1546-48 Fairmount		3-7-50	
18	198.22	189.68	8.54		17 + 23 + 49.4 + 74.5	17 + 20.5 + 46.9 + 72	#404	#2279	1535 N. Vassar	1557 N. Vassar	7-21-31 8-13-84 10-9-24	
							#2547		1544 Fairmount		9-16-52	
19	195.78	190.08	5.70				#1646		1557 N. Vassar		7-13-44	
	196.44	190.11	6.33	19 + 13								

2002-00750-3/18/02-1417 N Vassar - Bowers Pkg - 4" twin co no msmt

#199 - 1501 N. Vassar - Eugene Reynolds - 3-4-54
 #737 - Tap - 1543 N. Vassar - 9-9-47 - Baker Pkg.
 #261 - 608 wye - 1501 N. Vassar - 3-3-54 - Eugene Reynolds
 #3410 - Tap - 1550 Fairmount - Al Henning - 12-27-82