

1992 SANITARY SEWER REHABILITATION PROGRAM - PHASE I  
 PROJ. NO. 468-82220  
 BUILT BY INSITUFORM PLAINS, INC.  
 BOOKED 3-17-93 FROM AS BUILTS

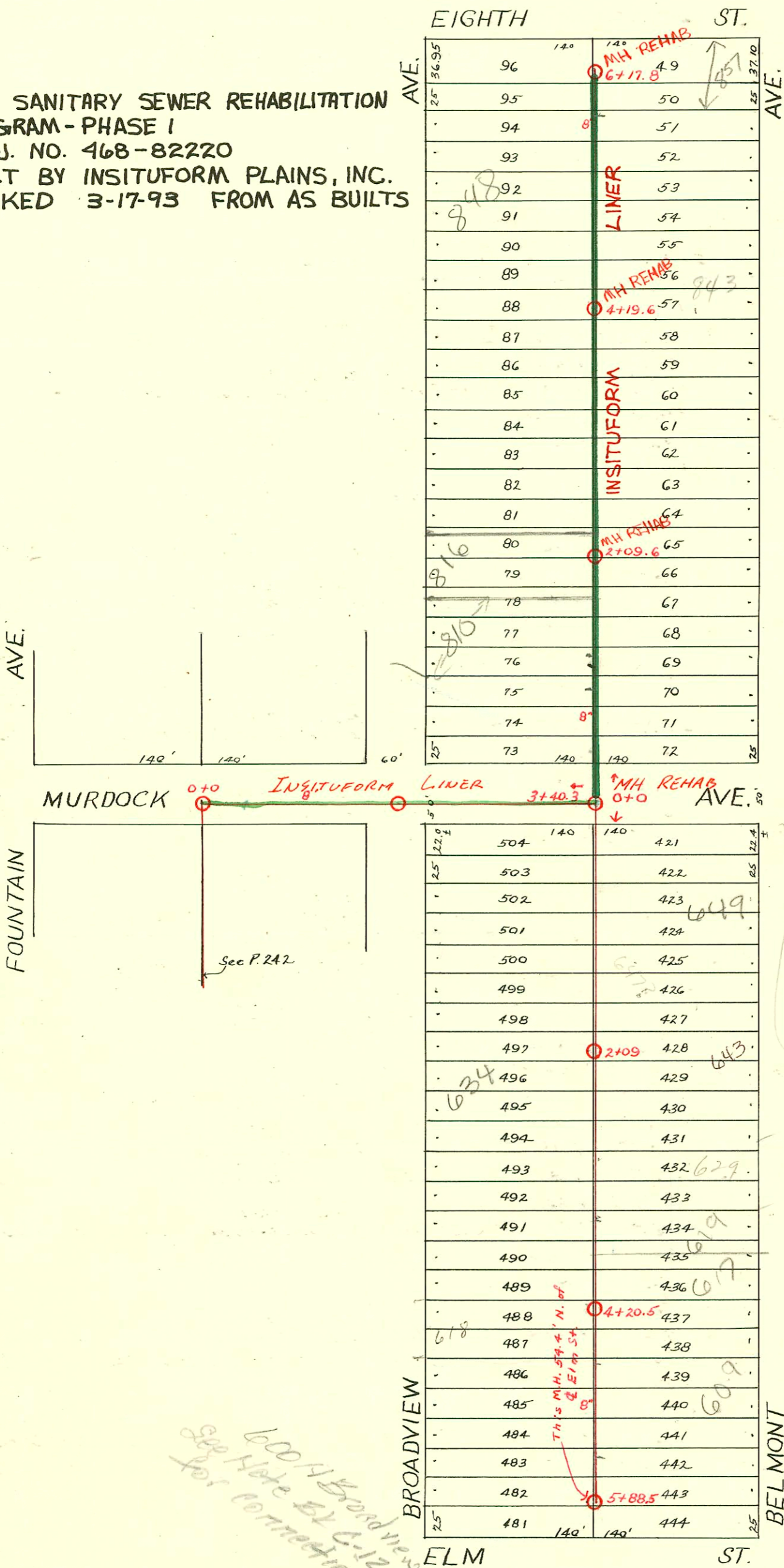

RECONNECTIONS

STATION	ADDRESS	DIRECTION
5+83.5	858 Broadview	West
5+81.1	857 Belmont	East
5+63.6	852 Broadview	West
5+38.7	851 Belmont	East
5+00.7	847 Belmont	East
4+98.6	848 Broadview	West
4+52.4	847 Broadview	West
3+73.6	838 Broadview	West
3+71.2	837 Belmont	East
3+73.3	830 Broadview	West
3+21	837 Belmont	East
2+70.7	827 Belmont	East
2+52.4	822 Broadview	West
2+20.5	819 Belmont	East
1+71	816 Broadview	West
1+68.6	813 Belmont	East
1+23.5	810 Broadview	West
0+98.1	807 Belmont	East
0+73.5	420 Murdock	East
0+52.2	802 Broadview	West

1991 SAN. SEW. RECONSTRUCTION PROGRAM PHASE III  
 BUILT BY INSITUFORM PLAINS

Lined in 2003 - see GBA Records

600 N Broadview  
 See Note BL C-12  
 for connection

CONSTRUCTION RECORD

SERVICE RECORD

Line 17  
Murdock Ave.

STATION	ELEVATION		Depth	MANHOLE	4-INCH "Y" BRANCHES		No. of Permit		House Number		DATE OF PERMITS	
	Ground	Grade			North West	South East	North West	South East	North West	South East	North West	South East
0+0	183.05	175.0	8.05	0+0								
1	184.75	175.30	9.45									
2	187.80	175.60	12.20									
3	192.05	175.90	16.15									
+40.3	193.95	176.02	17.93	3+40.3								

Bet. Broadview  
& Belmont,  
Murdock to 8th

0+0	193.95	176.02	17.93	0+0	0+46.3	0+43.8	#1003		802 N. Broadview		11-10-30	
					+73.3	+70.8	#1903		4220 E. Murdock		8-10-50	
					+96.3	+93.8	#16722		807 N. Belmont		2-28-63	
					1+22.3	1+19.8	#972		810 N. Broadview		11-22-46	
1+0	191.32	176.32	15.0		+47.3	+44.8	#9347		816 N. Broadview	813 N. Belmont	6-17-96	8-2-49
					+70.3	+67.8	#1828	#1109			4-16-47	
				2+09.6	+96.3	+93.8	#1400		819 N. Belmont		8-24-88	10-2-29
					+44.3	+41.8	#1356		827 N. Belmont		1-29-47	
					+69.3	+66.8	#823	#1357	830 N. Broadview	833 N. Belmont	9-3-48	1-29-47
					+95.3	+92.8	#1662	#378	838 N. Broadview	837 N. Belmont	3-21-47	7-10-46
3+0	190.62	176.92	13.70		3+20.3	3+17.8	#823	#1357				
					+46.3	+43.8						
					+71.3	+68.8	#1662	#378				
				4+19.6	+95.8	+93.3	#695		842 N. Broadview	845 N. Belmont	4-6-87	7-10-30
					+47.3	+44.8	#138				6-4-47	
4+0	190.07	177.22	12.85		4+29.3	4+26.8	#138					
					+50.8	+48.3	#417	#394	852 N. Broadview	847 N. Belmont	7-19-48	4-8-50
					+74.8	+72.3						
5+0	190.32	177.52	12.80		5+01.3	+98.8	#417	#394				
					+28.8	5+26.3						
					+58.3	+55.8	#690	#663	858 N. Broadview	857 N. Belmont	9-2-47	8-26-47
6+0	189.66	177.82	11.84		+82.3	5+79.8						
6+17.8	189.02	177.88	11.14	6+17.8	6+08.3	6+05.8						

Bet. Broadview  
& Belmont,  
Murdock to Elm.

0+0	193.94	180.0	13.94	0+0	0+34.5	0+32	#745		658 N. Belmont		4-26-50	
					+60.5	+58	#1638		658 N. Belmont		11-18-29	6-19-02
					+85.5	+83	#57	#867	656 N. Broadview	649 N. Belmont	3-13-36	7-15-29
					1+08.5	1+06	#219		648 N. Broadview		11-19-28	
					1+34.5	1+32	#866		647 N. Belmont		7-15-29	
					1+60.5	1+58	#803		645 N. Belmont		7-30-28	
					1+79.1	1+76.6						
2+0	197.24	181.0	16.24	2+09	2+07	2+04.5	#1065		643 N. R. Belmont	See Below	4-29-02	8-14-29
					+23.5	+21	#75		612 N. Broadview		1-30-28	
					+50	+47.5	#1093		623 N. Belmont		8-19-29	
					+73.5	+71	#1306		644 N. Broadview		9-17-29	
3+0	197.89	181.5	16.39		3+00.5	+97	#1230		629 N. Belmont		11-21-28	
					+25.5	3+23	#1625	#86	636 N. Broadview	619 N. Belmont	11-13-29	3-1-29
					+49.5	3+47						
					+74	3+71.5						
4+0	196.74	182.0	14.74		+99.5	3+97						
				4+20.5	4+18.5	4+16	#438		615 N. Belmont		11-30-92	11-21-28
					+42	4+39.5	#234		612 N. Belmont		6-12-28	
					+68	4+65.5	#624		644 N. Belmont		4-27-28	
5+0	197.79	182.5	15.29		+96.5	+94						
					5+23.5	5+21						
5+88.5	197.34	182.95	14.39		+50	+47.5	#693		601 N. Belmont		6-29-28	
				5+88.5	+82.1	+79.6	#1068		601 N. Belmont		10-2-28	

2008-01427-5/29/03-619 N Belmont - Roto Rooter - Pipe Burst replacement 4" PE SDR 35, City Wye repair, 4x8 Tee 73.5' N of MH 4+20.5 (3+47), tied inside house (NOTE: CITY MAIN TO BE INSULATED LINED - W/BC REPLACING SECTION)

2002-01731-6/19/02-649 N Belmont - Wichita Exc. - City Wye repair - saddle 83's of MH 0+0 (0+83) 1V22, 1V45 4" PVC  
2002-01224-4/29/02-643 N Belmont - Wichita Exc. - 4.6' N of MH 2+09 (2+04.4) 1V20, 1V45, 1V22, Predo Saddle

- 1999-00224 #117 - Tap - 617 N. Belmont - 3-C-29 - Simmons Pkg. Co. (3+85.5) - 2/2/99 Reddi - 4" SCH 40 - 13' S of NPL - 1H22, 1V45
- #1211 - Tap - 642 N. Broadview - 9-4-29 - Home Builders Pkg. Co.
- #918 - Tap - 608 N. Broadview - 7-23-29 - O.O. Oldfather
- #274 - Tap - 4211 E. Murdock - 10-6-41 - A.J. Hoff - (Tapped at 0+64)
- #1820 - Tap - 612 N. Broadview - 11-17-44 - Nelson Pkg. Co.
- #2497 - Tap - 822 N. Broadview - 5-18-48 - Howard Shepherd
- #1602 - Tap - 851 N. Belmont - 7-13-50 - Vaughn Pkg. Co.
- #30 - Tap - 848 N. Broadview - 2-5-54 - Reynolds Pkg. Co. (175' S. of MH)