

SCALE 1"=400'

TOWNE WEST SQUARE SAN SEWER  
BUILT BY: MID STATES CONST. CO.  
PROJ. NO DBKW 707075  
BOOKED 10-10-78 FROM ARGSS

on map

7-55

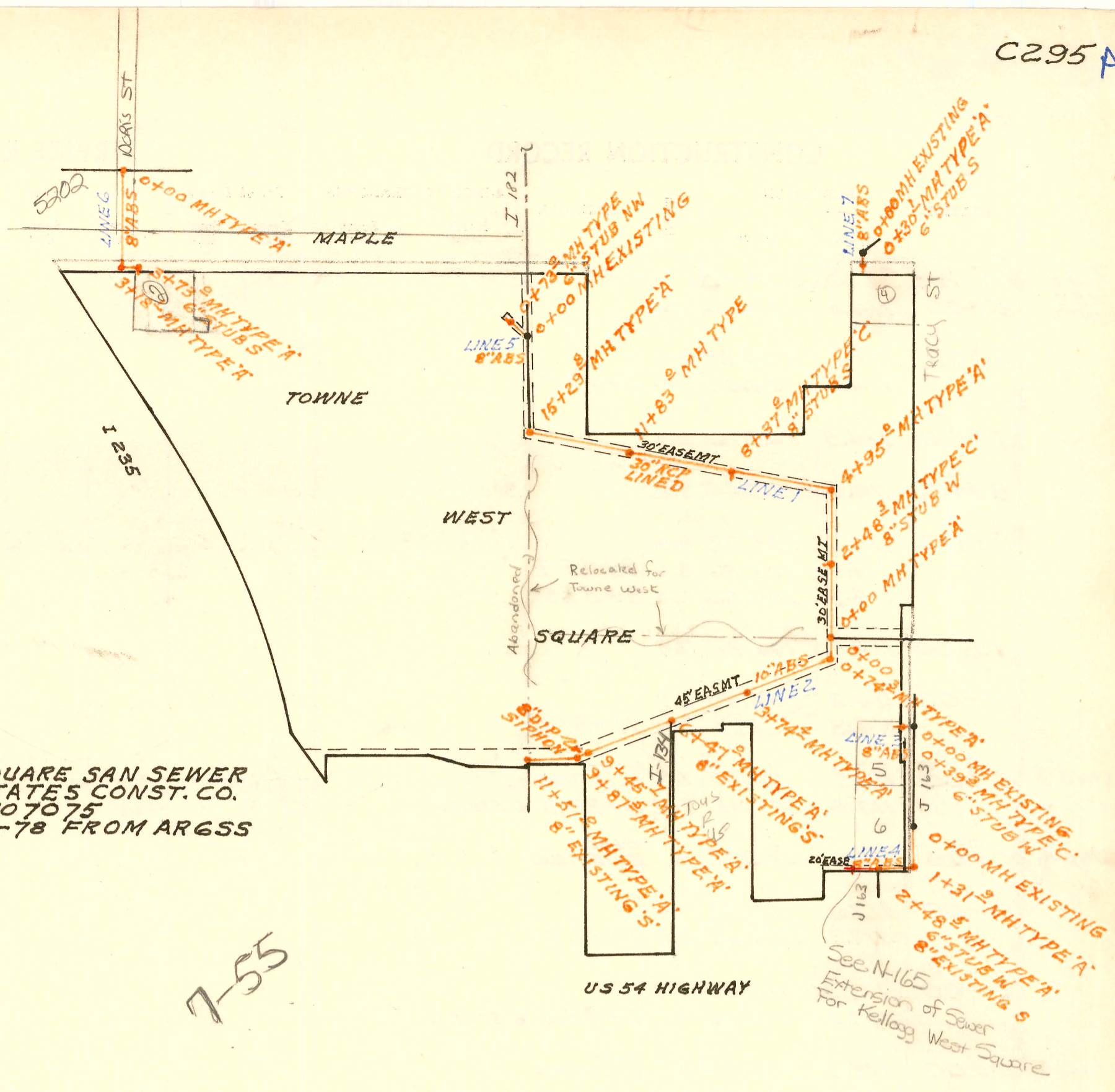

CONSTRUCTION RECORD

SERVICE RECORD

STATION	ELEVATION		Depth	MANHOLE	4-INCH "Y" BRANCHES		No. of Permit		House Number		DATE OF PERMITS	
	Ground	Grade			North West	South East	North West	South East	North West	South East	North West	South East
<b>THE TIMBERS CONT'D</b>												
LINE 2 5+00	229.1	219.25	9.9	5+90.0								
	229.0	219.59	9.4									
6+00	228.8	219.83	9.0									
7+00	228.5	220.23	8.3	7+22.7								
	228.3	220.32	8.0									
8+00	229.0	220.84	8.2									
9+00	229.7	221.24	8.5	9+69.2								
	229.7	221.51	8.2									
10+00	229.4	221.84	7.6									
	229.0	222.22		10+94.3								
LINE 3 0+00	228.3	220.52	7.8	0+00=7+22.7	LINE 2							
	1+00	228.0	220.94	7.1								
	227.3	221.26	6.0	1+78.3	4" STUB W							
<b>SEE PAGE C302</b>												
<b>TOWNE WEST SQUARE SANITARY SEWER</b>												
LINE 1 0+00	115.8	101.48	14.3	0+00								
1+00	115.2	101.53	13.7									
2+00	114.3	101.58	12.7	2+48.3	8" STUB W							
	113.6	101.61	12.0									
3+00	113.8	101.63	12.2									
4+00	114.7	101.68	13.0	4+95.0								
	113.6	101.79	11.8									
5+00	113.7	101.79	11.9									
6+00	113.6	101.84	11.8									
7+00	113.7	101.89	11.8									
8+00	113.8	101.94	11.9	8+37.0	8" STUB S							
	113.7	101.96	11.7									
9+00	113.3	101.99	11.3									
10+00	113.7	102.04	11.7									
11+00	114.1	102.09	12.0	11+83.0								
	113.9	102.14	11.8									
12+00	113.8	102.15	11.7									
13+00	114.1	102.19	11.9									
	115.2	102.24	13.0									
15+00	115.2	102.29	12.9	15+29.8								
	115.1	102.37	12.8									
LINE 2 0+00	115.8	103.10	12.7	0+00=0+00	LINE 1							
	114.0	103.31	10.7									
1+00	114.1	103.48	10.6	0+74.3								
2+00	113.6	103.76	9.8									
3+00	113.6	104.04	9.6	3+74.4								
	113.8	104.25	9.6									
4+00	114.0	104.32	9.7									

42544-8/14/90-2021 N Old Manx (Chapel)-UK - 4" ABS 40 tied onto line serving Admin. Bldg #1300 - See Letter att'd)