

SEC. A - SUB-MAIN R - 1919
LAT. C OF R - 1917
S.S. NO. 20

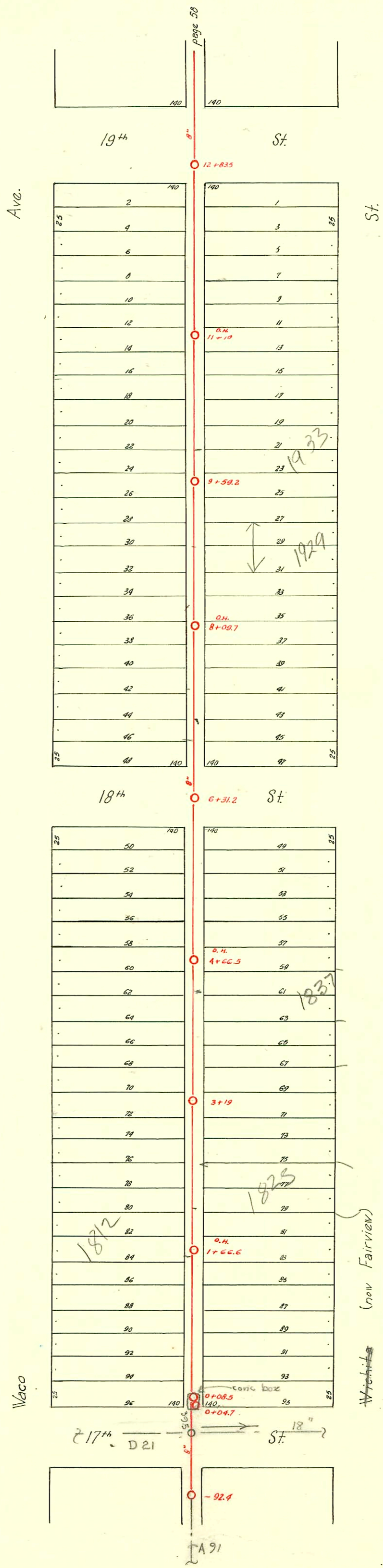

D-65

CONSTRUCTION RECORD							SERVICE RECORD					
STATION	ELEVATION		Depth	MANHOLE	4-INCH "Y" BRANCHES		No. of Permit		House Number		DATE OF PERMITS	
	Ground	Grade			North West	South East	North West	South East	North West	South East	North West	South East
-92.4				M.H. South of 17th St								
0	124.74	115.00	9.74	North line of 17th St								
				0+04.7	0+19.0	0+16.5	#1162		1802			5-20-24
				0+08.5	+33.5	+31.0	#1094	#140	1802			5-13-24
					+63.7	+61.2	#768		1800			3-10-19
					+85.0	+82.5			1800			
1	125.02	115.10	9.92		1+08.0	1+05.5			1810	1810		
					+31.3	+28.8	#424	#674	1800	Fairview		5-21-20
				1+66.6	+58.5	+56.0	#1298		1822			8-31-23
					+84.0	+81.5		#339	1817	Fairview		3-3-24
2	123.62	115.20	8.42		2+02.7	2+02.2			1822			
					2+32.2	+29.7	#202		1822			2-15-24
					2+37.7	+35.2	#413	#1530	1822	Wichita		4-22-25
					+83.5	+81.0						10-17-23
3	123.39	115.30	8.09		3+02.5	3+06.0			1828			
				3+19.0	+35.7	+33.2	#2582		1800			11-20-24
					+58.8	+56.3	#466		1800-90			6-17-26
					+82.6	+81.1		#770	1853	Wichita		7-13-25
4	123.85	115.40	8.45		4+8.9	4+06.4			1842			
					+32.0	4"40PVC +31.5	#720	2003-01656 #867	1842	1837 R See Below Wichita		6-23-22
				4+66.5	+58.4	+56.4			1839	Fairview		10-11-26
					+84.3	+81.8	#77	#1529	1854	Wichita		2-6-20
5	123.31	115.50	7.81		5+07.7	5+05.2	#908		1834 1834 7 Waco			10-17-23
					+32.5	+30.0		#343	1837	Wichita		9-28-21
					5+58.6	+56.0	#905		1856 Waco			4-18-22
					+83.0	+80.5		#238	1837	Wichita		12-20-17
6	122.34	115.60	6.74		6+28.0	6+65.5			1902			
				6+31.2	6+90.5	+88.0	#161		1903	Wichita		2-12-24
7	121.80	115.70	6.10		7+15.5	7+13.0	#722	#2368	1915	Wichita		9-22-20
					+43.5	+41.0		#570	1915	Wichita		2-26-24
					+69.1	+66.6						
					+94.0	+91.5		#1685	1917	Wichita		12-2-29
8	122.29	115.80	6.49	8+09.7	8+20.3	8+17.8	#833	#276	1914	1915 Fairview		11-9-20
					+45.5	+43.0		#854	1918	Waco		11-20-20
					+70.9	+68.4		#614	1929	Wichita		6-8-28
					+96.0	+93.5		#3706	1920	Waco		6-10-41
9	121.55	115.90	5.65		9+19.3	9+16.8			1931	Wichita		
					+46.9	+44.4		#615	1938	Waco		6-8-28
				9+59.2	+69.5	+67.0	#1500		1938	Waco		6-27-24
					+94.5	+92.0		#589	1938	Wichita		3-27-24
10	120.84	116.00	4.84		10+20.5	10+18.0			1950			
					+45.5	+43.0	#454		1932	Waco		6-1-26
					+71.8	+69.3	#127	#1655	1941	Wichita		2-18-28
					+94.9	+92.4	#186	#980	1931	Wichita		11-10-23
11	119.14	116.10	3.04	11+10.0	11+20.3	11+17.8			1931	Wichita		3-12-30
					+45.5	+43.0		#1048	1929	Fairview		2-8-25
					+69.5	+67.0		#115	1957	Wichita		12-5-46
					+92.7	+90.2	#35		1954	Waco		1-9-24
12	120.72	116.20	4.52		12+15.7	12+13.2	#4309		317 West 1914			1-20-20
					+41.2	+38.7		#714	1954	Wichita		4-5-41
				12+83.5								1-22-19

2003-01656 6/24/03 1837 Fairview Padgett Ex - Citywide Repair 4" Precast 112.6' N of MH 3+19 (4+31.6) 1V45, 1V22, 1H22
1 TWIN Co, Fernco, Shallow, 4" 40 PVC

Repair
C36961 - 319 W. 18th - 2-1-13 (5+61.7)
#33 - Tap - 1856 W. Waco - 4-21-33 - V. Shellenberger
#1782 - Priv. de. Line - 1815 Fairview - 10-25-44 - J. M. Hanna