

DIST. K - S.S. NO. 20 - 1920
DIST. Y - S.S. NO. 20 - 1920

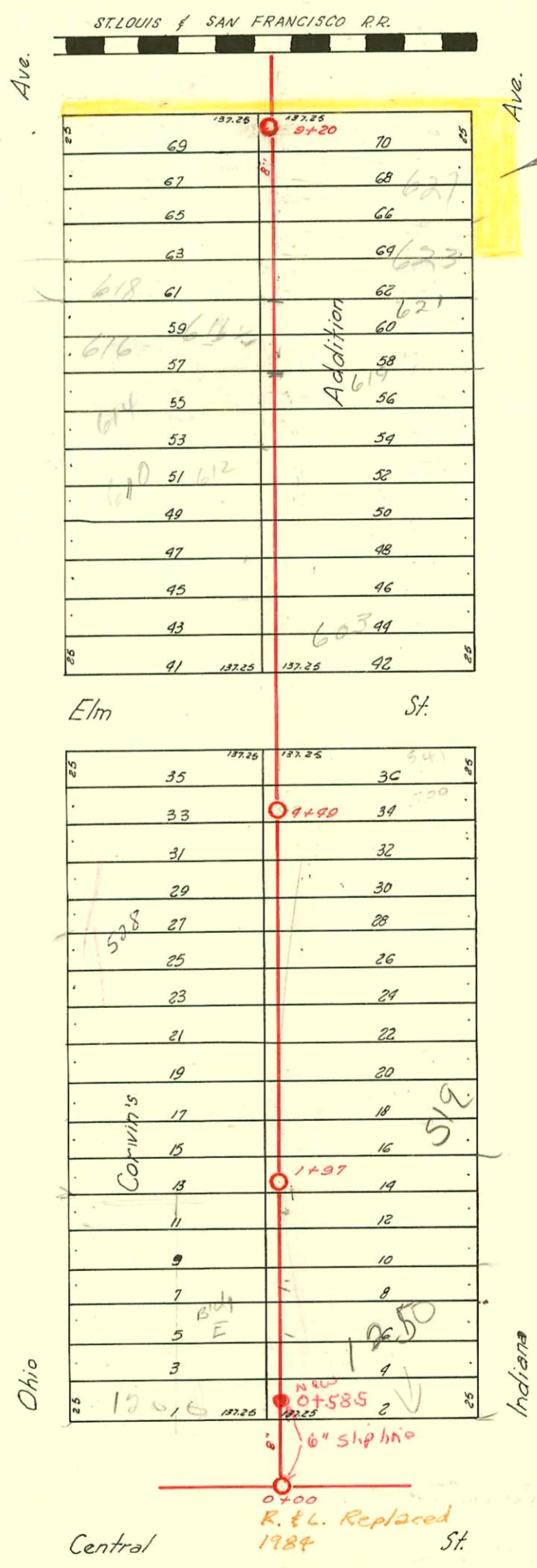

Vgc
Ord. No. 23-675

Ohio

Indiana

0+00
R. & L. Replaced
1984

CONSTRUCTION RECORD							SERVICE RECORD						
STATION	ELEVATION		Depth	MANHOLE	4-INCH "Y" BRANCHES		No. of Permit		House Number		DATE OF PERMITS		
	Ground	Grade			North West	South East	North West	South East	North West	South East	North West	South East	
0+0	111.76	104.70	7.06	0+00	0+54.5	0+52.0	#1223	#294	1222 E Central 1222			7-27-36	
1+00	111.05	104.00	6.15		+81.5	0+79.0	#1223	#1049	E Central 1222			12-9-21	8-21-22
					+35.5	1+33.0							
					+61.0	1+38.5							
					+87.5	1+85.0							
				1+97.0				#276	513 Indiana			6-17-46	
2+00	111.07	105.10	5.97		2+14.5	2+12.0	#714	9783	516 Ohio			4-7-24	
					+38.1	+35.6		#6654	521 Indiana				10-12-55
					+64.5	+62.0		#146	519 Indiana			11-5-76	3-8-21
					+89.5	+87.0		#323	520 Ohio			4-30-63	9-15-22
3+00	111.53	105.30	6.23		3+17.0	+31.0		#2310	521 Indiana			3-14-21	10-20-54
					+42.5	+40.0		#2406	528 Ohio				10-20-24
					+68.5	+66.0		#1891	525 Indiana				12-21-23
					+93.8	+91.3		#1134	527 Indiana				7-31-23
4+10	111.93	105.50	6.43	4+49	4+20.5	4+18.0	#1794	#997	536 N. Ohio			11-16-77	
					+46.8	+44.3		#716	534 Ohio			2-11-70	
					+62.0	+60.0		#34947	536 Ohio			7-7-24	7-20-38
4+75	112.45	105.65	6.80		4+72.5	+87.0	#876	#396	541 Indiana			10-16-80	9-17-24
					+87.0	+84.5		#1011	541 Indiana			9-17-24	9-17-24
					+96.5	+94.0		#1137	603 Ohio			8-12-80	7-20-38
5+25	112.35	105.75	6.60		5+22.5	+87.0	#1600	#1137	603 Ohio			7-21-24	7-31-23
					+87.0	+84.5		#1137	603 Ohio			7-21-24	7-31-23
5+85	112.60	105.87	6.73		5+82.5	+83	1521	#1136	603 Ohio			10-16-80	7-31-23
6+35					+12.5	6+10		#256	64 Indiana				5-7-80
					+38.5	+36		1128	64 Indiana				7-30-23
					+59.5	+57		#100506					
					+84.5	+82		#392	610 Ohio			6-10-80	6-9-24
					+11.5	7+09		#4723	612 Ohio			12-8-65	8-5-68
					+36.7	+34.2		#1364	615 Indiana			4-21-67	6-6-29
					+58	+60.5		#1232	618 Ohio			11-12-25	6-6-29
					+89.5	+87		#1886	619 Indiana			5-4-69	12-21-23
					8+13.5	8+11		#1171	623 Indiana				10-23-25
					+39	+36.5		#937	623 Indiana				9-29-29
					+65	+62.5		#185	627 Indiana				5-22-24
					+91	+88.5							
				9+20	9+14	9+11.5							

98-974-7 1-23-48 519 N Indiana - Miller
 97-19954-7 11-2-97 1250 E. Central - Buckle Building
 97-16788-7 9/22/47 1210 E Central - Adsett
 97-108-7 1-6-96 1200 E. Central Bldg E - NC Betzen -

5/6 12216 (1208 E Central) 10-11-84 Henning
 C 39641 - Sealoff 532 Ohio 12-23-71 - Al Henning (3+43)
 C 26503 - 524 Ohio - 8-16-71

#1123 - Top - 619 Indiana - 8-31-22
 #196 - Private Line - 1202 E. Central - 4-15-31 - Miller / Cherry Pkg. Co.
 #506 - Top - 1206 E. Central - 10-10-31 - L.W. Murphy
 #373 - Used old connection - 1200 E. Central - R. LaFay - 9-18-36
 #2311 - Top - 521 Indiana (Rear) Lee Layton Pkg. - 10-30-54
 9258 Top 518 Ohio Shampers Pkg. - 6-30-58

Sealoff C 28161 - 616 Ohio - 9-23-71

534 N. Ohio #58516 - Top (3+46) 11-5-76