

DIST. L-S.S. NO. 20-1919

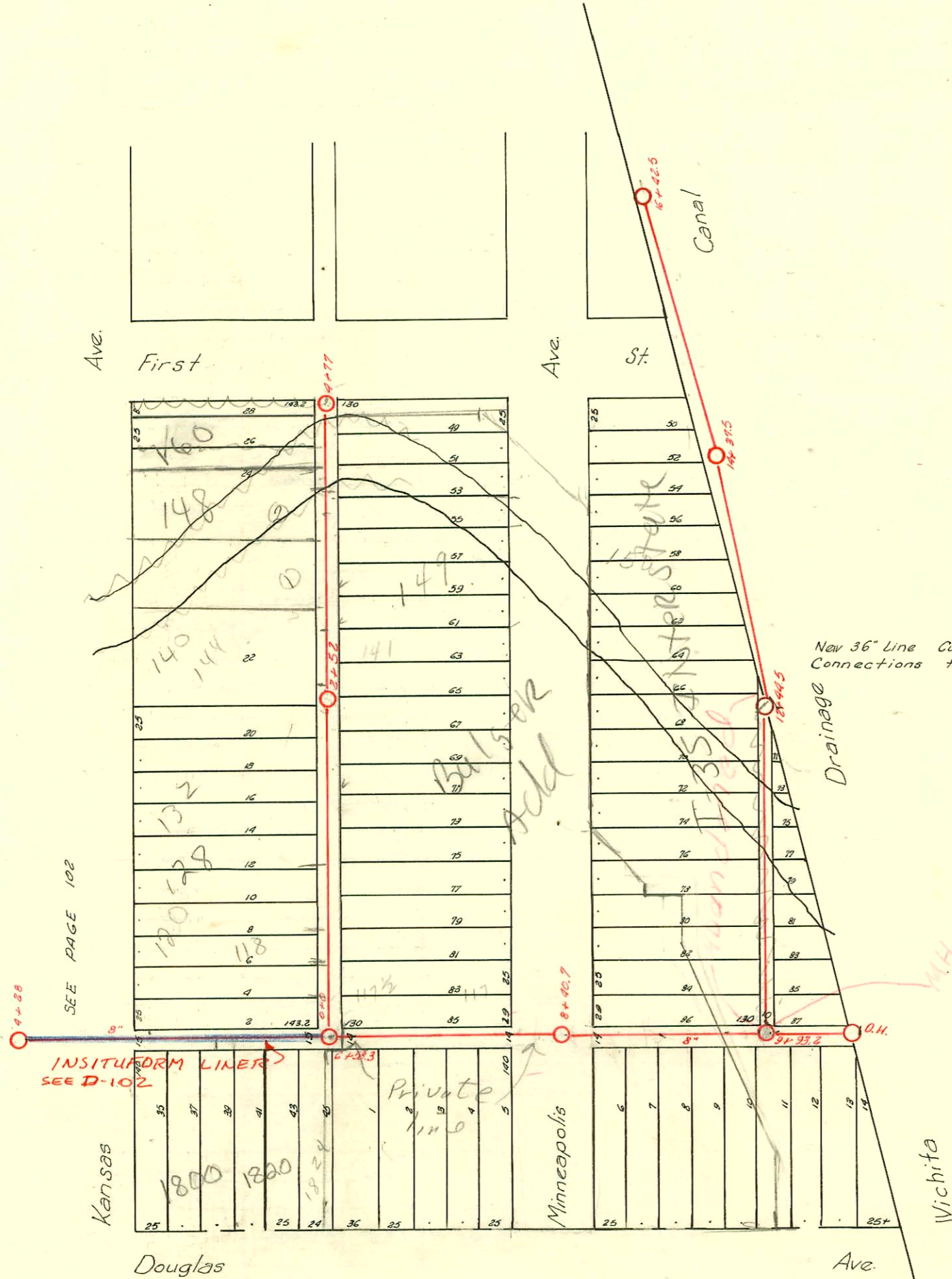

New 36" Line Cuts Thru 8" Line. Killed North of That Place. Connections to be made into new 36" Line Cross Connection: Page 214.

MH Filled
3/11/62 P. 12/19/62

Plat 16-49

Tap - C22012 - 1900 E. Douglas - V.M. Chakraborty - 12-2-70 (9+53.0)
(Balisek - Cadillac)

recon - 16022 - 1800 E. Douglas - 3-31-86 James Sadtman (s/o wye meas. OK. Edge of alley 4" clay top (4.5W))
recon - 16021 - 1816 E. Douglas - 3-31-86 James Sadtman
recon - 16023 - 1820 E. Douglas - 3-31-86 James Sadtman See Below
recon - 16024 - 1824 E. Douglas - 3-31-86 James Sadtman

96-12995.7 8/19/96 142 N Kansas (Rear House)

1999-00449-3/17/99-1820 E Douglas - BIL - 4" SCH 40 - Tied to wye - ITWIN CO, 1 KICKOUT, 1V45

2002-00101 1/16/02 128 N Kansas AE Henning - City wye repair 131' N of MH 0700 (1+31) dirt alley cut, 11/22

D-103

Form 41-(54) 8-58

CONSTRUCTION RECORD						SERVICE RECORD						
STATION	ELEVATION		Depth	MANHOLE	4-INCH "Y" BRANCHES		No. of Permit		House Number		DATE OF PERMITS	
	Ground	Grade			North West	South East	North West	South East	North West	South East	North West	South East
5+00	109.01	100.27	8.74		5+21		#466		1812 E. Douglas		6-2-27	
					5+48							
					5+76							
6+00	108.51	100.41	8.10	6+58.3					1820 E. Douglas			
					6+01							
					6+25							
					6+52							
					6+89.1		#416618 2991		1830 (S10) E. Douglas		7-14-86 4-29-46	
7+00	108.40	100.55	7.85		+16.5	+14						
					+40.2	+37.7						
					+66.8	+69.3	12369		1900 E. Douglas		10-22-84	
					+91.8	+89.3						
8+00	109.19	100.69	8.50	+40.7	+73.2	+70.7	#1013		1906 E. Douglas		2-24-47	
					+99.5	+97						
9+00	108.85	100.84	8.01	+93.2	+23.9	+21.4						
					+48.1	+45.6	#599		1908 E. Douglas		7-2-20	
					+78.5	+76						
10+00	108.17	100.99	7.18		+21.7	+19.2						
					+43.6	+41.1	#1167		1906 E. Douglas		12-23-46	
					+68.4	+65.9						
					+94.5	+92.0						
11+00	109.46	101.14	8.32		+19.3	+16.8						
					+44.7	+42.2						
					+70.7	+68.2						
					+96.2	+93.7						
12+00	109.91	101.29	8.62	+44.5	+21.7	+19.2						
					+49.9	+47.4						
					+76.7	+74.2						
13+00	108.54	101.44	7.10		+04.7	+02.2						
					+31.2	+28.7						
					+61.5	+59.0	#582		1903 E. First		4-20-23	
					+82.2	+79.7	#394		1907 E. First		4-20-25	
14+00	108.86	101.59	7.27	+37.5	+11.7							
					+44.8							
					+68.6							
					+90.2							
15+00	109.34	101.74	7.60		+40.2							
					+66.6							
					+96.2							
16+00	109.08	101.89	7.19	+42.5	+22.2		#1357		1900 E. First		9-14-23	
					+38.2							
0+0	108.09	102.08	6.01	0+0 OR 6+58.3	+31.3	+28.8						
					+57	+54.5	#195		116 N. Kansas		6-2-72	
					+82	+79.5	10944		121 N. Minn.		3-18-20	
									130 N. Kansas		4-21-20	
1	108.06	102.28	5.78		+06	+03.5						
					+31.7	+29.2	#20072		see N. Minn.		4-23-20	
					+58	+55.5	146		127 N. Minn.		1-11-02	
					+83.3	+80.8	19147		132 N. Kansas		2-9-24	
							334		132 N. Kansas		11-22-54	
							337		Minneapolis		4-28-20	
							337				7-8-69	
							337				10-6-21	
2	108.01	102.48	5.53	2+52	+07	+04.5	#335		136 N. Kansas		4-28-20	
					+35.7	+33.2						
					+60.8	+58.3	#367		140 N. Kansas		7-8-69	
					+87.8	+85.3	14821		141 N. Minn.		5-4-20	
					+14.0	+11.5						
					+40.1	+37.6						
					+70.5	+68.0						
					+91.7	+89.2						
3	109.00	102.68	6.32	3+3	+16.6	+14.1						
					+44.9	+42.4	#693		156 N. Kansas		3-4-21	
					+67.8	+65.3	337634		160 N. Kansas		2-5-73	
4	108.84	102.38	5.96	4+77								
0+0				0+0 or 9+93.2	North	South						
					0+25	+27.5						
					+45	+47.5						
					+60	+62.5						

#568-Top-140 N. Kansas-6-4-30-Home Builders Pkg. Co.
 #61-Top-1918 E. Douglas-4-4-35-LaFay
 #1852-Top-154 N. Minneapolis-5-16-42-Dermody Pkg. Co.
 #1853-Top-126 N. Minneapolis-5-16-42-Dermody Pkg. Co.
 #1854-Top-199 N. Minneapolis-5-16-42-Dermody Pkg. Co.
 #358-117 N. Minneapolis-10-3-47-Ray Bryant
 #6507-Top-149 N. Minneapolis-11-21-51-Moore-Robertson
 #3040-Top-148 N. Kansas-Laulling Pkg.-11-14-56
 #3681-Top-146 N. Kansas-M. Donald-2-6-57-C42055-Suboff. 11/5/73-Al Henning (9+60)
 #1000-Top-1800 E. Douglas-Lithrich Pkg 4-10-59 5+73.1
 #5906-19-2-51-Suboff. 11-22-67 Al Henning
 #5907-153 7th Minneapolis-Suboff. 11-28-67 Al Henning
 #11565-19930-144 N. Kansas-Rob Scott-
 8-30-88 21402-148 N. Kansas-Al Henning-(0+63)