

DIST. F-S.S. NO. 20-1920

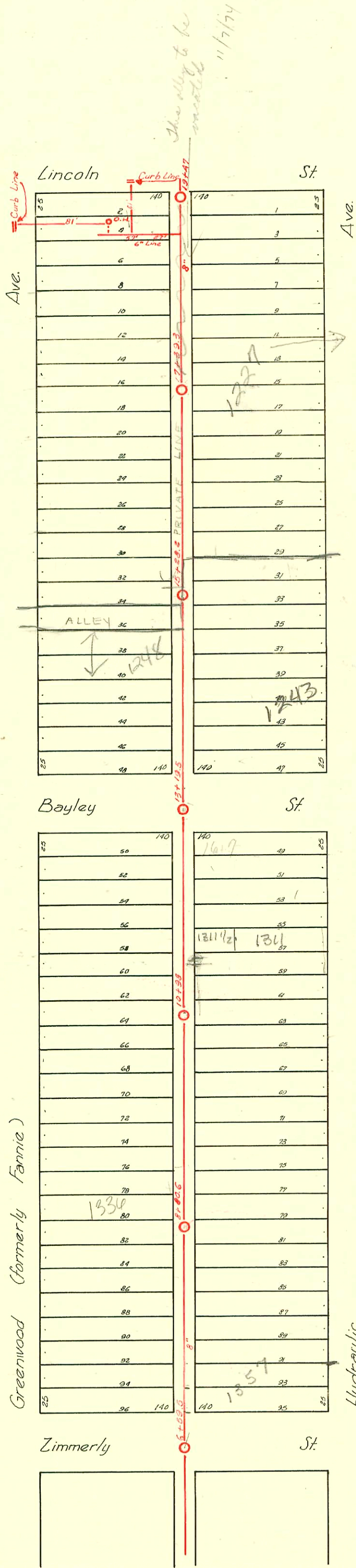

D-112

CONSTRUCTION RECORD						SERVICE RECORD						
STATION	ELEVATION		Depth	MANHOLE	4-INCH "Y" BRANCHES		No. of Permit		House Number		DATE OF PERMITS	
	Ground	Grade			North West	South East	North West	South East	North West	South East	North West	South East
6+00	103.43	96.19	7.24	6+59.5								
					+97	4"sch 40 PVC 6797.3 to 90.5	#2233	#404	1350 Fannie	1350 K Hydraulic		6-22-92 5-13-21
7+00	103.67	96.57	7.10									
					7+23.5	7+21	#2233	#430	1350 Fannie	1351 S. Hydraulic	10-2-24	
					+49	7+46.5	#397		1346 Greenwood		1-22-42	5-1-22
					+76	+73.5						
						+98.5						
8+00	104.47	97.07	7.40	8+30.6								
					9+51		#1360		1342 Fannie		12-29-25	
					+86.5	8+24	#611		1340 Fannie		6-4-25	
					+52.5	+50	#1303	#1172	1345 Fannie	1345 S. Hydraulic	6-30-24	9-11-22
					+72.2	+76	#611		1340 Fannie		6-9-25	
9+00	105.29	97.57										
					9+04	+01.5	#627	#437			6-7-22	10-30-22
					+30.5	+28						
					+56	+53.5	#1234	#1337	1330 Fannie		5-29-24	10-11-22
					+82.5	+80						
10+00	105.69	98.07	7.62	10+93								
					10+08.5	10+06	#1577		1328 Fannie		7-9-24	
					+32	+29.5		#1113		1321 S. Hydraulic		8-30-22
					+57.5	+55		#2538		1317 S. Hydraulic		8-7-40
					+83	+80.5						
11+00	106.44	98.57	7.87									
					11+10.5	+08	#1388	#1980	1312 Fannie		5-29-25 7-9-24	
					+35.5	+33		#1021		1315 S. Hydraulic		10-29-47
					+61.5	+59		#412		1311 S. Hydraulic		3-23-23
					+87	+84.5	#1579		1310 Fannie		7-9-24	
12+00	107.69	99.07	8.62									
					12+12.5	+10	#491		1306 Fannie		5-13-30	
					+33	+35.5						
					+63.5	+61	#616	#797	1302 Fannie	1303 S. Hydraulic	6-19-30	8-20-26
					+85	+82.5						
13+00	107.72	99.57	8.15	13+19.5								
					+57.5	12+55		#317		1261 S. Hyd.		12-23-35
					+82.5	+80	#1023		1612 E. Bayley		9-16-25	
14+00	107.93	100.07	7.86									
					14+03.5	+07						
					+35.5	14+33	#2222	#25231	1250 Fannie	1243 S. Hydraulic	9-29-24	4-27-90
					+61.5	+59	#1567	#1755	1245 Fannie	566 See below	6-23-99	12-26-22
					+88.5	+86		#285	1247 Greenwood	1247 S. Hyd.	8-15-24	6-10-37
15+00	107.98	100.57	7.41	15+28.2								
					15+13.5	+11	#1931	#493	1242 Fannie	1241 S. Hyd.	5-20-74	
					+39.5	+37	#973		1234 Fannie		7-2-24	6-6-21
					+65.5	+63	#44953	#44949	1232 Greenwood	1233 S. Hyd.	5-20-74	
					+93	+90.5	#1686		1235 S. Hyd.		5-20-74	12-8-22
16+00	107.93	101.07	6.86									
					16+19.5	+17	#44948	#44944	1238 Fannie	1235 S. Hyd.	5-20-74	5-20-74
					+45.5	+43	#513		1239 S. Hyd.		5-20-74	12-8-22
					+72.5	+70	#1074	#54	1238 Fannie	1235 S. Hyd.	5-20-74	5-20-74
					+93	+95.5					5-10-24	1-11-23
17+00	107.92	101.42	6.50	17+39.3								
					17+24	+21.5	#44951	#1237	1218 Fannie		5-20-74	
					+49.5	+47					5-29-24	
					+76	+73.5	#44952	#1112	1216 Fannie	1219 S. Hyd.	3-11-74	11-27-22
					+99	+99	#44945	#1616	1213 S. Hyd.		5-15-24	1-3-22
18+00	107.64	101.62	6.02									
					18+01.5		#527		1214 Greenwood		7-29-47	
					+23	+25.5						
					+53.5	+51	#44958	#824	1202 Fannie		5-22-74	9-10-21
					+79.5	+77	#1275				6-3-24	
19+00	106.84	101.82	5.02	19+47								
					19+05	+02.5	#44957	#1289	1200 Fannie	1201 S. Hyd.	5-20-74	5-20-74
					+33.5	+31	#135		1200 Fannie		3-18-29	12-29-21
19+00				+47								

99-12900-07 6/23/99-1248 Greenwood - Al Henning - 4" SCH 40 66's of MH - 1 Fernco Clamp - 1V22, 1V45, 1TWIN CO CITY WRE REPAIR

C48730-1227 S. Hydraulic (Dellone) 3-19-75 - John Harmon (16+25.8)  
 C48729- " " " " " " (MH tap in 17+39.3)

- #1441-Setting Wye-1321 S. Hydraulic-7-9-54-D.L. Day
- #1563-Tap-1309 S. Hydraulic-6-10-52-Joe M. Donald
- #339-Tap-Private Line-1603 E. Lincoln-4-17-29-J.M. Sterling Al Henning 5-20-74
- #246-Used Old Connection-1248 Fannie-7-1-36-C.C. McLaughlin
- #129-Tap-1612 E. Bayley-6-19-35-C.M. Wyant
- #266-Tap-1613 E. Lincoln-6-15-46-Joe's Pkg. Co
- #1909-Tap-1216 Greenwood-9-29-54-Fredrich Pkg. Co
- #10584-Set low Wye (1217 S. Hydraulic) Brown Reported 6-10-59 17+65.3 5-20-74 Al Henning
- #14765-1617 E. Bayley-Dellone Davis-16-3-61 Tap (12+45.5)