

DIST. 11 - S.S. 20
1920

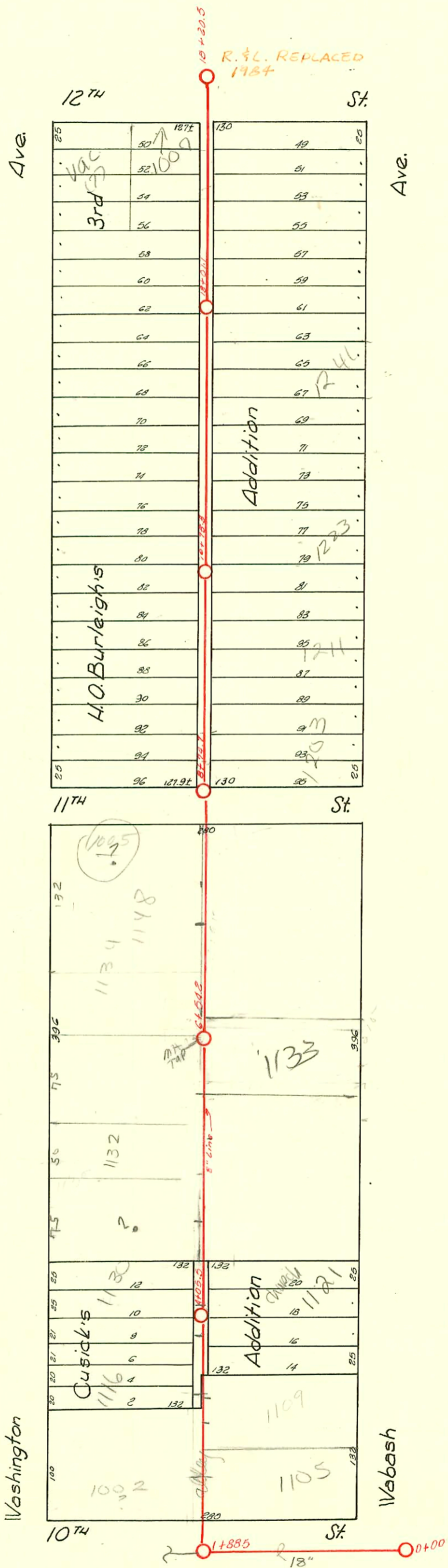

Ave.

12TH St.

St.

Ave.

1872	180
1871	179
1870	178
1869	177
1868	176
1867	175
1866	174
1865	173
1864	172
1863	171
1862	170
1861	169
1860	168
1859	167
1858	166
1857	165
1856	164
1855	163
1854	162
1853	161
1852	160
1851	159
1850	158
1849	157
1848	156
1847	155
1846	154
1845	153
1844	152
1843	151
1842	150
1841	149
1840	148
1839	147
1838	146
1837	145
1836	144
1835	143
1834	142
1833	141
1832	140
1831	139
1830	138
1829	137
1828	136
1827	135
1826	134
1825	133
1824	132
1823	131
1822	130
1821	129
1820	128
1819	127
1818	126
1817	125
1816	124
1815	123
1814	122
1813	121
1812	120
1811	119
1810	118
1809	117
1808	116
1807	115
1806	114
1805	113
1804	112
1803	111
1802	110
1801	109
1800	108
1799	107
1798	106
1797	105
1796	104
1795	103
1794	102
1793	101
1792	100
1791	99
1790	98
1789	97
1788	96
1787	95
1786	94
1785	93
1784	92
1783	91
1782	90
1781	89
1780	88
1779	87
1778	86
1777	85
1776	84
1775	83
1774	82
1773	81
1772	80
1771	79
1770	78
1769	77
1768	76
1767	75
1766	74
1765	73
1764	72
1763	71
1762	70
1761	69
1760	68
1759	67
1758	66
1757	65
1756	64
1755	63
1754	62
1753	61
1752	60
1751	59
1750	58
1749	57
1748	56
1747	55
1746	54
1745	53
1744	52
1743	51
1742	50
1741	49
1740	48
1739	47
1738	46
1737	45
1736	44
1735	43
1734	42
1733	41
1732	40
1731	39
1730	38
1729	37
1728	36
1727	35
1726	34
1725	33
1724	32
1723	31
1722	30
1721	29
1720	28
1719	27
1718	26
1717	25
1716	24
1715	23
1714	22
1713	21
1712	20
1711	19
1710	18
1709	17
1708	16
1707	15
1706	14
1705	13
1704	12
1703	11
1702	10
1701	9
1700	8
1699	7
1698	6
1697	5
1696	4
1695	3
1694	2
1693	1
1692	0

11TH St.

St.

Washington

10TH St.

Vabash

St.

CONSTRUCTION RECORD

SERVICE RECORD

STATION	ELEVATION		Depth	MANHOLE	4-INCH "Y" BRANCHES		No. of Permit		House Number		DATE OF PERMITS	
	Ground	Grade			North West	South East	North West	South East	North West	South East	North West	South East
0+00	115.18	107.30	7.88	0+00								
1+00	114.46	107.44	7.02									
2+00	114.35	107.58	6.77	1+88.5	+32 2+56.5 2+83	2+29.5 +54 +80.5	#21495 369	#4-2640 1954	1002 1224 510 East 11th	1105 510 Wabash	12-20-89 5-5-26	3-2-94 8-28-24
3+00	115.43	107.72	7.71		+09 +34.5 +59.5 2+86.5	3+06.5 3+32 +57 3+84	#2135 #283	#2135 C37818	1112 N. Washington	1115 Wabash	5-12-31	3-21-73
4+00	115.51	107.88	7.63	4+05.5	+40 +66.3 4+92	4+37.5 +63.8 +89.5	#41993 2067	#2374	1116 N. Washington	1121 N. Wabash	5-12-31	10-21-24
5+00	115.91	108.03	7.88		+18 +44.5 +69 +95.5	5+15.5 +42 +66.5 +93	#1363 #3560	#1363	1132 N. Washington	1131 N. Wabash	4-10-57 9-11-24	12-30-25
6+00	115.46	108.18	7.28	6+54.2	+21.8 +47.5 +74.5	6+19.3 +45 +72	#1363 #48334	#3561	1148 N. Washington	1133 N.R. Wabash	See Below 1-19-61 2-6-26 4-13-28	1-3-51
7+00	115.66	108.33	7.33		+702 +27.5 7+55.5 +80.5	+25 +53 7+88.7 +78	#2525 #41131	#173	1005 East 11th	1155 Wabash	12-12-45	3-10-26
8+00	115.82	108.48	7.34	8+74.7	+06 +32.5	8+03.5 +30	#2360 #19057	#2360	1203 Wabash (and Conn) East 11th		9-2-52 9-14-57 8-23-36	
9+00	116.41	108.63	7.78		+29 +56 +81.5	9+26.5 +53.5 +79	#5795 #11750	#5795	1207 Wabash		7-14-53 12-3-57 6-7-48	
10+00	116.19	108.78	7.41	10+75.3	+08 +33.5 +59.5 +86.5	10+05.5 +31 +57 10+84.5	#1553 #19057 #1156	#1553	1211 Wabash	1211 Wabash	Sealed w/ Fernco 1-14-00 Dupl Concrete	3-5-47 1-14-00 5-26-50
11+00	116.63	108.43	7.70		+11.1 +37.8 +63.5 +89.3	11+08.6 +35.3 +61 +86.8	#1668	#1668	1237 Wabash		7-27-44	
12+00	117.01	109.08	7.93		+14.8 +38.5 +69 +94	12+12.3 +52.5 +66.5 +91.5	9519137	#115	1247 Wabash		11-13-95	
13+00	116.39	109.23	7.16	13+01.1	+19.5 +43 +72.5 +98.5	13+17 +58.5 +70 +96	#941	#941	1005 East 12th		11-3-26	
14+00	115.76	109.38	6.38	14	+23.2 +54.5	14+20.7 +52	#154 #1914	#154	1007 East 12	1249 Wabash	7-8-25	8-21-24
15+00	116.29	109.53	6.76	15+20.5								

2003-02548 10/103 1133N Wabash - AE Henning - Replace existing suction - 4" 40 PUC, IV22, (TWIN) CO, City WYS repair

4" Predco, 34.9' S of MH 6754.2 (679.3)

Tap #66979 - 1130 N. Washington - A Conderoff - 10-18-71 (57872)

Deal off #46623 - 1157-59 Wabash - 9-12-74 - al Henning (7789.7)

#348 - Tap - 115 East 11th - 4-29-26 - See above

#2402 - Tap - 115 Wabash - 4-5-49 - Ray Yockley

#68 - Tap - 116 N. Washington - 3-7-50 - J.V. McVee

#16496 - Tap 1132 N. Washington - Ray Robertson, 12-19-62 (5728.5)

#11810 - Tap 1132 N. Washington (addn) 12-4-68

94-227 1-3-94 1107 N Wabash 231075 w/conn

98-17663-7 9/16/98 1109 N Wabash (Mwe-210)

Deal off #11810 - Tap 1132 N. Washington (addn) 12-4-68 Donald Thompson - tap in MH 6754.2