

DIST. 11 - S.S. NO. 20
1920

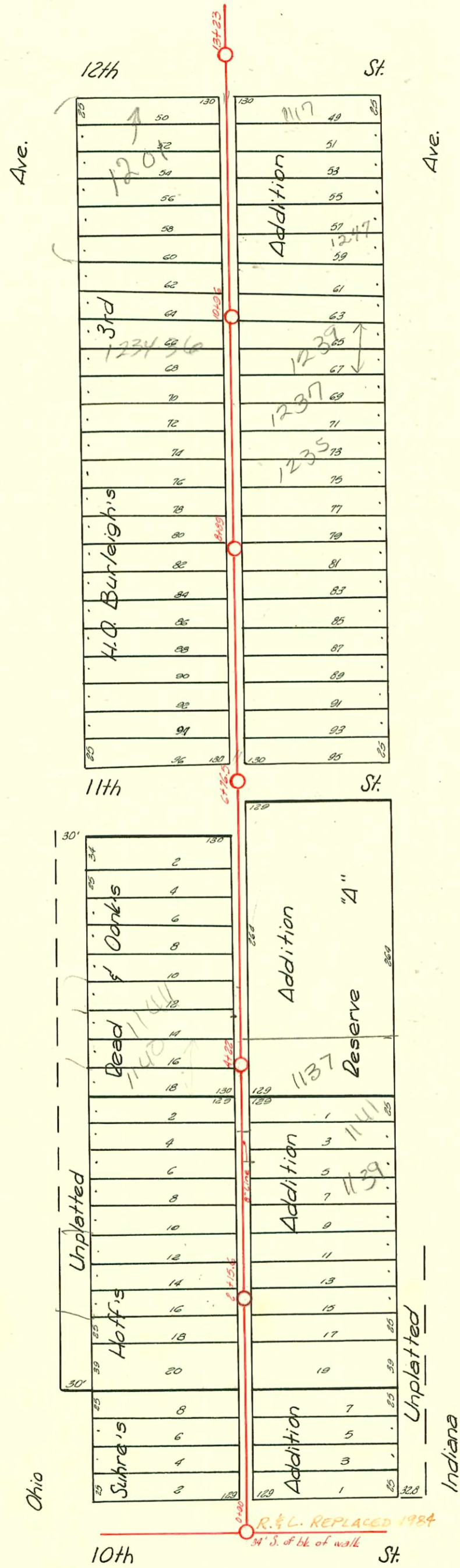

D-138

CONSTRUCTION RECORD

SERVICE RECORD

STATION	ELEVATION		Depth	MANHOLE	4-INCH "Y" BRANCHES		No. of Permit		House Number		DATE OF PERMITS	
	Ground	Grade			North West	South East	North West	South East	North West	South East	North West	South East
				0+00	159	144						
					185.5	183		#2216		1103 Indiana		9-30-24
					+07	+04.5						
					+32.5	+30		#58907	1108 S.O. Ohio		12-1-76	
					+57.5	+55		#435	1116 Ohio	1107 Indiana	6-28-21	8-25-20
					+84.5	+82		#336			5-25-26	4-6-25
					+109.5	+107		#C39979	1115 Ohio		7-11-73	
			7.05	8+15.6	+35.5	+33		1232	1120 Ohio	1109 S.O. Indiana	9-2-24	12-1-76
					+61.5	+59						5-11-25
					+87.5	+85		#125	1120 Ohio		4-27-25	
				3+	+13.5	+11		#C17950	1130 Ohio		3-11-70	
					+39	+36.5		#426	1103-00158 Indiana	1139 S.O. Indiana	4-27-50	1-5-03
					+64.5	+62		#17951	1132 Ohio	1141 S.O. Indiana	2-11-70	9-1-26
					+91	+88.5		#1401	1132 Ohio	1141 S.O. Indiana	10-2-29	7-19-23
			7.3	4+22	+15.9	+13.4		#1316	1132 Ohio		1-29-52	
					+43.5	+41		#3303	1140 S.O. Ohio		4-14-21	
					+69.5	+67		#B811	1143 Indiana		5-7-64	
					+95.5	+93		#450				5-1-25
					+21.2	+18.7		#1856		1151 Indiana		12-20-44
					+46.5	+44						
					+73.5	+71		#391	1155 Indiana		8-12-25	
					+99.5	+97		#2734	1159 Indiana		8-18-24	
			6.9	6+76.5	+26.1	+23.6						
					+23.1	+21.6		#45937	1202 Ohio	1205 Indiana	9-29-74	12-29-28
					+50.5	+48		1351	1628			2-19-48
					+76.9	+74.4						
					+149	+124						
					+31.1	+28.6		#2177		1201 Indiana		3-23-40
					+53.6	+53.1		#982		1209 Indiana		8-13-43
					+82.5	+80						
			7.5	8+89	+107.0	+103.4						
					+132.7	+130.2		#24190	1216 Ohio		10-29-73	
					+58.5	+56		2230			8-21-45	
					+83.5	+81		#432		1229 Indiana		3-24-48
					+108.2	+105.7		#1848	1252 Ohio	1237 Indiana	3-24-48	12-14-40
					+134.5	+132		#433		1231 Indiana		3-24-48
					+59.5	+57		#C3237	1234-30 Ohio		4-20-71	
			7.4	10+96	+85.5	+83		#1274	1246 Ohio	1237 Indiana		3-29-4
					+110.9	+108.4		#5358	#1730	1246 Indiana	12-11-29	8-16-29
					+137.1	+134.6						7-26-51
					+61.6	+59.1		#1112		1243 Indiana		8-20-29
					+85	+82.5						
					+12.5	+10		#2290		1251 Indiana		9-9-55
					+45.5	+33		#2078	1201 East 12th		9-12-24	
					+60							
				13+23								

96212437 122296 1196 N Ohio - McClung's

6/18/44 - 1219 E. 11th - 22 Henning - 7-01-77 (6+01.5)
 C 30769-1247 Indiana - 3-2-72 - 26 Henning (12+32.5)
 #7175 - Tap - 1245 Indiana - 12-7-53 - Rex Robertson, Inc.
 #2492 - Private Line - 1237 Indiana - 11-29-45 - Ray Veckley
 #1851 - Tap - 1205 Indiana - 3-24-48 - Joe Falkermir
 #6285 - Tap - 1237 1/2 Indiana - 10-29-51 - Scotty Clark & Pflug, Co.
 #2125 - Tap - 1139 Indiana - 8-11-52 - Joe McDonald
 #6843 - Tap - 1221 Indiana - 11-3-55 - Brenner

#18947 8/21/67 - 1144 N Ohio - Henning (4758)

94-16859-7 10-19-74 (117 E 12th St) Sealed off AT Main 12+38 (50)