

DIST. 11 - S.S. NO. 20
1920

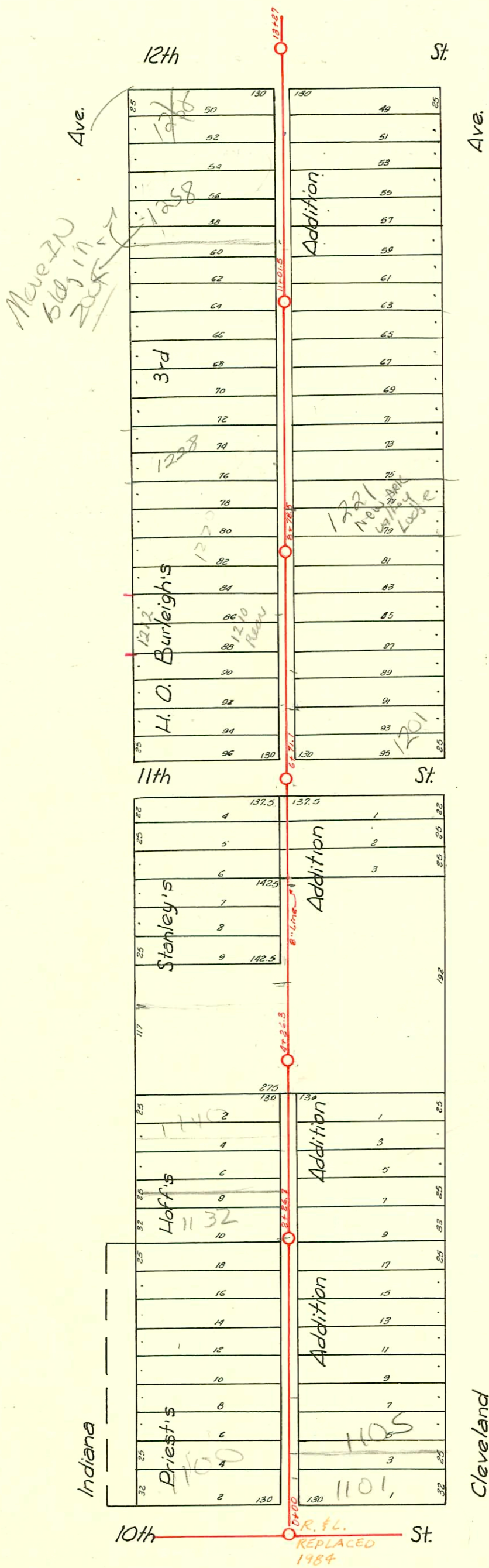

Sur 2003-0023 3-12-03 - 1221 N Cleveland (ARK Valley Lulse) OK CONTRACTOR
4" City tap - 173' SOF MH 1101.5 (9+28.5) 14" fall - shallow - 4" trap installed, 1V45,
1 twin CO at bldg - NO alley

0-139

CONSTRUCTION RECORD

SERVICE RECORD

STATION	ELEVATION		Depth	MANHOLE	4-INCH "Y" BRANCHES		No. of Permit		House Number		DATE OF PERMITS	
	Ground	Grade			North West	South East	North West	South East	North West	South East	North West	South East
0+00	115.53	107.15	8.38	0+00	5+72.5 STOP +50.5	4.48	95-12827 #95-7202	61	1100 N Indiana 1101	1101	8-17-25 5-18-55	
1+00	115.48	107.29	8.19		75.35 +101.5 +26.5 +51.5 +77.3	172.8 199 124 149 174.8	2081 #2567 #186	178 #200	1101 Indiana 1109 Cleveland 1110 Indiana	1109 Cleveland	9-12-24 11-18-24	2-12-21 2-2-23 2-8-23
2+00	115.65	107.43	8.22		2+02 7.45 2+26.7 +38.5 +64.5 +91.5	2+36 2+36 +62 139	#64470 556 #1074	#429 #1193 #557	1116 S.10 Indiana 1115 Cleveland 1119 Cleveland 1136 Indiana 1121 Cleveland	1115 Cleveland 1119 Cleveland	12-15-77 8-28-46	5-1-22 12-7-53
3+00	115.70	107.57	8.13		+16.5 +41.5 +63 3+83.5	3+14 +39 +55 +86	#1052	#680	1134 Indiana 1143 Cleveland	1131 Cleveland	9-23-25	8-3-21
4+00	116.34	107.71	8.63	4+26.3	+17.5 +42.5 +65.5 4+91	4+15 +40 +63 +98	#522 #2486	#1203	1140 Indiana 1148 Indiana 1146 Indiana	1143 Cleveland	5-15-25 11-6-24	10-5-22
5+00	116.38	107.85	8.53		+19.5 +47 +73 5+99.5	5+17 5+42 +75.5 +99.5	#399 #2130 #2523	#1067	1154 Indiana 1153 Indiana 1156 Indiana	1147 S.10 Cleveland 1153 S.10 Cleveland 1155 Cleveland	4-18-29 6-7-72 9-16-24 5-23-68	9-21-93 9-23-20 7-19-23 6-21-21 7-18-23
6+00	116.52	107.99	7.53		+45.5 6+71.1	+43 6+43	#2935 #2527	#7230	1155 Indiana 1159 Cleveland	1159 Cleveland	3-26-51 11-12-24	1-25-52
7+00	115.55	108.13	7.42		+41.5 +36.5 +63.5 +89.5	7+09 +34 +61 +87	#6486	#779 #121 #563	1212 V8 Indiana 1221 Cleveland 1203 Cleveland 1211 Cleveland	1221 Cleveland 1203 Cleveland	9-21-53 3-15-21 1-27-23 5-21-57	4-10-24 1-27-23
8+00	115.05	108.27	6.78		+14.3 +39.5 +65.5 8+78.5	8+11.8 +37 +63 +88.5	#638		1208 Indiana	1208 Indiana	7-27-27	
9+00	115.16	108.41	6.75		+15.9 +41.5 +69.5 9+93.5	9+13.4 +39 +67 +91	#1045 #1068 #1093 #1085	#1109	1220 Indiana 1224 Indiana 1225 Indiana 1235 Indiana 1244 Indiana	1231 Cleveland	12-3-26 9-2-33 12-11-26 9-16-39 12-27-26	6-26-41
10+00	115.90	108.55	7.35		+19.5 +43.5 10+68.5	10+17 +41 +66 +93	#1064	#8733 #2116 #2647 #359 #554	1240 Indiana 1241 Indiana 1243 Cleveland 1241 Cleveland 1247 Cleveland	1237 S.0 Cleveland 1243 Cleveland 1241 Cleveland 1247 Cleveland	9-1-38 9-10-40 4-11-25 8-4-47	11-18-76 9-16-24
11+00	117.13	108.69	8.44	11+01.5	+20.5 +47.1 +72.5 +98.5	11+18 +44.6 +70 +96	#2486 5445		1250 Indiana	1250 Indiana	6-11-71 8-3-50	
12+00	117.15	108.83	8.32		+23.5 +47 +54.5	12+21 +52 +52	#912	#117	1258 Indiana 1257 Cleveland	1257 Cleveland	9-30-30	1-23-23
13+00	117.28	108.97	8.31		+50							
	116.74	109.04	7.70									
			7.55	13+27								

2001-0226-9/6/01-1258 N Indiana-Reddi- New Tap for main in sldy at 66' N of MH 11701.5 made by City - Do not know what pipe material - Insp. not taken by sewer inspector

2001-01954-8/8/01 1221-23 N Cleveland-A. Henning - s/w w/ concrete 185's of MH 11701.5 (9+16.5)

95-11925-7 8+95 1212 Indiana - DL tied into exist clay tile line 21' off main with donut. used 4" sch 40

#6189 - Tap - 1148 Indiana - 8-18-53 - Nichell / Mansley
 #2570 - Tap - 1210 Indiana - 9-17-52 - Lee Layton
 #1672 - Tap - 1155 Cleveland - 11-26-29 - T.I. Hayes
 #1902 - Tap - 1309 East 10th - 2-5-45 - H.P. Duranway
 #3942 - Tap - 1229 Cleveland - 2-12-51 - Wichita Dtg. Co.
 #25361-522-90 - 1105 N Cleveland - NK - Dean / Kler - (0+97.0 TAP)
 #793-203-7 - 1208 E. 10th (No record of connection) - Seal of 4947 north of M.H. on N side of 10th 0+49.0