

SANITARY SEWER RESPONSE PLAN  
 PHASE IA  
 PROJ. NO. 468-87420 (623124)  
 PROJ. NO. 468-87420 (623124)  
 BOOKED 3-1-96 FROM AS BUILTS

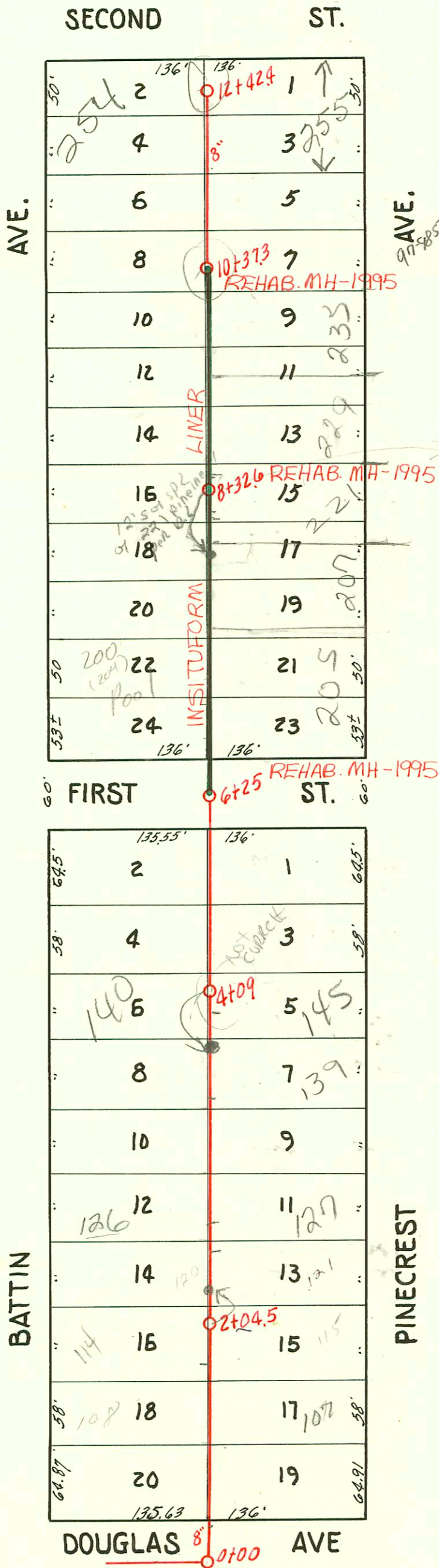

RECONNECTIONS		
STA.	ADDRESS	DIRECTION
10+28.4	238 N. Battin	West
10+17.4	235 N. Pinecrest	East
9+79.2	230 N. Battin	West
9+48.2	229 N. Pinecrest	East
9+02.7	221 N. Pinecrest 6+89	East
8+79.2	224 N. Battin	West
8+25.5	216 N. Battin	West
8+06.8	207 N. Pinecrest	East
7+21.3	205 N. Pinecrest	East
6+97.6	200 N. Battin	West

Meas Between  
 MH's NOT CORRECT  
 612197  
 R

PART OF **LAT. J, DIST. 6, S. S. 12**  
 DODSON - HUMPHREY  
 1930

CONSTRUCTION RECORD							SERVICE RECORD					
STATION	ELEVATION		Depth	MANHOLE	4-INCH "Y" BRANCHES		No. of Permit		House Number		DATE OF PERMITS	
	Ground	Grade			North West	South East	North West	South East	North West	South East	North West	South East
0+0	171.45	151.00	10.45	0+0	0+16.3	0+13.3						
					0+41.0	0+38		#199	3118 E. Douglas			9-22-41
					0+65	0+62						
					0+92	0+89	#1178	#3337	108 N. Battin	107 N. Pinecrest	10-29-38	3-26-03 4-17-41
1+0	171.96	161.35	10.61		1+16	1+13						
					1+40	1+37	#408	#122	114 N. Battin	115 N. Pinecrest	8-12-37	9-18-41
					1+67.5	1+64.5						
					1+91.5	1+88.5						
2+0	172.96	161.70	11.26	2+04.5	2+15.8	2+12.8	#5941 #1505	#122 N. Battin	120 N. Pinecrest	6-10-37	5-1-39	
					2+42.5	2+39.5		6015	126 N. Battin	127 N. Pinecrest	8-12-37	6-16-39
					2+67	2+64	#1039	#857	126 N. Battin	127 N. Pinecrest	8-8-38	1-6-42
					2+91.2	2+88.2						
3+0	174.25	162.05	12.21		3+18.8	3+15.8	#1607 #171	#132 N. Battin	133 N. Pinecrest		4-21-37	
					3+42.8	3+39.8		#1368	146 N. Battin	139 N. Pinecrest		3-7-39
					3+67	3+64	#303	#1868	146 N. Battin	139 N. Pinecrest	6-16-37	5-18-42
4+0	175.16	162.40	12.76	4+09	4+18.2	4+15.2						
					4+42	4+39	#273	#1621	140 N. Battin	137 N. Pinecrest	6-10-37	1-21-02 6-3-39
					4+69	4+66						
5+0	175.36	162.75	12.61		4+93	4+90	#97		146 N. Battin	151 N. Pinecrest	3-22-37	6-19-39
					5+17.5	5+14.5		#1656	152 N. Battin	157 N. Pinecrest		8-28-41
					5+44.5	5+41.5						
					5+69	5+66	#5		152 N. Battin	157 N. Pinecrest		6-16-39
6+0	175.46	163.10	12.36		6+92.5	6+89.5		#1649	209 N. Battin		3-5-35	
				6+25	6+63	6+60						
					6+95.5	6+92.5	#35		209 N. Battin			
7+0	175.78	163.45	12.33		7+22.5	7+19.5		#978	205 N. Pinecrest			10-25-30
					7+46.5	7+43.5						
					7+72	7+69						
8+0	175.98	163.80	12.18		8+97	8+94						
				8+32.6	8+25	8+22	#327		216 N. Battin			8-17-35
					8+49	8+46						
					8+73	8+70	#326		224 N. Battin			8-17-35
9+0	176.97	164.15	12.82		9+97.5	9+94.5		#306	221 N. Pinecrest			8-4-35
					9+25	9+22		#355	231 N. Pinecrest			9-8-35
					9+48.5	9+45.5						
					9+73	9+70	#95		230 N. Battin			4-9-35
10+0	175.67	164.50	11.17		10+99.5	10+96.5						
					10+24	10+21	#214		238 N. Battin			6-12-36
				10+37.3	10+47.5	10+44.5						
					10+73.8	10+70.8						
11+0	174.17	164.85	9.32		10+98	10+95		#474	243 N. Pinecrest			11-5-35
					11+25	11+22	#68		246 N. Battin			3-19-35
					11+49	11+46						
					11+73.5	11+70.5						
12+0	174.27	165.20	9.07		12+0.7	11+97.7		#1000	255 N. Pinecrest			11-7-30
					12+25	—	#1017		254 N. Battin	see below	8-22-03 7-29-38	
12+42.4	175.07	165.35	9.72	12+42.4	12+37	—						

2003-02204-8/22/03-254 N Battin- Wichita Exc- 4" PE SDR17 Pipeburst Replacement- city wye repair 6" Fredco - 4" PVC 40  
 2V22, 1V45, 1-WYE, 2 Kickouts, 17' sof DEMH 12+42.4(12.25.4)  
 2003-01514-6/10/03-140 Battin - Roto-Pipeburst replacement PE SDR17- city wye repair 4" Fredco 33' N of MH 4109(4+42)  
 2V22 4" SCH 40 PVC tied inside  
 2002-00283- 1/31/01-145 Pinecrest- Reddy Rootr. 2 Directional Co. Replaced 14' on low end, 2 Kickouts, 4" SCH 40 PVC

#222 - Tap - 207 N. Pinecrest - 9-25-35 W.W. Pray.  
 #356 - Tap - 235 N. Pinecrest - 9-8-36 W. R. Hayes - C60588-4-4-77  
 #808 - Tap (Douglas Ave. Sewer) 102 N. Battin - 4-18-38 - Albert J. Hoff