

**#2 Easement** - Made Jan. 13, 1933 Filed Feb. 3, 1933. From Kansas Humane Society. A 10' Easement thru the S. 10 A. of the S.W. 1/4 of NW 1/4 of Sec. 25-27S-1E of 6th P.M. The E of said 10' Easement is described as follows; Com. at a point on the S.L. of the N.W. 1/4 of said N.W. 1/4 of Sec. 25, 78.6' east of the S.W. corner of said NW 1/4 of Sec. 25, thence in a north-easterly direction along a straight a distance of 334'± to a point on the north line of above described property, 831.5' east of the west line of said N.W. 1/4 of Sec. 25. Has right to con. 1 build- ing without fee. Con. not to exceed 10 years.

**#3 Easement** - Made Jan. 12, 1933. Filed Feb. 3, 1933. From Mrs. M. T. Williams, a widow. A 10' easement thru the N. 30 A. of the S.W. 1/4 of the N.W. 1/4 of Sec. 25, 27S-1E of 6th P.M. The E of said 10' easement is describe as follows; Com. at a point on the east line of the said SW 1/4 of N.W. 1/4 of Sec. 25, 20' south of the N.E. corner of said S.W. 1/4 of N.W. 1/4 of Sec. 25, thence west along a straight line 20' south of and parallel to the north line of the said S.W. 1/4 of the N.W. 1/4 of Sec. 25 to the W.L. of said S.W. 1/4 of the N.W. 1/4 of Sec. 25. Also a 10' Easement running in a southwesterly and northeasterly direction, the E of which is described as follows; com. at a point 25' S. and 365' W. of the N.E. corner of said S.W. 1/4 of N.W. 1/4 of Sec. 25, thence in a southwesterly direction along a straight line 975'± to a point on the south line of the N. 30 A. of the S.W. 1/4 of the N.W. 1/4 of Sec. 25, 831.5' east of the west line of said N.W. 1/4 of Sec. 25.

- # 2377 - Tap - 4802-4 E. Gilbert Harley Riggs
- # 2378 - Tap - 4810-12 E. Gilbert 3-31-49
- # 2379 - Tap - 4816-18 E. Gilbert
- # 2380 - Tap - 4822-24 E. Gilbert \$10.00 special fee
- # 2381 - Tap - 4828-30 E. Gilbert Paid for each connection.
- # 2382 - Tap - 653-55 Eastwood
- # 2391 - Tap - 654-656 Eastwood Harley Riggs
- # 2398 - Tap - 4910-12 E. Gilbert 4-4-49

- # 1587 - Tap - 657 S. Crestway - 7-11-50 Harley Riggs (6+20)
- # 1978 - Tap - 636 S. Belmont - 2-21-47 - Simmons Plog. Co.
- # 493 - Tap - 645 S. Crestway - 8-8-46 Simmons Plog. Co.
- # 2659 - 5203-5-7-9 E. Kellogg - 9-9-42 Brodie Plog. Co.
- # 2660 - 508-10-12-14 Deavola - 9-9-42 Brodie Plog. Co.
- # 2661 - 514-18 - 20-22 Deavola - 9-9-42 Brodie Plog. Co.
- # 2662 - 524-26-28-30 Deavola - 9-9-42 Brodie Plog. Co.
- # 2663 - 532-34-36-38 Deavola - 9-9-42 Brodie Plog. Co.
- # 2664 - 540-42-44-46 Deavola - 9-9-42 Brodie Plog. Co.
- # 2035-648 S. Belmont - 5-2-45 H. J. Geile

- # 1502 - Tap - 652 S. Belmont - 9-6-49 - Coleman Plog. Co.
- # 142 - Tap - 4825 Eastwood - 6-19-50 Simmons Plog. Co.
- # 199 - Tap - 614 S. Belmont - 5-3-37 W. P. Hayes
- # 227 - Tap - 622 S. Belmont - 5-14-37 Frederick Plog. Co.
- # 580 - Tap - 606 S. Belmont - 11-3-37 W. P. Hayes.
- # 1036 - Tap - 632 S. Belmont - 8-5-38 T. P. Hayes Plog. Co.
- # 1071 - Tap - 1118 S. Belmont - 4-20-39 R. H. Anderson
- # 6746 - Tap - 4806 E. Gilbert - (10-21-53) Peay Plog. Co.
- # 4422 - Tap - 653 S. Belmont - 10-27-65 - Smith Plog. Co. (tap 28+86.5)

See below  
For contract between City & Eastborough Estates Co., See contract No. 2051 in City Clerk's File.

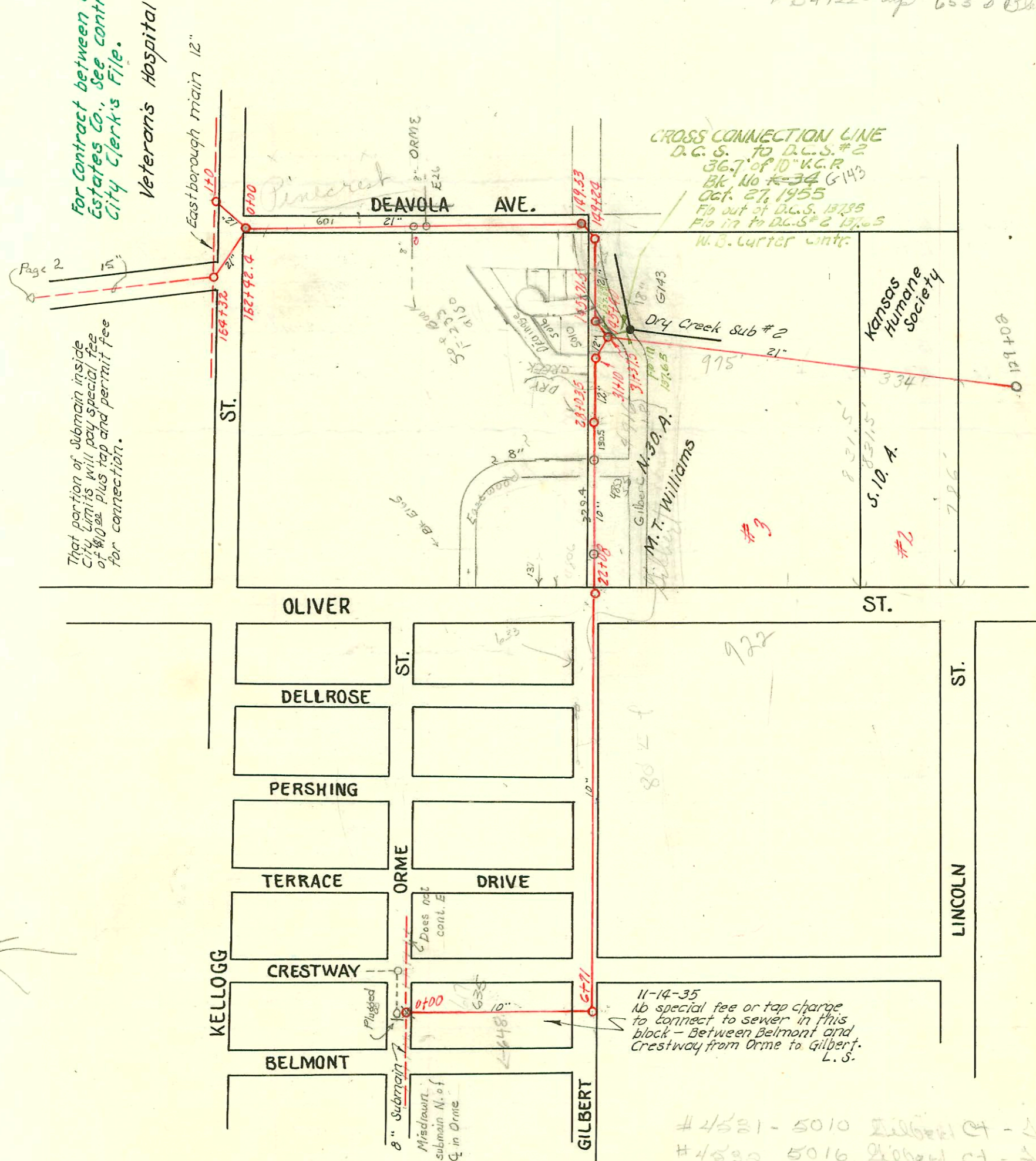

That portion of Submain inside City Limits will pay special fee of \$10.00 plus tap and permit fee for connection.

CROSS CONNECTION LINE  
D.C.S. to D.C.S. #2  
36.7' of 10" V.C.R.  
Bk. No. 34 G143  
Oct. 27, 1955  
Fp out of D.C.S. 15788  
Fig 17 to D.C.S. 2 15785  
W.S. Carter cont.

11-14-35  
No special fee or tap charge to connect to sewer in this block - Between Belmont and Crestway from Orme to Gilbert. L.S.

- # 223 - Tap - 4702 E. Gilbert - 5-14-49 Wichita Plog. Co. (\$10.00 Special Fee pd. Reat #79912-5-12-49)
- # 808 - Tap 4712 E. Gilbert - 8-31-48 C. G. Coleman (\$10.00 special fee)
- # 120 - Tap 601 S. Crestway - 6-5-48 - J. E. Lansdowne
- # 1939 - 617 S. Crestway - 5-6-47 - Wichita Plog. Co. (Reat #14227-617-5-29-61)
- # 1960 - 623 S. Crestway - 5-6-47 - Wichita Plog. Co.
- # 1961 - 627 S. Crestway - 5-6-47 - Wichita Plog. Co. (Reat #14227-617-5-29-61)
- # 1962 - 635 S. Crestway - 5-6-47 - Wichita Plog. Co. (Reat #14227-617-5-29-61)
- # 2304 - 651 S. Crestway - 4-29-48 Riggs Plog. Co. (5+31)
- # 22 - 658 S. Belmont - 5-20-48 Frederick
- # 1999-00671 - 642 S. Belmont - 10-15-47 Vaughn Plog. - WICHITA EX-4" SCH 40
- # 2422 - 712 S. Pershing - 6-17-40 Shellenberger #25.00 Special fee.
- # 2433 - 716 S. Pershing - 6-17-40 Shellenberger #25.00 & 30.00 Tap. Topped 13' ft east of center of Pershing.
- # 819 - 626 S. Belmont - 12-22-41 - Harley Riggs - 98 234767
- # 943 - Tap - 5217 E. Kellogg - 8-19-43 - Wichita Plog. Co.
- # 434 - 5017 E. Kellogg - Joe Mc Donald
- # 4581 - 5010 Gilbert Ct - Tap - Carter - 4-28-55
- # 4582 5016 Gilbert Ct - Tap - Carter - 4-28-55
- 1394 4940 E. Gilbert Tap - Carter - 7-9-56
- # 14247 Tap 617 S. Crestway - J. E. Lansdowne 6-2-61 (1+71)
- # 16652 Tap 4916 E. Gilbert - Robt. McShay 2-14-63 (28+52.5) Reat #18867-250 special fee paid 2-14-63 4916 E. Gilbert - Date Lansdowne
- B896 - 5127 E. Kellogg - Seal off at Henning - 2-9-64
- 14657 - (532-38) S. Pershing - 9-9-45 - at Henning 158+48.4
- 14656 - (534-30) S. Pershing - 9-9-45 - at Henning 159+45.4
- 14655 - (516-32) S. Pershing - 9-9-45 - at Henning 160+45.4
- 14658 - (540-46) S. Pershing - 9-9-45 - at Henning 157+54.4

NOT TO SCALE APPROX 1" = 400'  
**DRY CREEK SUBMAIN**  
CARTER-DOBSON CONST. CO.  
1933

| CONSTRUCTION RECORD |           |        |       |          | SERVICE RECORD      |                    |               |            |                     |            |                 |                                |
|---------------------|-----------|--------|-------|----------|---------------------|--------------------|---------------|------------|---------------------|------------|-----------------|--------------------------------|
| STATION             | ELEVATION |        | Depth | MANHOLE  | 4-INCH "Y" BRANCHES |                    | No. of Permit |            | House Number        |            | DATE OF PERMITS |                                |
|                     | Ground    | Grade  |       |          | North West          | South East         | North West    | South East | North West          | South East | North West      | South East                     |
| 131+0               | 143.40    | 133.65 | 9.75  |          |                     |                    |               |            |                     |            |                 |                                |
| 132+0               | 142.80    | 133.90 | 8.90  |          |                     |                    |               |            |                     |            |                 |                                |
| 133+0               | 142.90    | 134.15 | 8.75  |          |                     |                    |               |            |                     |            |                 |                                |
| 134+0               | 144.90    | 134.40 | 10.50 | 134+19   | Y-West              |                    | # 723         |            | 152-45 Home Society |            | 2-12-38         |                                |
| 135+0               | 145.40    | 134.65 | 10.75 |          |                     |                    |               |            |                     |            |                 |                                |
| 136+0               | 143.50    | 134.90 | 8.60  |          |                     |                    |               |            |                     |            |                 |                                |
| 137+0               | 142.30    | 135.15 | 7.15  |          |                     |                    |               |            |                     |            |                 |                                |
| 138+0               | 144.60    | 135.40 | 9.20  |          |                     |                    |               |            |                     |            |                 |                                |
| 139+0               | 140.00    | 135.65 | 4.35  |          |                     |                    |               |            |                     |            |                 |                                |
| 140+0               | 143.00    | 135.90 | 7.10  |          |                     |                    |               |            |                     |            |                 |                                |
| 141+0               | 142.10    | 136.15 | 5.95  |          |                     |                    |               |            |                     |            |                 |                                |
| 142+0               | 143.70    | 135.40 | 7.30  |          |                     |                    |               |            |                     |            |                 |                                |
| 143+0               | 142.30    | 135.65 | 5.65  |          |                     |                    |               |            |                     |            |                 |                                |
| 144+0               | 144.40    | 136.90 | 7.50  |          |                     |                    |               |            |                     |            |                 |                                |
| 145+0               | 148.40    | 137.15 | 11.25 | 145+40   |                     |                    |               |            |                     |            |                 |                                |
| 146+0               | 148.70    | 137.40 | 11.30 | 145+71.5 |                     |                    |               |            |                     |            |                 |                                |
| 147+0               | 149.00    | 137.65 | 11.35 |          |                     |                    |               |            |                     |            |                 |                                |
| 148+0               | 150.20    | 137.90 | 12.30 |          |                     |                    |               |            |                     |            |                 |                                |
| 149+0               | 151.10    | 138.15 | 12.95 | 149+24   |                     |                    |               |            |                     |            |                 |                                |
| 150+0               | 152.50    | 138.40 | 14.10 | 149+53   |                     |                    |               |            |                     |            |                 |                                |
| 151+0               | 151.60    | 138.65 | 12.95 |          |                     |                    |               |            |                     |            |                 |                                |
| 152+0               | 150.90    | 138.90 | 12.00 |          |                     |                    |               |            |                     |            |                 |                                |
| 153+0               | 151.00    | 139.15 | 11.85 |          |                     |                    |               |            |                     |            |                 |                                |
| 154+0               | 150.70    | 139.40 | 11.30 |          |                     |                    |               |            |                     |            |                 |                                |
| 155+0               | 145.60    | 139.65 | 5.95  |          |                     |                    |               |            |                     |            |                 |                                |
| 156+0               | 148.10    | 139.90 | 8.20  |          |                     |                    |               |            |                     |            |                 |                                |
| 157+0               | 151.30    | 140.15 | 11.15 |          |                     |                    |               |            |                     |            |                 |                                |
| 158+0               | 147.20    | 140.40 | 6.80  |          |                     |                    |               |            |                     |            |                 |                                |
| 159+0               | 150.70    | 140.65 | 10.05 |          |                     |                    |               |            |                     |            |                 |                                |
| 160+0               | 155.80    | 140.90 | 14.90 |          |                     |                    |               |            |                     |            |                 |                                |
| 161+0               | 155.50    | 141.15 | 14.35 |          |                     | 161+52.4           |               |            | 5207 Kelly          |            |                 |                                |
| 162+0               | 156.20    | 141.40 | 14.80 | 162+42.2 |                     |                    |               |            |                     |            |                 |                                |
| 163+0               | 152.80    | 141.65 | 11.15 |          |                     |                    |               |            |                     |            |                 |                                |
| 164+0               | 152.70    | 141.90 | 10.80 |          |                     |                    |               |            |                     |            |                 |                                |
| 164+32              | 152.70    | 141.96 | 10.74 | 164+32   |                     |                    |               |            |                     |            |                 |                                |
| 0+0                 | 156.10    | 143.10 | 13.0  | 0+0      |                     | see Permit 0+070.0 |               | 16232      | 5215 Kelly          |            | 5-7-86          |                                |
| 1+0                 | 153.80    | 143.50 | 10.30 | 1+0      |                     |                    |               |            |                     |            |                 |                                |
| 0+0                 | 161.50    | 152.00 | 9.50  | 0+0      |                     |                    |               |            |                     |            |                 |                                |
| 1+0                 | 159.00    | 151.80 | 7.20  |          |                     |                    |               |            |                     |            |                 |                                |
| 2+0                 | 158.60    | 151.60 | 7.00  |          |                     |                    |               |            |                     |            |                 |                                |
| 3+0                 | 158.80    | 151.40 | 7.40  |          |                     |                    |               |            |                     |            |                 |                                |
| 4+0                 | 160.80    | 151.20 | 9.60  |          |                     |                    |               |            |                     |            |                 |                                |
| 5+0                 | 159.40    | 151.00 | 8.40  |          |                     |                    |               |            |                     |            |                 |                                |
| 6+0                 | 157.30    | 150.80 | 6.50  |          |                     |                    |               |            |                     |            |                 |                                |
| 7+0                 | 156.50    | 150.60 | 5.90  | 6+71     |                     |                    |               |            |                     |            |                 |                                |
| 8+0                 | 159.0     | 150.40 | 8.60  |          |                     |                    |               |            |                     |            |                 |                                |
| 9+0                 | 161.40    | 150.20 | 11.20 |          |                     |                    |               |            |                     |            |                 |                                |
| 10+0                | 162.90    | 150.00 | 12.90 |          |                     |                    |               |            |                     |            |                 |                                |
| 11+0                | 164.10    | 149.80 | 14.30 |          |                     |                    |               |            |                     |            |                 |                                |
| 12+0                | 164.60    | 149.60 | 15.00 |          |                     |                    |               |            |                     |            |                 |                                |
| 13+0                | 165.10    | 149.40 | 15.70 |          |                     |                    |               |            |                     |            |                 |                                |
| 14+0                | 164.80    | 149.20 | 15.60 |          |                     |                    |               |            |                     |            |                 |                                |
| 15+0                | 164.60    | 149.00 | 15.60 |          |                     |                    |               |            |                     |            |                 |                                |
| 16+0                | 164.00    | 148.80 | 15.20 |          |                     |                    |               |            |                     |            |                 |                                |
| 17+00               | 163.60    | 148.60 | 15.00 |          |                     |                    |               |            |                     |            |                 |                                |
| 18+00               | 162.00    | 148.40 | 13.60 |          |                     |                    |               |            |                     |            |                 |                                |
| 19+00               | 161.30    | 148.20 | 13.10 |          |                     |                    |               |            |                     |            |                 |                                |
| 20+00               | 161.60    | 148.00 | 13.60 |          |                     |                    |               |            |                     |            |                 |                                |
| 21+00               | 158.60    | 147.80 | 10.80 |          |                     |                    |               |            |                     |            |                 |                                |
| 22+0                | 156.70    | 147.60 | 9.10  |          |                     | 22+42.0            | # 345         | 1255 Top   | 400 S. Oliver       | 5-20-80    | 637             | Tied into old file 8' off main |
| 23+0                | 152.20    | 147.58 | 9.62  |          |                     |                    |               |            |                     |            |                 |                                |
| 24+0                | 151.30    | 147.03 | 9.27  |          |                     |                    |               |            |                     |            |                 |                                |
| 25+0                | 150.60    | 141.48 | 9.12  |          |                     |                    |               |            |                     |            |                 |                                |
| 26+0                | 151.00    | 140.93 | 10.07 |          |                     |                    |               |            |                     |            |                 |                                |
| 27+0                | 152.10    | 140.37 | 11.73 |          |                     |                    |               |            |                     |            |                 |                                |
| 28+0                | 152.40    | 139.83 | 12.57 | 28+03.5  |                     |                    |               |            |                     |            |                 |                                |
| 29+0                | 144.00    | 138.52 | 5.48  |          |                     |                    |               |            |                     |            |                 |                                |
| 30+0                | 147.70    | 138.32 | 9.38  |          |                     |                    |               |            |                     |            |                 |                                |
| 31+0                | 148.00    | 138.12 | 9.88  | 31+10    |                     |                    |               |            |                     |            |                 |                                |
| 31+37.5             | 148.00    | 138.00 | 10.00 | 31+37.5  |                     |                    |               |            |                     |            |                 |                                |

# 21836  
 # 221 - Top 4317 E. Olive - Free Methodist Church - 9-25-35 Geo. Sargent (sealed inside Bsm't of Bldg. D.L. could not locate line outside)  
 # 248 - Top 145 S. Pershing - 10-31-35 Vernon Shellenberger (#25.00 Special Fee paid 10-21-35)  
 # 275 - Top 600 S. Belmont - 11-14-35 - W. B. Hayes (#25.00 Special Fee paid 10-21-35) wire S. W. of S. Popline