

LINCOLN ST.

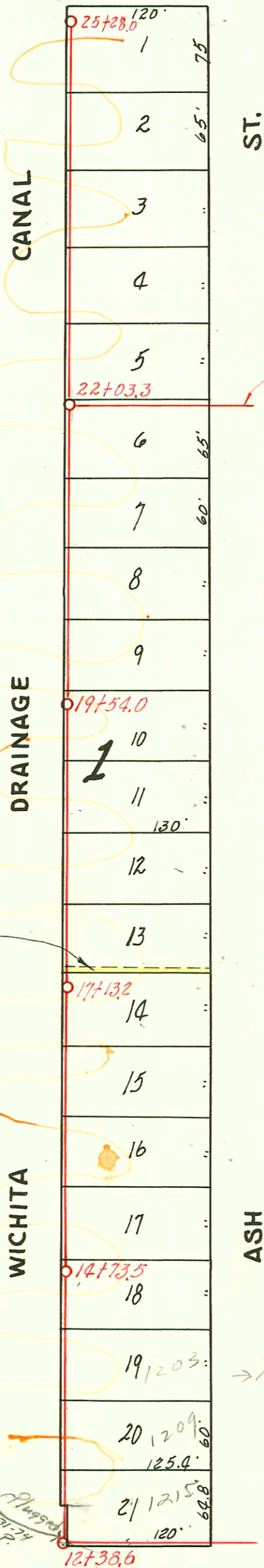

From The Schweiter Investment Co.
Made Aug. 1, 1941
Easement - 8' 6ft. of Lot 13, B1k. 1,
Schweiter's 8th Addition.

→ Wichita

Placed
5/21/74
H.P.

Rivers
CHANGES BY STATE HWY DEPT
BOOKED 8-6-77 AS BUILT PLAN

LAT. 8, S. S. #12
W. B. CARTER, 1941

CONSTRUCTION RECORD						SERVICE RECORD						
STATION	ELEVATION		Depth	MANHOLE	4-INCH "Y" BRANCHES		No. of Permit		House Number		DATE OF PERMITS	
	Ground	Grade			North West	South East	North West	South East	North West	South East	North West	South East
12+00	103.80	97.20	6.60	12+38.6								
						12+46.8						
						12+73.4						
13+00	103.80	97.56	6.24			13+00.5						
						13+30.8						
						13+61.0						
						13+88.0						
14+00	102.00	97.66	4.34			14+20.6						
						14+49.0						
						14+73.5						
						14+80.0						
15+00	103.00	97.66	5.34			15+09.6						
						15+40.0						
						15+70.7						
16+00	104.40	97.86	6.54			16+00.7						
						16+27.4						
						16+61.0						
						16+88.0						
17+00	104.10	97.96	6.14	17+13.2		17+19.2						
						17+48.8						
						17+79.0						
18+00	102.50	98.06	4.44			18+09.7						
						18+40.2						
						18+71.7						
19+00	103.20	98.16	5.04			19+01.3						
						19+29.4						
						19+54.1						
						19+62.0						
						19+89.3						
20+00	105.00	98.26	6.74			20+20.2						
						20+50.0						
						20+79.6						
21+00	106.00	98.36	7.64			21+10.3						
						21+40.2						
						21+73.4						
22+00	106.70	98.46	8.24	22+03.3		22+09.5						
						22+37.8						
						22+71.2						
23+00	106.60	98.56	8.04			23+02.0						
						23+33.3						
						23+68.3						
						23+99.4						
24+00	105.20	98.66	7.54			24+31.8						
						24+65.0						
25+00	105.00	98.76	6.24	25+28.0		25+00.8						

#532-Top of 21301 So Ash - 11-16-74 Frederick Pkg. (Connected at 25+22) C21303 Seal off 10-8-70
 #1757-Top of 8 Wgs. - 1215 S. Ash - J.C. General Pkg. 8-11-58