

1=150

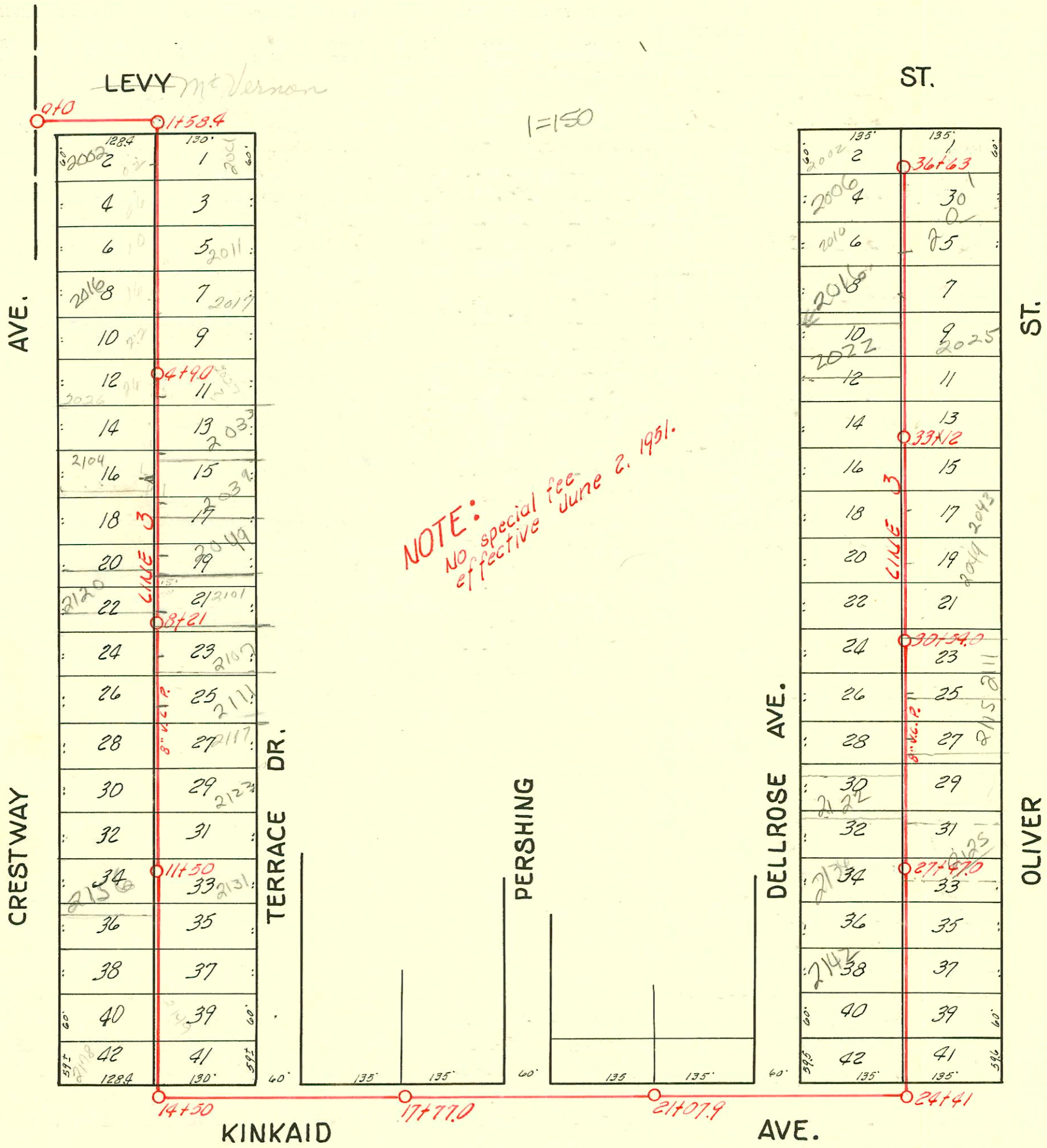

Under TV Log File Leak For
Submain #2 55712

NOTE: No special fee effective June 2, 1951.

2003-01236 5/7/03 2002 S Crestway Wichita Exc - Predco 6516' S of MH 1758.4(2724) 4" PVC - 2V45

2002-03174-11/21/02-2016 S Dellrose- Reddi Rootr- tied to claytile
4" PVC- 2TWIN CO, 1H45, 8H22, 1WYE
2002-00526- 2/25/02- 2016 S Crestway- Reddi Rootr - 4" TWIN CO

See 2002-00687 3/13/02 2016 S. Crestway - Reddi Rootr. 4" SCH40
PVC-TWIN CO, 3V45, 1WYE, Replaced 8' on S Kickout

NOTE: Wye measurements were furnished by F.E. Devlin, consulting engineer. Only one wye has been placed for each building site. Therefore, the City of Wichita assumes no responsibility if that wye can not be used. In such event the plumber must pay the usual tap fee.

- #771- Tap-2005 S. Oliver-10-29-53 - Joe M. Donald
- #354- Tap-2013 S. Oliver-3-13-52- R. La Foy
- #585- Tap-2154 S. Dellrose-6-22-49- Frederick Plog. Co.
- #3119- Tap-2135 S. Oliver-11-14-50 Eugene Reynolds
- #2184- Tap-2044 S. Dellrose-10-18-49- Frederick Plog. Co.
- #1127- Tap-2123 S. Oliver-8-5-49- A. I. Kimmis
- #2355- Tap-2147 S. Oliver-5-4-48- Jensen Plog. Co.
- #1344- Tap-2123 S. Terrace Drive-12-29-47- Callison Plog. Co.
- #539- Tap-2110 S. Crestway-7-29-47- Scotty Clark Plog. Co.
- #7822- Tap at 2126-2049 S. Terrace Dr.- Jensen Plog. Co- 12-5-47
- #1400- Tap-2136 S. Dellrose-2-5-47 Jensen Plog. Co.
- #1401- Tap-2142 S. Dellrose-2-5-47 Jensen Plog. Co. - 311063- Roto Rootr- City wye rep 1571.4' N of MH 24741(25+98.4) 4" PE SDR17 pipe burst replacement- 1V45
- #337- Tap-2120 S. Crestway-7-29-47- Scotty Clark Plog. Co. - 718199- WICHITA EXC- 4" SCH40 Tied to wye w/donut 13.8' N of MH 2721(27+07.2) 1721N CO, 1V22, 1V45
- #515- Tap-2003 S. Terrace Dr. 8-1-47- La Foy Plog. Co.
- #658- 21518, Terrace (Lot 31) 8-12-48- Rigg Plog. Co connected at 11+11.8

SEWER CONSTRUCTED IN 1942
F. E. DEVLIN ENG. W. B. CARTER CONT.

#2396- tap- Joe McDonald- 4300 East Clark- 9-13-52
12673 Tap 2011 S Terrace Turnbull Plog. 4-20-60 (3+32)

#B 2710, Seal off, 2003 S. Oliver, La Foy Plog, 1-21-65

CONSTRUCTION RECORD						SERVICE RECORD						
STATION	ELEVATION		Depth	MANHOLE	4-INCH "Y" BRANCHES		No. of Permit		House Number		DATE OF PERMITS	
	Ground	Grade			North West	South East	North West	South East	North West	South East	North West	South East
0+0	116.47	101.80	14.67	0+0								
1+0	116.67	102.10	14.57	1+58.4								
2+0	117.32	102.40	14.92		(R) 2+20.9	(R) 2+23.4						
3+0	117.36	102.70	14.66		(R) 2+84.6	2+62.9						
4+0	118.30	103.00	15.30		(R) 3+39.1	3+50.1						
5+0	118.52	103.30	15.22	4+90.0	(R) 3+98.2	4+13.3						
6+0	120.11	103.60	16.51		4+70.6	(R) 4+52.8						
7+0	120.37	103.90	16.47		(R) 5+16.6	5+24.8						
8+0	119.71	104.20	15.51		(R) 5+83.1	(R) 5+95.5						
9+0	119.43	104.50	14.93		6+28.8	6+64.9						
10+0	119.17	104.80	14.37		6+94.9	7+28.1						
11+0	119.31	105.10	14.21		7+52.2	8+05.0						
12+0	120.09	105.40	14.69		8+13.9							
13+0	121.08	105.70	15.38		8+68.2	8+65.2						
14+0	121.70	106.00	15.70		9+34.9	9+31.8						
15+0	122.67	106.30	16.37		9+91.6	9+88.6						
16+0	124.61	106.60	18.01		10+57.8	10+54.8						
17+0	123.27	106.90	16.37	17+77.0	11+14.8	11+11.8						
18+0	121.25	107.20	14.55		11+74.0	11+71.0						
19+0	120.23	107.50	12.73		12+35.2	12+32.2						
20+0	119.93	107.80	12.13	20+07.9	12+95.8	12+92.8						
21+0	120.16	108.10	12.06		13+56.3	13+53.3						
22+0	120.03	108.40	11.63		14+08.1	14+05.1						
23+0	116.81	108.70	8.11									
24+0	113.26	109.00	4.26	24+41.0								
25+0	113.14	109.47	3.67		25+03.4	24+99.6						
26+0	114.56	110.07	4.49		25+64.0	25+61.1						
27+0	116.99	110.67	6.32		26+24.4	26+21.4						
28+0	119.40	111.27	8.13		26+85.1	26+82.1						
29+0	119.30	111.87	7.43		27+42.8	27+39.9						
30+0	121.32	112.47	8.85		28+06.5	28+03.5						
31+0	122.16	113.07	9.09		28+66.8	28+63.8						
32+0	123.68	113.67	10.01		29+27.1	29+24.1						
33+0	123.90	114.27	9.63	33+12.0	29+84.8	29+81.8						
34+0	124.07	115.47	8.60		30+45.2	30+42.2						
35+0	124.23	116.07	8.16		31+17.0	31+14.0						
36+0	124.25	116.45	7.80	36+63.0	31+72.7	32+16.9						
					32+35.9	32+42.0						
					32+96.4							
					(R) 33+18.7							
					33+54.1	33+72.8						
					34+03.6	34+32.6						
					(R) 34+45.3	34+62.9						
					34+84.1	34+93.0						
					35+23.0	35+23.0						
					35+59.4	35+53.4						
					35+83.6	35+83.6						
					36+11.7	36+13.9						
					36+41.1	36+41.1						
					36+55.5	(R) 36+53.1						

LINE # 3

(R) indicates riser

#2523 - Tap into M.H. 36+63 with Private line - 2003 S. Oliver - 12-10-45 - Jensen Adv. Co
 #804 - Tap-2128 S. Dellrose
 #805 - Tap-2122 S. Dellrose
 #806 - Tap-2118 S. Dellrose
 #817 - Tap-2114 S. Dellrose
 #903 - Tap-2110 S. Dellrose
 #295 - Tap-2135 S. Dellrose - 7-29-48 - Harley Riggs
 #2552 - Special R. ind. by Bryant - 10-3-50
 #1122 - 2107 S. Terrace 9-2-80 H. Nearing
 #2682 - 12-28-90 - 2001 S. OLIVER - NIK (35+41 TAP) (Ground Water clean up)
 93-19456-7 7-26-93 2101 S. TERRACE - R. walk - Bob said mess OK middle of lot. Repair of main only; 12' x 20' x 35'; 1-22' / off main