

SERVICE RECORD

CONSTRUCTION RECORD

DATE	DESCRIPTION	BY	REMARKS

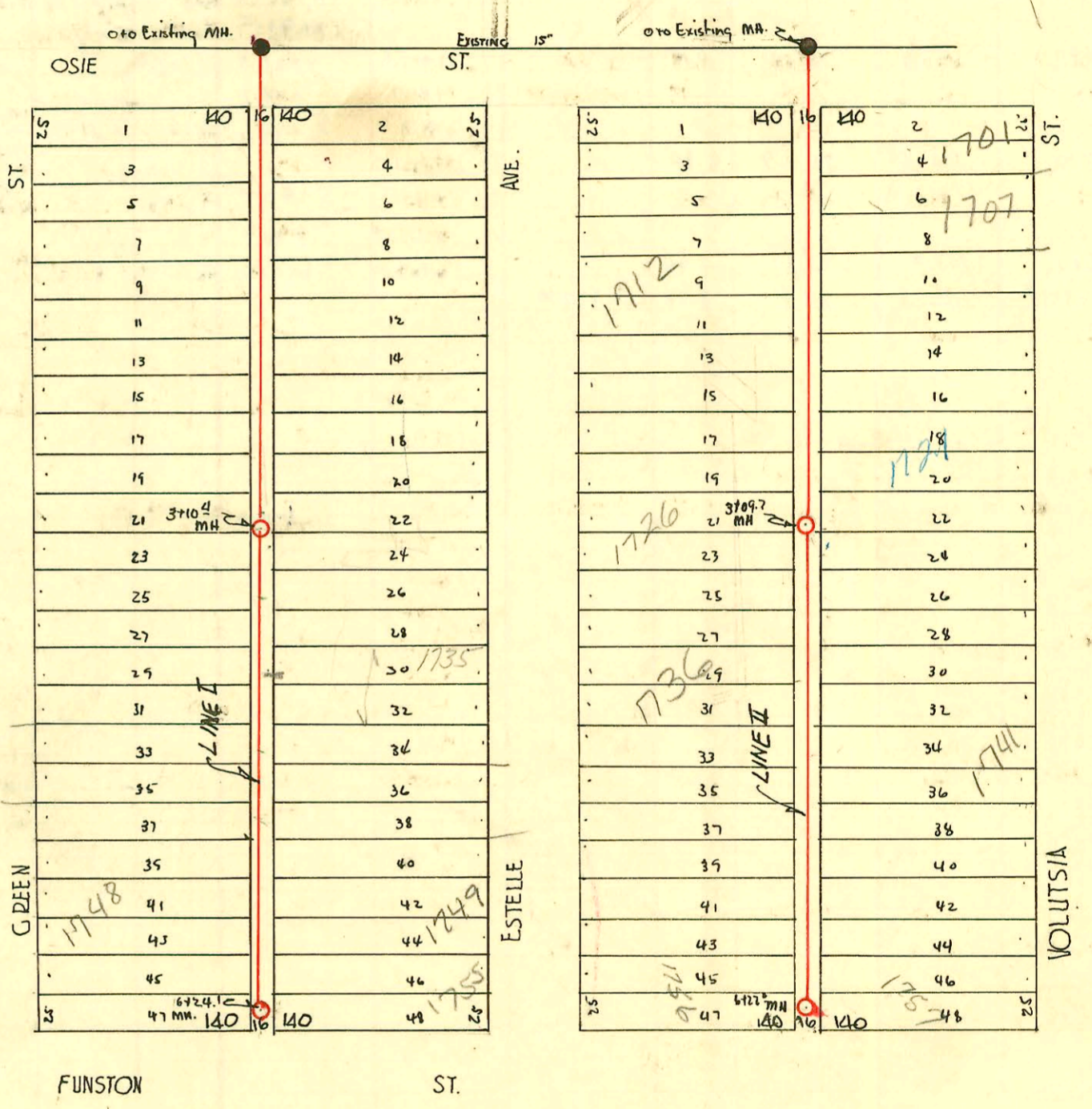

LAT. 7 DIST. AS. SS#12.
 W.B. CARTER CONST. CO.
 1949

CONSTRUCTION RECORD

SERVICE RECORD

LINE I

LINE II

STATION	ELEVATION		Depth	MANHOLE	4-INCH "Y" BRANCHES		No. of Permit		House Number		DATE OF PERMITS			
	Ground	Grade			North West	South East	North West	South East	North West	South East	North West	South East	North West	South East
0+0	99.5	94.08	6.57	0+0 Existing MH	0+61°	0+58°	#14726 #599	#592	1702 S. R. Estelle	1701 S. R. Estelle	3-21-80 6-23-49	9-23-85 6-23-49		
1+0	99.4	94.18	5.83		1+07.0 +59.2	1+04° +56.2	#02732 #598 #12680 #594	#1390 #593	1706 S. R. Estelle 1712 S. R. Estelle	1707 S. R. Estelle 1711 S. R. Estelle	3-2-81 6-23-49 11-26-80 6-23-49	6-11-64 6-23-49 6-23-49		
2+0	99.5	94.28	6.21		2+11' +60° +57°	2+08° +57°	#01887 #600 #601	4832 #595 #596	1716 S. R. Estelle 1722 S. R. Estelle	1717 S. R. Estelle 1721 S. R. Estelle	11-17-80 6-23-49 6-23-49	12-2-81 6-23-49 10-21-81 6-23-49		
3+0	99.6	94.38	6.07		3+06.7	3+03.7	#1393	#1388	1728 S. R. Estelle	1731 S. R. Estelle	8-26-49	8-26-49		
3+10.4	99.6	94.35	6.05	3110 4	+57.8	3+54.8	#1392	#1387	1730 S. R. Estelle	1735 S. R. Estelle	8-26-49	3-16-93 8-26-49		
4+0	99.9	94.48	5.83		4+07.4	4+04.4	#1391	#1386	1734 S. R. Estelle	1738 S. R. Estelle	8-26-49	2-19-03 8-26-49		
5+0	99.8	94.58	5.77		+59.0	+56.0	#1390	#1385	1738 S. R. Estelle	1744 S. R. Estelle	8-26-49	8-26-49		
6+0	99.5	94.68	5.20		5+08.0	5+05.0	#1389	#1384	1744 S. R. Estelle	1745 S. R. Estelle	8-26-49	9-10-64 8-26-49		
6+24.1	99.4	94.70	5.04	6+24.1	+56.9	+53.9	#2320 #20517 #2321	#2834 #94192477 #2833	1749 S. R. Estelle 1754 S. R. Estelle	1755 S. R. Estelle	11-3-49	4-29-02 12-13-49 11-28-44 12-13-49		
0+0	102.0	94.43	8.04	0+0 Existing MH	0+31.5 +62.0 +92.0	0+42.5 +65.0 +95.0	#2319	#1732	2001-01262 1702 S. Estelle	1701 S. R. Pipe Burst - See Below Voluntia	11-3-49	5-22-01 9-20-49		
1+0	102.1	94.53	8.06		1+16.2	1+19.5	#2954	#1731	1706 S. Estelle	1709 S. Voluntia	12-29-49	9-20-49		
					+40.1	+43.1	#2955	#1730	1712 S. Estelle	1711 S. Voluntia	12-29-49	9-20-49		
2+0	102.4	94.63	7.77		+88.3	+91.8	#2956	#1729	1716 S. Estelle	1717 S. Voluntia	12-29-49	9-20-49		
					2+10.3	2+13.3	#2957	#1728	1722 S. Estelle	1721 S. Voluntia	12-29-49	9-23-95 9-20-49		
3+0	102.6	94.73	8.21		+86.7	+89.7	#93-17627 #1728	#1727	1726 S. Estelle	1727 S. Voluntia	5-17-93 12-29-49	9-20-49		
3+09.7	102.7	94.74	8.23	3+09.7	+40.6	+43.6	#2318	#1726	1732 S. Estelle	1731 S. Voluntia	11-3-49	10-7-46 9-20-49		
					+58.8	+61.8	#20318	#1725	1736 S. Estelle	1737 S. Voluntia	3-22-88 11-3-49	9-20-49		
4+0	102.2	94.83	8.84		+87.6	+92.6	#2317	#1725	1742 S. Estelle	1741 S. Voluntia	11-3-49	9-13-95 9-20-49		
					+409.9	4+12.9	#2316	#1724	1746 S. Estelle	1747 S. R. Voluntia	11-3-49	9-20-49		
					+35.0	+38.3	#2315	#1723	1750 S. Estelle	1751 S. Voluntia	3-2-79 11-3-49	9-20-49		
5+0	102.8	94.93	8.30		5+09.7	5+12.7	#2314	#1722	1754 S. Estelle	1755 S. Voluntia	11-3-49	9-20-49		
					+82.5	+85.5	#170426 #2313	#1721	1756 S. Estelle	1757 S. Voluntia	8-23-49	8-12-85 9-20-49		
6+0	102.6	95.03	7.96		+51.6	+60.6	#1318	#1721	1756 S. Estelle	1757 S. Voluntia	8-23-49	8-12-85 9-20-49		
6+22.0	102.5	95.05	7.88	6+22.0	6+15.4	6+16.4								

2001-01262-5122101-1701 S Voluntia - Roto Rooter (Pipe Burst) 4" PE SDR17 donut 65' S of MH 0+0 (0+65) TWIN CO, 1122, 1145, 3 Fernco
 170428-1752- S. ESTELLE - SEWERS - 3-2-79 N-C. Lap 5+74.2

B 1391 - 1707 S. Estelle top - Keith Willard & Sons - 6-11-64 (1+23)

top B 1966 - 1745 S. Estelle - Phil's Draining - 9-14-64 (5+16)
 #93-11762-7 - 1726 S. Estelle - R-4" Wye 23' N of SPL - 4" PVC 40 - (couldn't locate MH) 1/4" pf shallow - dirt alley out