

SERVICE RECORD

CONSTRUCTION RECORD

DATE	DESCRIPTION	BY	DATE	DESCRIPTION	BY

280  
112500

OTO EXISTING MH

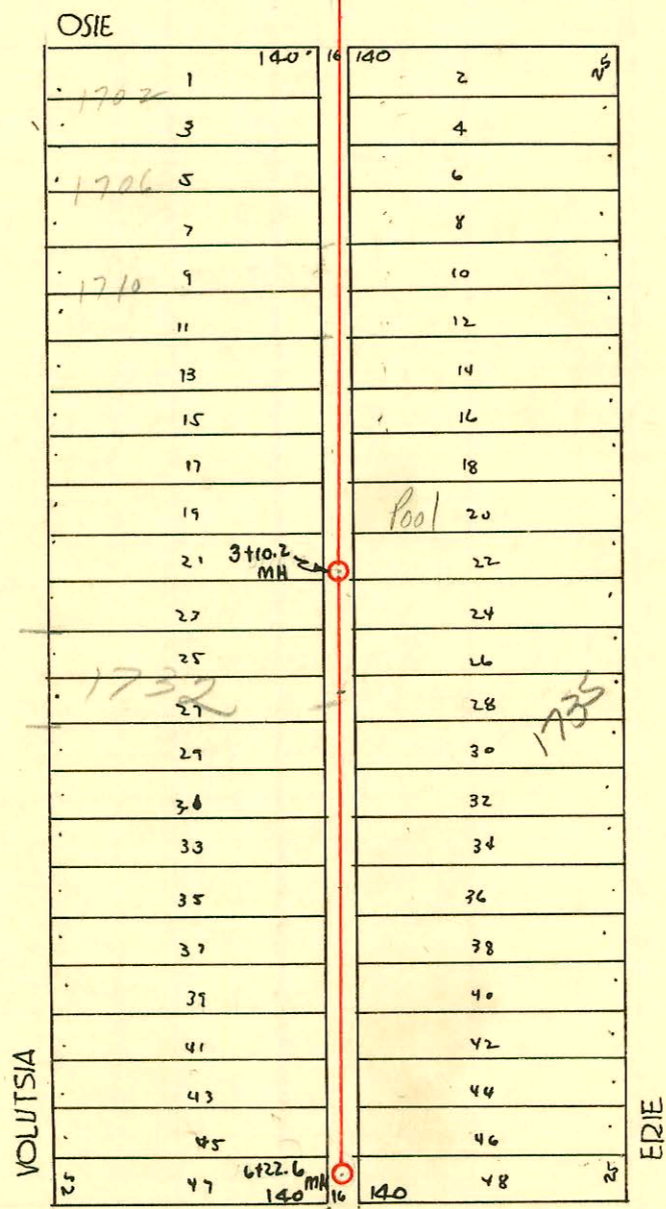

Lat. 1 Dist. Submain W, 55<sup>th</sup> 12  
W.B. Carter Const. Co.  
1949

CONSTRUCTION RECORD						SERVICE RECORD						
STATION	ELEVATION		Depth	MANHOLE	4-INCH "Y" BRANCHES		No. of Permit		House Number		DATE OF PERMITS	
	Ground	Grade			North West	South East	North West	South East	North West	South East	North West	South East
0+0	103.8	94.89	9.22	0+0 Existing MH.	0+48.7 0+60.4	0+53.4 +76.7 <sup>B</sup>	#548	#2666	1702 S. P. Volusia	1701 S. Erie	3-26-03 6-20-49	1-12-82 12-3-49
1+0	103.8	94.87	9.22		1+02.9	+76.8 +54.6 +78.6	#549	#2667	1706 S. Volusia	1702 S. Erie	6-20-49	12-3-49
2+0	104.9	94.99	10.20		2+03.5	+27.5 +54.9 +81.8	#551	#2669	1710 S. Volusia	1711 S. Erie	6-20-49	12-3-49
3+0	105.2	95.09	10.34	<del>3+10.2</del>								
3+10.2	105.3	95.10	10.11	3+10.2	3+18.0	+41.8 +78.0	#2250 #2544	#2671	1724 S. Volusia	1729 S. Erie	11-31-49	12-3-49
4+0	103.9	95.19	9.15		4+17.8	+41.7 +76.8	#1070		1736 S. Volusia		5-1-52	
5+0	103.8	95.29	8.80		5+19.2	+43.7 +67.9 +70.9	#2543	#2542	1742 S. Volusia	1741 S. Erie	11-21-49	10-24-50 1-19-93 10-24-49
6+0	103.5	95.39	8.44		6+04.0	+70.9	#2540	#902	1754 S. Volusia	1759 S. Erie	11-21-49	4-16-52
6+22 <sup>5</sup>	103.8	95.41	8.58	6+22 <sup>5</sup>								

2003-00788- 3/26/03-1702 S Volusia-Reddi- Pipeburst replacement-alley cut, city wye repair 4" Predco  
48.7' S of MH 0+00 (0+48.7) 2V45, 17W12 CO

#1160- Inf. 2820 E. Juniper - 8-10-49 - Brodie P. Co.