

EASEMENT # 2394 See easement on page 164 Book No. G, This book.

EASEMENT # 2394, Made this 26th day of January, 1950, From Faulders Builders Incorporated. The south two and one-half (2½) feet of Lots 4 and 13 and the north two and one-half (2½) feet of Lots 5 and 12, in Block K; All in Greendale Addition.



Scale 1" = 100'

SUBMAIN 2, WAR INDUSTRIES SEWER
Sta. 0+00 to Sta. 10+42

LAT. 1 SUBMAIN 2, W. I. S.
Sta. 10+42 to 39+05.7

PRIVATE JOB
GREENDALE ADDITION
City of Wichita, Kansas
L.K. White City Engineer
W. B. Carter 1949

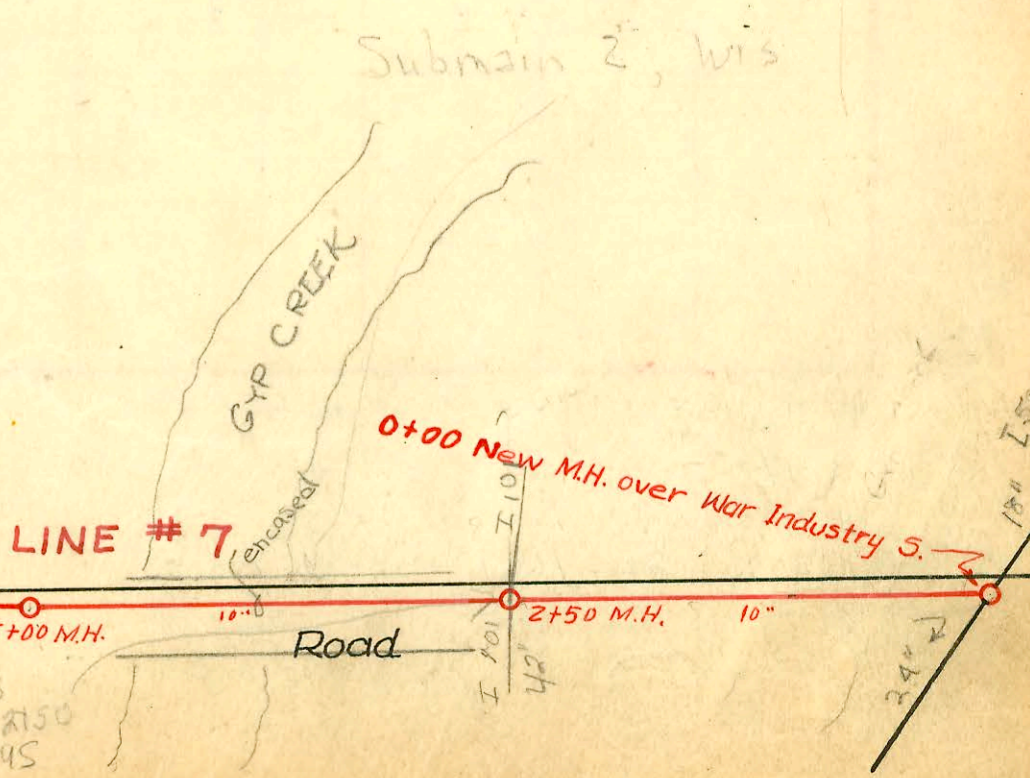

CONSTRUCTION RECORD

SERVICE RECORD

Line #7
Continued

STATION	ELEVATION		Depth	MANHOLE	4-INCH "Y" BRANCHES		No. of Permit		House Number		DATE OF PERMITS	
	Ground	Grade			North West	South East	North West	South East	North West	South East	North West	South East
0+00	125.4	108.14	17.55	0+00 New M.H.	Y North							
1+00	125.6	108.24	17.59									
2+00	126.2	108.34	18.14									
2+50	126.6	108.39	18.48	2+50 M.H.								
3+00	127.0	108.44	18.81									
4+00	118.1	108.54	9.81									
5+00	122.7	108.64	14.26 in 8.70 out	5+00 M.H.	5+57.5							
6+00	126.0	114.60	11.51		6+38							
7+00	127.3	115.00	12.93									
7+18	128.6	115.07	13.76 in 5.23 out	7+18 M.H.								
8+00	131.57	123.93	7.84									
9+00	133.5	124.33	9.40									
10+00	136.2	124.73	11.71		Y West	Y East						
10+42	136.7 137.0	124.90 125.98	12.95 in 11.17 out	10+42 M.H.	10+73.8	10+70.8	#3855 #5031	#6759 #6758	1965 R 1954 1954	1959 Roanoke Roanoke	3-10-53 2-19-51 See Below	12-10-51 12-10-51
11+00	138.0	126.17	12.02		11+22.4	11+19.4						
11+79.3	137.3	126.90	13.13	11+79.3 M.H.								
12+00	139.6	126.47	13.35		12+13.2	12+10.2		#6757		1949 Roanoke		12-10-51
					+77.3	+74.3	#3833	#6385	1744 S Edgemoor	1943 Roanoke	2-8-51	7-27-51
13+00	141.0	126.77	14.39		13+38.3	13+35.3	#3832		1938 S Edgemoor	1931 Roanoke	2-8-51	7-27-51
						+99.3		#6384				
14+00	141.5	127.07	14.71		14+02.3			#3831	1932 S Edgemoor		2-8-51	
14+09.6	141.6 141.6	127.09 #E	14.79	14+09.6								
					14+75.8	14+72.8	#3830	#5383	1926 S Edgemoor	1925 Roanoke	2-8-51	7-27-51
15+00	141.6	127.37	14.47		15+40.2	15+37	2003-00612 #3827	#5382	1920 S R Edgemoor	1919 Roanoke	3-11-53 2-8-51	7-27-51
						+97.8			1914 S R Edgemoor		9-2-50 2-8-51	
16+00	141.0	127.67	13.52		16+00.8			#3828				
16+24.3	140.6	127.74	13.11	16+24.3					1908 S Edgemoor		2-8-51	
					16+59.2	16+56.2		#3827				
17+00	139.8	127.97	12.03		17+22.6	17+19.6						
18+00	138.8	128.27	10.82		18+41.6	18+38.6	#1554	#5100	1844 S Edgemoor	1851 Roanoke	7-7-50	6-27-51
19+00	138.2	128.57	9.83									
					19+05.7	19+02.7	#1555	#5099	1884 S Edgemoor	1897 Roanoke	7-7-50	6-27-51
19+32.8	138.8	128.67	10.38	19+32.8								
					19+63.5	19+60.5	#1556	#5098	1882 S Edgemoor	1821 Roanoke	7-7-50	6-27-51
20+00	139.7	128.87	11.07		20+25.2	20+22.2	#1557	#5097	1886 S Edgemoor	1825 R Roanoke	7-7-50	12-1-53 6-27-51
					+90.0	+87.0	#1558	#5096	1820 S Edgemoor	1819 Roanoke	7-7-50	6-27-51
21+00	141.1	129.17	12.17		21+50.5	21+47.5	#1559	#5095	1804 S Edgemoor	1813 Roanoke	7-7-50	6-27-51
21+77.8	142.2	129.41	13.01 in 10.37 out	21+77.8								
22+00	142.6	132.12	10.74		22+09.0	22+06.0	#1560	#5093	1809 S Edgemoor	1809 Roanoke	7-7-50	6-27-51
					+70.3	+67.3	#1561	#5092	1806 S Edgemoor	1801 Roanoke	7-7-50	6-27-51
23+00	143.6	132.42	11.41		23+96.0	23+93.0	#1407	#5038	1748 S Edgemoor	1747 Roanoke	6-27-50	6-18-51
24+00	143.8	132.72	11.34		24+63.7	24+60.7	#1408	#5037	1744 S Edgemoor	1741 Roanoke	6-27-50	6-18-51
24+94.3	143.7	133.00	10.93 in 8.93 out	24+94.3								
25+00	143.8	135.01	9.03		25+28.6	25+25.6	#1409	#5036	1738 S Edgemoor	1737 Roanoke	6-27-50	6-18-51
					+96.8	+93.8	#1410	#5035	1732 S Edgemoor	1731 Roanoke	6-27-50	6-18-51
26+00	144.0	135.16	8.99		26+64.5	26+61.5		2003-01971 #5134	1725 R Edgemoor		7-28-53 6-18-51	
27+00	143.7	135.31	8.84		27+27.5	27+26.1	#1412	#5033	1720 S Edgemoor	1719 Roanoke	6-27-50	6-18-51
					+93.6	+90.6	#1551	#5032	1714 S Edgemoor	1713 Roanoke	7-7-50	6-18-51
28+00	143.7	135.46	8.52		28+23.3	Stub North						
28+23.3	143.9 143.7	135.49 135.48	8.61 in 8.45 out	28+23.3								
Stub No. 0+00				0+00 = 28+23.3								
					0+38.6	0+35.6	#1552	#5034	1708 S Edgemoor	1709 S Roanoke	7-7-50	6-18-51
					+82.1	+79.1	#1553	#5035	1705 S Edgemoor	1705 S Roanoke	7-7-50	6-18-51
0+86	143.6	135.58	8.38	0+86								

2000-00033- 117100-BTL Exc-4"SCH40-Donut 59.9'S of MH 11+79.3 (1119.4) ITWINCO, 2V22, 1H22, 1V45
 2003-00612- 3/11/03- 1920 S Edgemoor- RD Campbell 4" PVC, ITWINCO, 3V22, 1H22, Shallow, 4" Pradco 87'S of MH
 16+24.3 (15+37.3) City Wye repair

#1411- Tap at 1726 S. Edgemoor - 6-27-50 - Max Hinshaw
 Tapped at 26+44.5
 #3826- Tap - 1902 S. Edgemoor - 2-8-51 - Robinson P. Mfg. Co
 #3834- Tap - 1948 S. Edgemoor - 2-8-51 - Robinson P. Mfg. Co
 #4389- Tap - 1913 Roanoke - 4-18-51 - Eugene Reynolds
 #4390- Tap - 1937 Roanoke - 4-18-51 - Eugene Reynolds
 #5190- Tap - 1907 Roanoke - 7-7-51 - Frederick P. Mfg. Co. - Tap at 16+50.8
 #5191- Tap - 1901 Roanoke - 7-7-51 - Frederick P. Mfg. Co. - Tap at 17+11.6
 #5922- 5920 Mt. Vernon - 7-23-53
 School. Tap - Randall P. Mfg. Co
 #4562- Private Line Conn. See 2003-01971 5-335