

RECORD RECORD



EASEMENT # 2526, Made Dec. 15th, 1951, by James S. Bato and Yvonne J. Cato. — Beginning at a point 12 feet west of the N.E. corner of the following described tract: Beginning 30 feet E. and 47.42 feet N. of S.W. cor. of N. 1/2 of S.W. 1/4 Sec. 36, T. 27 S., R. 1 E., of 6th P.M.; thence N. 104.355 feet; thence E. 228.71 feet; thence S. 104.355 feet; thence W. to point of beginning; — Thence S. 20 feet; thence W. 16 feet; thence N. 20 feet; thence E. 16 feet to place of beginning.

EASEMENT # 2527, Made Nov. 16th, 1951, by Norman H. Bekemeyer and Dorothy Louise Bekemeyer. — The east 8 feet of the following described tract: — Beginning 30 feet E. and 626.13 feet N. of S.W. cor. of N. 1/2 of S.W. 1/4 of Sec. 36, T. 27 S., R. 1 E., of 6th P.M.; thence E. 208.71 feet; thence N. 104.35 feet; thence W. 208.71 feet; thence S. 104.35 feet to place of beginning, Sedgwick County, Kansas.

EASEMENT # 2528, Made Nov. 24th, 1951, by Henry C. Richert and Lois G. Richert. — The E. 8 feet of the following described tract: — Beginning at a point 30 feet E. and 730.48 feet N. of the S.W. cor. of the N. 1/2 of the S.W. 1/4, Sec. 36, T. 27 S., R. 1 E., of 6th P.M.; thence E. 208.71 feet; thence S. 104.36 feet; thence W. 208.71 feet; thence N. 104.36 feet to place of beginning.

EASEMENT # 2529, Made Dec. 10th, 1951, by Roy F. and Mildred D. Spencer. — Beginning at a point 28 feet west of the N.E. cor. of the following described tract: — Beginning 30 feet E. and 521.775 feet N. of S.W. cor. of N. 1/2 of S.W. 1/4, Sec. 36, T. 27 S., R. 1 E., of 6th P.M.; thence N. 104.355 feet; thence E. 228.71 feet; thence S. 104.355 feet; thence W. to place of beginning. — Thence S. 104.355 feet; thence E. 16 feet; thence N. 104.355 feet; thence W. to place of beginning.

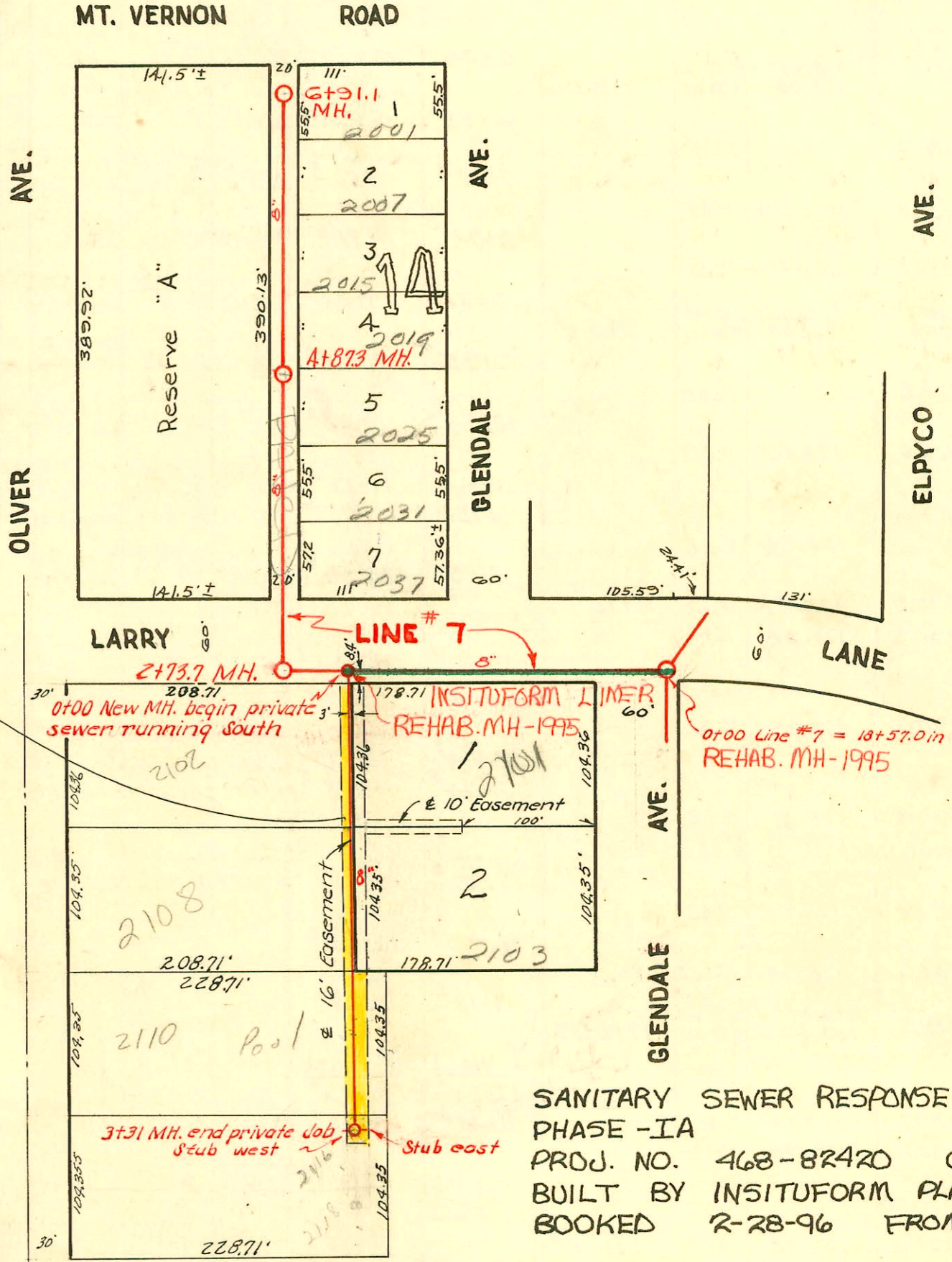

PRIVATE SEWER  
 EBY CONST. CO.  
 Jan. 11, 1952  
 JT58

SANITARY SEWER RESPONSE PLAN  
 PHASE -IA  
 PROJ. NO. 468-82420 (623124)  
 BUILT BY INSITUFORM PLAINS, INC.  
 BOOKED R-28-96 FROM AS BUILTS

