

LAT. 38, S. S. # 20

W. B. CARTER, JULY 2, 1953

BK. JT. 70, PROJ. NO. C23-22

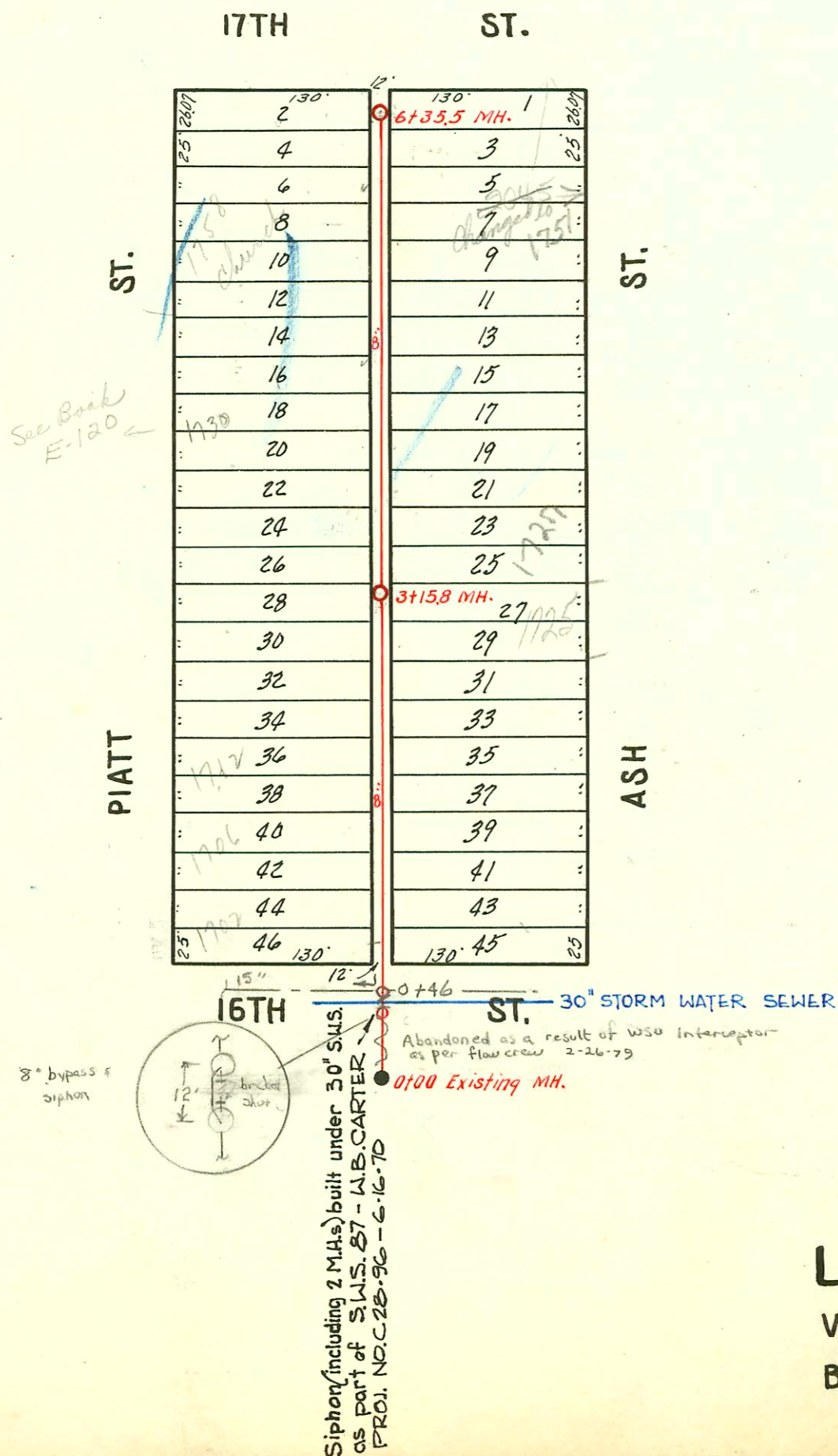

SCALE 1" = 100'

LAT. R, DIST. O, S. S. # 12

W. B. CARTER - MARCH, 1953

BK. NO. JT. 58 - PROJ. NO. C23-6

