

1993 SANITARY SEWER REHABILITATION
 PROGRAM - PHASE III
 PROJ. NO. 468-82348 (632000)
 BUILT BY W.B. CARTER
 BOOKED 10-17-94 AS PER PLAN

NOTE: District is not shown.
 See Appraiser's plat in City clerk's office for benefit district.

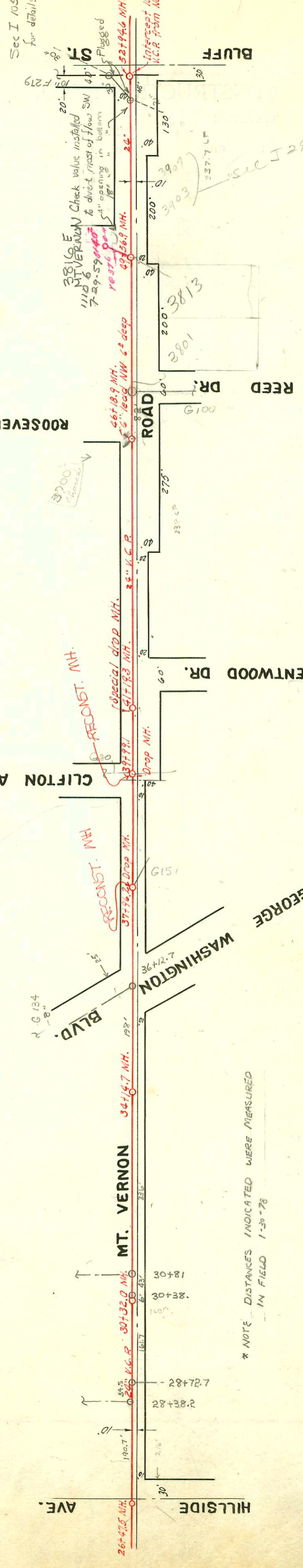

DRY CREEK
SUB-MAIN No 2, S. S. No 12
 W. B. CARTER 1953
 BK. DRY CREEK #2 SUB, PROJ. NO. C20-67
 Booked MAY 12, 1953
 1" = 150'

* NOTE DISTANCES INDICATED WERE MEASURED IN FIELD 1-30-78

NOTE: Construction Record for this project is shown on pages 140 to 146 inclusive.

CONSTRUCTION RECORD						SERVICE RECORD						
STATION	*ELEVATION		Depth	MANHOLE	4-INCH "Y" BRANCHES		No. of Permit		House Number		DATE OF PERMITS	
	Ground	Grade			North West	South East	North West	South East	North West	South East	North West	South East
0+0	98.4	90.05	8.3	0+00 Exist'g MH.								
	97.9	90.08	7.8	0+35.8								
1+0	97.8	90.14	7.7									
2+0	97.7	90.22	7.5									
3+0	97.5	90.30	7.2									
4+0	97.5	90.38	7.1									
	97.5	90.46	7.0	4+96.6								
5+0												
6+0	97.5	90.54	7.0									
7+0	97.8	90.62	7.2									
8+0	97.7	90.70	7.0									
	97.8	90.71	7.1	8+16.7								
9+0	97.4	90.78	6.6									
10+0	97.9	90.86	7.0									
11+0	98.4	90.94	7.5									
	98.5	90.97	7.5	11+36.5								
12+0	98.4	91.02	7.4									
13+0	98.5	91.10	7.4									
14+0	98.6	91.18	7.2									
	98.4	91.19	7.2	14+05.2								
15+0	98.7	91.26	7.4									
16+0	99.5	91.34	8.2									
17+0	99.9	91.42	8.5									
18+0	100.5	91.50	9.0									
	100.5	91.50	9.0	18+09.0								
19+0	100.7	91.58	9.1									
20+0	100.5	91.66	8.8									
21+0	100.8	91.74	9.1									
22+0	100.8	91.82	9.0									
	100.8	91.83	9.0	22+10.0								
23+0	101.0	91.90	9.1									
24+0	100.7	91.98	8.7									
25+0	100.5	92.06	8.4									
26+0	100.7	92.14	8.6									
	100.7	92.15	8.6	26+16.5								
	100.5	92.49	8.0	26+47.5								
27+0	100.7	92.54	8.2									
28+0	100.8	92.64	8.2									
29+0	101.0	92.74	8.3									
30+0	101.1	92.84	8.3									
	101.2	92.86	8.3	30+32.0								
31+0	101.4	92.94	8.5									
32+0	101.6	93.04	8.6									
33+0	101.6	93.14	8.5									
34+0	102.1	93.24	8.9									
	102.1	93.25	8.9	34+14.7								
35+0	102.4	93.34	9.1									
36+0	103.0	93.44	9.6									
37+0	104.4	93.54	10.9									
	107.0	93.62 out 100.64 in	13.4 6.4	37+96.2								
38+0												
39+0	111.2	100.74	10.5									
	117.5	100.84 out 107.77 in	16.7 9.7	39+99.1								
40+0												
41+0	123.8	107.87	15.9									
	124.5	107.89 out 112.64 in	16.6 11.9	41+19.3								
42+0	130.4	112.72	17.7									
43+0	134.7	112.82	21.9									
44+0	135.6	112.92	22.7									
45+0	134.7	113.02	21.7									
46+0	131.7	113.12	18.4									
	131.4	113.14	18.3	46+18.9	(6" Lead NW, 62° deep)							
47+0	128.5	113.22	15.3									
48+0	125.6	113.32	12.3									
49+0	124.6	113.42	11.2									
	124.7	113.47	11.2	49+56.9								
50+0	124.5	113.52	11.0									
51+0	124.4	113.62	10.8									
52+0	124.1	113.72	10.4									
	125.3	113.81	11.5	52+94.6								

20872 - 6-14-68 - 3813 E Mt. View - Henning

70

64425

3700 E. Mt. View 4-14-65