

See page 76, Bk. G. for existing S.S. to serve lots 14, 15, 16, 17, 18 & 19.

2003-02860 11/3/03 5618 E Coe Ark Valley Plog. Install 2 cleanouts - 1V22, 1H22, 2V45, 1W45, 2TWIN 4" 40PVC had addition into house line
 2003-02355 9/9/03 5647 Coe. Wichita EXC - city wye repair
 4" PVC Tee 5' 50ft MH 11+02.9 (11+07.9) TWIN CO, 1V45, 2V22, 4" 40PVC

LAT. 39, D.C.S. 2, S. S. NO. 12
 W. B. CARTER NOV. 8, 1954
 BK. No K-24 PROJ. NO. C24-58

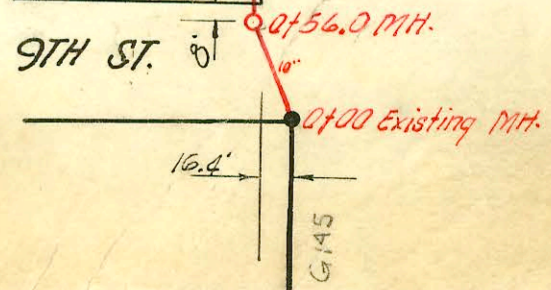

CONSTRUCTION RECORD

SERVICE RECORD

STATION	ELEVATION		Depth	MANHOLE	4-INCH "Y" BRANCHES		No. of Permit		House Number		DATE OF PERMITS			
	Ground	Grade			North West	South East	North West	South East	North West	South East	North West	South East	North West	South East
0+0	189.4	175.00 out 175.22 out 179.22 in	12.4 14.2 10.2	0+00 Existg MH. 0+56.0										
1+0	190.1	179.40	10.7		0+78.0		#2561		1002 N LANTANA					
2+0	190.5	179.80	10.7		1+22.0 1+89.0		#2562 #2563		1008 N LANTANA 1014 N LANTANA					
3+0	190.1	180.20	9.9		2+46.2		#2564		1020 N LANTANA					
3+0	190.2	180.44	9.8	3+60.5	4 PVC 40 3+07.0		#4561		1026 N LANTANA		5-3-55			
4+0	190.3	180.60	9.7		3+70.0		#4563		1032 N LANTANA		5-2-55			
5+0	190.1	181.00	9.1		4+30.5 4+88.0		#4564 #4565		1038 N LANTANA 1044 N LANTANA		5-3-55 5-3-55			
6+0	191.2	181.40	9.8		5+47.7		#4566		1050 N LANTANA		5-3-55			
6+0	191.0	181.66 Out 181.86 in	9.3 9.1	6+66.0	6+03.5		#4567		1056 N LANTANA		5-3-55			
7+0	191.7	182.00	9.7		6+89.0		6178		1062 N LANTANA		8-30-55			
8+0	191.2	182.40	8.8		8+07.0		#6179		5734 2.100		8-30-55			
9+0	192.5	182.80 Out 184.80 in	9.7 7.7	9+00.4	9+08.5									
10+0	192.9	185.20												
11+0	194.1	185.61 Out 185.81 in	8.5 8.3	11+02.9	PVTEE by city 11+07.9		2003-02355 52095 #2177		5647 Coe Ct 5655 Coe Ct 5655 Coe Ct	R see next pg	9-9-03 3-2-82 5-31-79 1-13-55			
12+0	193.3	186.20	7.1		11+62.5		272096				5-31-79			
12+0	193.1	186.43	7.0	12+54.4	12+64.0		#3996		5662 Coe Ct		3-28-55			
13+0	193.4	186.60	6.8		13+60.6		#6923		5650 Coe Ct		11-15-55			
14+0	194.2	187.00	7.2											
14+0	194.6	187.18	7.4	14+43.5										
15+0	194.8	187.40	7.4		15+59.3		#6671		5642 Coe Ct		10-7-55			
16+0	195.0	187.80	7.2											
16+0	194.8	187.94	6.9	16+35.0										
Line #2	0+0	193.4	6.5	0+00 = 12+54.4 in Line #1	NORTH	SOUTH								
1+0	194.2	187.30	6.9		1+98.0	1+95.0	25600 #4101	2001550 #4077	5635 B Coe Ct 5632 A Coe Ct		6-19-90 5-18-55	8-8-01 1-6-55		
2+0	195.6	187.70 188.00 Out 190.00 in	7.9 8.8 6.8	2+75.0	2+83.0	2+86.0	#3222	5637 Coe Ct	5624 Coe Ct		1-24-55	11-29-54		
3+0	197.2	190.10	7.1		3+56.0	3+59.0	#4178	5633 Coe Ct	5618 Coe Ct	R see next	4-11-55	11-3-03 6-27-55		
4+0	199.0	190.50	8.5		4+52.0	4+55.0	#4190	5611 Coe Ct	5610 Coe Ct		4-11-55	3-24-55		
5+0	200.6	190.90	9.7		5+24.6	5+27.6	#2835	5603 Coe Ct	5602 Coe Ct		12-3-54	3-9-57 6-27-55		
Line #3	0+0	201.6	10.5	5+50.0 0+00 = 16+35.0 in Line #1										
1+0	194.8	188.14	6.7		0+06.5		6177 #234		5622 B Coe Ct		7-16-82 3-14-56			
1+0	197.0	188.54	8.5		1+61.0	1+88.0	#3684	5639 Coe Ct	5636 Coe Ct		2-28-54	11-9-54		
2+0	199.3	188.94	10.4											
2+0	200.2	189.24 191.00	11.0 9.2	2+76.0										
3+0	200.2	191.10	9.1		3+13.0	3+16.0	5645 #2538	5623 Coe Ct	5620 Coe Ct		7-21-55	11-9-54		
4+0	201.6	191.50	10.1		4+24.0	4+24.0	#2147	5601 Coe Ct	5614 Coe Ct		5-12-91 11-2-54	9-11-08 7-7-54		
5+0	202.7	191.90	10.8		5+26.0	5+26.0	#2448	5607 Coe Ct			11-8-54			
	203.4	192.10	11.3	5+52.0										

Line #1

Line #2

Line #3

5635 Coe Ct - tap - stop - 5/16/55
5650 Coe Ct - tap - stop - 9/9/55
L-5647 Coe Ct - tap - stop - 4-10-56

See 2001-01992 8/13/01 5632 E Coe Roto Root R-
cut 4" PVC WYE INTO SDR 17 LINE - 2H22, IRWINCO
SWR 2001-01950 8/16/01 5632 E Coe R - Roto - 5 Fernco
Donut 80'E of MH 2175(1495) - 145 ST H, 2H45, 1H22
Pipe Burst Replace - 4" PE SDR17, IRWINCO