

H-159A

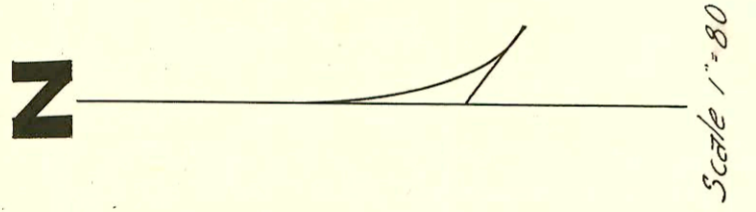

SUB 11, S.S. #22
 L. C. PEDDICORD CONSTR. CO. JULY 6, '56
 6+52' MH. BK NO. K-40 PROJ. NO. C26-25

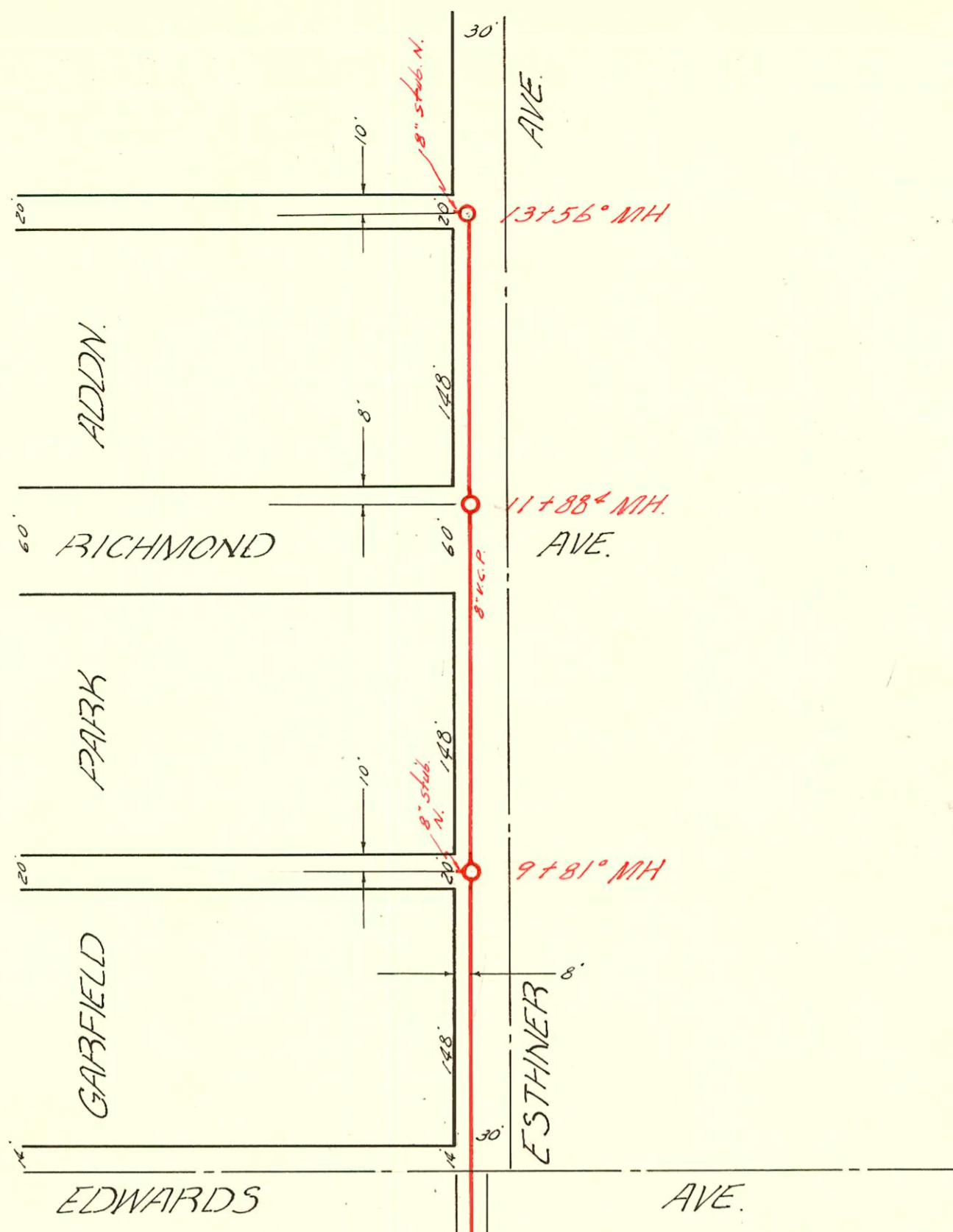
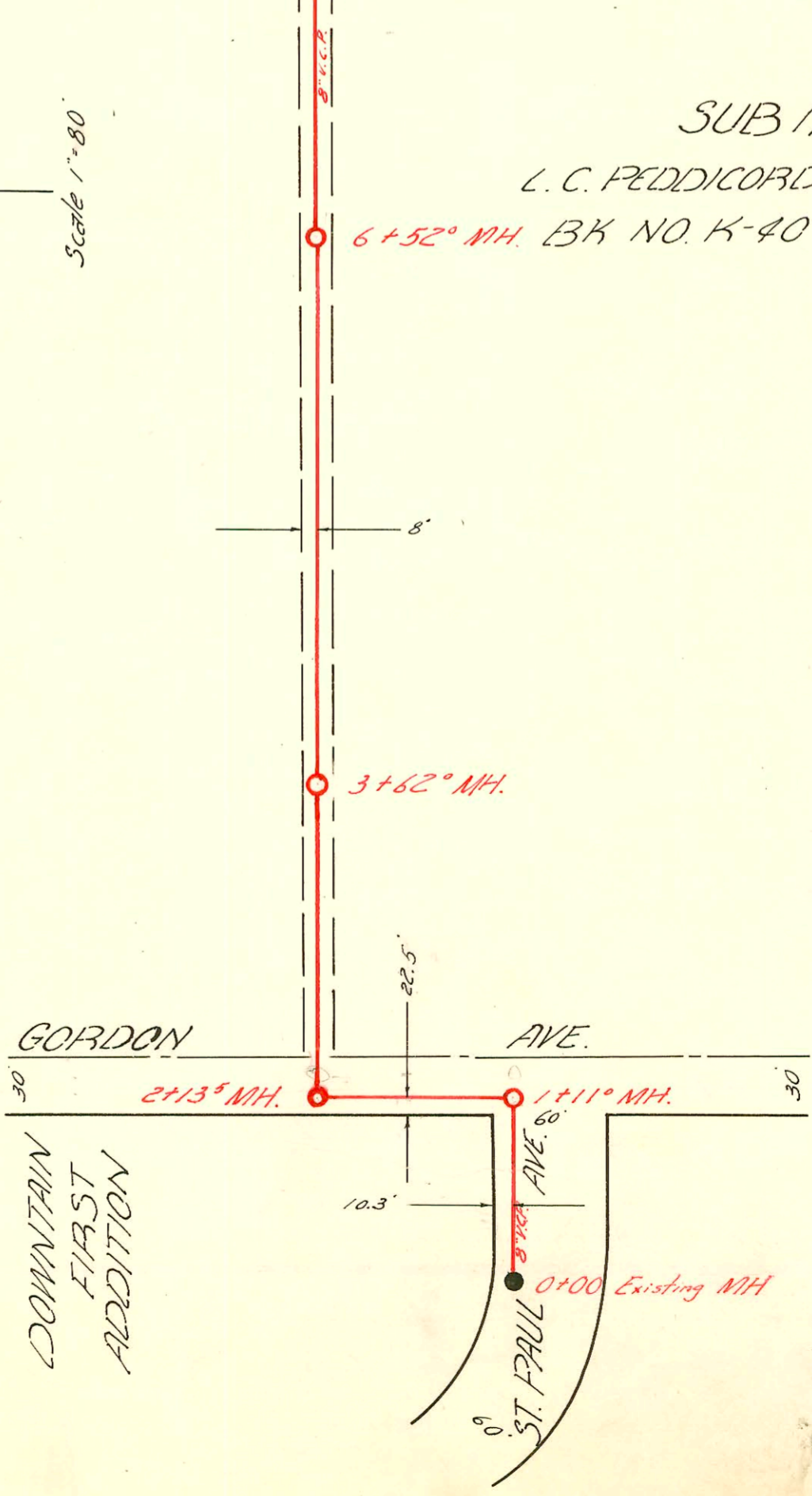

757
 1500
 1500
 1500

14-154

159

CONSTRUCTION RECORD						SERVICE RECORD						
STATION	ELEVATION		Depth	MANHOLE	4-INCH "Y" BRANCHES		No. of Permit		House Number		DATE OF PERMITS	
	Ground	Grade			North West	South East	North West	South East	North West	South East	North West	South East
0+00	105.8	99.41	6.39									
1+00	105.45	99.68	5.77									
				1+11°								
2+00	106.37	99.91	6.46									
	106.37	99.93	6.44	2+13°								
3+00	106.2	100.06	6.14									
	106.4	100.15	6.25	3+62°								
4+00	106.5	100.20	6.30									
5+00	106.8	100.35	6.45									
6+00	106.6	100.50	6.10									
	106.6	100.58	6.02	6+52°								
7+00	106.5	100.65	5.85									
8+00	106.8	100.80	6.00									
9+00	107.0	100.95	6.05									
	106.2	101.17	5.03	9+81°	8" stub N.							
10+00	106.2	101.10	5.10									
11+00	105.8	101.25	4.55									
	105.4	101.38	4.02	11+88°								
12+00	105.3	101.40	3.90									
13+00	105.8	101.55	4.25									
	105.5	101.73	3.77	13+56°	8" stub N.							