

LAT. 25 SUB. 3 S.S. 22 K-51 10-22-58  
 W.B. CARTER CONSTR. CO.  
 2 28-24

Scaled

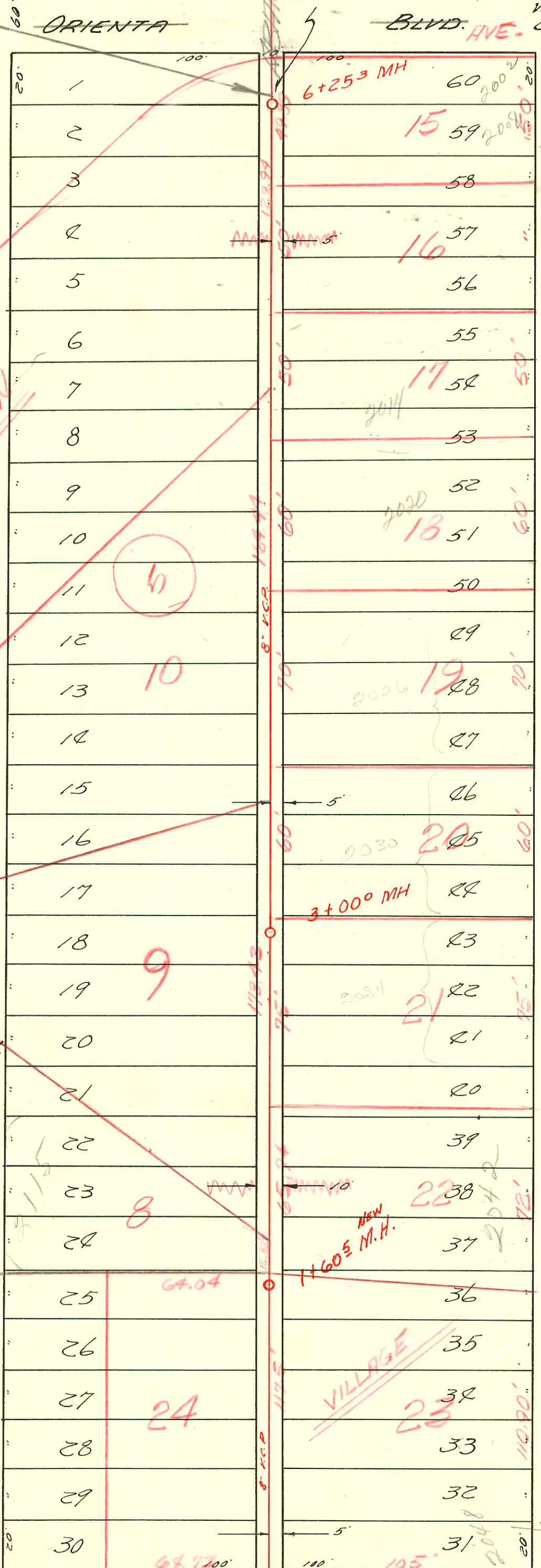

SOUTH

27TH STREET

BENNETT AVE.

AVE.

LAT. 22 SUB 3 S.S. 22  
 UTILITY CONTR. INC., SEPT. 27 '56  
 BK NO. K-28 PROJ. # C26-84

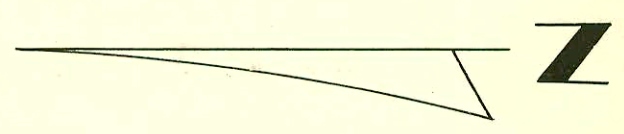

CONSTRUCTION RECORD

SERVICE RECORD

STATION	ELEVATION		Depth	MANHOLE	4-INCH "Y" BRANCHES		No. of Permit		House Number		DATE OF PERMITS	
	Ground	Grade			North West	South East	North West	South East	North West	South East	North West	South East
Cont. CINE #7 5+00	121.3	115.8	5.5		+98 <sup>8</sup>		#2762		740 N. West		10-15-56	
	121.3	116.2	5.1	5+995	+87 <sup>1</sup>	+85 <sup>1</sup>	C1901		134 N. West		4-17-68	
LINE #7A 0+00									724 N. West		9-22-97	
1+00	121.7	115.6	6.1									
	121.7	115.9 IM	5.7	1+678	TURN So.							
2+00	121.6	116.1	5.5		4" SCH 40		2000-00110		710N West (Walgreens)		1-25-00	
3+00	121.4	116.5	4.9		2+51.8							
CINE #8 0+00	121.2	116.9	4.3	3+993		3+833 TAP		25252	708 N. West		4-30-90	
1+00	121.0	114.5	6.5		+28 <sup>0</sup>	+26 <sup>0</sup>						
						+89 <sup>4</sup>						
1+00	121.1	115.5	5.6									
	121.2	116.4	5.2	1+505								
#218-Top (102 N. West St) Callison 9-21-56 #B-530-Top (714 N. West St) Davis Trenching Service 12-7-63 (at 13 7A)												
LAT. 22 SUB. 3 S.S. #22												
0+00	98.6	89.9	8.7	Existing manhole	Y NORTH	Y SOUTH						
					+72 <sup>6</sup>	+76 <sup>6</sup>		#11607	2048 W. 27th St.		11-19-68	
1+00	98.3	90.1	8.2		+18 <sup>0</sup>	+20 <sup>0</sup>						
					+52 <sup>0</sup>	+52 <sup>0</sup>						
2+00	97.9	90.3	7.6	1+605 NEW M.H.	+97 <sup>4</sup>	+99 <sup>4</sup>	10130	C1467	2115 3042 Pricefield W 27th		4-21-59	6-26-69
						+19 <sup>7</sup>						
3+00	98.0	90.5	7.5	3+00 <sup>0</sup>	+37 <sup>3</sup>	+72 <sup>7</sup>	C2808	#2615	2751 Diamond	2034 W 27th	4-25-67	10-3-66
					+17 <sup>9</sup>							
4+00	98.4	90.7	7.7		+57 <sup>5</sup>	+96 <sup>0</sup>		#2646	2038 W 27th			10-3-66
					+98 <sup>0</sup>			#2657	2026 W 27th			10-3-66
5+00	97.9	90.9	7.0		+36 <sup>7</sup>	+55 <sup>9</sup>		#3613	2020 W 27th			2-1-57
					+80 <sup>5</sup>							
6+00	98.0	91.1	6.9		+12 <sup>5</sup>	+37 <sup>9</sup>						
					+52 <sup>9</sup>							
7+00	98.0	91.2	6.8	6+253	5+86.3	+78 <sup>0</sup>	B4877	8657	2781 Diamond	2008 W 27th St	1-4-66	11-14-58
					+96 <sup>5</sup>							
8+00	98.0	91.2	6.8	6+253	+15 <sup>4</sup>	+17 <sup>4</sup>	3757	8656	2757 Oriente Blvd	2007 W 27th St	2-14-57	11-14-58
<del>LAT. 25 SUB. 3 S.S. 22</del>												
0+00	98.3	91.56	6.7	Existing M.H.								
1+00	97.9	91.76	6.1		+30 <sup>4</sup>	+28 <sup>4</sup>	12134		1929 Springfield		1-1-60	
	97.9	91.83	6.1	1+357 (O.H.) M.H.				12755	2757 S. Glenn			5-11-60

#3645 - 1014 N. 27th - Top - R. K. Ray - 2-1-57 (R) 255960 - 6-16-76 - get better  
 #2522 Spec. for paid Rev. #43453 - 2757 S. Glenn - Phipps Bldg. 5-11-60  
 #3191 - Top - Moon + Gillis - 2768 So. Bennett 5-22-67 (0+52.5)