

SCALE 1"=150'

ADDITION TO SUB "R" SAN. S. 20  
 W.B. CARTER CONST. CO. JUNE 27 '60  
 BK. NO. K-68 PROJ. NO. C 21-69  
 RECON PORTION SS N<sup>o</sup> 1  
 BUILT BY: CLEARWATER EXCAV. CO.  
 PROJ. N<sup>o</sup> 542-80-245-80034-000-000-001  
 BOOKED 8-10-81 FROM AG 13A

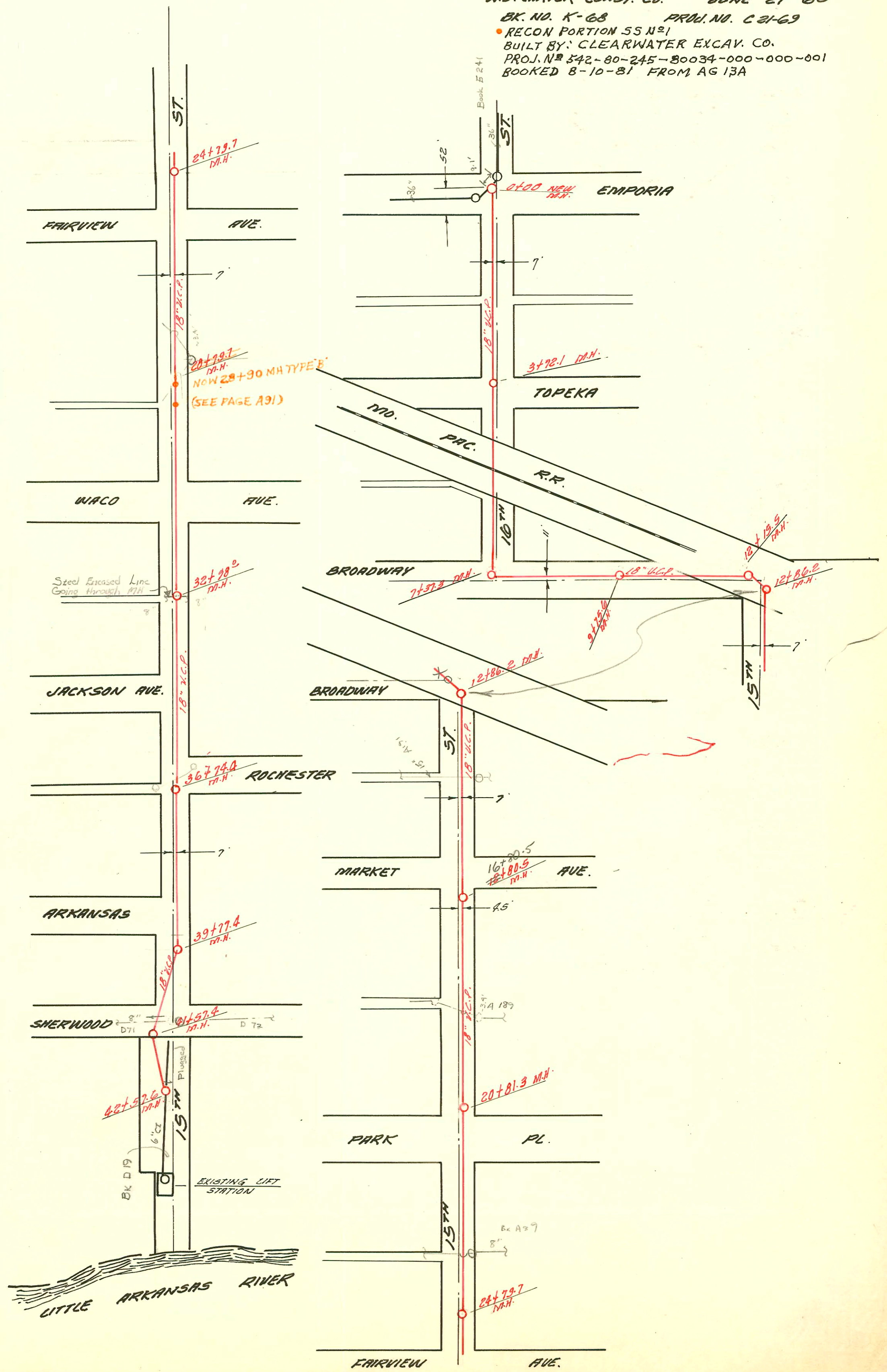

CONSTRUCTION RECORD						SERVICE RECORD						
STATION	ELEVATION		Depth	MANHOLE	4-INCH "Y" BRANCHES		No. of Permit		House Number		DATE OF PERMITS	
	Ground	Grade			North West	South East	North West	South East	North West	South East	North West	South East
0+00	120.1	108.50	11.6	0+00 (NEW M.H.)								
1+00	120.0	108.62	11.4									
2+00	120.1	108.74	11.4									
3+00	120.1	108.86	11.2									
		120.3	108.95	11.3	3+72.1							
4+00	120.2	108.98	11.2									
5+00	121.1	109.11	12.0									
6+00	120.8	109.27	11.5									
7+00	120.5	109.34	11.1									
		120.6	109.37	11.2	7+37.3							
8+00	120.2	109.56	10.6									
9+00	120.2	109.68	10.5									
		119.9	109.77	10.1	9+25.6							
10+00	120.1	109.80	10.3									
11+00	119.7	109.92	9.8									
12+00	119.8	110.04	9.8									
		119.8	110.06	9.7	12+15.5							
			110.11	9.7	12+86.2							
13+00	120.0	110.26	9.7									
14+00	119.9	110.38	9.5									
15+00	119.8	110.50	9.3									
16+00	119.6	110.62	9.0									
		119.5	110.71	8.8	16+80.5							
17+00	119.6	110.74	8.9									
18+00	119.8	110.86	8.9									
19+00	119.9	110.98	8.9									
20+00	120.1	111.10	9.0									
		120.1	111.19	8.9	20+81.3							
21+00	120.3	111.22	9.1									
22+00	120.4	111.34	9.1									
23+00	120.2	111.46	8.7									
24+00	120.0	111.58	8.4									
		120.0	111.68	8.3	24+29.7							
25+00	120.1	111.70	8.4									
26+00	120.4	111.82	8.6									
27+00	120.1	111.94	8.2									
28+00	120.2	112.06	8.1									
		120.2	112.15	8.0	28+90							
					<del>28+79.7</del>							
29+00	120.2	112.18	8.0									
30+00	120.3	112.30	8.0									
31+00	120.3	112.42	7.9									
32+00	120.2	112.54	7.7									
		120.2	112.66	7.5	32+98.0							
33+00	120.2	112.66	7.5									
34+00	120.0	113.19	6.8									
35+00	119.9	113.73	6.2									
36+00	119.8	114.27	5.5									
		119.6	114.67	4.9	36+74.4							
37+00	119.7	114.70	5.0									
38+00	119.5	114.82	4.7									
39+00	119.4	114.94	4.5									
		119.5	115.03	4.5	39+77.4							
40+00	119.8	115.06	4.7									
41+00	120.2	115.18	5.0									
		120.0	115.25	4.7	41+57.4							
42+00	120.5	115.30	5.2									
		119.9	115.38	4.5	42+57.6							