

SCALE ≈ 1" = 100'

See Letter  
att: - P. 136

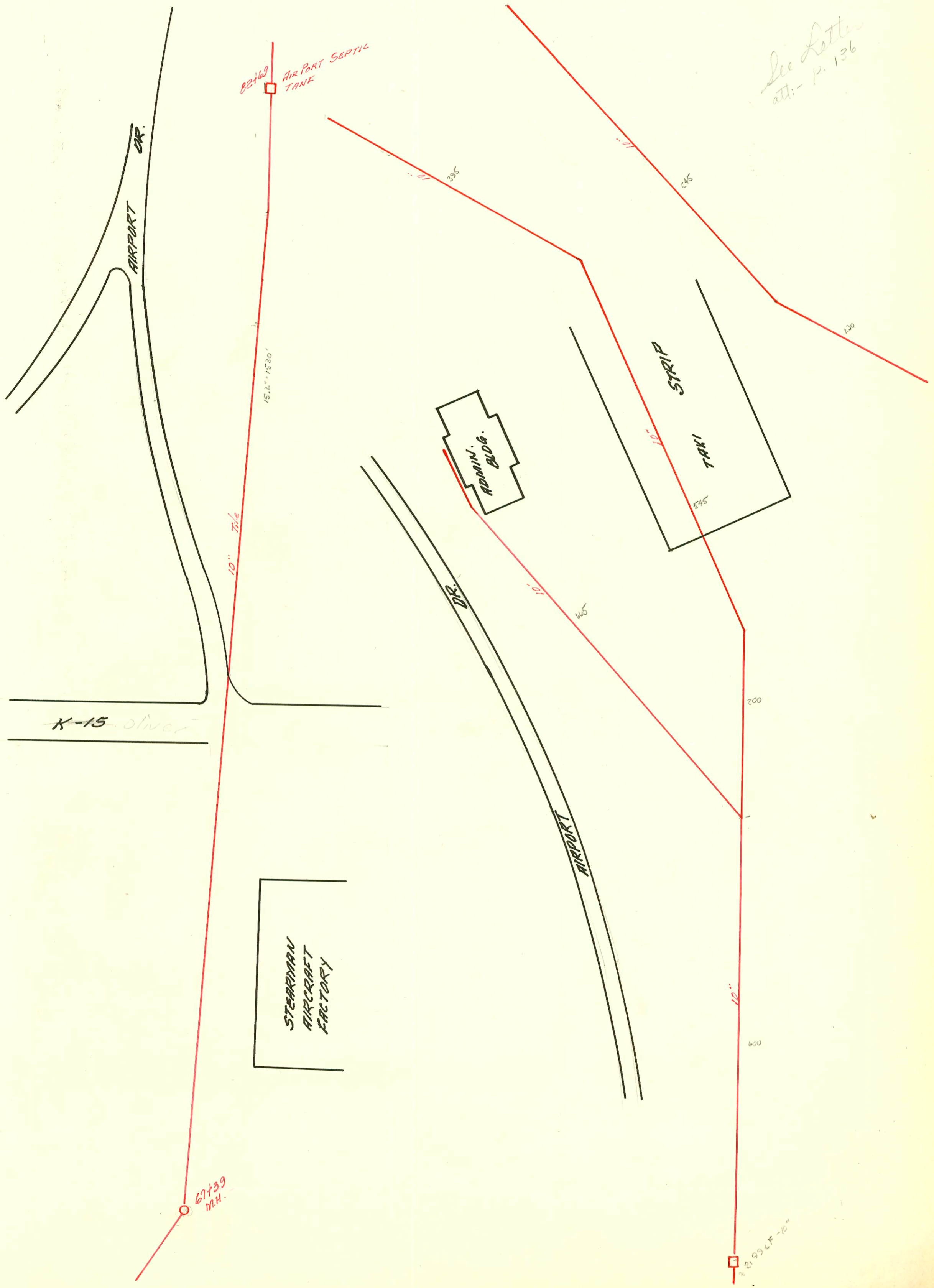

82+69 AIRPORT SEPTIC TANK

15.2" / 530'

10" 716'

K-15 Over

STARRMAN  
AIRCRAFT  
FACTORY

ADMIN.  
BLDG.

STRIP

TAXI

AIRPORT

67+39  
M.H.

21,99 LF - 70"

395'

245'

230'

DR.

165'

200'

600'

10"

