

LAT. 5 WESTLINK SEWER
 Mid States Constr. Co. Inc. 6-25-63
 Proj. No C23-41 Book K76A 8-9-63

airway

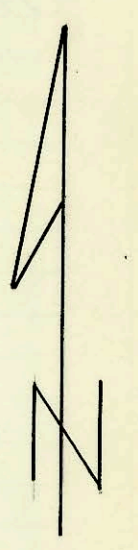
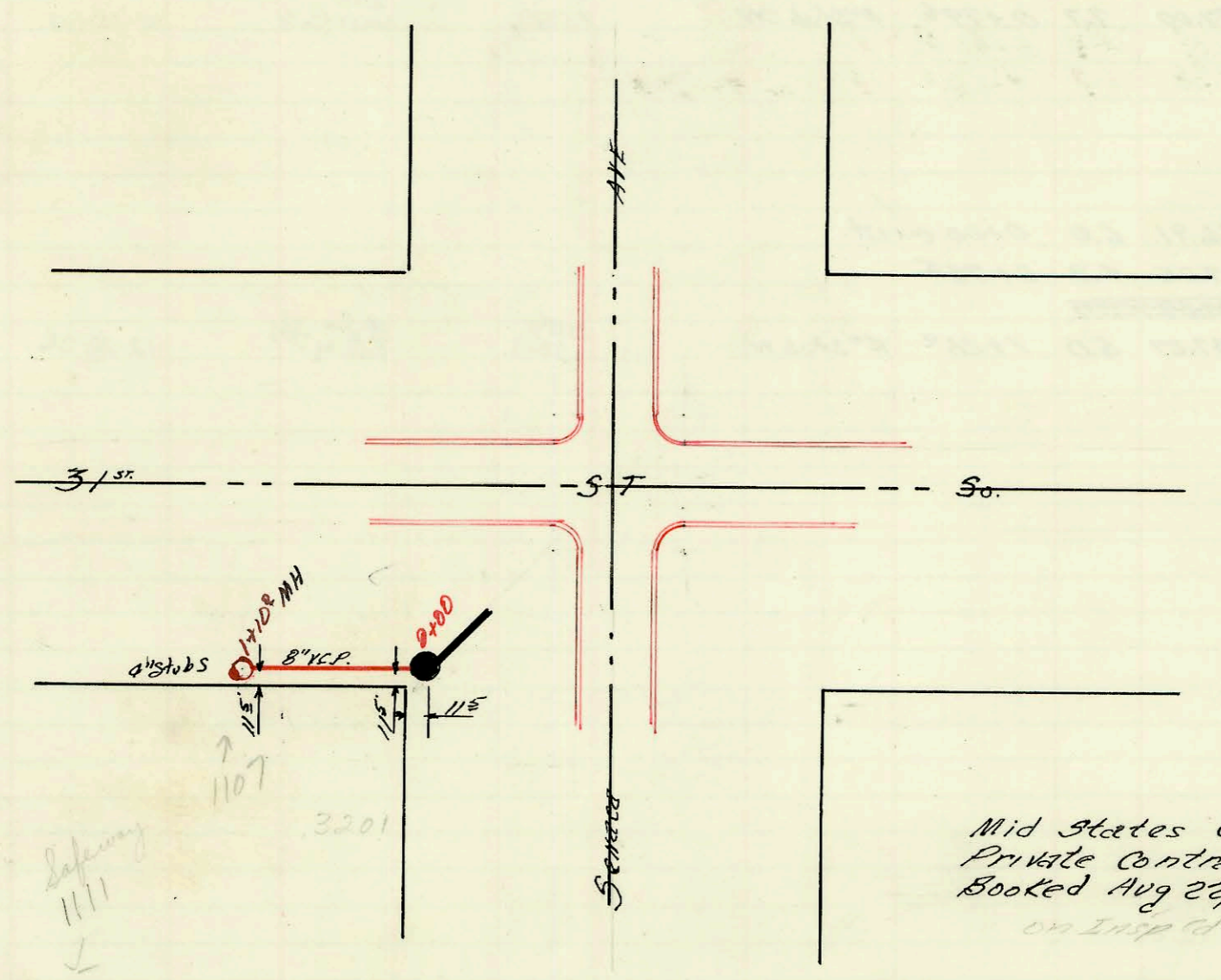

Mid States Constr. Co. Inc
 Private Contract Aug 16, 63
 Booked Aug 22, 1963
 on Insp'd plan

See
 J-2

CONSTRUCTION RECORD

SERVICE RECORD

STATION	ELEVATION		Depth	MANHOLE	4-INCH "Y" BRANCHES		No. of Permit		House Number		DATE OF PERMITS	
	Ground	Grade			North West	South East	North West	South East	North West	South East	North West	South East
LAT 5 Westlink Sewer												
0+00	127.88	117.00	10.9	0+00 Exist								
	128.7	117.04	11.7	0+22 ^o								
1+00	129.5	117.30	12.2									
					1+30 ^o			B 835	4531 W. Seneca			2-19-64
2+00	129.5	117.50	12.0									
						2+17 ^o		B 3326	3515 Shade	443 Westfield Ct		5-4-65
						2+49 ^o		B 2071				10-2-64
3+00	129.9	117.70	12.2									
	129.7	117.75	12.0	3+28 ^o								
						3+71 ^o	3+71 ^o	#2 B 6270	9521 Westfield	447 Westfield		8-12-68 8-30-66
4+00	128.9	117.9	11.0									
						4+86 ^o						
5+00	128.6	118.10	10.5									
						5+03 ^o		B 3425	4431 Shade			5-18-65
6+00	128.3	118.3	10.0									
	128.4	118.36	10.0	6+31 ^o	4" Stubs NE&SE			B 108	451 Westfield			9-5-63
								4124	459 Westfield			11-12-81
								B 3315	469 N. Westfield	459 Westfield (swimming pool)		5-3-65 4-14-76
Private Contract Mid States Constr. Co. Inc.												
0+00	95.2	90.00	5.2	0+00 Exist								
	95.2	90.44	4.8	1+10 ^o Endline 4" Stubs S				B 20683		1107 W. 31st St		8-25-70 8-21-63

Ref
 SWR 2000-01651 7-12-00 439 N Westfield Ct - Wichita, KS - 4" PVC - Replace from house to WPL (Approx 20-25' off main) Tied back to clay tile. Owner of other prop. would not allow digging on prop. where main lays. Roto Rooter TV'd this portion of line.

23511-7 6/6/91 - 320' S. Seneca - Groundwater clean up - M.H. stub.